

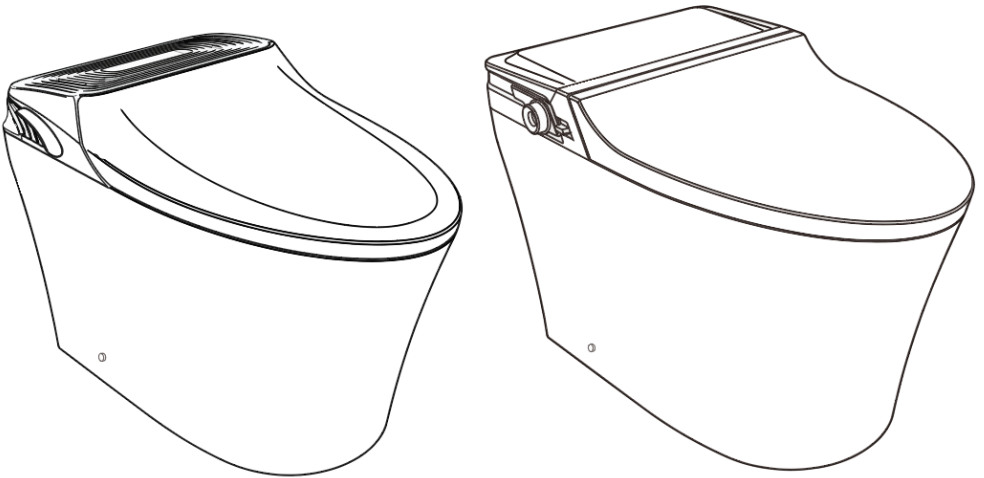

LOS FLEXI
CRAFTING YOUR HOME STORY



Y1 & Y2 Smart Toilet

INSTALLATION GUIDE

cs@losflexi.com

www.losflexi.com

+1 (662) 502-5099

SAFETY PRECAUTIONS

- This product is a Class I appliance. For your life and property safety, please carefully read and follow the following precautions.
- To prevent the danger of arbitrarily resetting the fuse, this product seals the fuse. It is prohibited to use fuses that do not meet the product specifications.
- The fixed power supply cord must have a conductor cross-sectional area of 17-14 AWG (1-2 mm²).
- Ensure the water supply pressure remains within 22-109 psi.

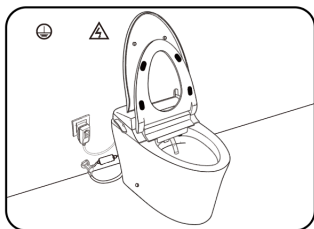

GROUNDING

- Ensure the power outlet is properly grounded. This product must be connected to a dedicated 120V AC, 60Hz, 15A circuit with a Ground Fault Circuit Interrupter (GFCI).
- If the power supply is not grounded, it may cause electrical leakage or electric shock.
- Contact a qualified electrician or your local power company for grounding assistance.

PROHIBIT

Please follow the safety instructions below. Otherwise, it may cause fire, electric shock, burns, personal injury, water leaks, indoor flooding, or product damage.

Do not disassemble, repair, or modify this product. If you have any questions, please contact our customer service.

A line drawing of a toilet with its lid up. To the right of the toilet is a circular icon with a diagonal slash over a crossed wrench and screwdriver, indicating that disassembly or modification is prohibited.

Do not pour water or detergent on the product body or power plug.

A line drawing of a toilet with its lid up. Water is shown splashing from the top of the toilet. To the right is a circular icon with a diagonal slash over a water tap, indicating that pouring water or detergent is prohibited.

Do not bring lit cigarettes or flammable materials near the product.

A line drawing of a toilet. To the right is a circular icon with a diagonal slash over a lit cigarette, indicating that bringing lit cigarettes or flammable materials near the product is prohibited.

Do not touch or unplug the power plug with wet hands.

A line drawing showing a hand reaching towards a power plug. Lightning bolts are shown striking the plug, and water droplets are on the hand, indicating that touching or unplugging the power plug with wet hands is prohibited.

Do not connect this product to wastewater, mixed water, industrial water, seawater, or any untreated or partially treated water. Doing so may cause skin infection or product malfunction.

A line drawing of a toilet. To the right is a circular icon with a diagonal slash over a water tap, indicating that connecting the product to inappropriate water sources is prohibited.

Do not bend or flatten water pipe.

A line drawing showing a water pipe being bent. Lightning bolts are shown striking the pipe, indicating that bending or flattening the water pipe is prohibited.

Do not pour urine into warm air outlet.



Do not hit or sit on the toilet cover.



Do not insert fingers or objects into the heating outlet and do not cover it during use.

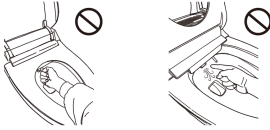

	Do not use damaged or malfunctioning products.
	Do not bend or flatten water pipe.
	Do not disassemble water pipe while valve is open.
	Do not use loose, shaking, or other faulty power sockets.
	Do not pull, twist, bend, pinch, bundle, or bear weight on the power cord or plug. Damaged cords or plugs may lead to electric shock or fire.
	Only feces and toilet paper should be flushed.
	Replace damaged power cords properly. Only the manufacturer or electrical personnel should replace a damaged power cord.

PAY ATTENTION TO

Do not use this product in bathrooms that are overly damp or prone to flooding. Avoid spraying or rinsing the product with water to prevent internal damage. Otherwise, it may cause electric shock or fire.



Avoid placing the product in direct sunlight or near heating equipment. Exposure may cause discoloration.

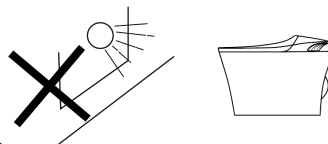

When the product will not be used for an extended period, always unplug the power, turn off the water supply, and drain any accumulated water inside the product. Failure to do so may result in damage from frozen water, potentially causing fire or water leaks.

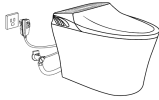

In cold winter, if the product is transported or stored for a long time, remaining water inside may freeze. To prevent damage from freezing, take appropriate anti-freezing measures. Failure to do so may cause fire or water leaks.



When cleaning or maintaining the toilet, do not use harsh or unsuitable cleaners, including strong acids, industrial solvents, acetone, gasoline, kerosene, brake fluid, or high-concentration alcohol. Using improper cleaners may crack plastic parts or cause personal injury, electric shock, or fire.

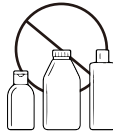

Do not lean back, stand on the cover, or roughly open or close the lid or seat, as this may cause damage and personal injury.

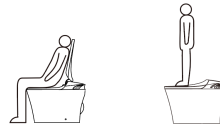

	Do not use the "high" or "medium" seat temperature or heating/air temperature settings for extended periods. Prolonged use may cause burns.
	Do not pour urine directly onto the product body, nozzle, or cleaning tube. Doing so may cause dirt buildup and blockages.
	Always use the new hose components provided with this machine. Do not reuse old components. If other water connection devices are used, replace them together. Otherwise, water leaks and property damage may occur.
	In the event of a sudden power outage, unplug the power plug and close the corner valve to prevent water leakage.
	To prevent safety risks from an improper thermal circuit breaker reset, do not power this product through external switching devices, such as timers, or connect it to circuits that automatically turn on and off.
	A water stop valve should be installed within reach in the same room or area as the product. This allows the water supply to be quickly shut off in an emergency without using tools. Failure to have an accessible stop valve may result in unexpected malfunctions and potential user losses.
	Do not embed cementitious materials (such as cement mortar) in the base of the toilet, as expansion may cause cracking.
	Regularly unplug the power plug and wipe it with a dry cloth to remove dust. Poor insulation may cause fire if ignored.

Follow these steps when using the battery:

- Only use and dispose of batteries in accordance with local regulations. Improper use may disable safety protections and cause hazards such as explosions or fire.
- Do not expose the battery to high temperatures, including sunlight, fire, or ovens, as this may cause explosion or leakage of flammable liquids or gases.
- Do not disassemble, strike, squeeze, or cut the battery, which may cause an explosion.
- Stop using the battery immediately if it expands or deforms.
- Keep the battery out of reach of children. If swallowed or inserted into any part of the body, seek medical assistance immediately.

MANDATORY

Please supervise children at all times to make sure they do not play with the product, as misuse may cause injury.



If you notice any water leakage, please close the water valve immediately to stop the water supply.



This product must be connected to a cold water supply with an inlet temperature between 39.2°F and 95°F (4°C-35°C). Using water outside this range may result in burns or product malfunction.



This product should be used under adult supervision by children, and by individuals with physical, sensory, or intellectual limitations, or limited experience.

When using the heating or drying functions, please help lower or turn off the temperature for children, elderly users, or anyone who may have difficulty adjusting settings; users with limited mobility or slower reactions; and anyone who may fall asleep due to medication, alcohol, or extreme fatigue.

When installing or replacing the filter, remember to shut off the water supply and angle valve, and tighten all connections securely to prevent water leaks.

This product is designed for use in environments above 32 °F (0 °C). Using it in freezing conditions may damage internal components and cause leaks or malfunction.

PACKAGE LIST

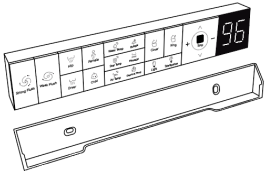

Remote Control Kit



T-valve

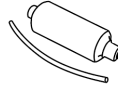

Water Filter

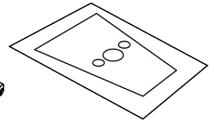

Installation Template

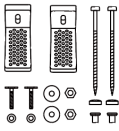

Floor Mounting Bracket

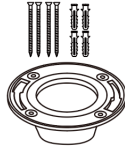

Flange Kit



Wax Seal



Back Up Battery Box



Foam Shield Bottle



Aromatherapy Stick

ROUGH-IN SIZE

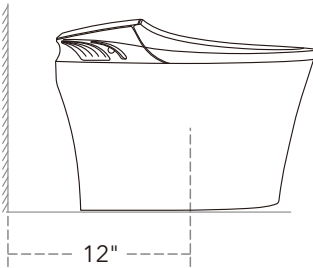

Y1 Model

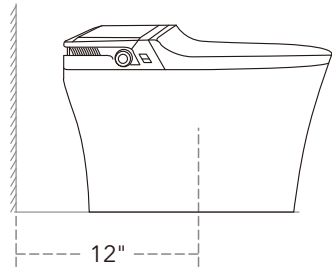

Y2 Model

TOOLS REQUIRED (Not Supplied)



Drill



Adjustable Wrench



Tape Measure



Screwdriver

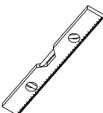

Level



Marker Pen



Caulking Gun

TECHNICAL PARAMETERS

Name (model)		Smart Toilet (Y1 and Y2)
Rated Voltage		120V~
Rated Frequency		60Hz
Rated Power		1380W
Power Cord Length		59.06 Inch (About 5 feet long)
Flushing Method		Jet Siphon Type
Washing Functions	Rear Wash	The cleaning water volume is about 0.16 GPM (0.62L/min)
	Feminine Wash	The cleaning water volume is about 0.18 GPM (0.67L/min)
	Water Temperature	Room Temperature - about 93 °F - about 98 °F - about 104 °F (4 adjustment levels)
	Maximum Power Of Warm Water Heater	1380W
	Safety Devices	Thermal cutoff, Thermostat, Temperature Sensor
Toilet Seat	Heating Temperature	Room Temperature - about 93 °F - about 98 °F - about 104 °F (4 adjustment levels)
	Power Of Seat Heater	45W
	Safety Devices	Thermal cutoff, Thermostat, Temperature Sensor
Warm Air Dryer	Warm Air Temperature	Room Temperature - F1 - F2 - F3 (4 adjustment levels)
	Power Of Air Dryer	270W
	Safety Devices	Thermal cutoff, Thermostat, Temperature Sensor
Waterproof Grade		IPX4
Water Supply Temperature		41-95°F
Operating Room Temperature		32-104°F
Product Size		28.35 * 17.91 * 20.08 Inch
Product Weight		94.80 LB

INSTALLATION STEPS

1. Remove The Old Toilet

- Turn off the water supply.
- Flush the toilet to empty the tank. Remove any water left in the tank or bowl.
- Disconnect the supply line from the tank.
- Remove decorative caps. Unscrew nuts that attach the toilet to the floor. Remove toilet.
- Make sure the water supply valve is shut off before installation.
- Remove old toilet flange. Clean any old wax, putty, etc. from base area.

2. Reserved Space

- Reserve the installation position according to the dimensions given in the figure below.

NOTE: The installation template also helps locate the toilet in an unfinished bathroom. Place it at the desired spot to measure, install the water valve and outlet, and mark the drain opening.

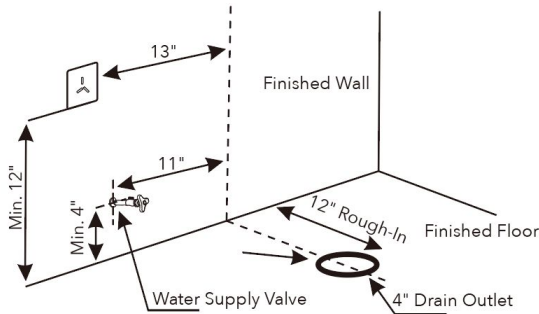

- Place the included installation template.
- Align the template with the drain outlet, mark the mounting holes and extend the dashed reference lines on both sides of the template for accurate positioning.

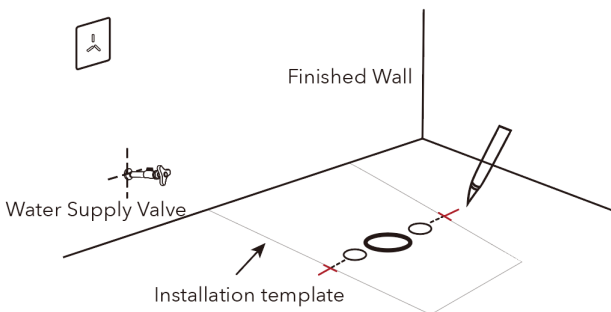

3. Install The Toilet Flange

- Place the flange on the toilet outlet.
- Mark the holes on the floor with a marker, then remove the flange.
- Drill the holes at the marked spots.
- Plug the expansion anchors into the holes.
- Align the flange with the holes.
- Place the screws into the holes and secure them with a drill.

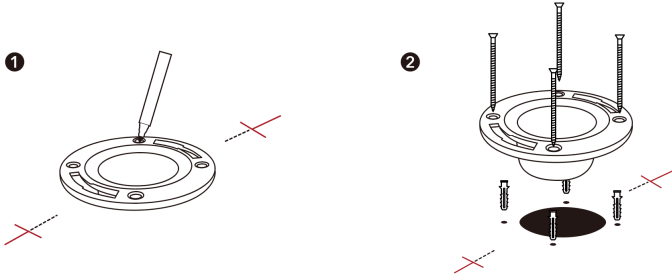

4. Install The Backup Battery Box

- Open the battery box lid and install 10 batteries. Then close the battery box lid.
- Connect the power plug from the battery box to the connecting cable on the toilet, then secure with the waterproof cap.
- Place the battery box behind the toilet. (Please ensure the battery box is accessible for future maintenance.)

Battery Model: AA Alkaline Battery (Not Included)

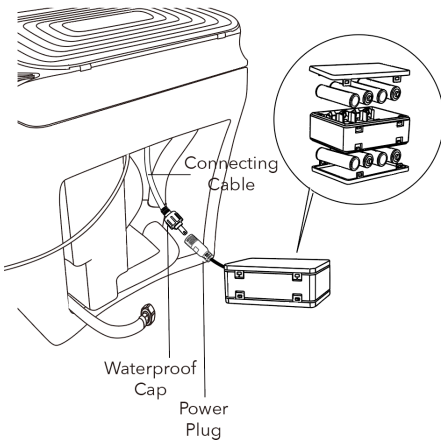

How To Change Battery

- Take out the battery box from the back of the toilet.
- Open the lid and replace batteries.

Recommended Battery Box Position

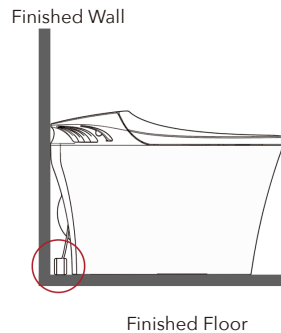

5. Install The Water Fliter

- Attach the water filter to the hose on the toilet. When you hear a "click", it is secured. (This step will make later installation easier.)

NOTE: Make sure the "Flow" arrow points toward the toilet.

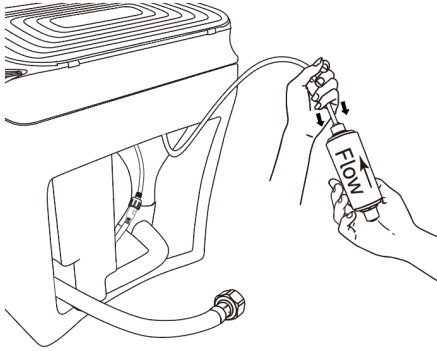

How To Change Water Fliter

- Press the retaining clips on both sides of the filter, then pull out the hoses.
- Replace the filter and reattach the hoses.

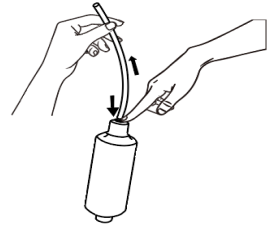

6. Install The Floor Mounting Brackets

- Insert the T-bolts and mounting brackets. Make sure the brackets stay within the circle marks.
- Secure the washers and nuts onto the T-bolts.

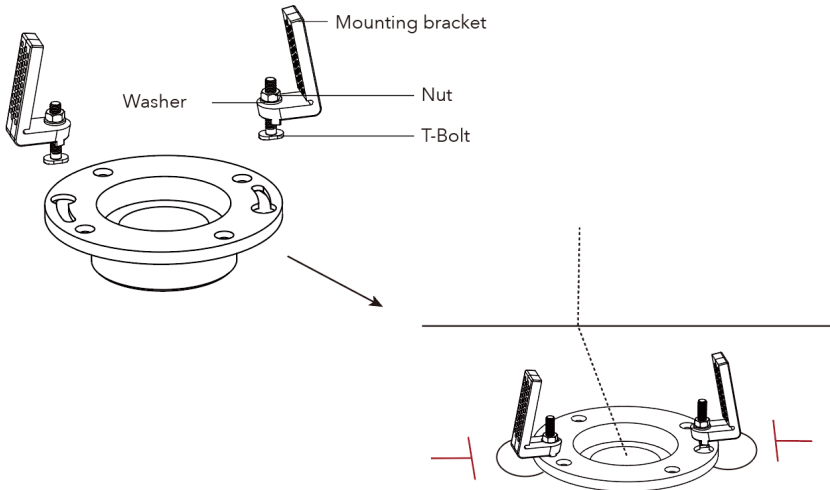

7. Install The Wax Seal

- Place the wax seal at the bottom of the toilet drain outlet.
- Use the marker to mark on both sides of the toilet. The marks should be vertical and aligned with the floor mounting hole.

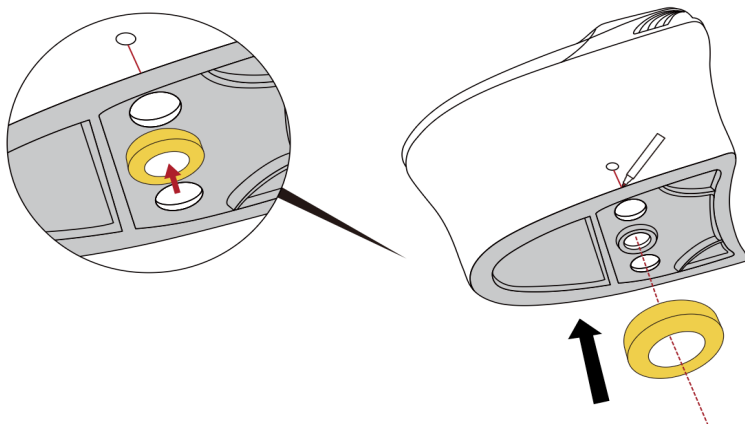

8. Install The Toilet

- Lift the toilet, then carefully lower it onto the mounting position. Apply even pressure to ensure the wax seal sits tightly against the floor.
- Make sure the marks on the toilet align with the lines on the floor.

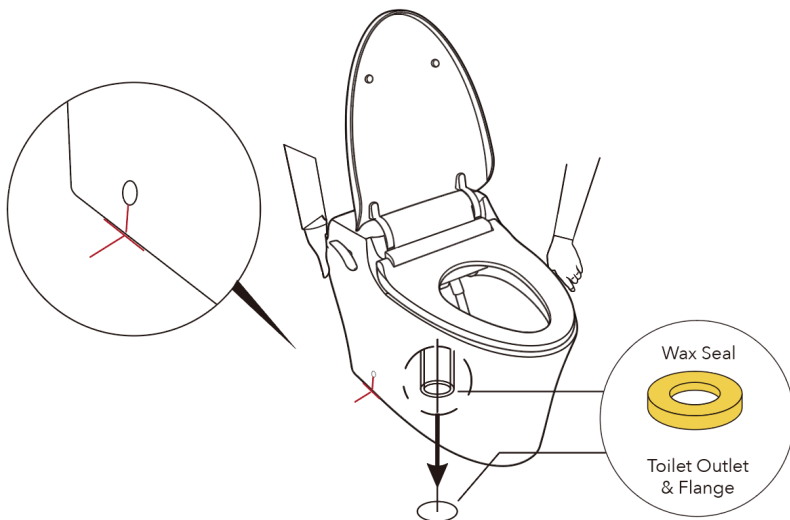

9. Install The Floor Mounting Screws

- Insert the fixing sleeves and screws into the mounting holes on the side of the toilet.
- Tighten the screws with a screwdriver.
- Put the decorative caps over the fixing sleeves.

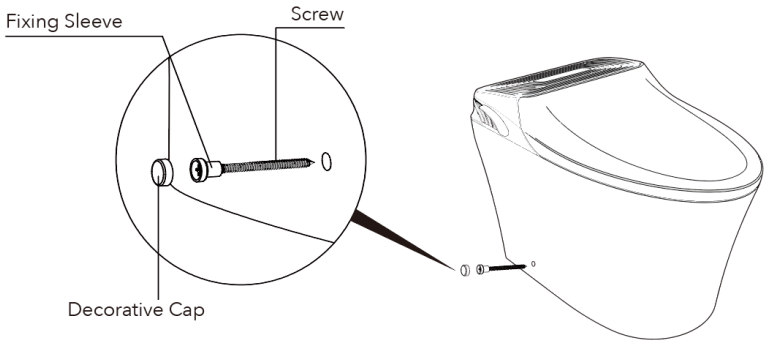

10. Connect The T-valve

- Connect the flush water hose to the T-valve.
- Remove the nut from the water filter outlet on the T-valve. Attach the water filter hose to the outlet, then tighten the nut.
- Attach the hose to the filter. When you hear a "click", it is secured.
- Turn on the water supply valve and the T-valve after all connections are completed.

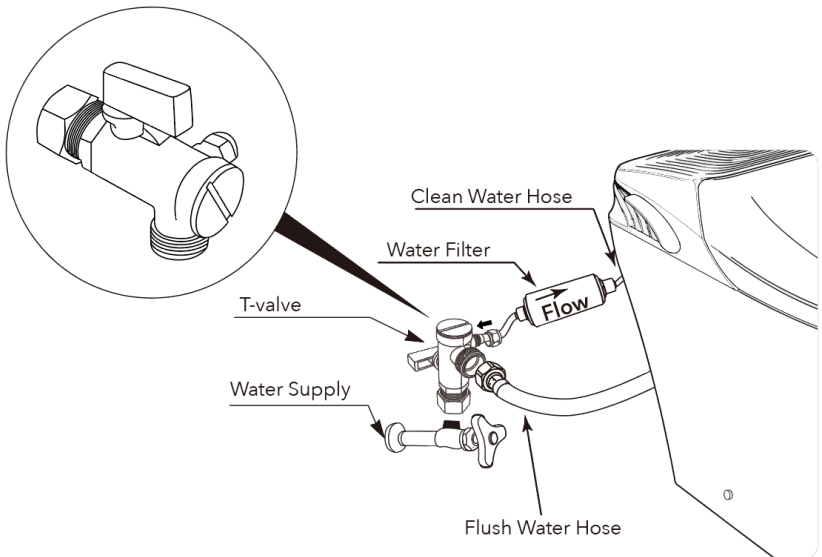

11. Connect The Power And Toilet Test

- Insert the power plug into the 120V waterproof socket.
- Confirm that the socket is connected to the power supply and grounded.
- Press the reset button to activate the toilet.

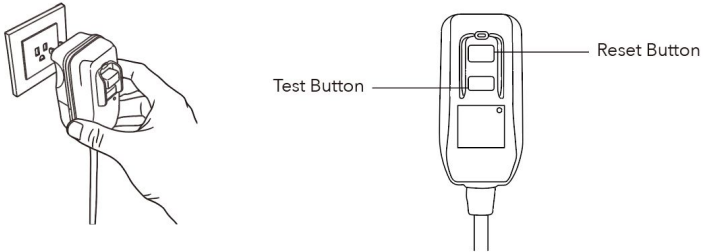

- After powering on the toilet, activate all functions to confirm proper operation.
 - ① Flush the toilet several times and check for leaks.
 - ② Place your palm over the sensor on the toilet seat to activate functions like Rear Wash or Feminine Wash and ensure they work properly.
 - ③ Check all function buttons on the remote control and the side control on the toilet.

NOTE:

- Press the test button on the plug to cut off the power to the toilet. Press the reset button again to activate it.
- If the remote control is no response, please check the following "Remote Control Code Matching" to reconnect it.

Remote Control Code Matching

- After powering on the toilet, press and hold "Feminine Wash" function using the lever or knob on the toilet.
- When hearing "beep" sound, the toilet enter code matching mode.
- Press any buttons on the remote control, and complete the matching.

12. Secure The Toilet

- Use sealant or adhesive to the area where the toilet meets the ground.
- Use a wipe to remove any excess sealant or adhesive.

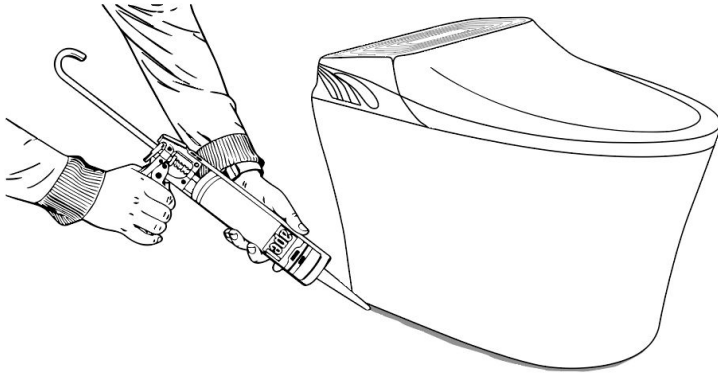

INSTALL THE REMOTE CONTROL

Battery Model:

AAA Alkaline Battery (Not Included)

Method 1: Secure With Anchors And Screws

- Place the holder at the desired spot.
- Mark the holes on the wall with a marker, then remove the holder.
- Drill 2 holes at the marked spots.
- Secure the holder with expansion anchors and bolts. (Not included.)

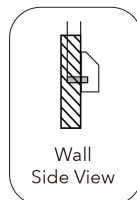
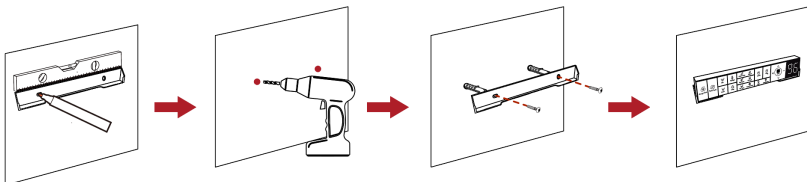

Method 2: Secure with Double-Sided Tape

- Peel off the protective films from the double-sided adhesive on the back of the holder.
- Clean dust, grease, and water from the wall.
- Press the holder firmly against the desired spot for at least 30 seconds to ensure strong adhesion.

NOTE: This method works on glazed tiles, glass, and other smooth wall surfaces.

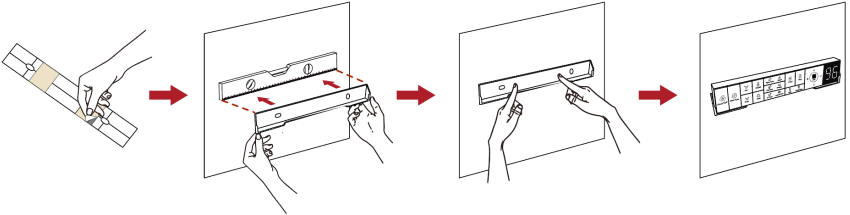

Recommended Installation Area

It is recommended to install it level with your sight when sitting on the seat. (Slightly higher than the smart toilet.)

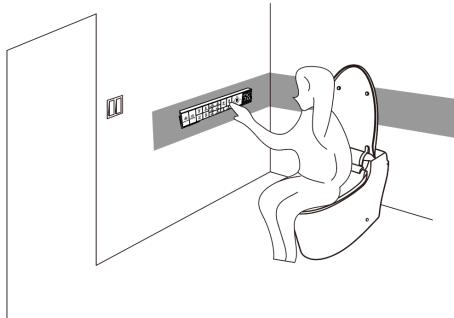

The gray area indicates the recommended installation area.

LIMITED WARRANTY COVERAGE

ONE YEAR LIMITED WARRANTY

Los Flexi products are crafted with superior materials and impeccable workmanship, offering our customers reliable and long-lasting products. If defects in materials or craftsmanship are detected under standard use within the first two years of installation, Los Flexi will either supply replacement parts at no charge or, if deemed necessary, replace the product or its parts. This warranty is exclusive to the original purchaser, and proof of purchase is mandatory for any claim.

This Warranty Will Be Voided If:

- The product's installation did not follow our recommendations.
- The product was relocated from its initial installation site.
- The product underwent any modifications from its original condition.
- The product suffered from neglect, misuse, chemical overuse, accidents, or any other damages.

Los Flexi does not imply that our products adhere to local building or plumbing codes. Consumers must ascertain local code compliance before and during installation. This warranty is strictly for the original purchaser and first consumer.

Los Flexi won't be held responsible for any consequential damages linked to the product's installation, replacement, return, or usage. This includes, but is not limited to, freight charges, labor, downtime, home damages, and other associated costs (e.g., professional services, investigations, audits, legal fees).

This Los Flexi warranty clearly delineates our liability. Items not specified in this warranty fall outside Los Flexi's responsibility. In states with variations concerning implied warranties, our compliance is ensured.

For any queries or concerns, feel free to reach out to us at

Email: cs@losflexi.com

Site: www.losflexi.com

Voicemail: +1(662) 502-5099



For High Resolution
Installation Guide



Y1 Smart Toilet
Instructional Videos



Y2 Smart Toilet
Instructional Videos