

ASSEMBLY INSTRUCTION

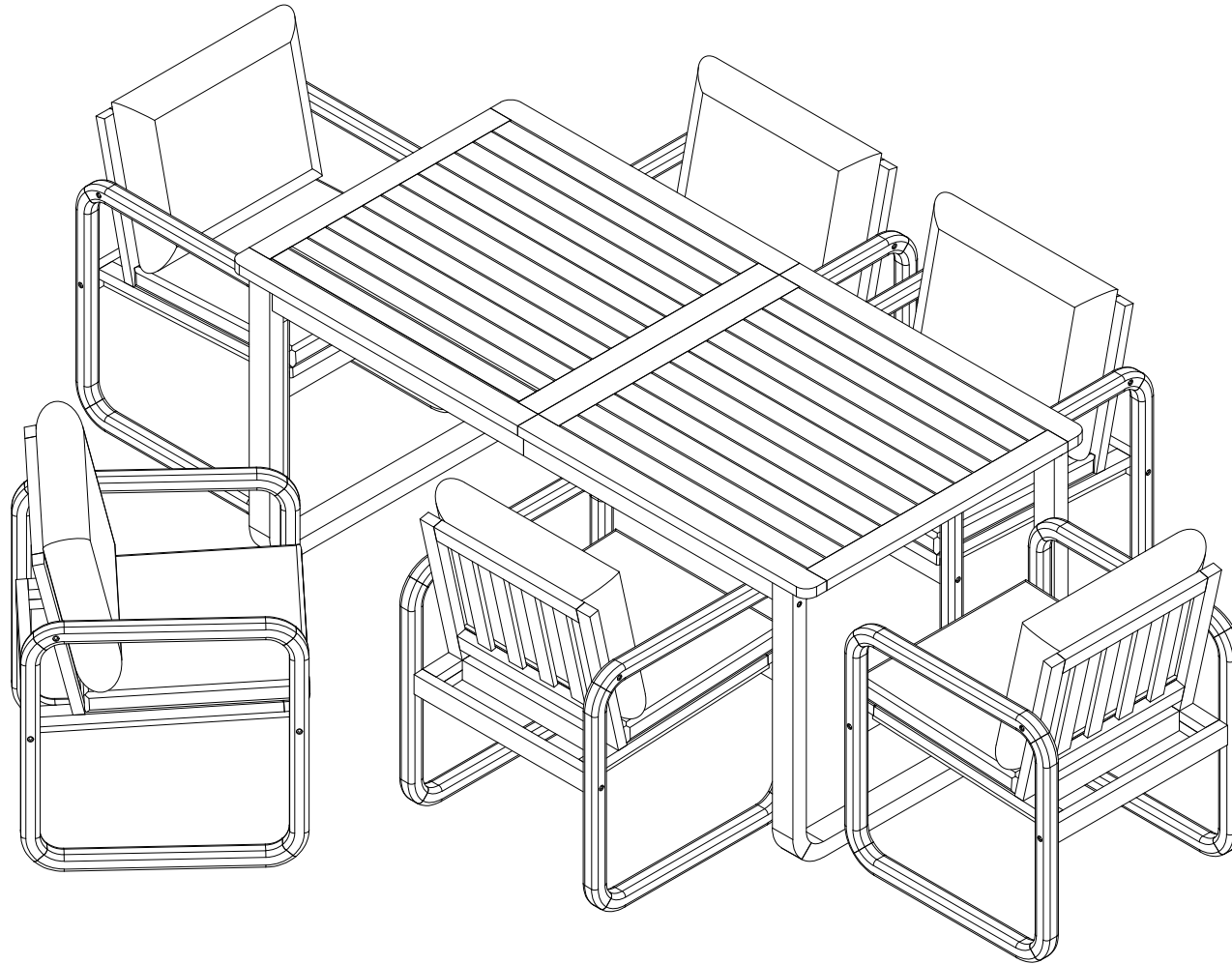

N719P387619;N719P387620;N719P387621

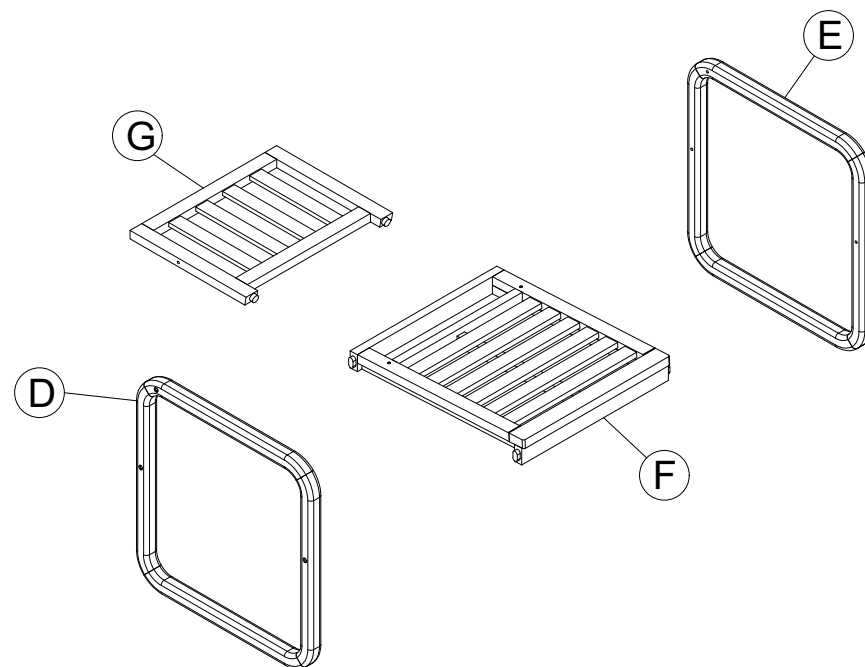
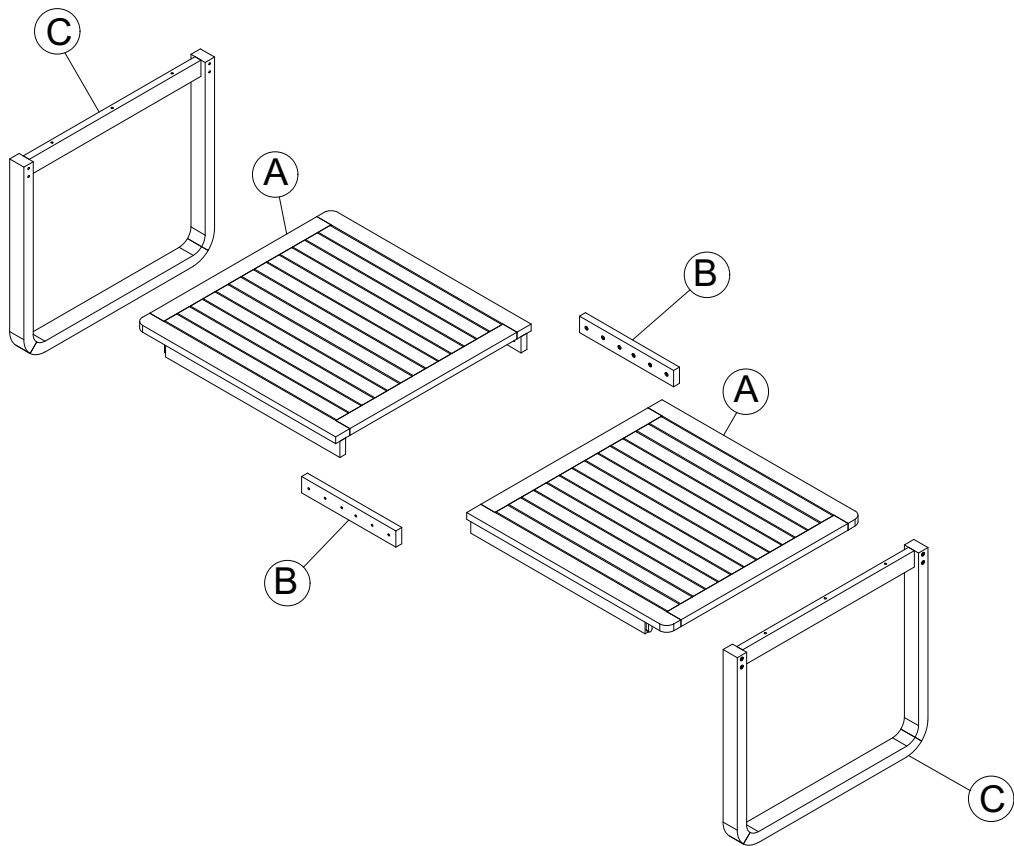

X6

Notice :

1. 50% Tighten before fixing all screws, Allen wrench is recommended instead of an electric drill.
2. Place the item on a flat ground to adjust and make sure it remains stable.
3. Tighten up all screws with tools gradually.
4. If the screws are not aligned with holes during assembly, please loosen all the other screws to 50% and continue the assembly process.
5. If the item is not stable, please loosen all the screws, adjust it on a flat ground and tighten up all screws again.
6. Note : If one or some screws are fully tightened during assembly, chances are the others will not be aligned with holes. In addition, all the holes are designed to be relatively larger to provide more space for the adjustment of the screws.

Part List :

A

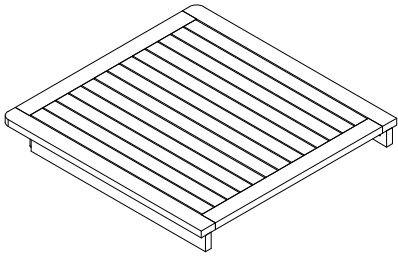

Table Top (2pcs)

B

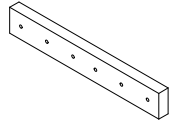

Table Support (2pcs)

C

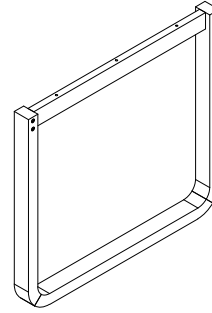
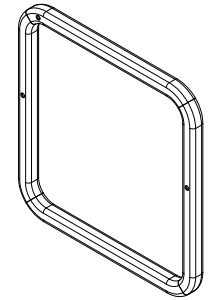

Table Leg (2pcs)

D



Left Leg Chair (6pcs)

E

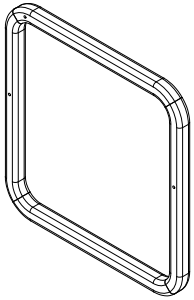

Right Leg Chair (6pcs)

F

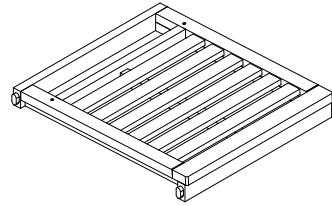

Chair Seat Panel (6pcs)

G

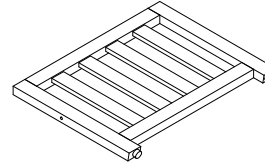

Chair Backrest Panel (6pcs)

I

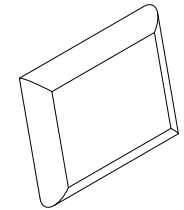

Back Cushion (6pcs)

H

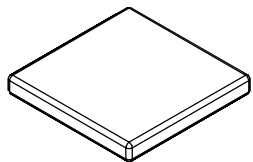

Seat Cushion (6pcs)

Hardware List :

1

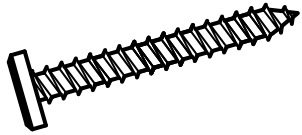

**Screw M7*90mm (8 PCS)
extra 1 pc**

2

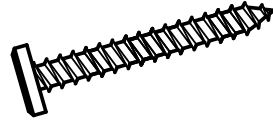

**Screw M6*80mm (12 PCS)
extra 2 pcs**

3

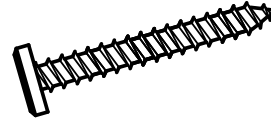

**Screw M6*70mm (24 PCS)
extra 3 pcs**

4

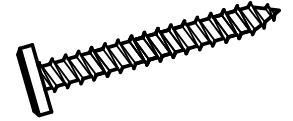

**Screw M6*60mm (6 PCS)
extra 1 pc**

5



**Allen Bolt M6x60mm (12 pcs)
extra 2 pc**

6

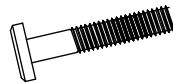

**Allen Bolt M6x40mm (12 pcs)
extra 2 pcs**

7

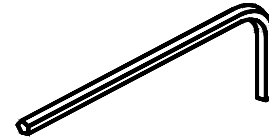

Allen Key (1 pc)

8

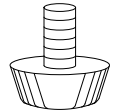

**Leveler PP Screwed (24 pcs)
extra 3 pcs**

CARTON CONTENT

SKU: N719P387619

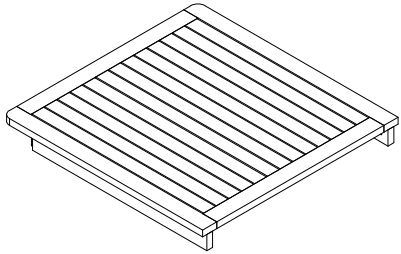

AX 2

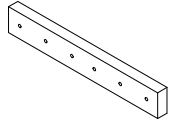

BX 2

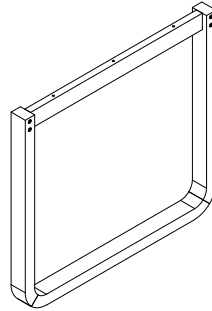

CX 2

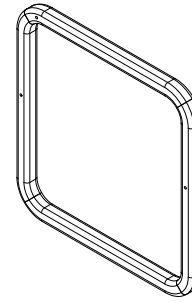

EX 3

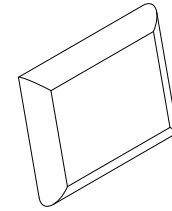

IX 3



Hardware

SKU: N719P387620

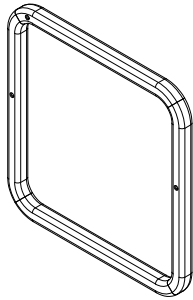

DX 6

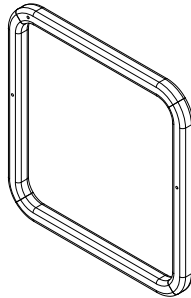

EX 3

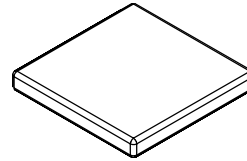

HX 6

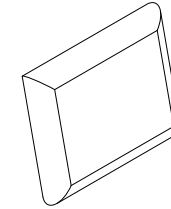

IX 3

SKU: N719P387621

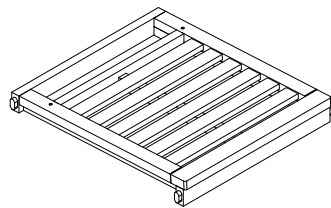

FX 6

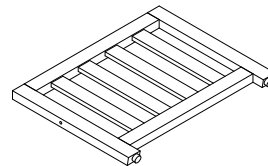

GX 6

ASSEMBLY INSTRUCTION

STEP 1

A x 2

B x 2

⑥ x 12

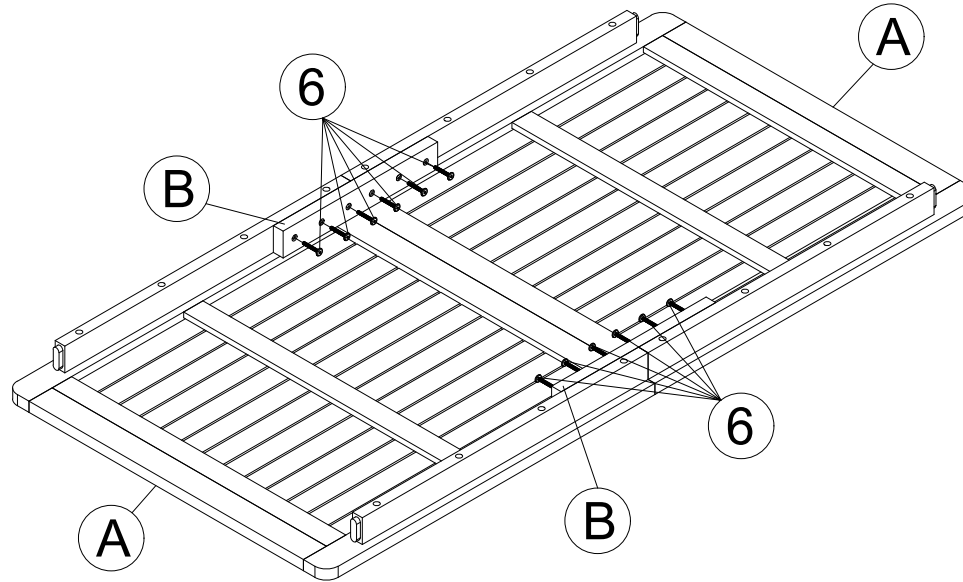

STEP 2

C x 1

① x 4

④ x 3

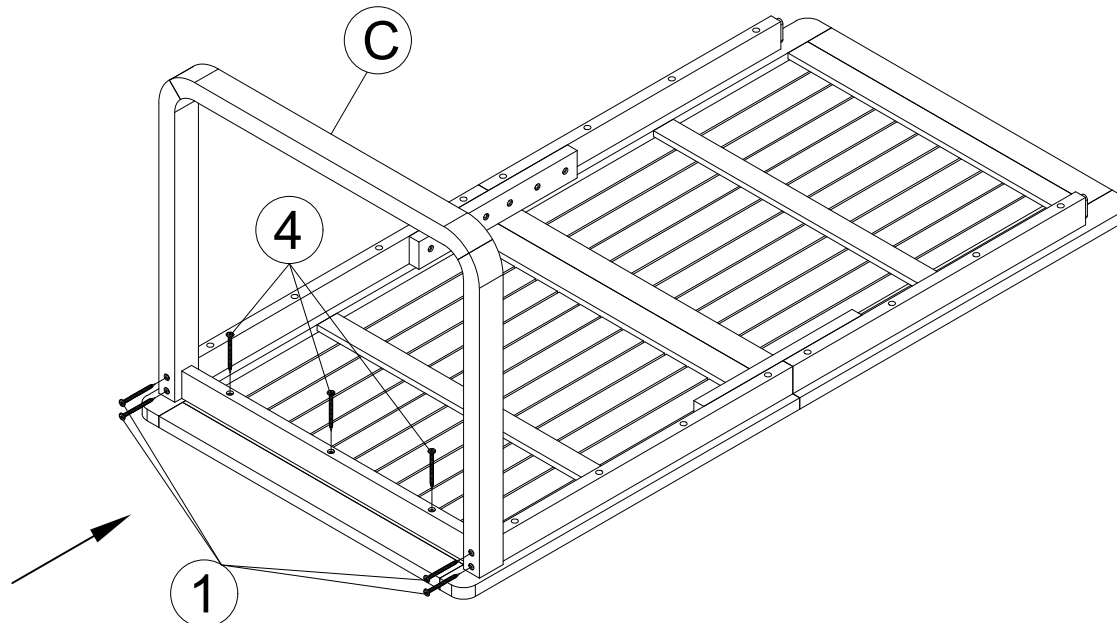

ASSEMBLY INSTRUCTION

STEP 3

C x 1

① x 4

④ x 3

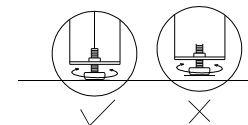
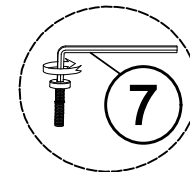
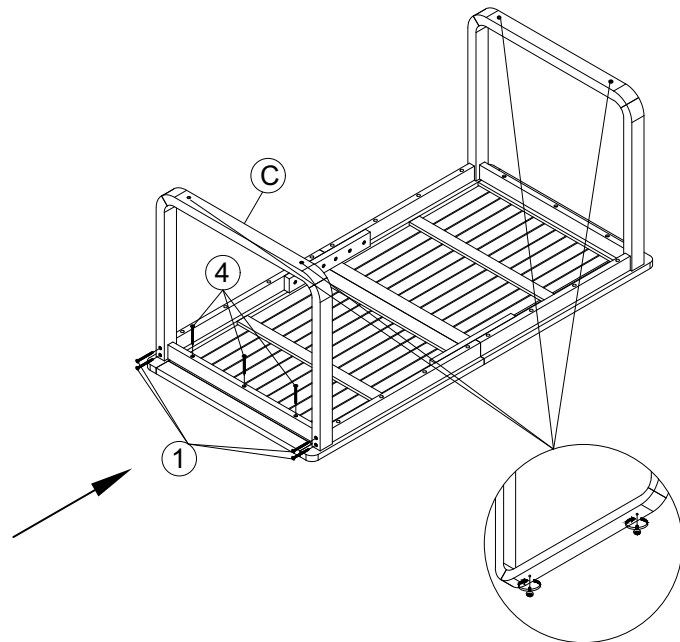

STEP 4

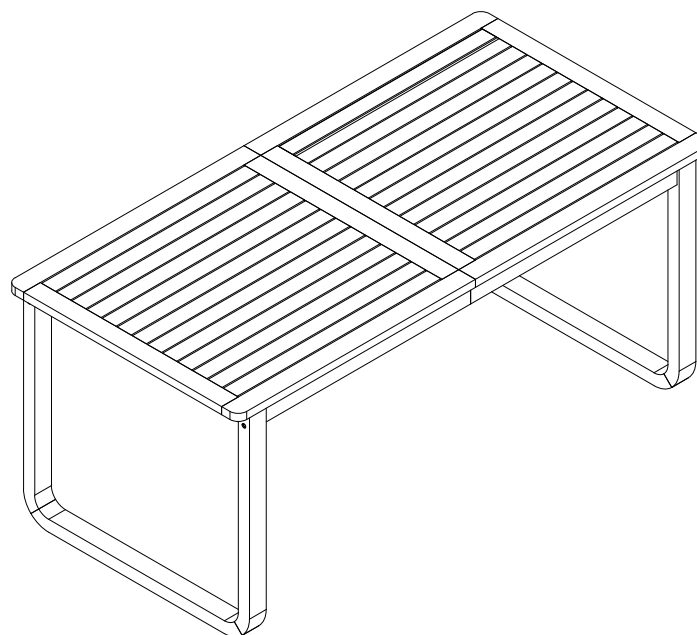

ASSEMBLY INSTRUCTION

STEP 5

D x 1

E x 1

F x 1

③ x 4

X6

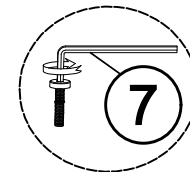
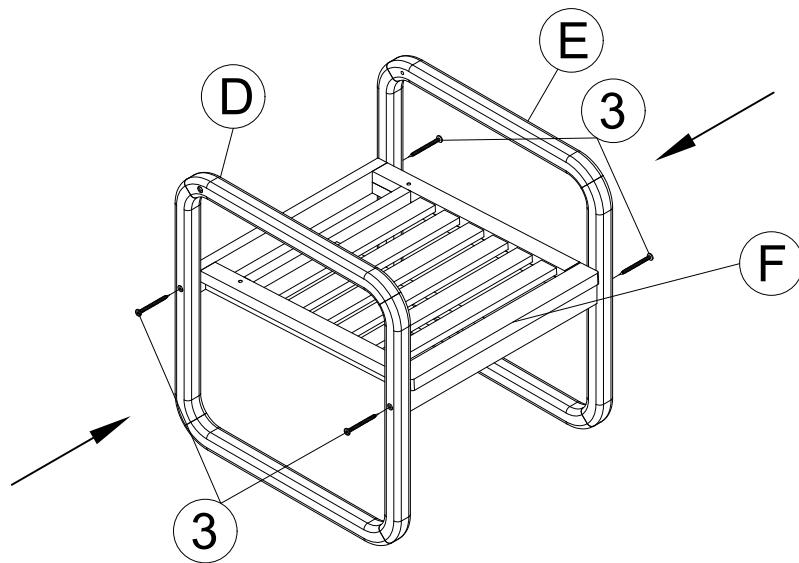

STEP 6

G x 1

⑤ x 2

X6

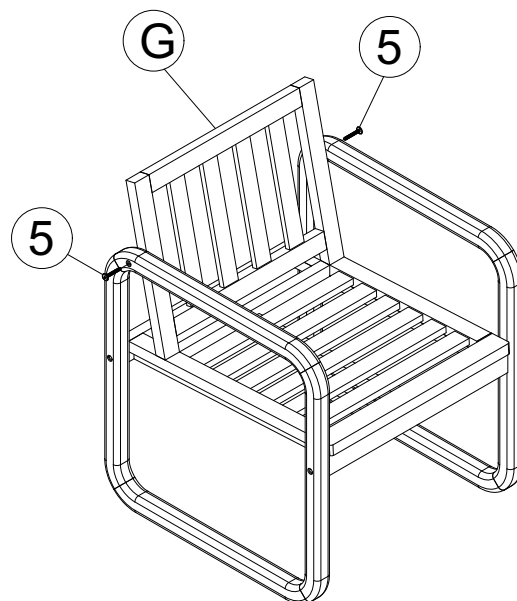

ASSEMBLY INSTRUCTION

STEP 7

② x 2

⑧ x 4

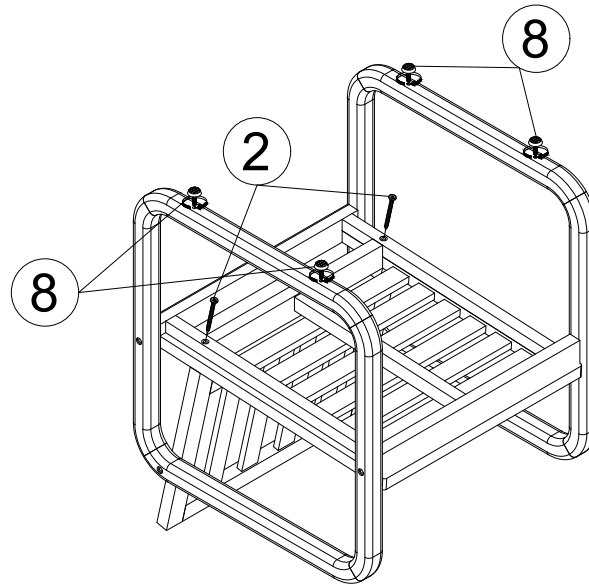

X6

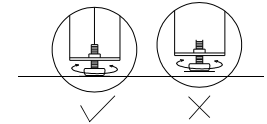

STEP 8

I x 1

H x 1

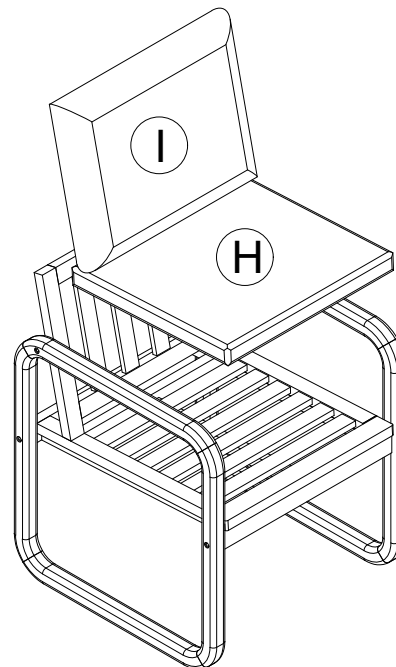

X6

ASSEMBLY INSTRUCTION

STEP 10

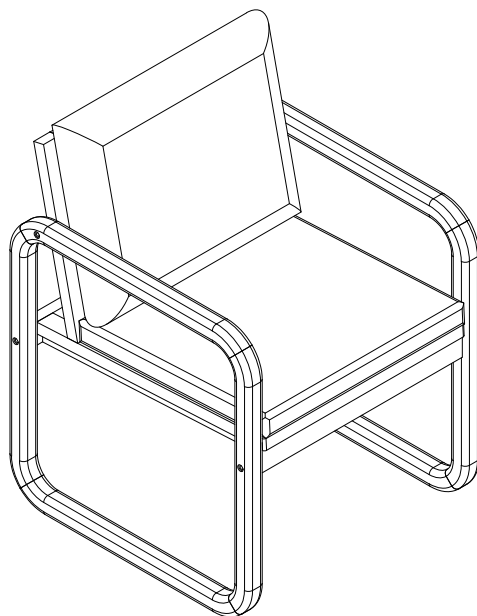

ASSEMBLY INSTRUCTION

