

ASSEMBLY INSTRUCTION

Description: DINING TABLE

Thank you for purchasing this quality product space. Be sure to check all packing material carefully for small parts that may have come loose inside the carton during shipment.

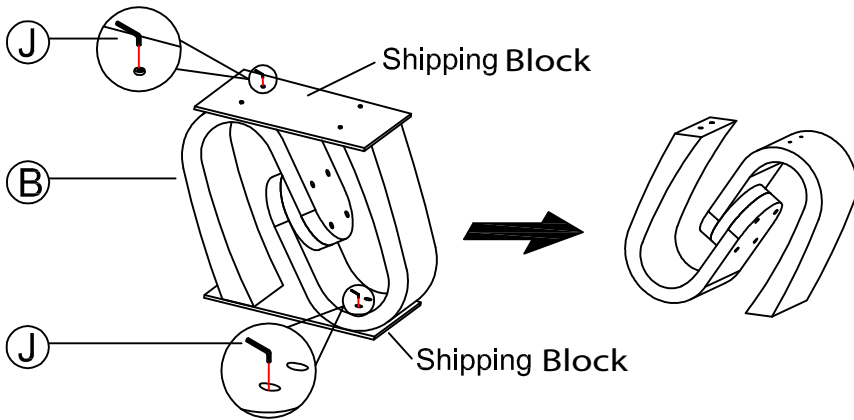

Step 1

Remove the upper and lower shipping block from the pedestal

Step 2

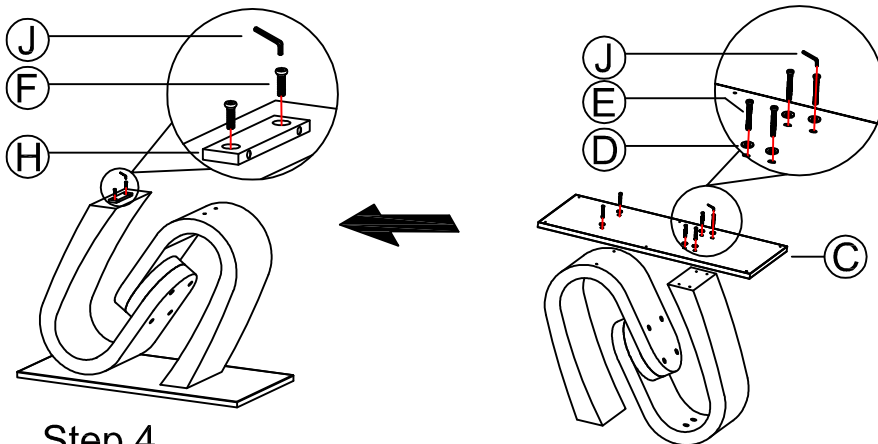

Step 4

Assembly the metal glass collector bracket to the pedestal

Step 3

Attach the bottom plate to the pedestal

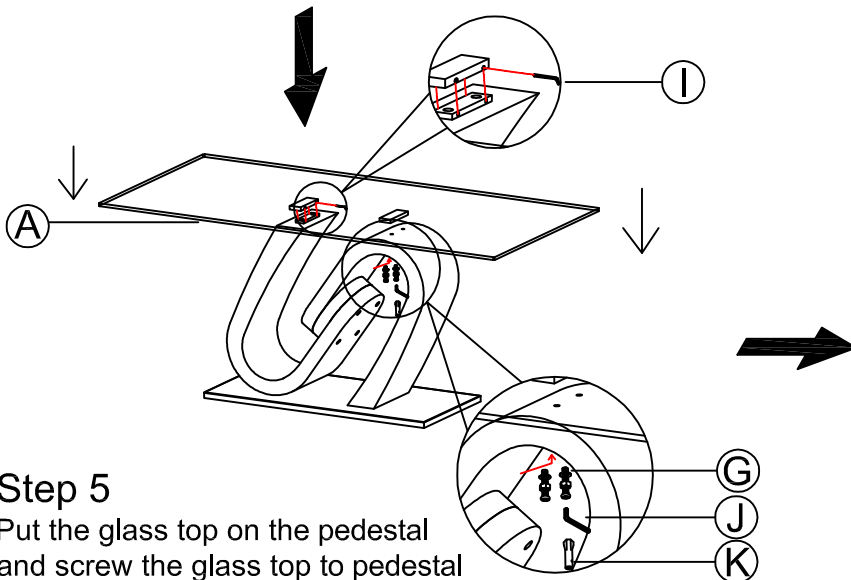

Step 5

Put the glass top on the pedestal and screw the glass top to pedestal

PART LIST:

| NO. | Description | Diagram | Quantity |
|-----|-----------------|---------|----------|
| A | Table glass top | | 1 |
| B | Table column | | 1 |
| C | Table base | | 1 |

HARDWARE LIST:

| NO. | Description | Diagram | Quantity |
|-----|--|---------|----------|
| D | Flat washer $\phi 20 \times T2.0\text{mm}$ | | 6 |
| E | Bolt M8 $\times 40\text{mm}$ | | 6 |
| F | Bolt M8 $\times 20\text{mm}$ | | 2 |
| G | Bolt/Nut/Flat washer M8 $\times 65\text{mm}$ /M8/ $\phi 20 \times T2.0\text{mm}$ | | 2 |
| H | Metal 136 $\times 36 \times 10\text{mm}$ | | 1 |
| I | Allen key 3# | | 1 |
| J | Allen key 5# | | 1 |
| K | Socket wrench 14# | | 1 |

Finished

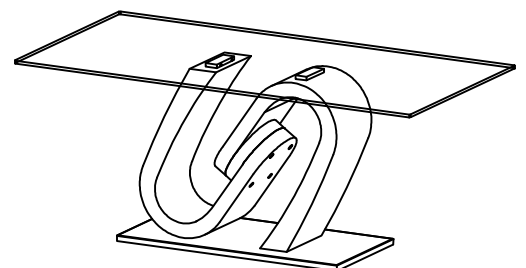

Made In China