

## **BAR UNIT**

### **ASSEMBLY INSTRUCTION**



## ASSEMBLY INSTRUCTION

### ASSEMBLY TIPS:

- 1.Remove hardware from box and sort by size.
- 2.Please check to see that all hardware and parts are present prior to start of assembly.
- 3.Please follow attached instructions in the same sequence as numbered to assure fast & easy assembly.



### Warning !

- 1.Don't attempt to repair or modify parts that are broken or defective.Please contact the store immediately.
- 2.This product is for home use only and not intended for commercial establishment.

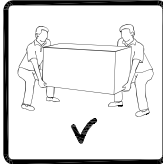

ASSEMBLY TIME PER UNIT: 70 MINUTES

### PARTS IDENTIFICATION:

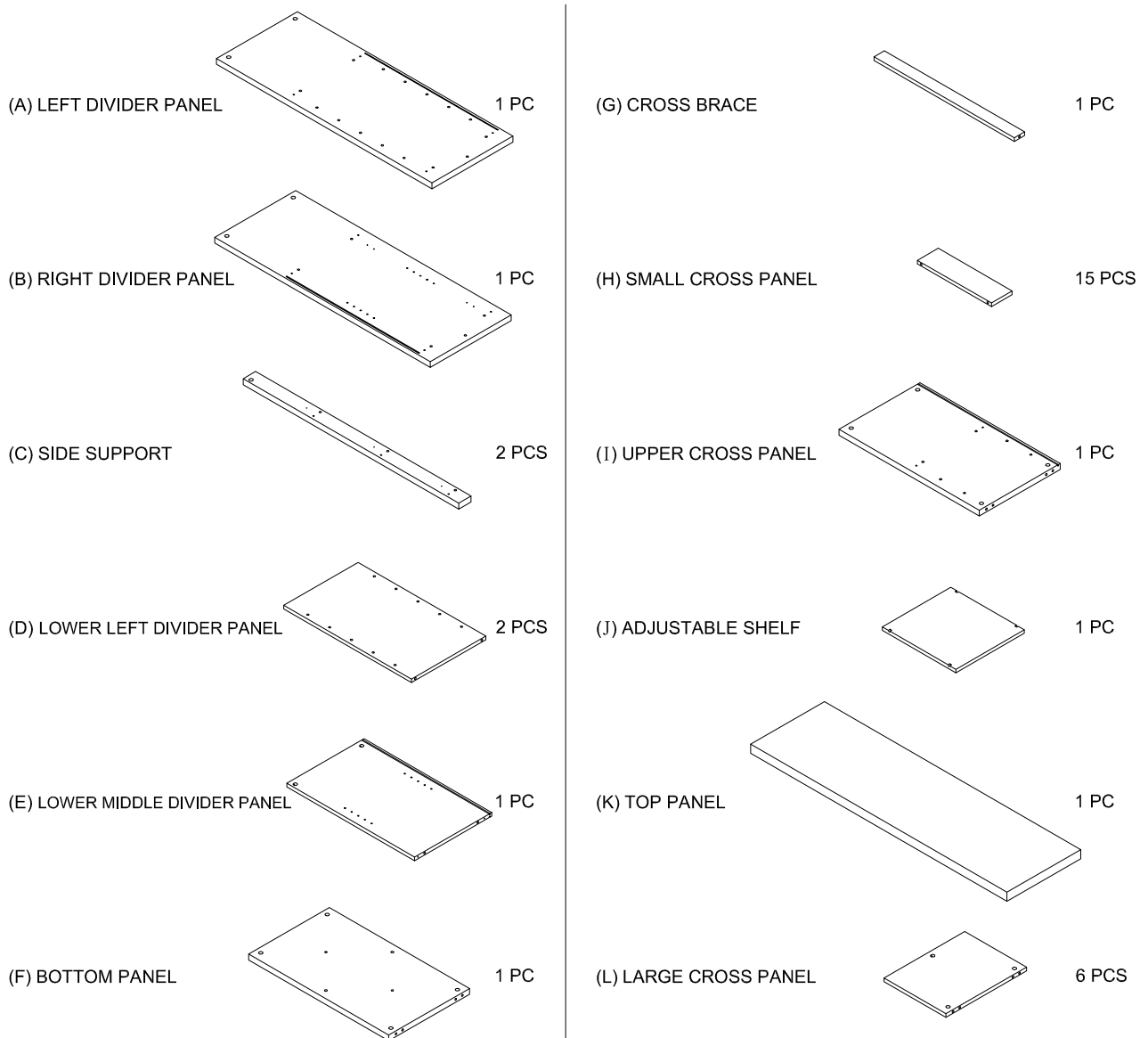

# ASSEMBLY INSTRUCTION

(M) DOOR

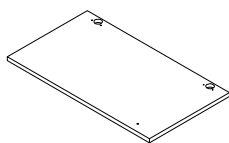

1 PC

(O) GLASS

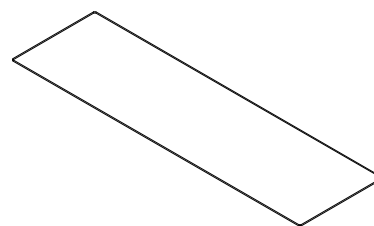

1 PC

(N) BACK PANEL

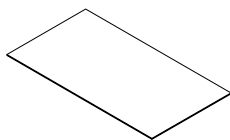

2 PCS

Z	HARDWARE PACKAGE						
NO	DESCRIPTION	FIGURE	Q'TY	NO	DESCRIPTION	FIGURE	Q'TY
1	GLUE 40g		2 PCS	10	HANDLE BOLT		1 PC
2	WOODEN DOWEL ø8x30mm		68 PCS	11	HINGE		2 PCS
3	WOODEN DOWEL ø8x50mm		20 PCS	12	HINGE SCREW ø4x15mm		8 PCS
4	CAM BOLT ø7x35.5mm		34 PCS	13	HANGING CUP HOLDER		1 PC
5	CAM LOCK ø15x12mm		34 PCS	14	∩-shaped iron bar		6 PCS
6	SCREW ø4.5x42mm		2 PCS	15	FIXER		6 PCS
7	PIN ø4.9x8mm		4 PCS	16	FIXER SCREW ø3x19mm		16 PCS
8	PLASTIC FEET ø15mm		7 PCS	17	FILLING PIECE ø12mm x 6 HOLE		1 PC
9	HANDLE		1 PC	18	STICKER ø20mm		6 PCS

Z9,Z10,Z11,Z13,Z14 not included in blister packaging.



## STEP 3 :

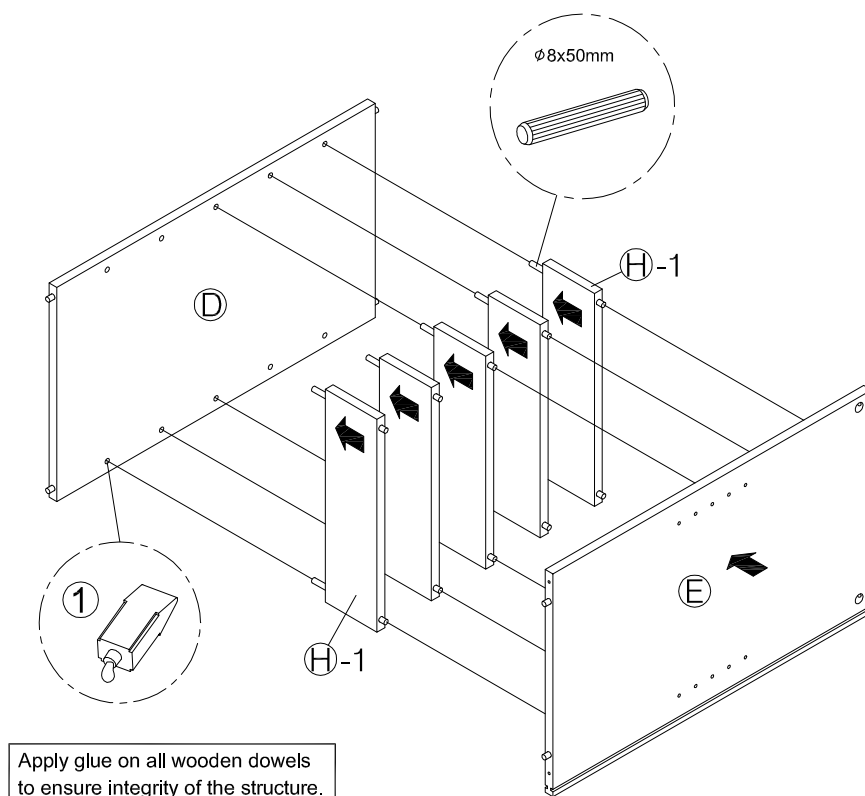

## STEP 4 :

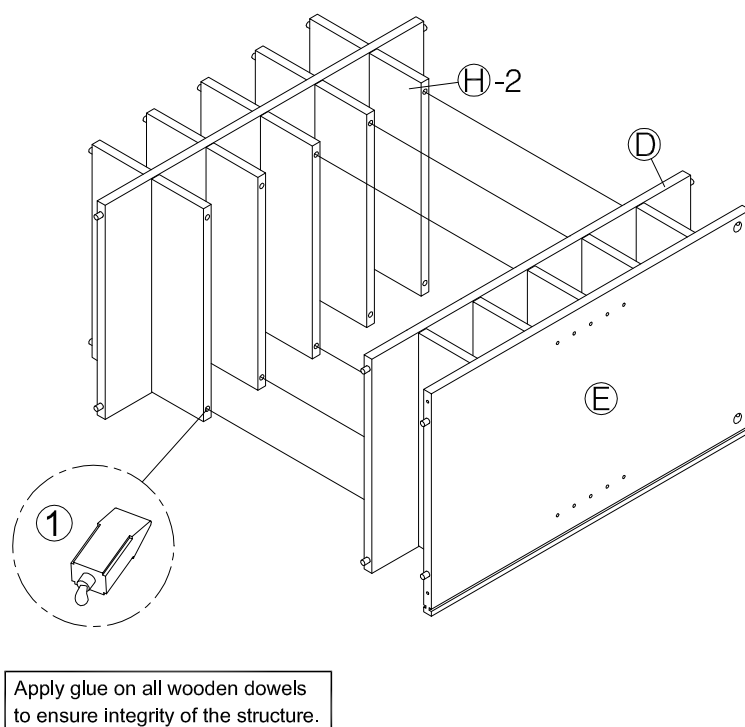

## STEP 5 :

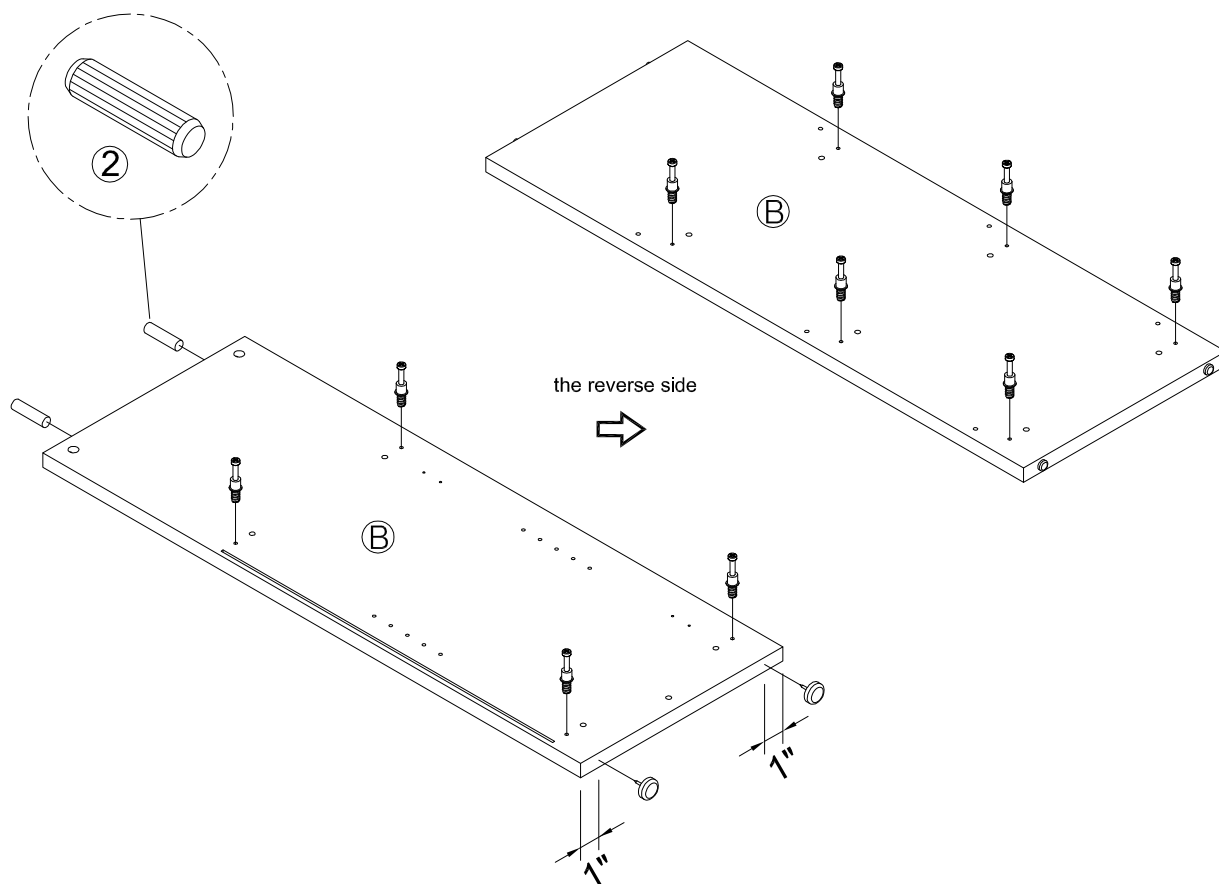
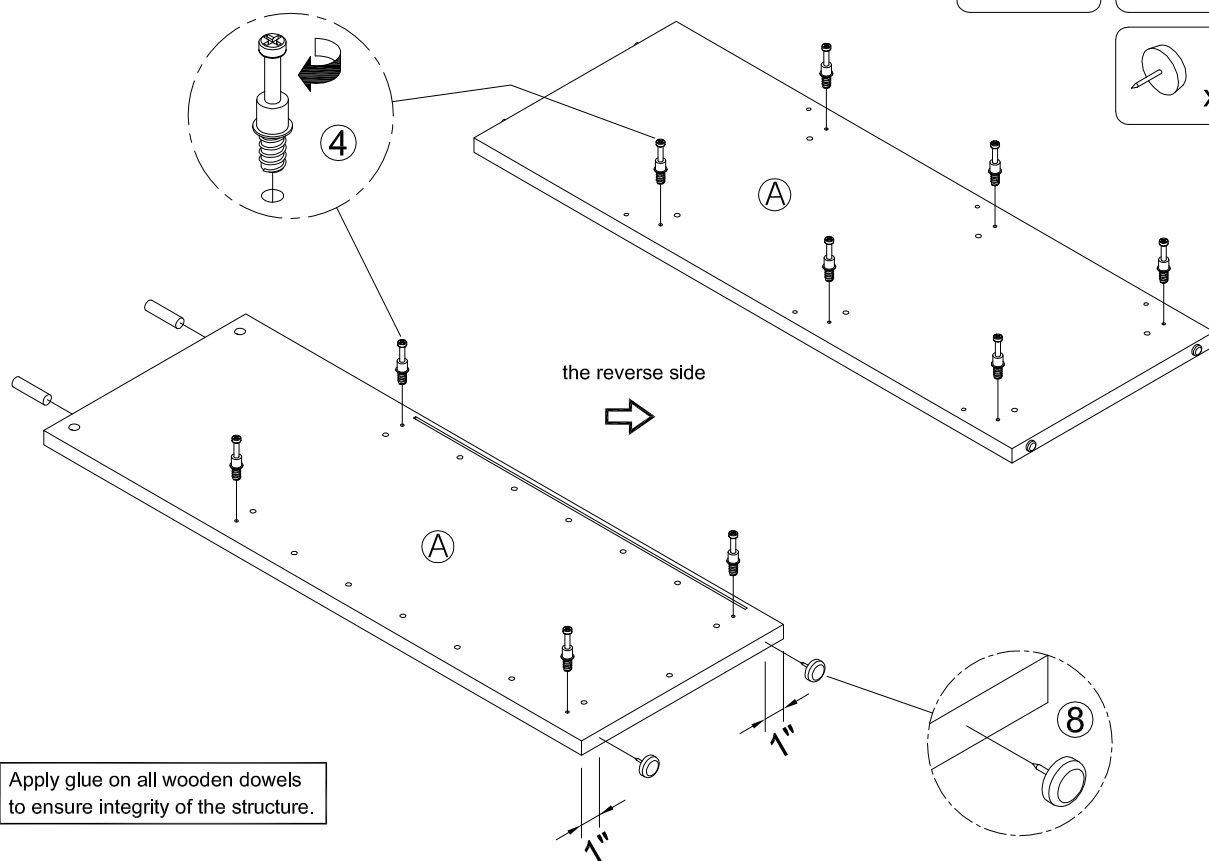
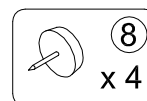
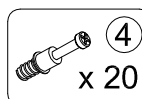
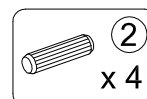

# ASSEMBLY INSTRUCTION

## STEP 6 :

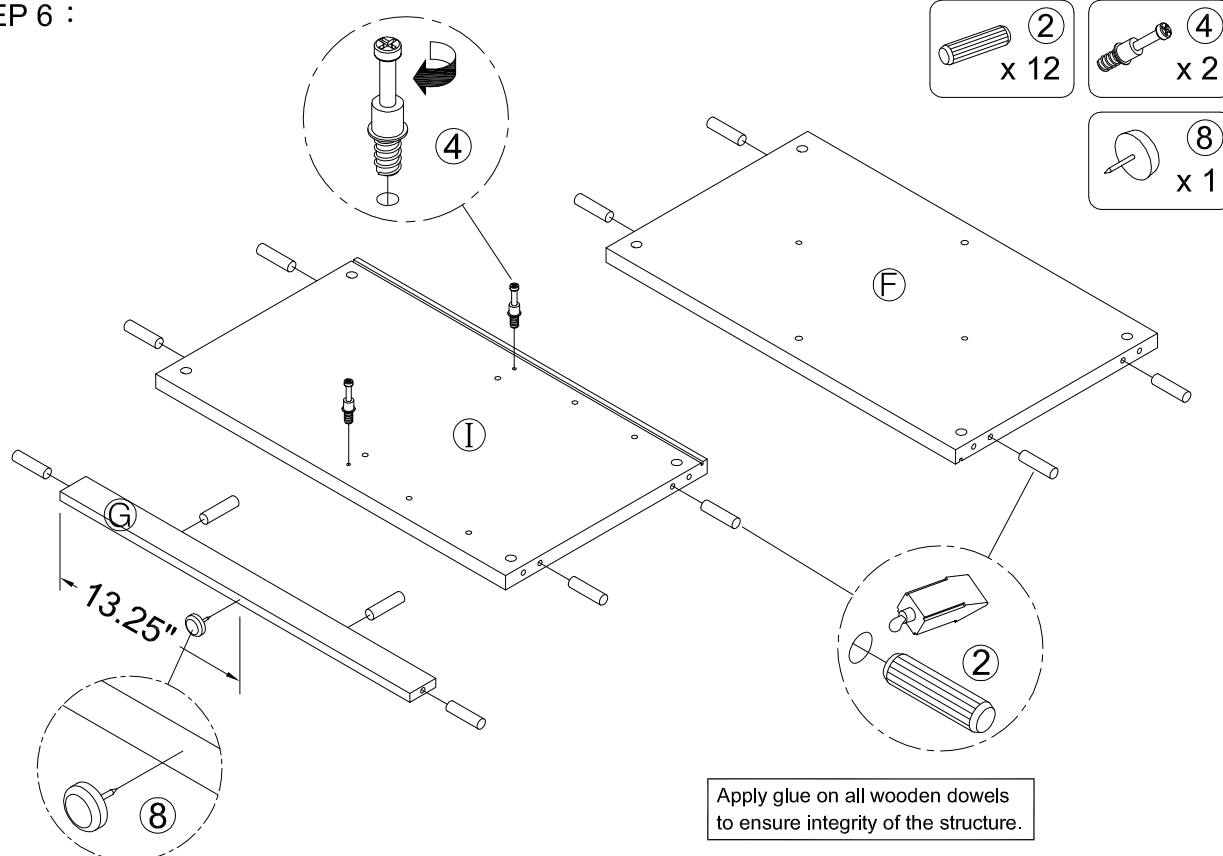

## STEP 7 :

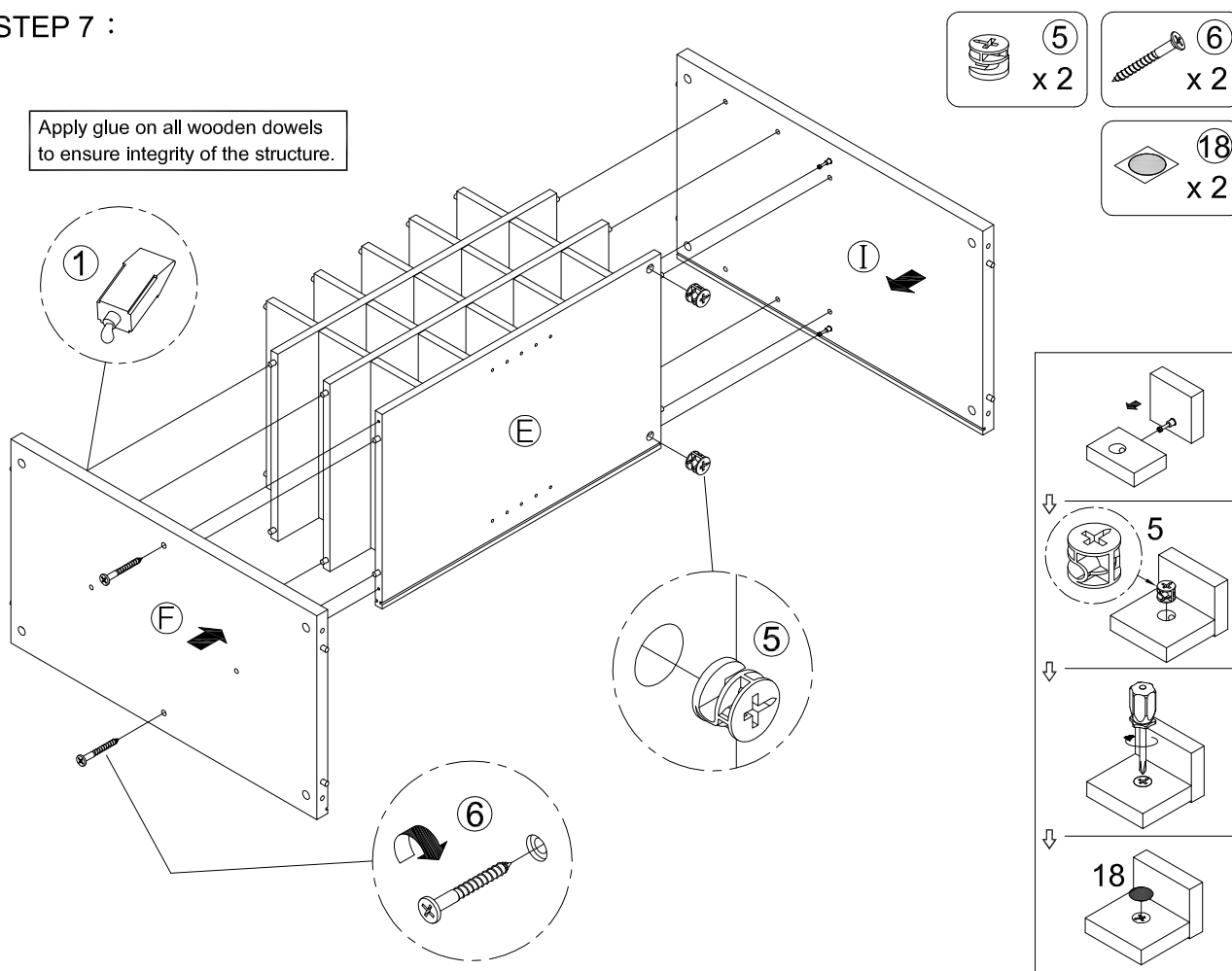

## STEP 8 :

Apply glue on all wooden dowels to ensure integrity of the structure.

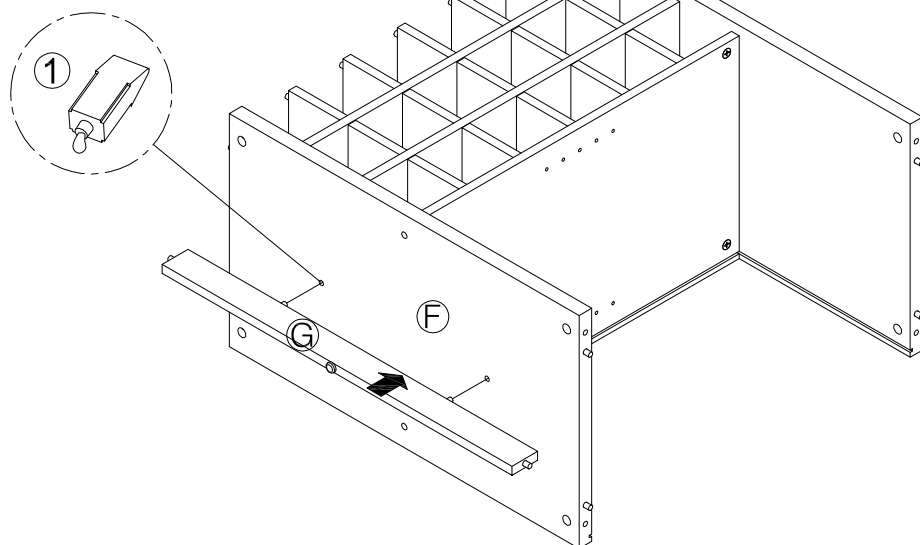

## STEP 9 :

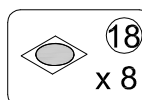
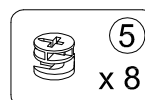

Apply glue on all wooden dowels to ensure integrity of the structure.

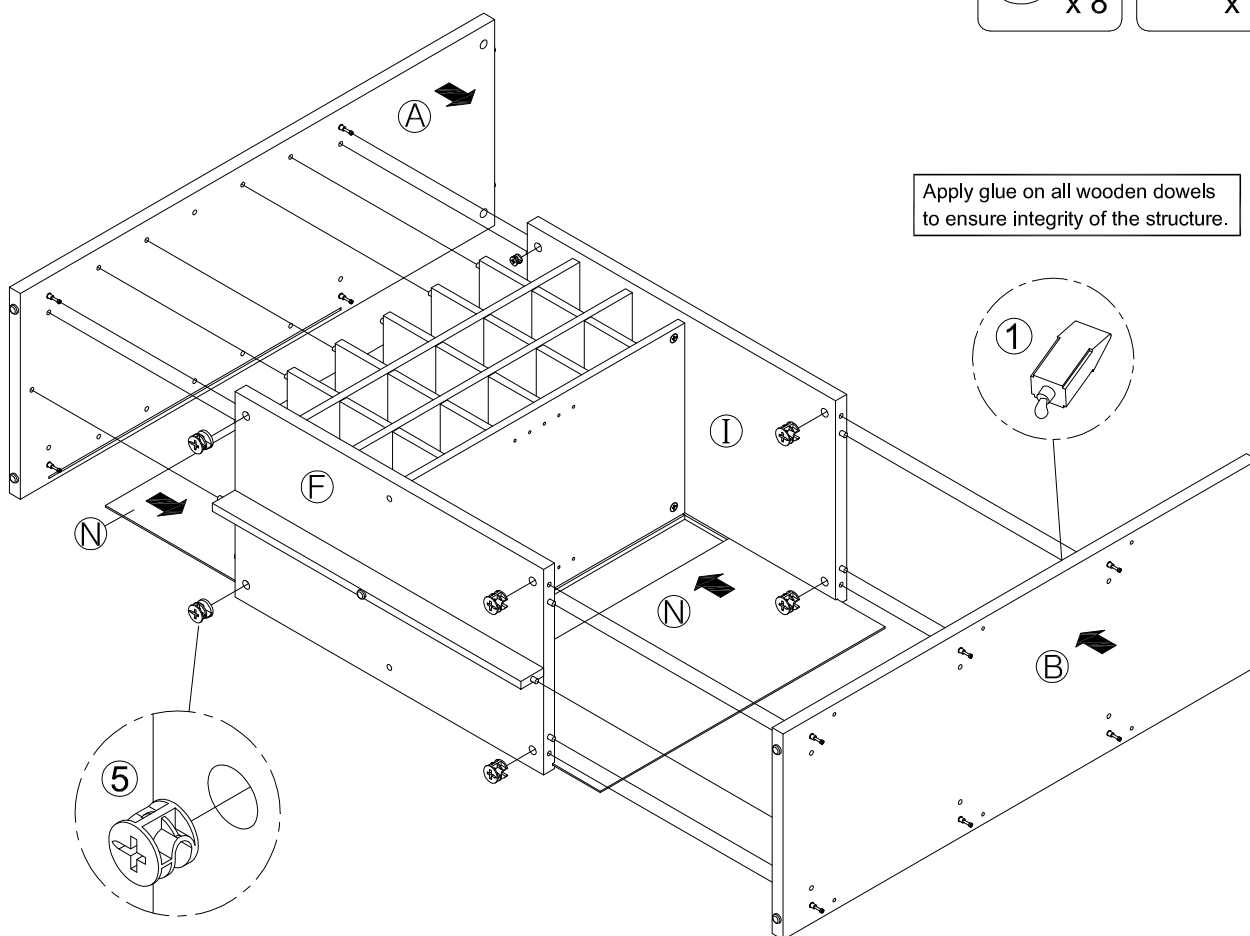



Apply glue on all wooden dowels to ensure integrity of the structure.

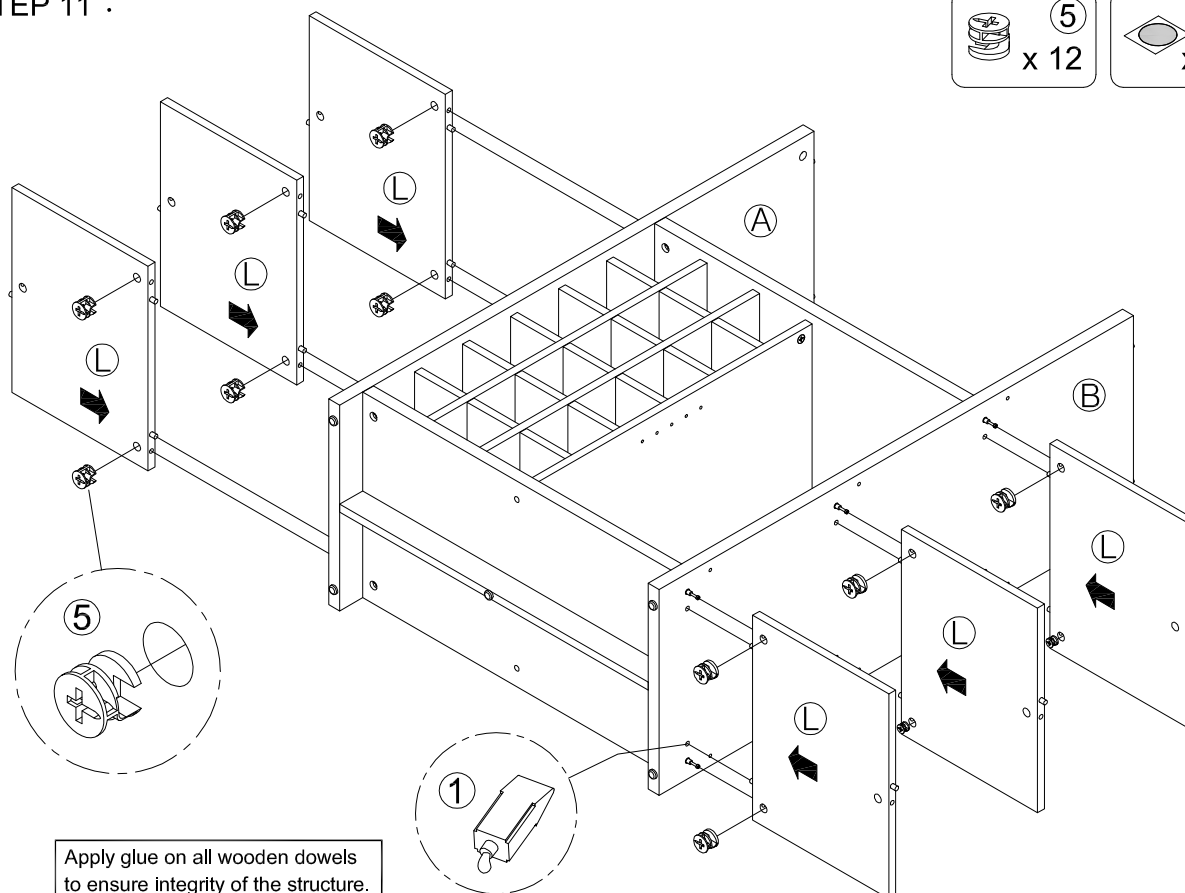
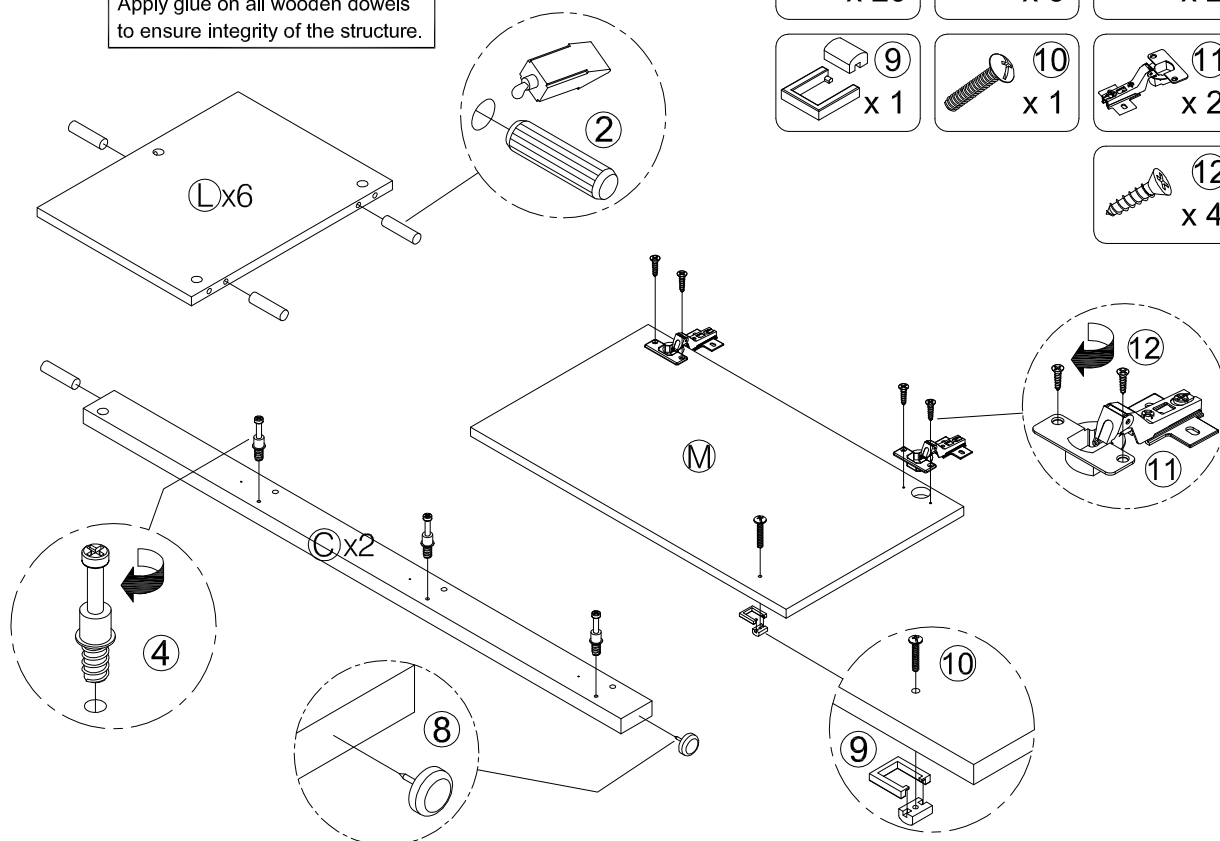

Apply glue on all wooden dowels to ensure integrity of the structure.

# ASSEMBLY INSTRUCTION

## STEP 12 :

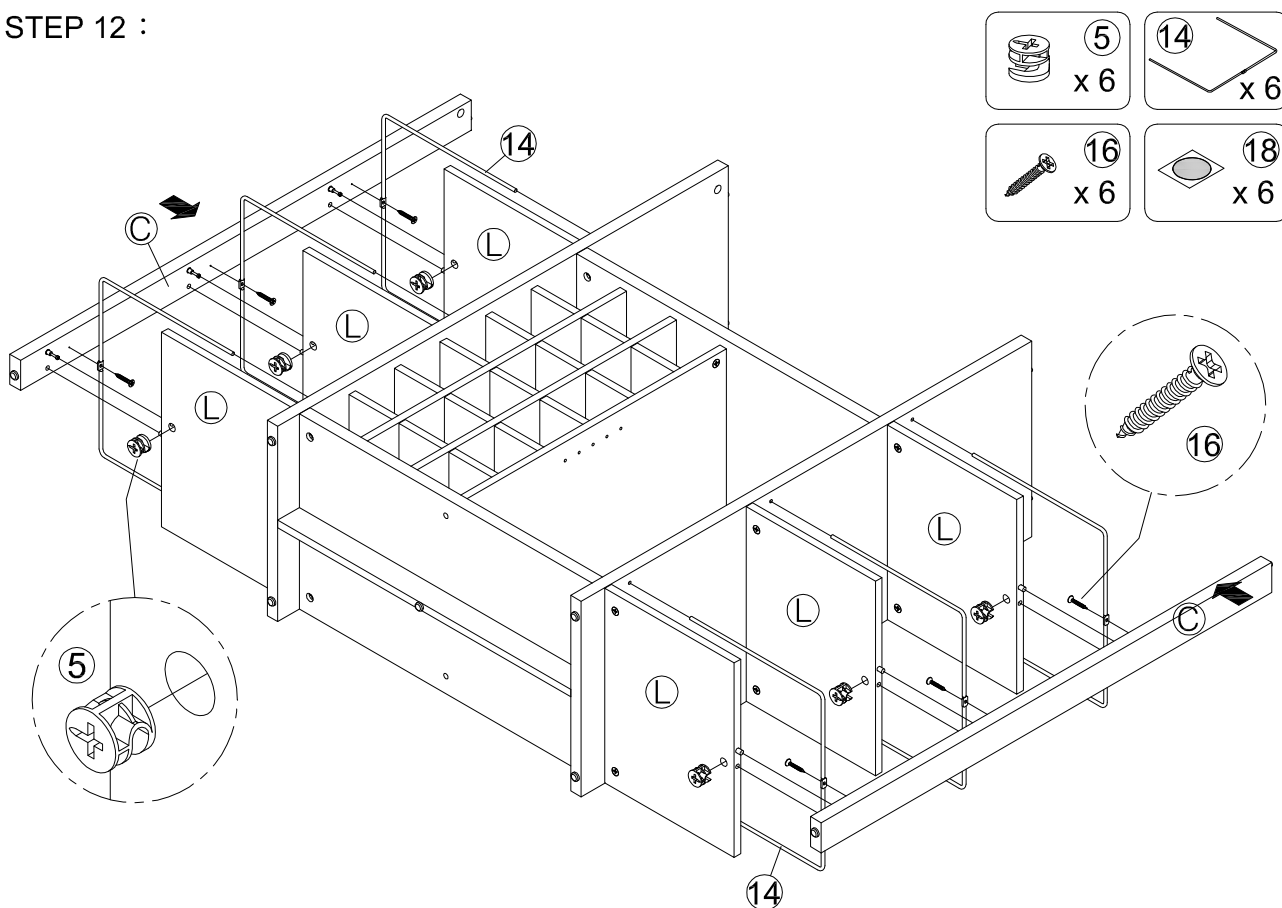

## STEP 13 :

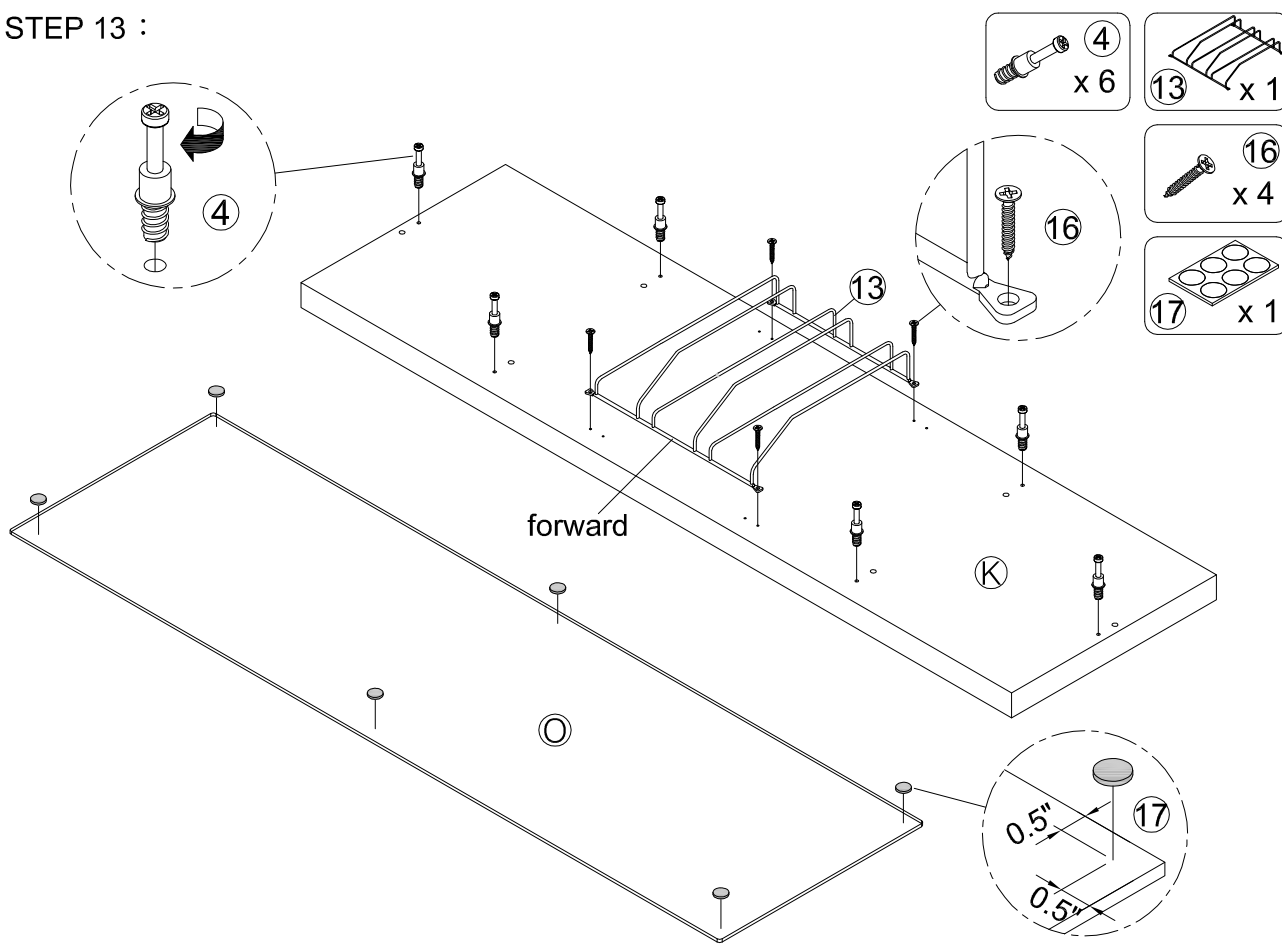

## STEP 14 :

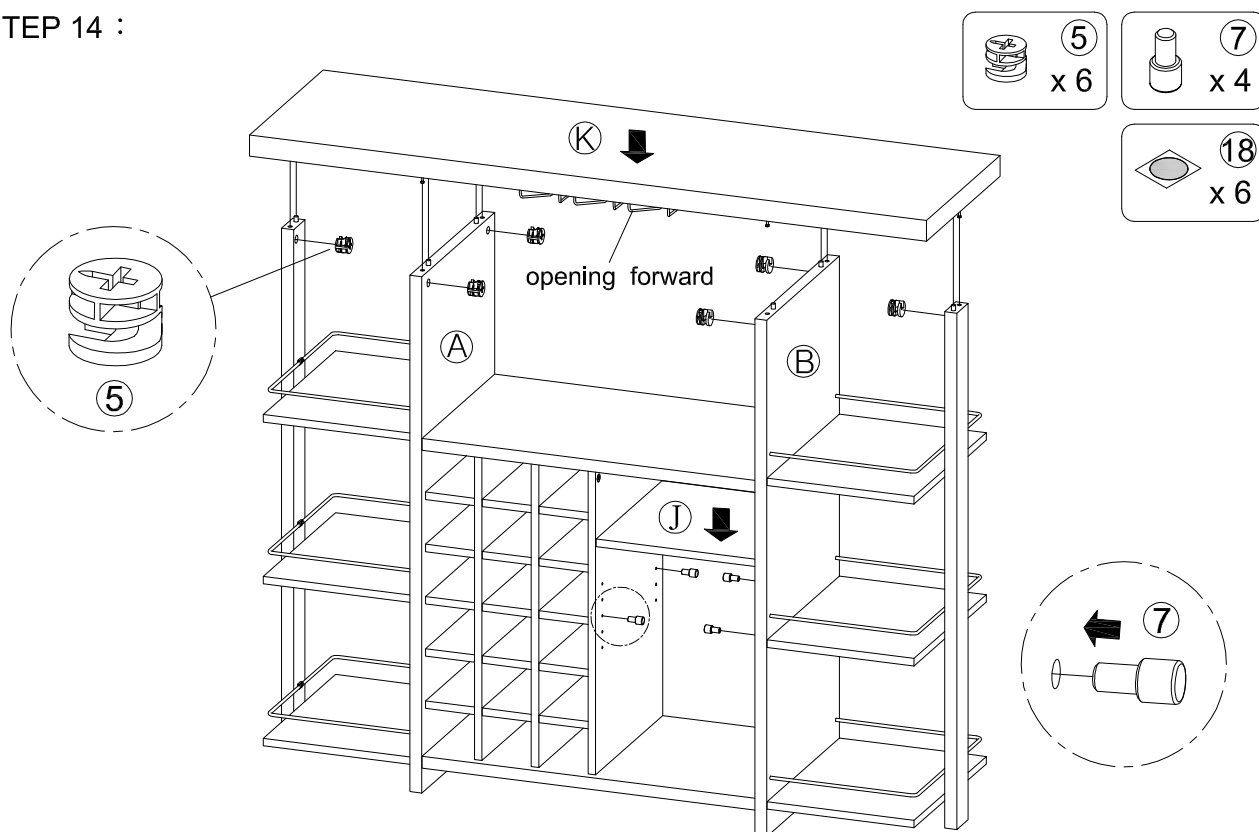

## STEP 15 :

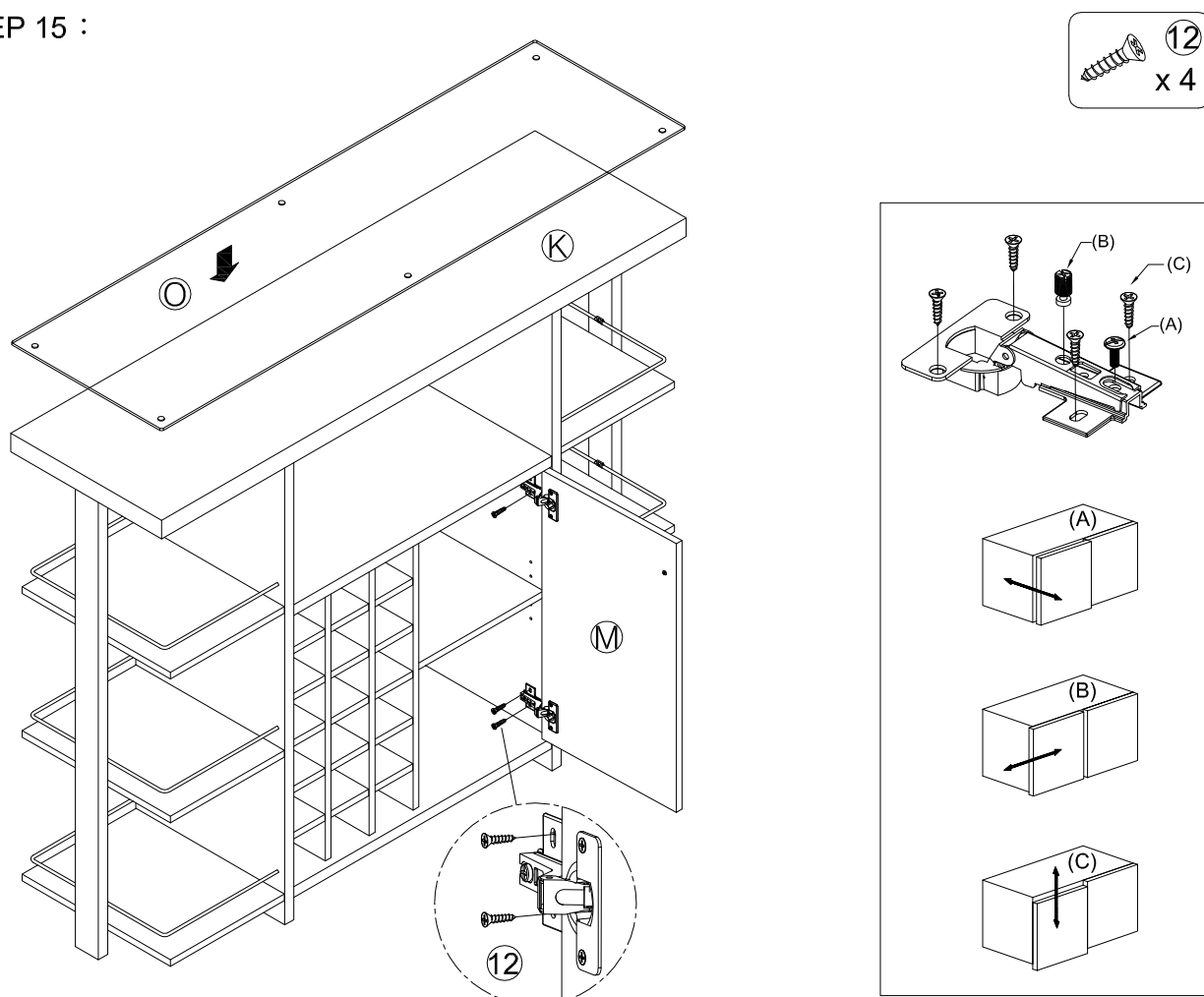

# ASSEMBLY INSTRUCTION

STEP 16 :

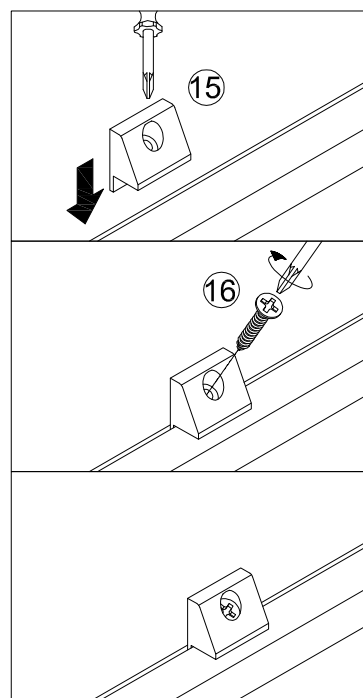
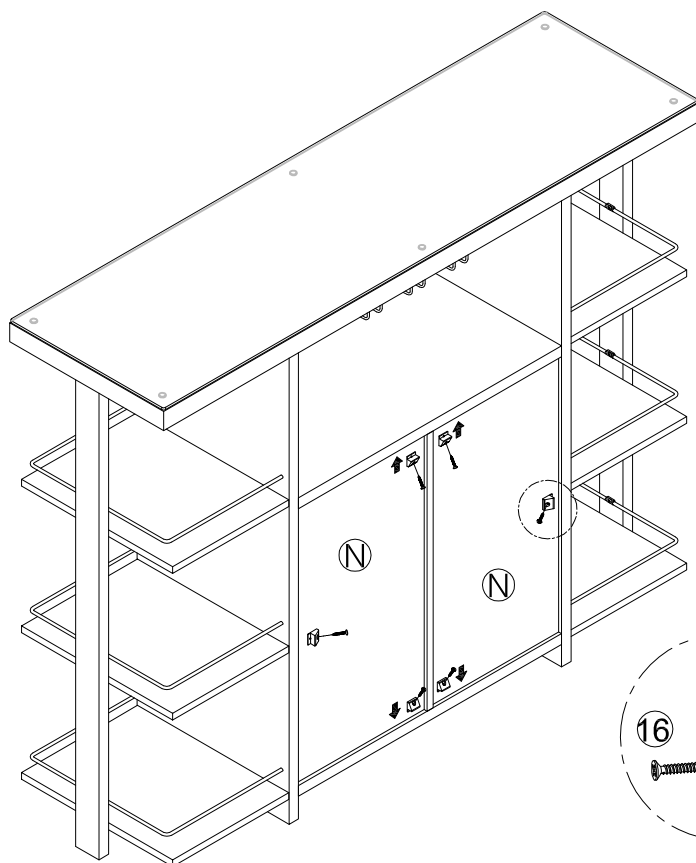
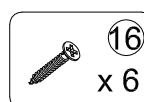
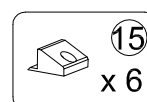

FINISH

