

Super Washer

Model: 842

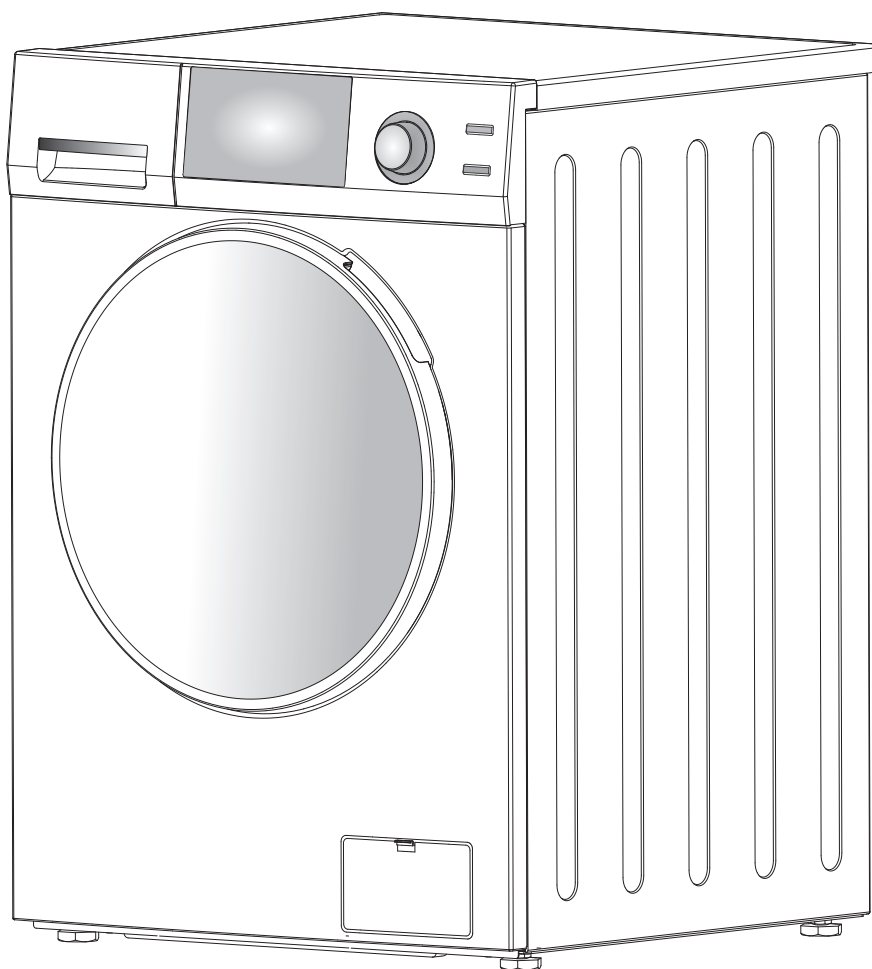

OWNER'S MANUAL

	DO NOT RETURN TO STORE!		1-800-776-3538
	HAVE QUESTIONS OR NEED SERVICE?		Service@ApplianceDesk.com

Read the instructions carefully and keep for future reference. Information maybe updated from time to time so please refer to the website for the latest version of the manual.

TABLE OF CONTENTS

Introduction.....	1
Warranty Information	2
Technical Data.....	4
Important Safety Instructions.....	5
Diagram of the Washer.....	6
Handling and Placement.....	7
Remove Shipping Bolts and Level Washer.....	8
Electrical.....	9
Plumbing.....	10
Special Installation Requirements.....	11
Operating Instructions.....	12
Program Selection Chart.....	13
Special Wash Programs.....	14
Control Panel.....	15
Display Panel.....	16
Maintenance.....	17
Troubleshooting.....	19
Error Codes.....	20

INTRODUCTION

Congratulations on your new Super Washer! In addition to its contemporary design, this is a highly sophisticated engineered product that will give you many years of satisfaction.

Here are some of the best reasons for buying your Super Washer

1. Easy Operation

This appliance is simple to use as a washer.

2. Efficient Operation

With a high spin speed of 1400 rpm, more water is extracted, resulting in shorter dry times.

3. Convenience

This appliance can be permanently installed and be made portable with the installation of the portability kit (sold separately) where needed.

4. Placement Options

The Washer's sleek design makes it a perfect appliance for any kitchen or laundry room. Its compact size makes the Washer perfect for placement on each floor of your home.

5. Better Clothing Appearance

This Washer has no agitator to damage your clothes so they look better and last longer.

6. Water Savings

This appliance uses very little water for washing and far less than a standard full size top-loading washer. A new feature introduced is automatic water level which helps in saving water as it automatically decides the water intake depending on the quantity of your clothes.

7. Energy Savings

This appliance is engineered to provide valuable energy savings when compared to other washers

8. Maintenance

Since the machine has a self-cleaning pump, this appliance needs no cleaning of lint after every washing. Instead, there is a convenient coin trap which only needs to be cleaned every few months.

9. Space Savings

The washer is of optimum size saving space around your home.

10. Add a sock

In this feature, the program can be stopped at any time to add forgotten items to the wash. Press PAUSE for 5 seconds. Door will open after draining water so that it does not overflow. Load clothes. Close door. Press the START button. Washer will continue from the point it stopped.

WARRANTY INFORMATION

Your appliance is protected by this warranty under normal, personal, family or household use for 1 Year Parts & Labor and limited commercial use (90 days) in USA and Canada.

WARRANTY

Consolidated Brands undertakes to the consumer / owner to repair or, at our option, to replace any part of this product which proves to be defective in workmanship or material under normal personal, family or household use, in USA and Canada, for a period of one year parts & labor from the date of original purchase. For commercial use, the product is warranted for a period of 90 days.

During this period, we will provide all labor and parts necessary to correct such defect, free of charge, if the appliance has been installed and operated in accordance with the written instructions provided with the appliance. Ready access to the appliance, for service, is the responsibility of the consumer / owner. If a unit is installed in a closet or cabinet, it should be removed by the consumer / owner, for access by service technicians. If this is not done, there will be an extra charge.

EXCLUSIONS

In no event shall Consolidated Brands be liable for incidental or consequential damages or for damages resulting from external causes such as abuse, operation misuse, neglect, alterations, normal wear and tear, incorrect voltage or acts of God. This warranty does not cover service calls which do not involve defective workmanship, damage due to other products while combined use with this product or materials covered by this warranty. Accordingly, diagnosis and repair costs for a service call which does not involve defective workmanship or materials will be the responsibility of the consumer / owner.

Most work is covered. The defining factor is, has the machine malfunctioned (Consolidated Brands is responsible) or has the customer omitted or done something to cause malfunction (customer is responsible). Some states do not allow the exclusion or limitation of incidental or consequential damages, so the above limitation or exclusion may not apply to you.

You can register your Warranty by either of the following methods:

1. Scan Chat-AI
 - Open Smart Phone
 - Open Camera
 - Click the Link



2. Register online at ApplianceDesk.com/Warranty

Note: QR Code is also used to obtain Product Information, Manuals and Updates

WARRANTY SERVICE

This warranty is given by:

Consolidated Brands

5006 Steffani Lane,
Houston, Texas, 77041, USA

QUESTIONS / SERVICE

Phone/Text: 1-800-776-3538

Email: Service@ApplianceDesk.com

Web: www.ApplianceDesk.com

THE FOLLOWING ARE NOT COVERED UNDER WARRANTY:

Installation

1. Non-removal of shipping bolts, causing vibration / internal damage.
2. Non-adjustment of feet to level machine, causing vibration / internal damage.
3. Not conforming to minimum space requirements for built-in installation, causing excess heat and resulting in damage to internal components.
4. Installation in a corrosive environment.
5. Incorrect water pressure i.e below 7.25 psi or above 145 psi
6. Incorrect water inlet hose installation (use only factory supplied hoses with metric threads on the L shaped side to fit water valve)

Maintenance

1. Non-cleaning of coin trap for debris, causing the unit to not drain out water and resulting in drain pump malfunction.
2. Improper maintenance (such as, but not limited to, scale build-up, freeze damage, or vent blockage).

Damage

1. Breakage of cosmetic parts e.g., door handle, knob.

Other

1. Accident, abuse or misuse.
2. Using solvents to clean the machine or wash clothes, causing damage.
3. Misapplication of this product e.g., use in a non household/commercial environment.
4. Any other cause not due to defects in materials or workmanship.
5. Problems or damage due to fires, flooding, electrical surges, freezing or any acts of God.
6. Any damage caused by poor water quality.
7. Operating the appliance with anything other than potable water at all times.
8. Force majeure.

Warranty Limitations

1. If a unit is located more than 25 miles away, there will be a trip charge.
2. If a unit is in a remote area more than 75 miles away, the machine should be taken to the technician's workshop.
3. All repairs or replacements are warranted only for the remainder of the original warranty period.
4. If a return or replacement is required, allow 3-4 weeks to process.
5. Replacement units will be delivered with curbside delivery only.
6. We may require the return of products or parts to our warranty department for which the shipping charges are to be pre-paid by the consumer / owner.
7. Charges may be incurred if warranty coverage is not applicable.
8. Service would be provided from Monday to Friday between normal business hours.

GENERAL

Since it is the responsibility of the consumer/owner to establish the warranty period by verifying the original purchase date, Consolidated Brands recommends that a receipt, delivery slip or some other appropriate payment record be kept for that purpose. This warranty gives you specific legal rights, and you may also have other rights which vary from State to State.

All rights reserved. Manual subject to change without notice.

TECHNICAL DATA

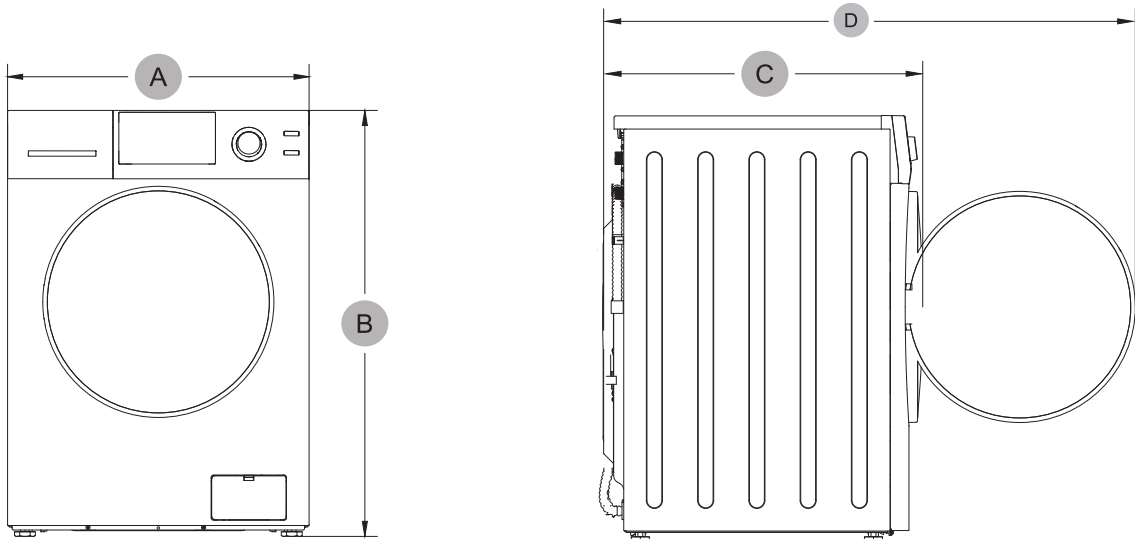

Type		Front loading washing machine
Model		842
Dimensions (inches/cm)	A. Width	23.6 / 60
	B. Height-overall	33.5 / 85
	C. Depth	24 / 615
	D. Depth with door open	41.3 / 1,035
Rated voltage		110 - 120V / 60Hz 9A
Water pressure (psi/Mpa)		7.25 - 145 / 0.05 - 1.00
Wash capacity (lb/kg)		26.0 / 12.0
Net weight (lb/kg)		163 / 74
Spin revolution (rpm)		Max. 1,400
Power consumption (W)	Washing	120
	Spin	500
	Wash heater	1,000



Intertek

4007606



Intertek

EP 5033552

ENERGY
PERFORMANCE
VERIFIED

RENDMENT
ENERGETIQUE
VERIFIE

Electrical Testing Laboratories

US N° 4007606 CANADA EP 5033552

The ETL Listed Mark is the legal equivalent to the UL and CSA Listed Marks

Note: All rights reserved.
Designs, Specifications and Manual subject to change without notice

IMPORTANT SAFETY INSTRUCTIONS

Your Washer has been built in compliance with safety regulations, to protect you and your family.

WARNING – To reduce the risk of fire, electric shock, or injury to persons when using your appliance, follow basic precautions, including the following:

1. Read all instructions before using the appliance.
2. Do not wash articles that have been previously cleaned in, washed in, or spotted with gasoline, other flammable or explosive substances, as they emit vapors that could ignite or explode.
3. Do not allow children to play on or in the appliance. Close supervision of children is necessary when the appliance is used near children.
4. Before the appliance is removed from service or discarded, remove the door.
5. Do not reach into the appliance if the tub or drum is moving.
6. Do not install or store this appliance where it will be exposed to the weather.
7. Do not tamper with controls.
8. Do not repair or replace any part of the appliance or attempt any servicing unless specifically recommended in the user-maintenance instructions or in published user-repair instructions that you understand and have skills to carry out.
9. Do not add gasoline, dry-cleaning solvents, or other flammable or explosive substances to the wash water. These substances give off vapors that could ignite or explode.
10. Under certain conditions, hydrogen gas may be produced in a hot water system that has not been used for 2 weeks or more. **HYDROGEN GAS IS EXPLOSIVE.** If the hot water system has not been used for such a period, before using the washer, turn on all hot water faucets and let the water flow from each for several minutes. This will release any accumulated Hydrogen.
11. Check the Coin Trap every few months to remove any coins, buttons or similar size objects.

California Proposition 65

WARNING: This product contains chemical known to the State of California to cause cancer and birth defects or other reproductive harm.

DIAGRAM OF THE WASHER

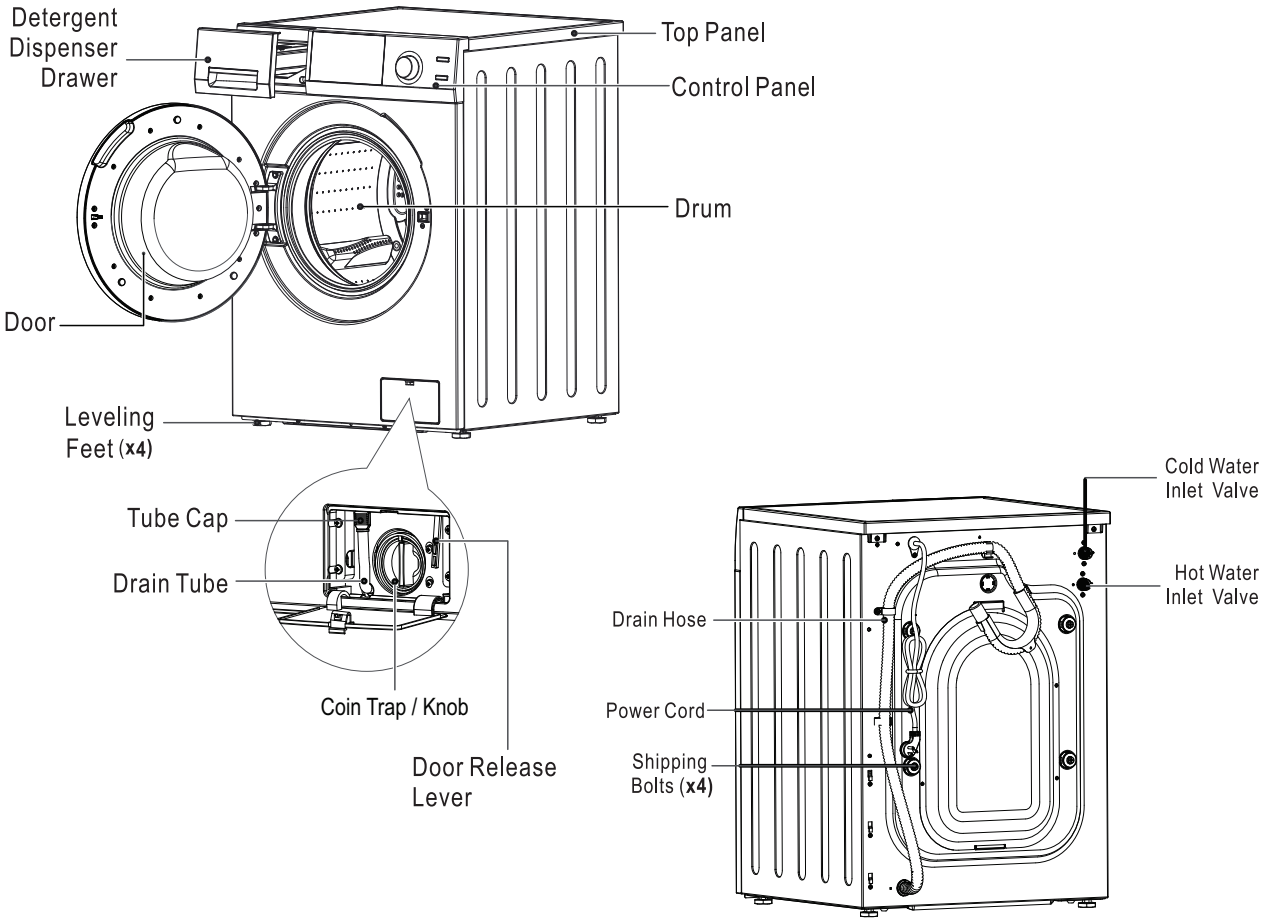

Included

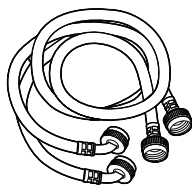

Cold/Hot water hoses(2)

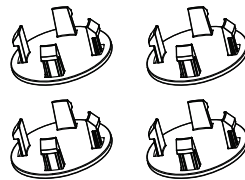

Caps for covering shipping bolts (4)

NOTE

- Contact Customer Service if any accessories are missing.
- For your safety and for extended product life, use only authorized components. The manufacturer is not responsible for product malfunction or accidents caused by the use of separately purchased unauthorized components or parts.
- The images in this manual may be different from the actual components and accessories, and are subject to change by the manufacturer without prior notice for product improvement purposes.

HANDLING AND PLACEMENT

Handling

Please handle the machine carefully and use appropriate means while lifting and moving the machine so that it does not get damaged.

- Ensure not to drag the appliance.
- Ensure not to hold on to protruding parts when lifting.

Placement

Inspect the Washer to ensure there is no damage.

Any residual moisture inside the drum is due to the final testing which every washing machine undergoes before leaving the factory. This is normal.

- Place the appliance away from direct sunlight, sources of heat and high humidity, and also away from areas of moisture and exposure to cold temperatures.
- Ensure the appliance is placed in a well-ventilated and dry environment.
- Ensure that the appliance is placed on flat and stable ground. Adjust the 4 feet to make it level.

Disposal

All packaging materials are recyclable.



Please dispose of packing material and your old appliance in accordance with local regulations.

DANGER

Suffocation from plastic and folding cartons.

Keep children away from the shipping carton and packing material.

Before discarding the appliance, remove the door in order to prevent risk of child entrapment.

 CAUTION 	The model number and the serial number are on the label affixed to the back of the unit. These numbers are also available on the front of the cabinet behind the door.
RISK OF ELECTRIC SHOCK DO NOT OPEN	You should note the model and serial numbers of this unit in the space provided. Retain this booklet as a permanent record of your purchase to aid in identification in the event of theft.
CAUTION: TO REDUCE THE RISK OF ELECTRIC SHOCK, DO NOT REMOVE COVER (OR BACK). NO USER SERVICEABLE PARTS INSIDE. REFER SERVICING TO QUALIFIED SERVICE PROFESSIONALS.	MODEL# _____ SERIAL# _____

REMOVE SHIPPING BOLTS AND LEVEL

The free-floating drum inside the Combo is held in place during transport with 4 shipping bolts. (Fig. 1.)
Remove each shipping bolt along with the retainer, bush and washer. (Fig. 2.)

Failure to remove shipping bolts may cause severe vibration, noise and can lead to permanent damage to the machine. IT WILL ALSO VOID THE WARRANTY.

Store all these parts for future use when moving the Combo to a new location. (Fig. 3.)

DO NOT transport the machine without reinstalling the shipping bolts.

Close the holes left open by the bolts with the caps provided (Fig. 4).

It is important for the machine to be perfectly level. For this reason, the machine is fitted with adjustable feet used for leveling the machine before use (Fig. 5.)

An adjustable wrench or 17mm open end wrench is required to loosen or tighten the leveling feet.

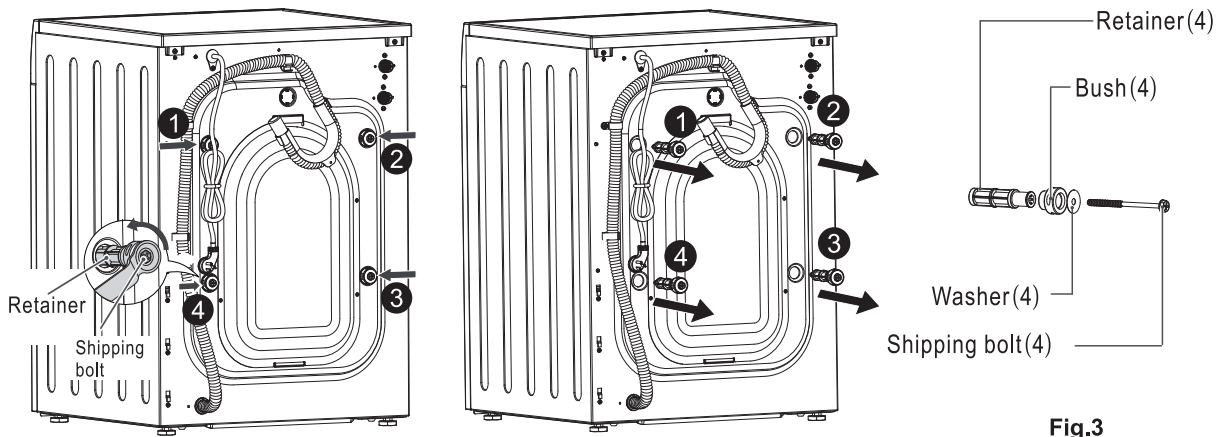

Fig.1

Fig.2

Fig.3

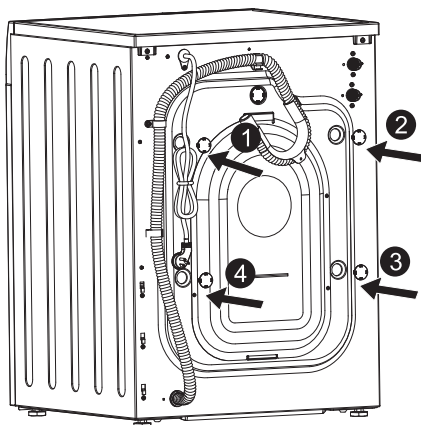

Fig.4

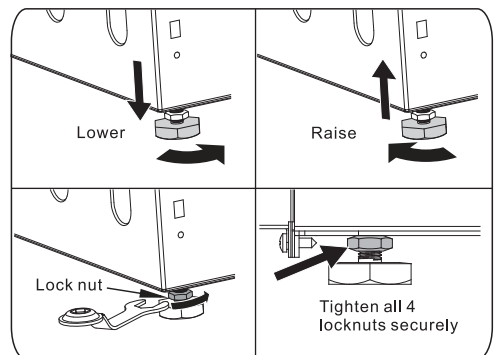

Fig.5

ELECTRICAL

CONNECTION

Connect the plug to a power outlet - 110V / 60Hz with minimum 15 Amps. Make sure that the voltage and frequency available correspond with those stated on the serial number plate located on the machine. Do not use adaptors or extension cords since they could result in overheating and burn out. It should **not** be controlled by a wall switch or pull cord which might be turned off accidentally.

POWER SUPPLY

This Super Washer must be connected to an individual circuit identical to the one specified on the rating plate of the loading port protected by fuses or circuit breaker conforming to local codes.

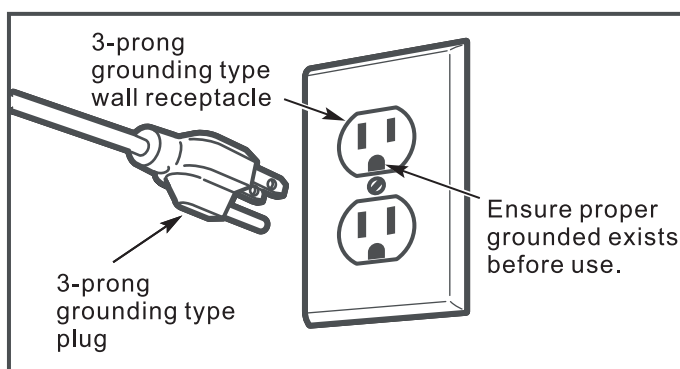

GROUNDING

This appliance must be grounded. In the event of malfunction or breakdown, grounding will reduce the risk of electric shock by providing a path of least resistance for electric current. This appliance is equipped with a power cord having an equipment-grounding conductor and a grounding plug. The plug must be plugged into an appropriate outlet that is properly installed and grounded in accordance with all local codes and ordinances.

WARNINGS

- Improper connection of the equipment-grounding conductor can result in a risk of electric shock. Check with a qualified or service representative or personnel if you are in doubt as to whether the appliance is properly grounded.
- Do not modify the plug provided with the appliance: if it will not fit the outlet, have a proper outlet installed by a qualified electrician.

Note: If the electrical power supply does not meet the specifications listed above, please call a licensed electrician.

PLUMBING

ONLY USE THE WATER INLET HOSES THAT COME WITH THE MACHINE.

Reason: They are custom hoses. The L-Shaped side uses metric thread to fit the valve and the straight side uses US pipe (NPT) thread. *Replacement hoses will not fit the metric thread and will leak.*

CONNECTING TO THE WATER FAUCET

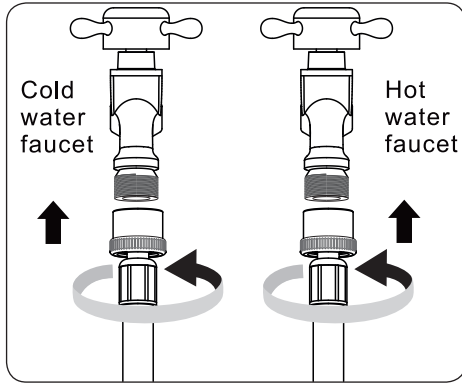

Fig.6

To connect the hoses to the water faucets:

- Connect the straight end of each hose to the cold or hot faucet.
- Turn the fittings by hand until they are tight, and then tighten them by just an additional two-thirds of a turn with a plier. Do not overtighten the fittings. They can be damaged.
- When done, pull the water hoses up and down to check if they are properly connected.

CONNECTING TO THE MACHINE

To connect the hoses to the machine:

- Connect the L-shaped end of each hose to the cold or hot water valve on the rear of machine.
- Open both the faucets, and check if there is a leak.

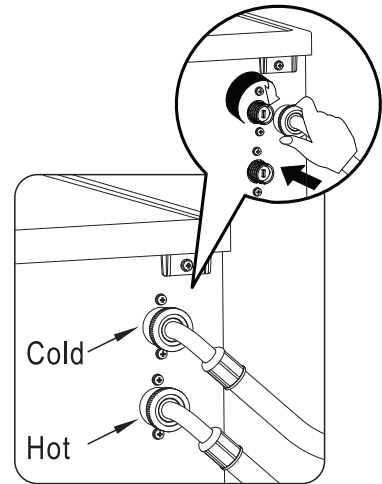

Fig.7

CONNECTING THE DRAIN HOSE

Connect the standpipe to a drain duct (with internal diameter of at least 1.6 inches) or place it for drainage in to a sink or a tub, ensuring that there are no kinks or bends. The free end must be at a height of 24"-40" from the floor. The hose can be held in place using the white plastic clamp on the upper part of the back panel.

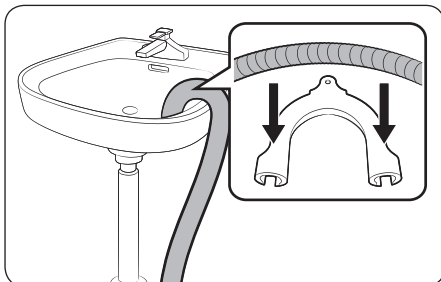

Fig.8

Height difference between the installation location of the washing machine and the drainage point:

Minimum 24", and Maximum 40".

- Attach water drain hose to hose guide.
- Hook the hose guide over the side or standpipe (Fig.8).
- When the water is being drained, check that the water flow out of the hose is adequate.

SPECIAL INSTALLATION REQUIREMENTS

MINIMUM CLEARANCE OTHER THAN ALCOVE OR CLOSET INSTALATION

Minimum clearances to combustible surfaces: 2" (5 cm) clearance both sides and 3" (7.5 cm) rear.

BUILT-IN, RECESSED, CLOSET AND ALCOVE INSTALLATION

The Super Washer may be installed in a built-in, recessed area, closet or alcove.

The installation spacing is in inches and is the minimum acceptable.

Other installations must use the minimum dimensions indicated.

Minimum clearance between dryer cabinet and adjacent walls are: 2" either side and 3" front and rear.

Minimum vertical space from floor to overhead cabinets, etc. is 52" (132 cm).

Closet door must be louvered or otherwise ventilated and must contain a minimum of 60 sq. in. of open area equally distributed. If this closet contains both washer and a dryer, doors must contain a minimum 120 sq. in. of open area equally distributed.

No other fuel-burning appliance shall be installed in the same closet with dryer.

★ Additional clearances for wall, door and floor molding may be required.

NOTE: If a door is installed that potentially encloses the unit while running, the door must allow for a minimum of 20 sq. in. of air free movement. There must also be a 1" additional space in front of the unit to the closed door and 1" from the back of the unit to the wall. Additional spacing should be considered for easy installation, servicing and compliance with all applicable local, state and federal codes.

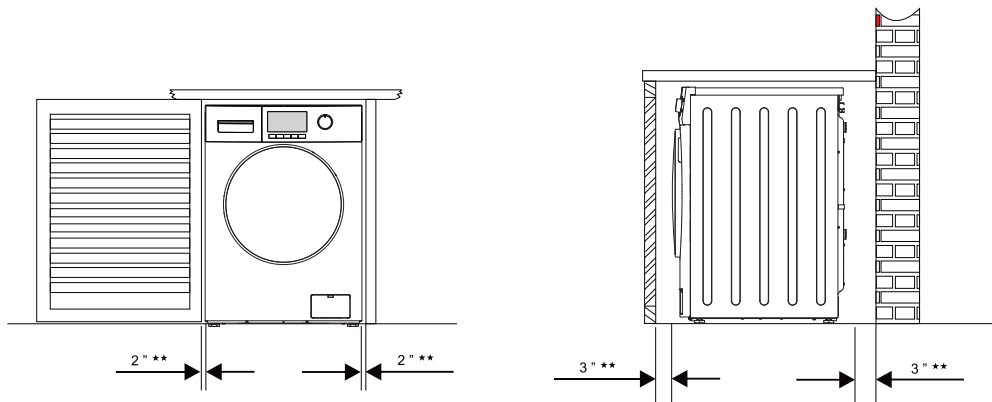

Fig. 9

ADA COMPLIANCE

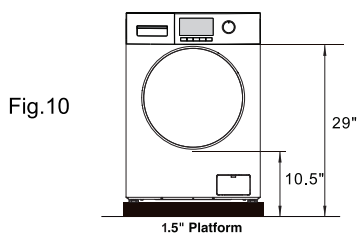

Fig.10

Use 1.5" height platform to make the machine ADA compliant.

OPERATING INSTRUCTIONS

1. Ensure the Washer is turned off. (Power Indicator light should be off).
2. Separate clothes by type, color and degree of soiling.
3. For small items such as socks and children's clothes please use a mesh bag.
4. Load clothes of the selected type loosely into the drum. Ensure to put in a full load of clothes.
5. Close the Washer door. You will hear a click when it is correctly closed.

Use High Efficiency (HE) detergent about 1 table spoon.

Add detergent to Dispenser A,

You can add fabric softener and pre-wash detergent as shown in the diagram to compartment B & C.

Note: The washer is designed to be used with a full and balanced load. If a small or half load of clothes is put in the washer, it will be unbalanced causing the drum to rotate slowly during the spin cycle and will not extract sufficient water. This will result in wet clothes at the end of the cycle and will not be ready to put in the dryer.

Detergent Dispenser

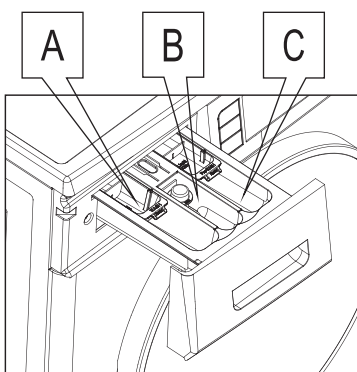

Fig. 11

Dispenser A:
Detergent for main wash

Dispenser B:
Fabric Softener

Dispenser C:
Detergent for pre-wash and bleach

**The blue cups are only for liquid detergent.
Please do not add powder in these cups.**

Note : concentrated fabric softener must be diluted with a little water before being poured into the dispenser
(This prevents the over flow siphon from getting blocked)

Your washer is designed to use a High Efficiency (HE) detergent, which reduces or eliminates suds and results in more efficient washing.



WINTERIZING

How to winterize for cold weather

- 1) Pour 2 cups of RV type Antifreeze in soap dispenser.
- 2) Select WINTERIZE cycle on knob and press START. Machine will Rinse & Spin.
- 3) Open coin trap once cycle is finished and drain out remaining water.
- 4) Shut off water at both faucets and disconnect water inlet hoses from faucets and drain.

PROGRAM SELECTION CHART

WASH CYCLES

Each wash program has default temperature, spin speed and rinse settings. You can use the buttons on the control panel to changes the defaults for most of the programs.

Wash Programs	Description of Load	Wash Temperature	Spin Speed (rpm)	Display Time min
1. NORMAL	Mixed Clothes (Shirts, Trousers, etc)	Warm	1200	51
2. Prewash + Heavy	Thick Cottons (T-Shirt, Jeans)	Cold+Hot	1400	75
3. Heavy	Mixed Cottons (T-Shirt, Jeans)	Hot	1400	51
4. ECO	Cotton Blends, Light Fabrics	Cold	800	31
5. Quick 20	Cotton Blends, Light Fabrics	Cold	1200	20
6. Baby	Light Fabrics	Warm	800	41
7. Delicate	Silk, Polyester etc	Cold	800	36
8. Wool	Woolens	Cold	500	36
9. Quiet 60	Mixed Cottons	Cold	800	31
10. Sanitize 165°	Bed Sheets etc	Hot	1200	69
11. Allergen 131°	Mixed Cottons	Hot	1200	59
12. PET Cycle	Mixed Cottons	Cold	1200	46

PET CYCLE

Before loading clothes and sheets into the appliance, remove as much pet hair as possible in order to prevent buildup and clogging of the drain pump. Wipe the surface of clothes and sheets with a lint roller or a damp rubber glove to easily remove pet hair.

After the end of the wash cycle, run a quick wash cycle without clothes. After the cycle ends, wipe down the drum with a damp cloth to collect any pet hair on the drum surface.

OTHER CYCLES:

Spin only- 12 minutes Spin cycle at Max. 1,000 RPM.

Self clean - 40 minutes cycle at 90° to clean the inner drum and tub of the machine.

Rinse/Spin - 15 minutes rinse cycle and a spin cycle.

Winterize - 2 minutes cycle to winterize your appliance.

 **The total working time will vary with the laundry size, water pressure, water temperature and ambient temperature etc.**

SPECIAL WASH PROGRAMS

PROGRAM	PURPOSE	HOW IT WORKS
ECO	Energy-efficient wash using less water and power for everyday cleaning.	Uses lower wash and rinse temperatures, longer cycle times, and optimized drum motions to reduce power use.
Heavy	Deep cleaning for heavily soiled items.	Uses higher water levels, stronger agitation, and hotter water. May include an extra rinse or pre-wash.
Quiet 60'	Minimize noise during operation.	Reduces spin speed and slows drum movement to lower vibration and sound.
Sanitize 160°	Kills germs, bacteria, and allergens.	Heats water to very high temperatures (up to ~160 - 170°F / 70-75°C).
PET Cycle*	Remove pet hair and odors. (See instructions below)	Uses extra rinse cycles, higher water levels, and sometimes soak to loosen fur and dander.
Self Clean	Cleans the washer drum itself.	Runs hot with extra water and strong agitation (empty). Some machines suggest adding a cleaning tablet or vinegar.
Allergen 131°	Reduce common allergens like dust mites and pollen.	Uses high-temperature water and an extended wash cycle to break down and flush away allergens.
Winterize	Prepare the machine for cold weather or storage (to prevent freezing damage).	Drains all water from the hoses, pump, and internal parts. Some versions circulate antifreeze through the system.
Baby Wash	Gently but thoroughly clean baby clothes, while removing detergent residues and germs.	<ul style="list-style-type: none"> • Uses higher water temperatures (often around 140-160°F / 60-70°C) to sanitize fabrics and kill bacteria. • Includes extra rinse cycles to ensure no detergent residue remains - important for babies sensitive skin. • Gentle drum movements protect delicate fabrics like cotton and soft baby wear.

CONTROL PANEL

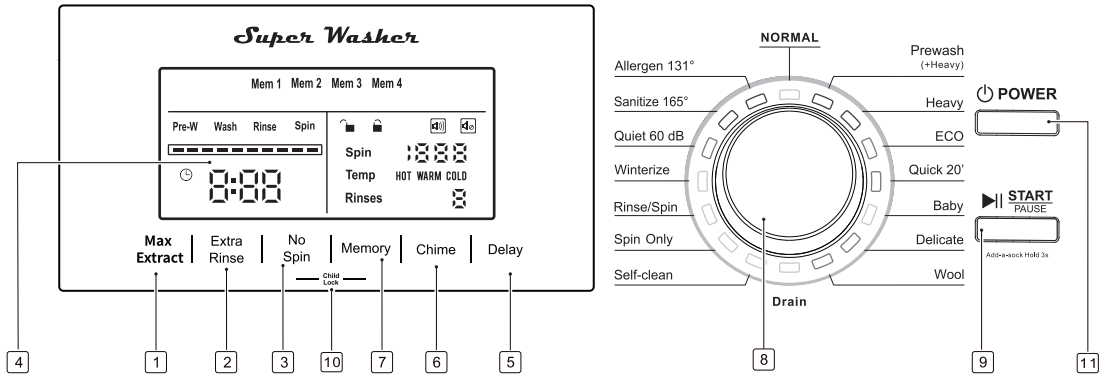

1	Max Extract	To extend the duration of final spin cycle by 30%.
2	Extra Rinse	Press this selection button to add one more rinse cycle to the selected washing program.
3	No Spin	Press this selection button to add a special function to the selected washing program. This function will keep the laundry in the rinse water after the last rinse cycle is finished. Press this button again, it will drain out the water, and step into last spin cycle.
4	Color LED Display	To display the selected program, such as the water selection, spin speed, remaining time, rinse times, water level and error messages.
5	Delay Start button	Press this button to select the delay time from 1 to 24 hours in one hour increments before the wash cycle started. If a change is to be made after the delay start time is set, turn the dial to other point, then select your desired program again.
6	Chime button	Press this button to turn on, or turn off the chime before you start the washing cycle.
7	Memory button	Press this button to select one of the four positions, then select the additional options for your favorite washing cycles, then press Start/Pause button to run this program, and this program will be memorized. If you want to run the memorized program later, press this button to select one of them, then press Start/Pause button. Press Start/Pause button to cancel the Memory operation.
8	Program Dial	Turn dial to point to one of the 16 programs depending on the load to turn the unit on.
9	Start/Pause button	Press this button to start or interrupt the selected wash program, or to view the program during a cycle.
10	Child Lock	In order to deactivate function to the controls, to prevent altering cycle, press and hold No spin and Memory buttons for 5 seconds
11	Power	Press this button to turn the machine on. Or hold down this button to turn it off.

DISPLAY PANEL

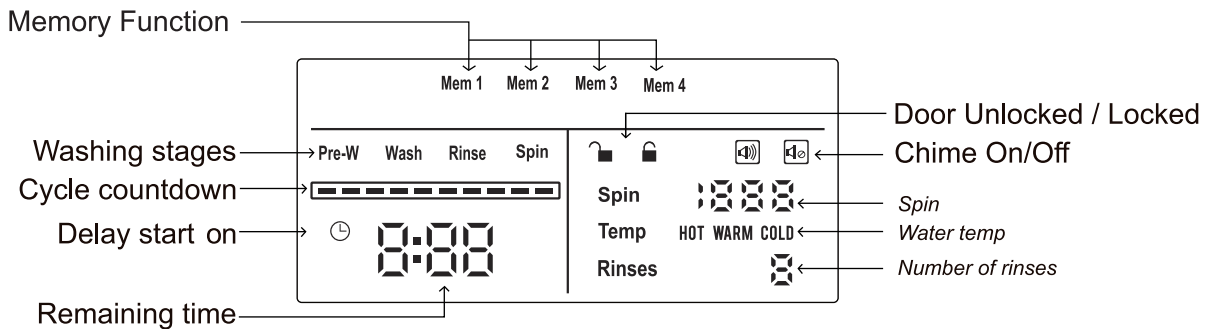

How to Run Wash Cycle

1. Press POWER button
2. Press START

Default cycle is DAILY - If required, you can change to desired washing cycle based type of clothes by rotating the Program Dial knob.

How to stop the wash cycle

- The wash program can be stopped at any time.
- Press START/PAUSE, rotate the knob to another program to cancel the current selected program.
- Press POWER button for 3 seconds to turn off the machine.

How to turn on the display in energy saving mode



- Machine display gets turns off automatically during operations to save energy.
- Press any button to turn the display during this energy saving mode.

Add-a-sock Feature

The wash program can be stopped at any time to add forgotten items to the laundry.

- Press START/PAUSE for 5 seconds.
- Door will open after draining water so that it does not overflow.
- Load clothes. Close the door.
- Press START The cycle will continue from the point it stopped.

Understanding the door lock function

Pressing the START button  will lock the door  → . The wash cycle will start and will continue until the whole program is completed. The door will be locked and cannot be opened until the wash cycle ends. Please do not try to force the door open.

Breakage of the door handle is not covered by warranty.

MAINTENANCE

General Cleaning

Clean the outside and inside of the appliance regularly, including the door gasket, using water, mild detergent and a soft cloth. Please do not use strong chemicals and abrasive materials to clean.

Cleaning the coin trap

- Turn off the Washer.
- Open the service flap, (bottom right corner) (Fig. 12)
- Turn knob to the left. (Fig.13)
- Remove foreign objects/fluff from inside and clean the interior. (Fig.14)
- The pump impeller wheel located behind the water filter, must be able to rotate. Remove detergent residue and fluff from the pump cover thread and pump housing.
- Insert the coin-trap cover and screw tight, close the service flap. (Fig.15)

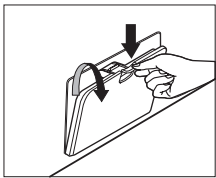

Fig. 12

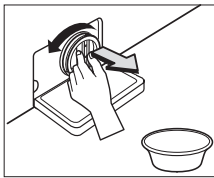

Fig. 13

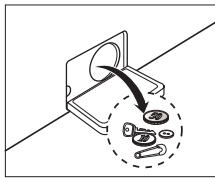

Fig. 14

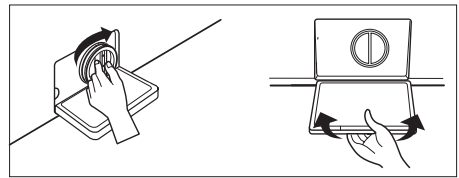

Fig. 15

Cleaning the Detergent drawers

- Press release lever on the inside of the drawer and pull it out. (Fig.16)
- Remove the cap from the Fabric Softener compartment.
- Clean the drawer recess with a bristle brush. (Fig.17, Fig.18)
- Reinsert the cap (Pushing it firmly into place).
- Push the drawer back into place.
- Run a rinse program without any laundry in the drum.

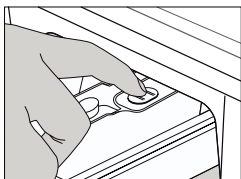

Fig.16

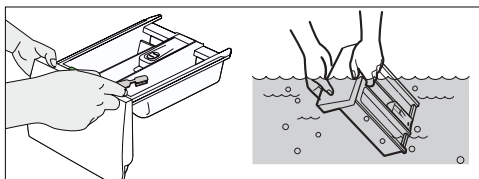

Fig.17

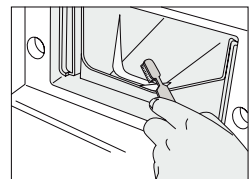

Fig.18

Cleaning the water inlet filter

- Turn off the water tap. (Fig.19)
- Unscrew the water inlet hose. (Fig. 20)
- Clean the filter using a hard bristle brush under the running water. (Fig. 21)
- Insert the filter into the valve and tighten up the inlet hose. (Fig. 22)

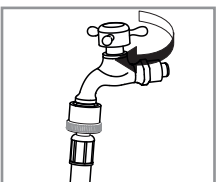

Fig.19

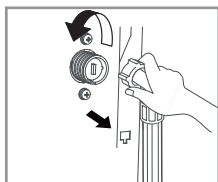

Fig. 20

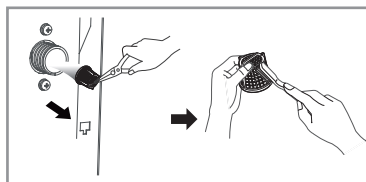

Fig. 21

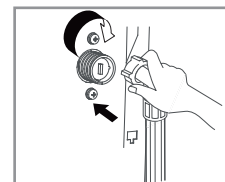
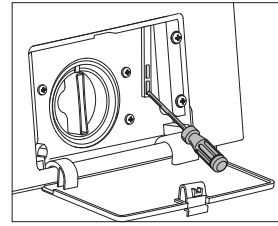

Fig. 22

Emergency Release

If the Washer door is locked and clothes need to be removed, follow this procedure:

- Open the service flap.
- Drain the remaining water.
- Pull down the emergency release lever with a tool and release.
- Door can then be opened.
- Close the service flap.



The dangers of freezing

If the machine is exposed to freezing temperatures, certain precautions should be taken.

- Turn off the water tap.
- Unscrew the inlet hose.
- Unhook the drain hose.
- Pull forward the drain hose and the inlet hose in a bowl placed on the floor, and let the water drain out.
- Screw the water inlet hose back on and reposition the drain hose.

Vacation

If the Washer is not going to be used for an extended time, ensure that the door is left open to prevent mold and odors.

TROUBLESHOOTING

In most cases, when your Super Washer fails to work, the problems arising can be easily solved without having to call for a technician. Before calling for assistance, always check these points.

Problem	Solution
Will not start	<ul style="list-style-type: none"> • Make sure the door is firmly closed. E -1 • Make sure your Washer - Dryer is plugged in. • Make sure the water source faucet (s) are open. • Make sure to press the Start/Pause Button to start your Washer. • Make sure the Child Lock is not activated. • Before your machine starts to fill, it will make a series of clicking noises to check the door lock. • Check the fuse or reset the circuit breaker.
Has no water or not enough water	<ul style="list-style-type: none"> • Turn faucet (s) on fully. E -3 • Make sure the door is tightly closed. • Straighten the water inlet hose (s). • Disconnect hoses and clean filters. Hose filter screens may be clogged. • Open and close the door, then press the Start/Pause Button.
Vibrates or is too noisy	<ul style="list-style-type: none"> • Make sure your machine is set on a level surface. If the surface is not level, adjust your machine feet to level the appliance. • Make sure that the shipping bolts / rods are removed. • Make sure your machine is not touching any other object. • Make sure the laundry load is balanced.
Stops	<ul style="list-style-type: none"> • Plug the power cord into a live electrical outlet. • Check the fuse or reset the circuit breaker. • Close the door and press the Start/Pause Button to start your machine. • For your safety, your machine will not tumble or spin unless the door is closed. • Before your machine starts to fill, it will make a series of clicking noises to check the door lock. • There may be a pause or soak period in the cycle. Wait briefly and it may start. • Check the filters on the inlet hoses at the faucets for obstructions. • Clean the filters periodically.
Door locked or will not open	<ul style="list-style-type: none"> • Press the Start/Pause Button to stop your machine. • Your machine door will remain locked before the water temperature cool down to 55°C. • It may take a few moments for the door lock mechanism to disengage.
Does not drain and/or spin	<ul style="list-style-type: none"> • Check the fuse or reset the circuit breaker. E -2 • Straighten the drain hoses. Eliminate kinked hoses. If there is a drain restriction, call for service. • Close the door and press the Start/Pause Button. For your safety, your Washer will not tumble or spin unless the door is closed.
Fills with the wrong temperature water	<ul style="list-style-type: none"> • Turn faucet (s) on fully. • Make sure the temperature selection is correct. • Make sure the hoses are connected to the correct faucets. • Flush water lines. • Check the water heater. It should be set to deliver a minimum 49° C (120° F) hot water at the tap. Also check the water heater capacity and recovery rate. • Disconnect the hoses and clean the screens. The hose filter screens may be clogged. • As your Washer is filling, the water temperature may change as the automatic temperature control feature checks incoming water temperature. This is normal. • While your Washer is filling, you may notice just hot and/or just cold water going through the dispenser when cold or warm wash temperatures are selected. This is a normal function of the automatic temperature control feature as your Washer determines the temperature of the water.

Load is too wet at the end of the wash cycle	<ul style="list-style-type: none"> • Use the High or Extra High spin speed. E -4 • Use High Efficiency (HE) detergent to prevent over-sudsing. • Load is too small. Very small loads (one or two items) may become unbalanced and not spin out completely.
Leaks water	<ul style="list-style-type: none"> • Make sure the door is firmly closed. E -4 • Make sure all hose connections are tight. • Make sure the end of the drain hose is correctly inserted and secured to the drainage system. • Avoid overloading. • Use High Efficiency (HE) detergent to prevent over-sudsing.
Has excessive suds	<ul style="list-style-type: none"> • Use High Efficiency (HE) detergent to prevent over-sudsing. E -4 • Reduce the detergent amount for soft water, small or lightly soiled loads. • Non-HE detergent is NOT recommended.

ERROR CODES			
Code	Possible Cause	Solution	Component
E1	Door Open	Ensure the door is completely CLOSED and properly latched.	Door Switch
E2	Drain Issue	Clean the drain FILTER thoroughly. Ensure the drain HOSE is not kinked, bent, blocked, or crushed.	Drain Pump
E3	Water Inlet Valve	Confirm that the WATER FAUCETS are fully turned ON. Check and clean the inlet valve filter if clogged. Check if there is any water leakage from water / drain hoses.	Inlet Valves
E4	Excess Water / Excessive Suds	Ensure the door is properly CLOSED. Use appropriate spin speed and adequate High Efficiency (HE) detergent.	Inlet Valves
E5	Motor	Ensure the drum is NOT OVERLOADED and select the appropriate wash program based on the fabric type.	Motor + Electronic Module
E7	Washing Heater	Reduce load size and restart the cycle. Avoid OVERLOADING the unit.	Washing Heater
E8	Overload / Temperature Sensor Malfunction	Reduce load size and distribute clothes evenly. Connect properly the HOT and COLD faucet.	Temperature Sensor (@rear-bottom of Drum)
E10	Water Pressure Switch	Ensure faucets are FULLY OPEN. Confirm hoses are not kinked or blocked. Clean inlet FILTERS if necessary. Check water pressure (not above 145 PSI) Turn OFF & unplug → see if water still enters Clean inlet valve filters / screens Check hoses for tight connection / damage Try a RESET (unplug 5 -10 mins)	Water Level Sensor
E16	Communication Error	If the unit is not responding, UNPLUG it for 10 -15 minutes and plug it back in. If the DISPLAY FLICKERS or the unit makes noise while off, perform a power reset by unplugging and reconnecting after 10–15 minutes.	Communication Cable

Information or Parts:
www.ApplianceDesk.com/Parts

