

ASSEMBLY INSTRUCTIONS & PARTS IDENTIFICATION

SLATBACK CHAIR

Thank you for purchasing this quality product. Be sure to check all packing material carefully for small parts that may have come loose inside the carton during shipment.

Hardware kit			
No		Description	Q'Ty
A		Lock Washer 5/16"	11 pcs
B		Flat Washer 5/16"	11 pcs
C		Long Bolt 1/4"x 3"	4 pcs
D		Medium Bolt 1/4"x 2"	4 pcs
E		Short Bolt 1/4"x 1 3/8"	3 pcs
F		Allen Key	1 pc
G		Screw Ø4 x 38mm	4 pcs

Key Parts			
No	Code	Description	Q'Ty
1	2021-398KDP40	Chair Back	1 pc
2	2021-398KDP41	Complete Seat	1 pc
3	2021-398KDP42	Right Facing Front Leg	1 pc
4	2021-398KDP43	Left Facing Front Leg	1 pc
5	2021-398KDP44	Right Facing Side Stretcher	1 pc
6	2021-398KDP45	Left Facing Side Stretcher	1 pc
7	2021P01F	Floor glide	4 pcs

FABRIC CARE INSTRUCTION REGULAR CARE
Clean with shampoo, foam, or dry cleaning solvents as desired.
Do not saturate with liquid. Pile fabrics may require brushing to restore appearance.
Cushion covers should not be removed and dry cleaned.
FABRIC CONTENT: 100% Polyester; Cleaning code "WS"

STEP 1

- Carefully lay Chair Back flat on a smooth flat surface to prevent scratches.
- Affix Complete Seat to Chair Back by inserting a Flat Washer (B), Lock Washer (A) with Short Bolt (E) into each of the holes on the back rail of the seat, and Long Bolt (C) with washes into each of 2 holes in the Complete Seat corners. (See Detail A & B).
- Tighten screws with provided Allen Key (F) by turning clockwise until secure

STEP 2

- Carefully turn chair upside down and attach each Front Leg to the front corners of the Complete Seat (Keeping in mind of the right side and left side leg) with a Flat Washer (B), Lock Washer (A) and Medium Bolt (D). (See detail C). Keep the bolt loose at this point. Insert right side stretcher and left side stretcher between the Front and Back Legs, then insert the Front Stretcher between the two Front Legs. (Make sure that the side stretchers are not at an angle as the front legs are on the wrong side). Fasten stretchers to legs with Screws (G) using a Screwdriver (not provide).
- Be sure to level the chair prior to tightening front leg bolts with wrench provided (F).

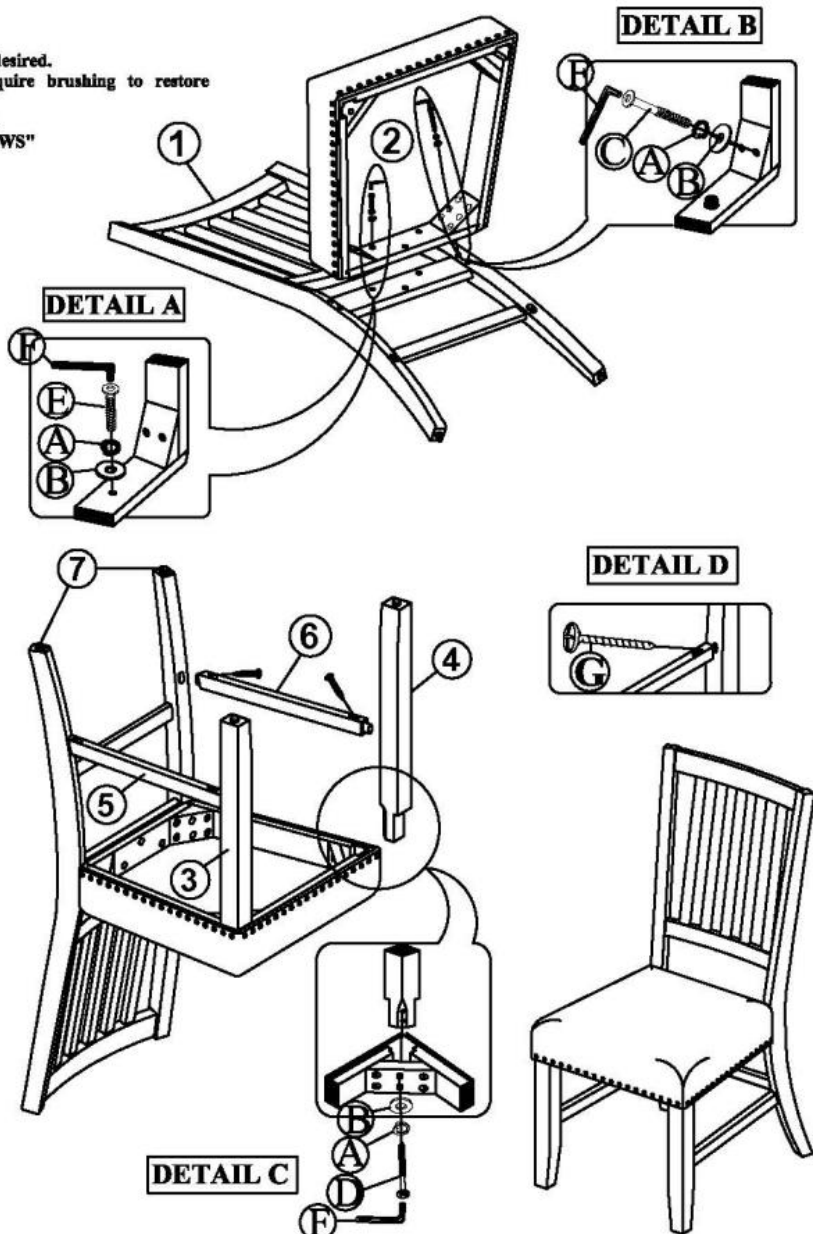

MADE IN VIETNAM