

**SPECIFICATIONS:**

**DESCRIPTION**

Wall-mounted sconce featuring one handcrafted glass.

**LAMPING**

**Standard:** 40W Low-pressure G9 Halogen 120V lamp, included.  
Suitable for use in an open fixture. Dimmable with standard incandescent dimmer.

**LED:** 5W LED Replaceable source 120V, dimmable, included.

**DIFFUSER**

Shade shall be handcrafted glass of various decors.  
Diameter of 5.5" and height of 2.5"

**CONSTRUCTION**

Fixture utilizes metal arm assembly with stamped steel canopy and faceplate (5" Circle or Square), with plated finish.

**METAL FINISH**

Fixture shall be finished in Bronze, Chrome or Satin Nickel.

**MOUNTING**

Installs directly to a 4" octagonal outlet box. Wall-mount only.  
Designed for uplighting, but may also be oriented downward.

**LABELS**

UL or ETL Listed. Suitable for Damp Locations (interior use only).



MINI SCONE SHOWN IN DICRO SWIRL & SUNSET WITH SQUARE CANOPY

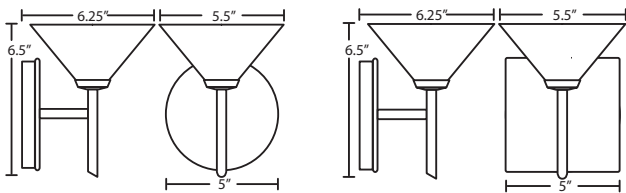

WHITE

BLUE MATTE

MARBLE

BI-COLOR

WHITE STARPOINT

MANGO STARPOINT

BLUE STARPOINT

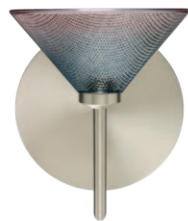

**For ordering information, see next page**

All dimensions provided are nominal.  
Allowance must be made for dimensional tolerance in handcrafted glasses.

## MINI SCONCES WALL

### ORDERING:

---

FIXTURE	GLASS OPTIONS	METAL FINISH	METAL FINISH	OPTIONS
Sconce	White Marble Sunset Blue Matte Bi-color White Starpoint Blue Starpoint Mango Starpoint Dicro Swirl	40W G9 Hal 5W LED 120V, dimmable	Bronze Chrome Satin Nickel	Square Canopy

Mini Sconce w/ Dicro Swirl Glass, Satin  
Nickel Finish

#### LED SCONCES:

---

- Total power of only 5 watts
- Dimmable with a standard dimmer
- Rated life: 25,000 hours
- 450 lumens
- CCT: 3000° Kelvin
- CRI: 80+

#### Project Information:

---