

ELKAY®

SPECIFICATIONS

Lustertone® Deep Single Bowl Sink No Faucet Ledge Models DLFR Series

GENERAL

Highest quality sink bowl seamlessly formed of #18 gauge, type 304 (18-8) nickel bearing stainless steel. Top Mount.

DESIGN FEATURES

Bowl Depth: 10-1/8" (257mm) or 12-1/8" (308mm).

Coved Corners: 1-3/4" vertical and horizontal radius.

Bowl Recess: 3/16" (44mm) below outside edge of sink.

Finish: Exposed surfaces are hand blended to a Lustrous High-Lighted Satin finish.

Underside: Fully undercoated to dampen sound and reduce condensation.

OTHER

Drain Opening: 3-1/2" (89mm).

Sink complies with ASME A112.19.3/ CSA B45.4



Sinks are listed by IAPMO® as meeting the applicable requirements of the Uniform Plumbing Code®, International Plumbing Code®, and National Plumbing Code of Canada.

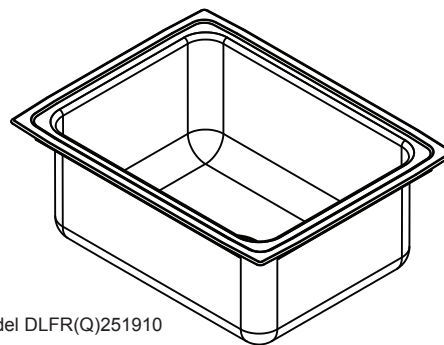

Model DLFR(Q)251910

SINK DIMENSIONS (INCHES)*

Sink Package Model Number	Overall		Inside Bowl			Cutout in Countertop (1-1/2" Radius Corners)		Minimum Cabinet Size
	L	W	L	W	D	L	W	
	A	B	C	D	E	L	W	
DLFR191810	19 (483mm)	18 (457mm)	16 (406mm)	13 1/2 (343mm)	10 1/8 (257mm)	18 3/8 (467mm)	17 3/8 (441mm)	24 (610mm)
DLFR251910	25 (635mm)	19 1/2 (495mm)	21 (533mm)	15 3/4 (400mm)	10 1/8 (257mm)	24 3/8 (619mm)	18 7/8 (479mm)	30 (762mm)
DLFR251912	25 (635mm)	19 1/2 (495mm)	21 (533mm)	15 3/4 (400mm)	12 1/8 (308mm)	24 3/8 (619mm)	18 7/8 (479mm)	30 (762mm)

* Length is left to right. Width is front to back

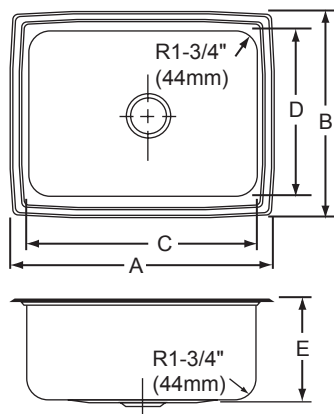

U-Channel Type Mounting System

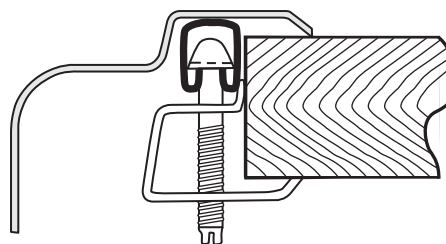

In keeping with our policy of continuing product improvement, Elkay reserves the right to change product specifications without notice. Please visit elkay.com for the most current version of Elkay product specification sheets.

This specification describes an Elkay product with design, quality, and functional benefits to the user. When making a comparison of others producers' offerings, be certain these features are not overlooked.