

Water Fountain

User Guide

CONTENTS

Fountain Care Instructions	1
Warnings & Cautions	2
Pump Assembly Instructions	3
Light Assembly Instructions	6
Appendix of Light Diagram	7
Appendix of Fountain Extrusion Diagram	9

Thank you for choosing our product. To ensure a safe and effective experience, please read the manual thoroughly before assembly and use.

FOUNTAIN CARE INSTRUCTIONS

To keep your fountain last with proper fountain maintenance, we highly recommend the following.

Cleaning Your Fountain

An environment of water, light, and air invites algae into your fountain; therefore algae growth is natural to fountains. Unfortunately, algae growth will clog and impede water flow through the pump. Consequently, it is essential that you clean your fountain pump, bowl, and rocks once every 1-3 months.

The best way to clean the fountain is with a soft Terry cloth towel and soapy warm water. Never use bleach or any other harsh chemical, as they can damage the pump and water fountain. Remember to unplug any electrical components prior to cleaning to reduce the risk of electric shock.

Caring for Your Pump

Don't let the pump run dry! Pumps are designed to be submerged and should only be used when fully submerged in water. Depending on your weather conditions, always remember to check the water level of your fountain every 3 -5 days. During extreme summer weather conditions, please be sure to check your water levels daily as water tends to evaporate quicker.

When you forget to fill your fountain with water you will end up burning out the motor in your pump. This will void the warranty. Over time your pump will have algae build up on the pre-filter cage of the pump.

If possible, remove the pre-filter cage from the pump to clean. Run the pre-filter cage through warm water and use an old toothbrush to lightly scrub the pre-filter cage and remove all algae buildup. Run warm water over the rest of the pump to remove the algae build-up that is on the pump. We recommend doing this every 1-2 months depending on how quickly your fountain builds up algae.

Water Levels

The most important aspect of fountain care is to maintain an adequate water level. Maintaining the right water level in your fountain will protect your pump from burning out. It's essential to check the water level every 1-2 days and fill as needed. If the fountain begins to produce white misty bubbles, this is an indication that the fountain is low on water. In such cases, it is advisable to replenish the water to the appropriate level.

We highly recommend using distilled water as it does not contain the minerals and additives found in local supplies which can cause damage to your pump and fountain.

Algae Build Up

Keep in mind that algae grow more quickly in bright sunshine areas, so you may choose not to put your fountain in direct sunlight. We highly recommend changing the water in the fountain every month to reduce the growth of algae.

Winter Fountain Care

In cold climates, We highly recommend storing your fountain and pump inside during the coldest months of the year. If this is not possible follow the steps below:

- Unplug and drain your fountain completely until it is completely dry of water.
- Fill the fountain bowl(s) with burlap to prevent water from freezing on your fountain.
- Disconnect the pump from the tubing located on the back of the fountain.
- Store the pump inside during the winter to prevent water freezing inside the pump motor.
- Cover the fountain with a waterproof cover for the winter.

The purpose of this process is to keep water from staying or building up in your water feature. The water in your fountain could freeze and therefore expand, leading to flaking surfaces or even cracks. Make sure to check your fountain during the winter season often in order to prevent any water buildup.

WARNINGS & CAUTIONS

Warnings

- To reduce the risk of electric shock, connect the pump only to a Ground Fault Circuit Interrupter (GFCI) outlet.
- Do not exceed the voltage specified on the pump label.
- Always disconnect the pump from the power source before performing maintenance or working on the pump, lights, or any fountain fittings.
- Inspect the power cord for damage before installation or maintenance.
- Replace the entire pump if any damage is detected. Clean the pump using a damp cloth only.
- Do not use chemicals for cleaning, as they may damage the finish.

Cautions

- Use the correct power source as specified on the pump label. Keep the power cord away from high temperatures or heat sources.
- Never lift the pump by its power cord.
- Keep the fountain out of reach of children.
- Do not operate the pump when dry; it must be fully submerged for proper functioning and cooling.
- Do not pump heated liquids.
- Use with freshwater only. Avoid heavily chlorinated water or water with high pH levels.

Note

Please note that the assembly process requires teamwork. Due to differences in individual product designs, there may be slight variations from the specified content. We apologize for any inconvenience and appreciate your understanding.

PUMP ASSEMBLY INSTRUCTIONS

The following diagrams describe the assembly steps of the pump for various fountains.

1. Diagram of water circulation for a whole unit fountain

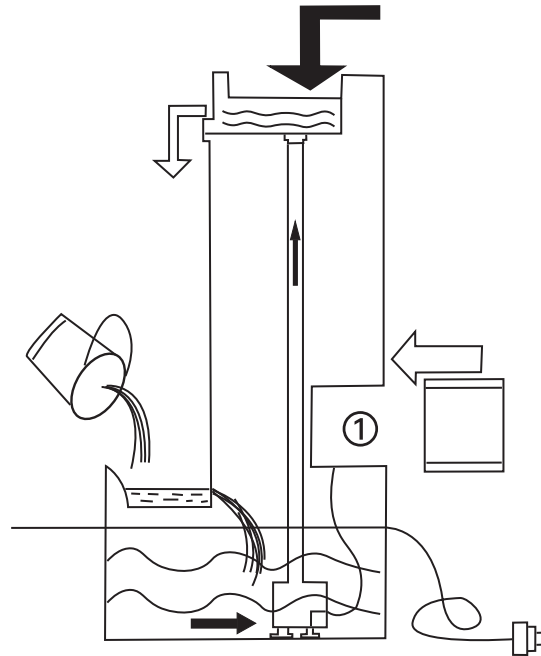

- Remove the pump from the package and untie the power cord. Adjust the flow rate (if applicable) to the maximum (+) position.
- Drag out one end PVC tube from the fountain back (as shown in Fig. 1) to connect with the pump. Place the pump in a desired location in the fountain. Close the cover plate (The individual product is not with any cover plate because of structure difference). Always keep the plug out.
- Add water according to what picture shows. Make sure that water level does not exceed the front and back rock bottom.
- Connect the power cord from the pump to a properly grounded, grounding type receptacle (GFCIN). Processing circuit.

2. Diagram of water circulation for one set fountain with two pieces, by the perpendicularity links up

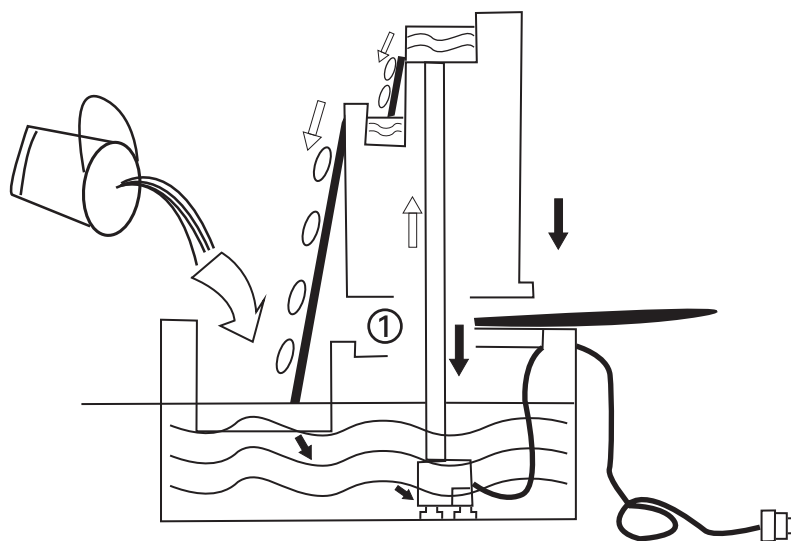

- Remove the pump from the package and untie the power cord. Adjust the flow rate (if applicable) to the maximum (+) position.
- Drag out one end PVC tube from the bottom of Fountain Upright (as shown in Fig. 1) to connect with the pump. Place the pump in a suitable location in the Fountain Cistern, and assembled the Fountain Upright on the Fountain Cistern at the same time (as what picture shows). Make sure they fitted well.
- Add water according to what picture shows. Make sure that water level does not exceed the front and back rock bottom.
- Connect the power cord from the pump to a properly grounded, grounding type receptacle (GFCIN). Processing circuit.

3. Diagram of water circulation for twist and lock style fountain

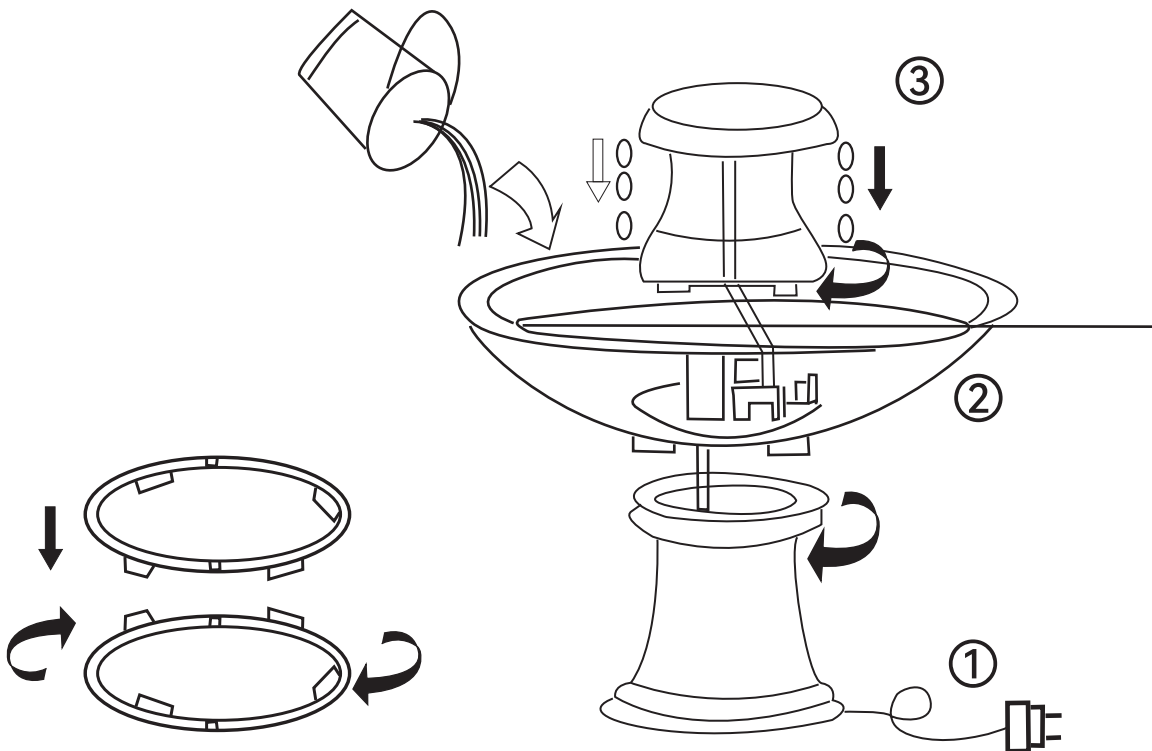

- Remove the pump from the package and untie the power cord. Adjust the flow rate (if applicable) to the maximum (+) position. Pass the power cord through the middle of the Basin and Pedestal, drag the power cord out from the hole of Pedestal bottom (as what picture shows).
- Tighten the screws to assemble the Basin and the Pedestal (as shown in Fig.1 & Fig.2).
- Drag out one end PVC tube from the bottom of the Fountain Upper-end to connect with the pump. Place the pump in a suitable location in the Basin (as shown in Fig.2 & Fig.3).
- Tighten the screws to assemble the Fountain Upper-end and the Basin (as shown in Fig.2 & Fig.3).
- Add water according to what picture shows. Make sure that water level cover the pump fitly just completely.
- Connect the power cord from the pump to a properly grounded, grounding type receptacle (GFCN). Processing circuit.

4. Diagram of locking style fountain

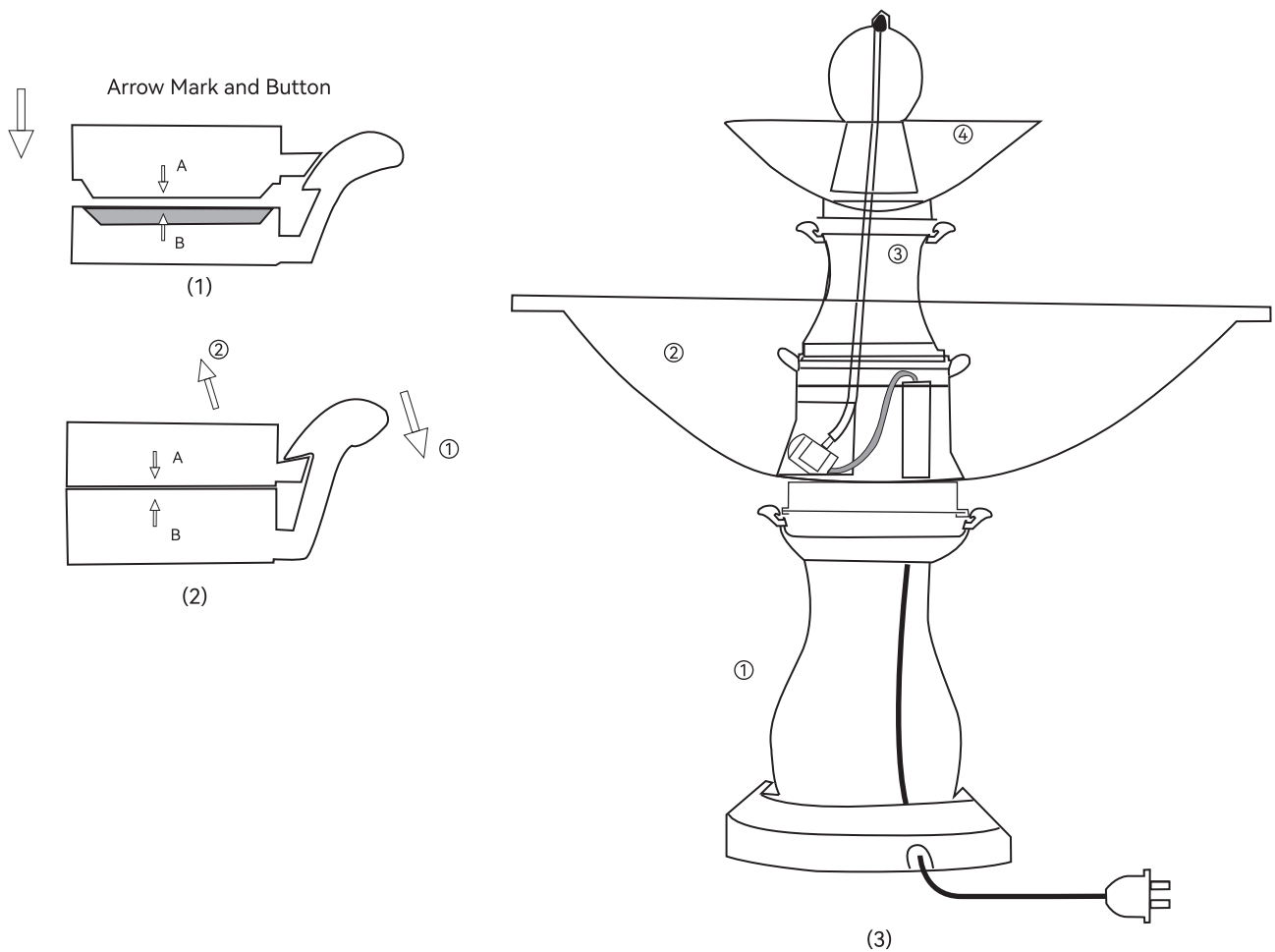

- Place the Pedestal ① on the ground, lift the Basin ② up and find Arrow Mark and Button as picture (1), then set the Basin ② on the Pedestal ① and make sure the button is closed tightly.
- Remove the pump from the package and untie the power cord. Adjust the flow rate (if applicable) to the maximum (+) position. Pass the power cord through the middle of the Basin and Pedestal, then take the plug out as shown in picture(3).
- Lift the Fountain Top ④ up, through the water pipe from Middle Pedestal ③, find Arrow Mark and Button then connect them together, make sure the button is closed tightly.
- Pick up the end of water pipe, connect it with the pump, and put the pump in the suitable location, then close the cover.
- Fill water into Basin, make sure that water level cover the pump fitly just completely.
- Connect the pump plug to a properly grounded. Grounding type receptacle (GFCI). Processing circuit.

LIGHT ASSEMBLY INSTRUCTIONS

Diagram of fountain light(s)

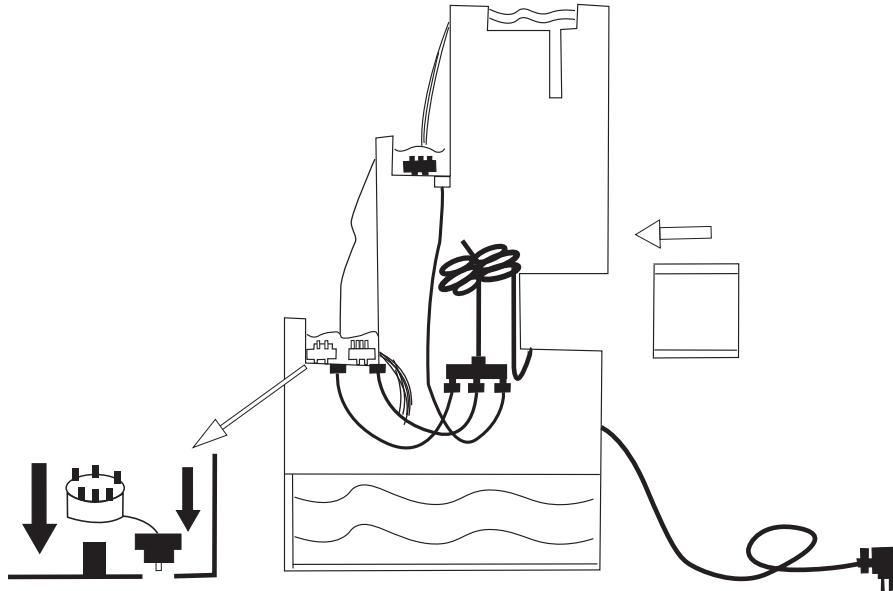

- If product design does not contain light, please ignore this chapter.
- Please check accessories light(s) and wiring strategy if the product should attach any light.
- Remove the transformer from the package.
- Drag the light(s) cord attachment plug out the fountain, connect it to the transformer.
- Connect the transformer to a properly grounded, grounding type receptacle (GFCI). Processing circuit.

(i) Note

For a fountain with a two-piece setup, the light component may sometimes be attached to the Fountain Upright. Follow these steps for assembly:

- Detach the light cord: Carefully unplug the light cord attachment from the Fountain Upright.
- Connect the light: Use the black PVC connector to attach the light cord to the Fountain Infrastructure.
- Proceed with remaining steps: For any additional assembly, refer to the instructions outlined in the earlier steps.

APPENDIX OF LIGHT DIAGRAM

Six granule per LED light set

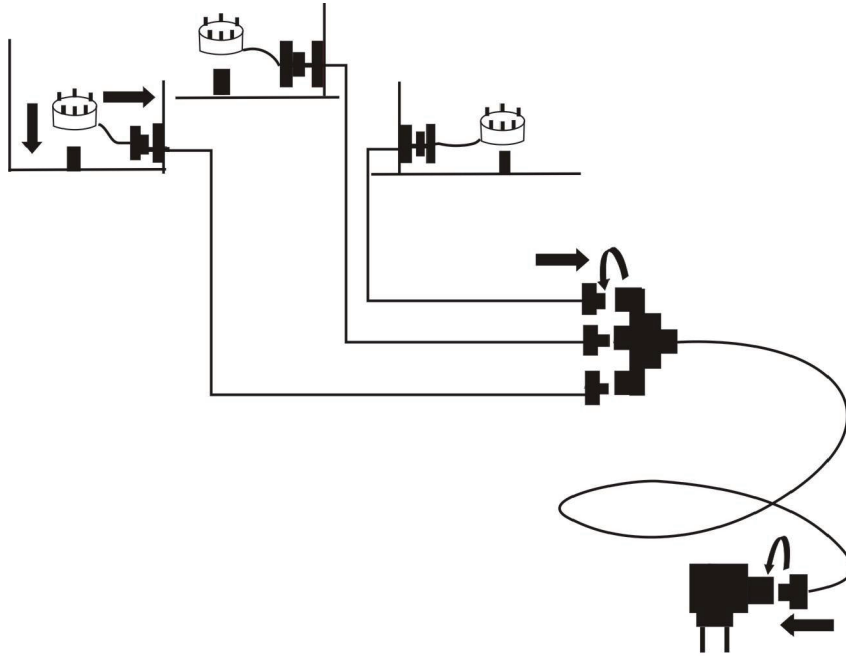

Single LED light

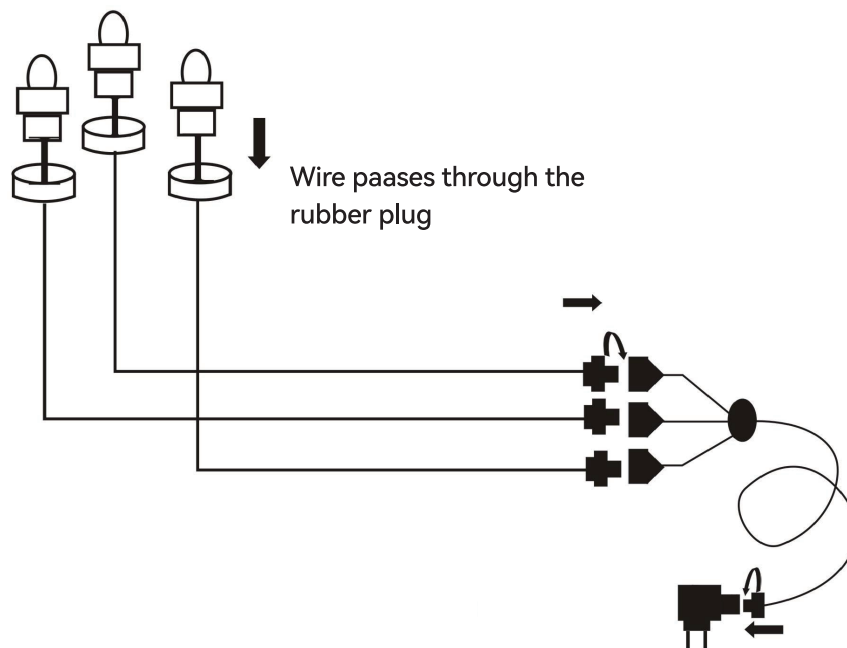

Finger type light

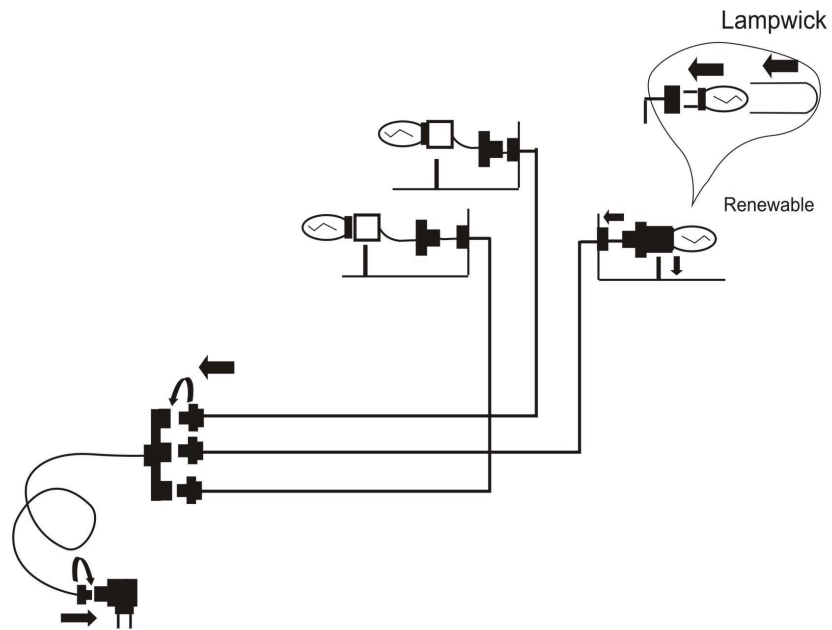

Iron arm trumpet light

⚠ To avoid scalded or lampwick fracture, never pinch light shade to adjust light, especially when the light is on.

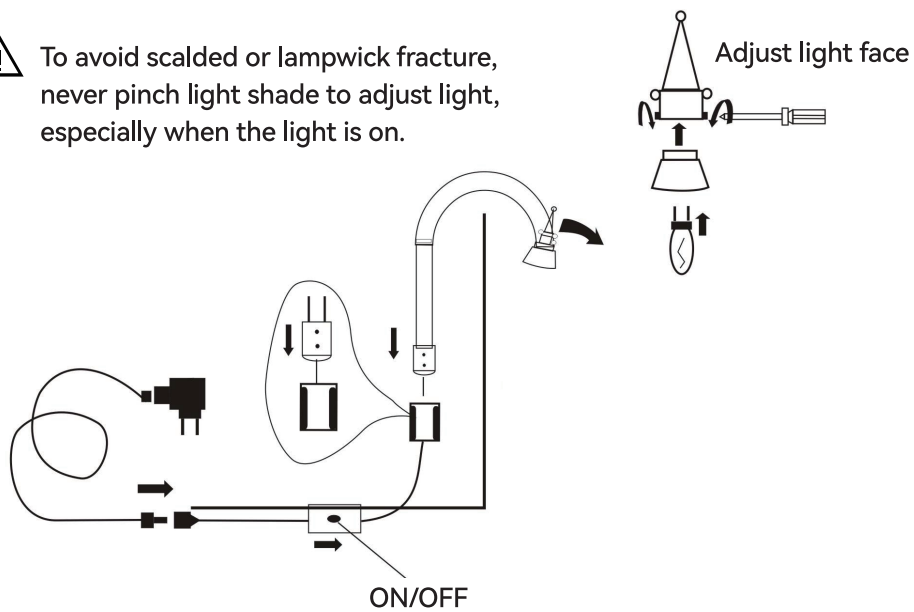

APPENDIX OF FOUNTAIN EXTRUSION DIAGRAM

Fork - Unions Adapter

For great flux, three face outwater

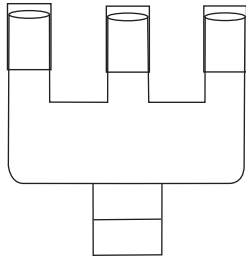

Y - Unions Adapter

For great flux, two face outwater

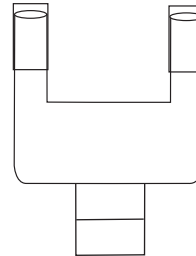

Adjustable Fork - Unions Adapter

To counterpoise water flux

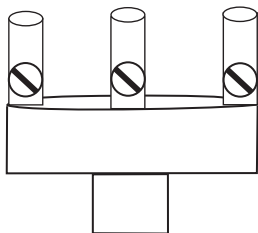

Water Disperse Connection

To share the running water

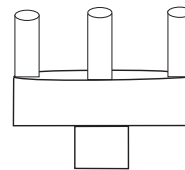

Colligation

To bind the PVC tube with the pump. Ensure that link up tight.

