

## Adjustable Bed Base Assembly Instructions



## CONTENTS

Safety & Warranty Warnings	01
Parts List	03
Electronics Quick Reference Guide	04
Installation Guide	06
Remote Control Instructions	08
Pairing Remote Control Instructions	10
Synchronizing Two Bases	11
Troubleshooting	12

## Safety & Warranty Warnings

---

*Attention: Read the following information before using this product . Failure to use a surge protection device could compromise safety or cause product malfunction and could void the electrical portion of your warranty.*

Electrical surges are by far the biggest cause of problems with electrical circuits.

In order to help protect your investment in case of a power surge or outage, use an electrical surge protection device (not included).

### *WARRANTY WARNING!*

Do not open or tamper with the transformer, control box, motors, or remote control (with the exception of battery compartments). The product warranty will be void if these components are tampered with.

### *SMALL CHILDREN AND PETS:*

Immediately dispose of all packing materials as they can smother small children and pets. Do not allow any persons or pets under the bed. Children, convalescents and disabled person should not operate the bed without adult supervision.

### *HOSPITAL OR CONVALESCENT USE DISCLAIMER:*

Adjustable beds are designed and engineered for a life style of in-home comfort and are not intended for hospital use or for a bed-ridden patient on an extended recovery. Adjustable beds are not equipped with bars to help patients get safely in and out of bed and are not intended to be used around tent type oxygen therapy or explosive gases.

### *PRODUCT RATINGS:*

The bed lift motors are not designed for continuous use of more than 2 minutes in an 18 minutes period, or approximately 10% duty cycle. Any attempt to circumvent or exceed this rating will shorten the life expectancy of the product and may void the warranty.

*WEIGHT UNITS:*

The limitation for this adjustable bed is 750 lbs. The bed will structurally support these weights, provided weight is evenly distributed across the head and foot sections. This product is not designed to support or lift this amount in the head or foot section alone. Exceeding this weight restriction could damage the bed and/or cause injury and void the warranty. Enter or exit the bed in a flat position and do not sit on the head or foot sections while in the raised position.

*LIFTING AND LOWERING MECHANISMS:*

It is normal for the raising and lowering feature on this bed to emit a minimal humming sound during operation.

*LOCATION ENVIRONMENT:*

The level of sound experienced in a room is directly related to the environment within that location. To reduce the resonance, place a piece of carpet or rubber casters cups under the legs. The rubber caster cups also prevent the bed sliding when located on smooth or hard surface flooring.

*TO REDUCE THE RISK OF SHOCK, BURNS, FIRE OR INJURY:*

Make sure the base is in a flat position and the vibrating motors are turned off before unplugging the bed base from the power source. Always unplug the base from the electrical outlet before cleaning or servicing the base. If the cord or plug is damaged, discontinue use of the bed base.

*FCC COMPLIANCE:*

This device complies with part 15 of the FCC Rules for residential use. Operation is subject to the following two conditions: (1) This device may not cause harmful interference, and (2) this device must accept any interference received, including interference that may cause undesired operation.

Radio Frequency: 2.4 GHz

## Parts List

---

All electronics and components that need to be installed are located in boxes. Before discarding the packing materials, ensure that all the parts are accounted for.

A



AAA Batteries (3)

B



Bed Legs & Bottom Caps (6)

C



Power Cord (1)  
& Power Supply (1)

D



Remote Control (1)

E



Retainer Bar (1)  
Attached to the bed frame

## Electronics Quick Reference Guide

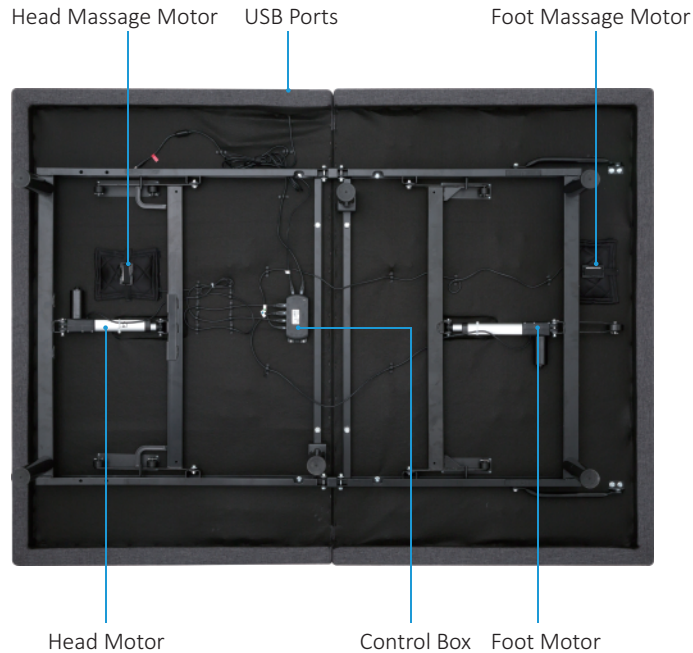

Type A & Type C  
on a bed side

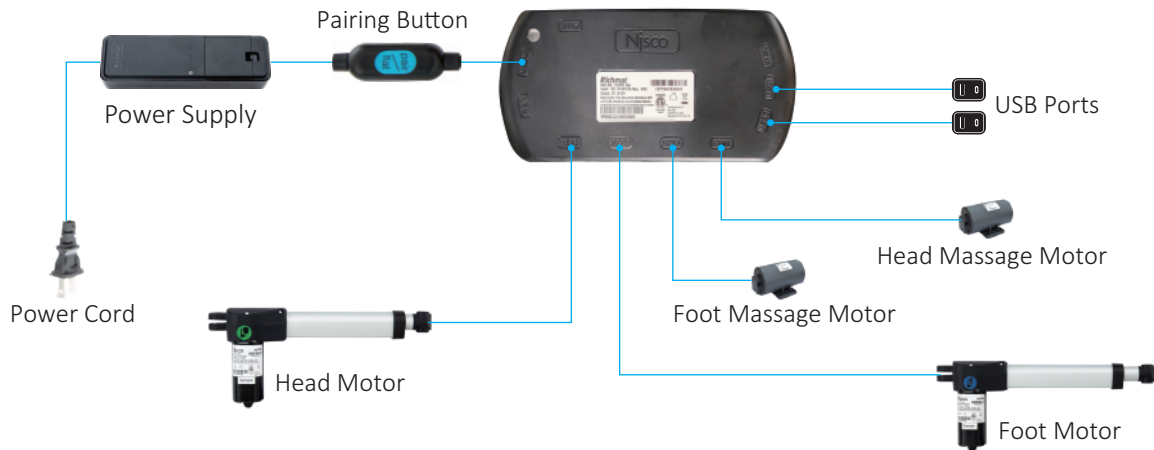

## Installation Guide

---

For safety reasons, lifting of the adjustable bed frame must be performed by 2 people; and the unit should always be in a flat position before opening.

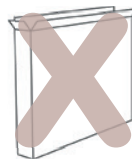
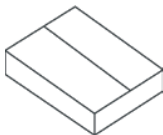

---

## Assembly

### Step 1

Open the shipping box, cut the ribbon securing accessory boxes & mattress retainer bar, and put them aside.

Lift the folded bed frame unit out of the shipping carton carefully, and then put it on a flat floor.



Note: Do not pull the ribbon from the base as the upholstery will be damaged.

## Attaching Bed Legs

### Step 1

Remove the six (6) bed legs from the accessory bag.

Hand tighten the legs by threading them clockwise into the pre-threaded holes on the bed frame.

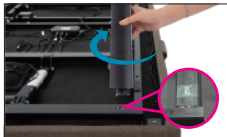

### WARNING

Nut on the frame is removable and replaceable.  
Please remove tape on the nut to install legs.

### Step 2

Once legs are attached, please pick up from head and foot and flip without resting on legs.

## Installing Retainer Bar

### Step 1

With assistance turn the bed frame over, top side up.

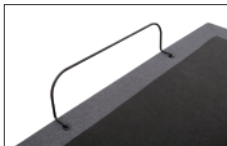

### Step 2

Insert the ends of the retainer bar into the quick connect brackets located at the foot of the bed.

## Setting Up Electronics

### Step 1

Take out the power supply and power cord from the accessory box.



### Step 2

Connect the power cord and plug the power cord into a working electrical outlet.



Note: Do not overload power board.

### Step 3

Install the three (3) AAA batteries into the remote control. Confirm the remote control works by pressing the lift buttons.



## Remote Control Instructions

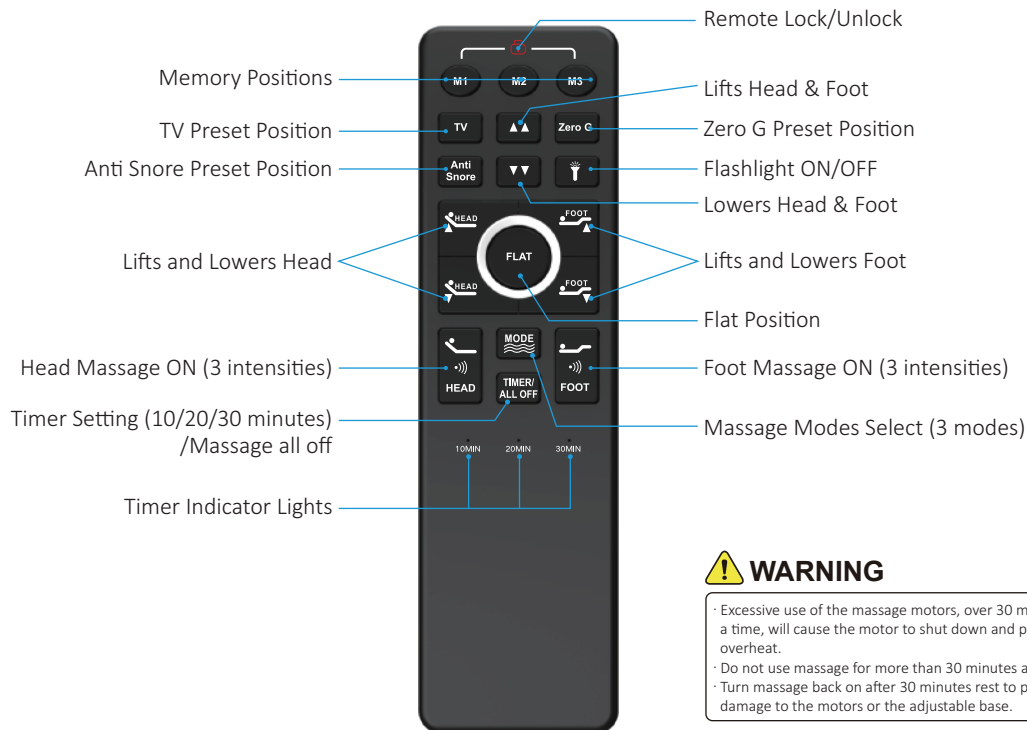

### **WARNING**

- Excessive use of the massage motors, over 30 minutes at a time, will cause the motor to shut down and possibly overheat.
- Do not use massage for more than 30 minutes at a time.
- Turn massage back on after 30 minutes rest to prevent damage to the motors or the adjustable base.

## ADJUST



The HEAD▲▼arrows lift and lower the head section of the base.



The FOOT▲▼arrows lift and lower the foot section of the base.



The double▲▲arrows lift and lower the head & foot section of the base.



Press and hold the button, flash light will be on.



Remote Lock/Unlock

## ONE TOUCH BUTTONS



One touch **TV** preset position



One touch **ZG** preset position



One touch **ANTI SNORE** Preset Position



One touch **FLAT** preset position



+



Press M1+M3 for 3 seconds, child lock / unlock

## MESSAGE FEATURE



Head Massage ON (3 intensities)



Foot Massage ON (3 intensities)



Message Modes Select (3 modes)



Timer Setting (10/20/30 minutes)  
/Message all off



Timer Indicator Lights

## HOW TO SET THE MEMORY POSITIONS



Start by adjusting the bed to the right position, Then press the **M1** and **FLAT** buttons at the same time.

## Pairing Remote Control Instructions

The original remote that comes in the box, should already pair with the base. In the event that the remote is not paired with the base, follow these steps.

### Remote Is Not Paired With The Base

#### Step 1

First check batteries are correctly inserted and are working.  
Replace batteries when required.

#### Step 2

Check that the power cord is correctly inserted and power is on.

#### Step 3

**Press and hold "HEAD LIFT" and "FOOT LIFT" simultaneously, then press and hold the pair button on the cord of control box for 3 seconds until you hear 2 beeps sound, the remote is then paired.**



## Synchronizing Two Bases

unison movement

### OPTION: WIRELESS

If you have split bases, follow these instructions to operate both sides with one remote control in a synchronized manner. Skip this step if you don't have split bases.

1. Make sure each remote control operates a respective side (i.e., Remote A controls Base A and Remote B controls Base B).
2. Pair Remote A to Base B, then base A and base B can be simultaneous operated by Remote A.
3. Test moving both bases with Remote A. Remote B will no longer function.

NOTE: If you want to operate the bases separately again, remote B can be paired to base A or base B again.

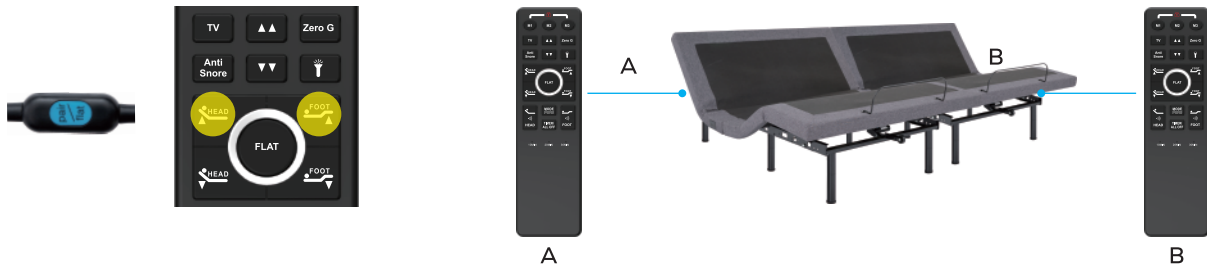

## Troubleshooting

In the event that the power foundation fails to operate, assess the symptoms and possible solutions provided in the chart below.

SYMPTOMS	SOLUTIONS
Remote control illuminates and appears to be operable, but will not activate bed.	Verify that the power cord is plugged into a working, grounded electrical outlet. Test the outlet by plugging in another working appliance.
No features of the power foundation will activate.	<p>Program the remote control (see the Setting Programmable Positions and Pairing Remote section of this manual for programming procedures).</p> <p>Unplug the power cord, wait 30 seconds and plug back to reset electronic components.</p> <p>The surge protection device or the electrical outlet may be defective. Test the outlet by plugging in another working appliance.</p>
Wireless remote will not illuminate.	Replace the batteries in the wireless remote.
Head or foot section will elevate, but will not return to the horizontal (flat) position.	<p>Bed mechanism may be obstructed. Elevate bed and check for obstruction. Remove obstruction.</p> <p>Head section may be too close to the wall.</p> <p>Headboard may be too close to the edge of the mattress. Verify that there is enough distance between the headboard brackets and mattress. Adjust if required.</p>

SYMPTOMS	SOLUTIONS
Head & Foot lift function has minor interference during operation.	<p>Check batteries in wireless remote control, replace with two (2) new AAA batteries if necessary.</p> <p>Make sure that you are following the duty cycle of the motors (do not operate more than two minutes over a 18-minute period, or approximately 10% duty cycle).</p> <p>Press the lift buttons squarely and accurately.</p> <p>Wireless remote control may be experiencing common Radio Frequency Interference from other radio transmitting devices. Wait several seconds, and then try pressing appropriate button again, See FCC Compliance Statement on page 5 of this guide.</p>
A clicking noise is heard under the bed when raising or lowering.	This is normal. The lift motor relays “click” when they are engaged. No action is required.