

Installation Instruction of Mirror Cabinet

Required tools

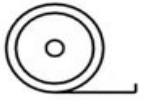

Tape Measure



levelling rod



self-tapping screw



Screwdriver



hammer

Complimentary accessories

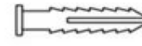

Plastic Anchors



self-tapping screw

1

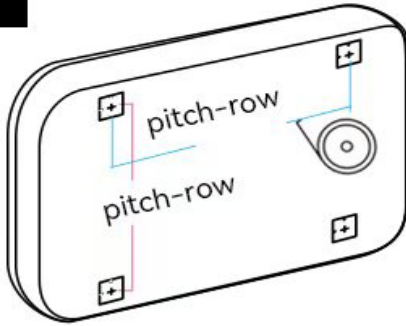

Measure the horizontal and vertical mounting hole spacing of the mirror cabinet.

2

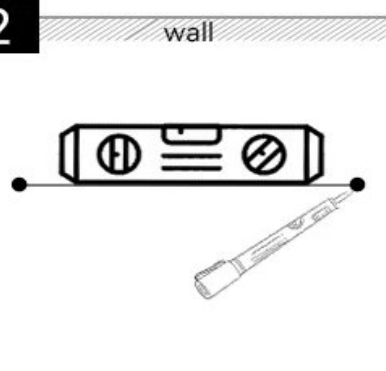

Measure the horizontal and mounting position with the leveling rod and mark it on the wall.

3

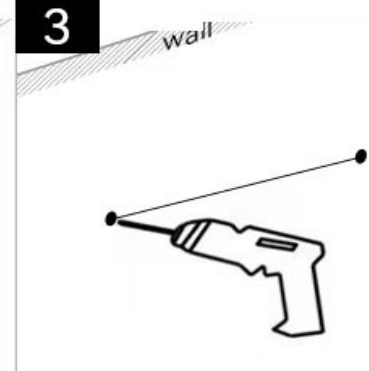

Drill holes according to the markings.

4

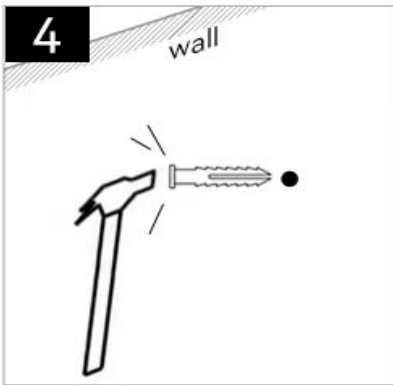

Hammer plastic anchors into pre-drilled holes.

5

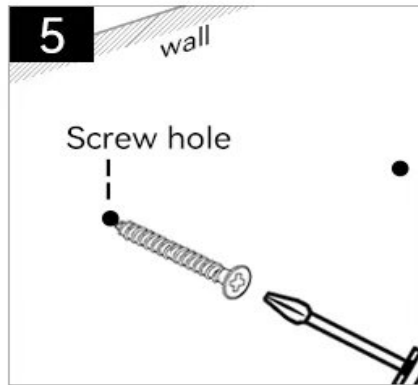

Screw in the tapping screw with a screwdriver.

6

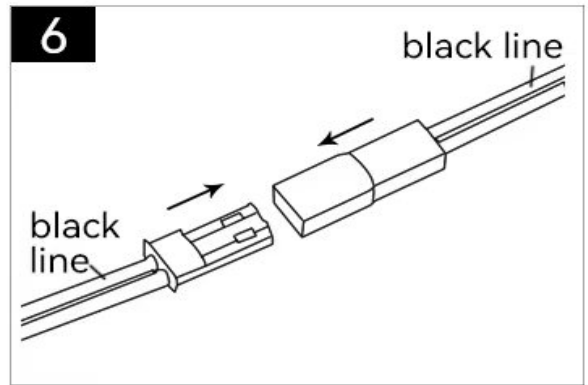

The card slots on both sides are inserted in accordance

7

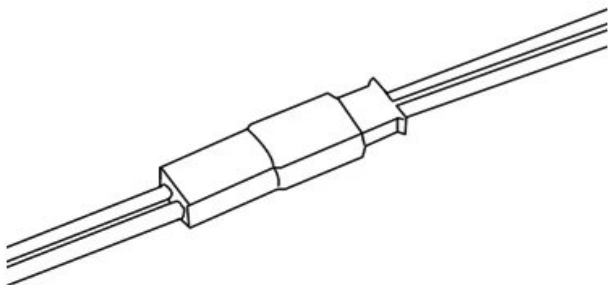

Plug in and install it to power

8

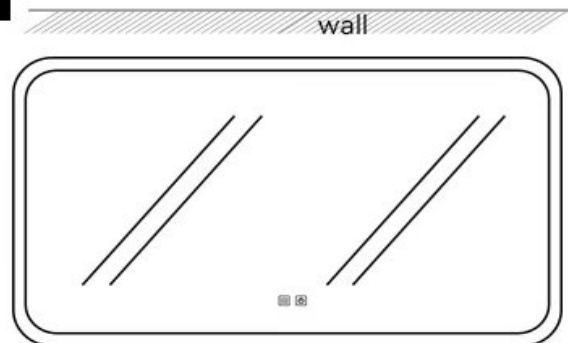

Hang up the mirror cabinet to complete the installation.