

# Living room 20x48" Wall Storage

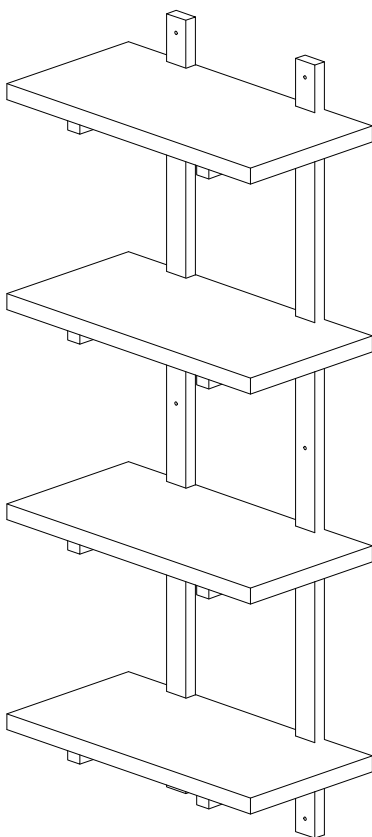

Thank you for purchasing the Living room 20x48" Wall Storage. We have found it helpful to have a second person present during the assembly process.

## Wall Storage Assembly Instructions

### Parts

NO.	DRAWING	DESCRIPTION	QTY
A		METAL FRAME	2
B		SHELF	4

NO.	DRAWING	DESCRIPTION	QTY
C		M6x35MM BOLT	16
D		4x60MM SCREW	6
E		ALLEN KEY	1
F		DRYWALL EZ ANCHOR	6

## Step 1

Read through these instructions thoroughly before beginning assembly. We have found this to be of great value when assembling this product.

---

## Step 2

Remove all parts and hardware from packing material. Wooden pieces should be placed on a non abrasive surface to prevent damage to the finish

---

## Step 3

Lay Metal Frame Assembly (A) on a non abrasive surface. Attach Shelf (B) to Metal Frame (A) using 16-M6x35MM Hex Bolts (C). NOTE: TIGHTEN ALL BOLTS AT THIS TIME !

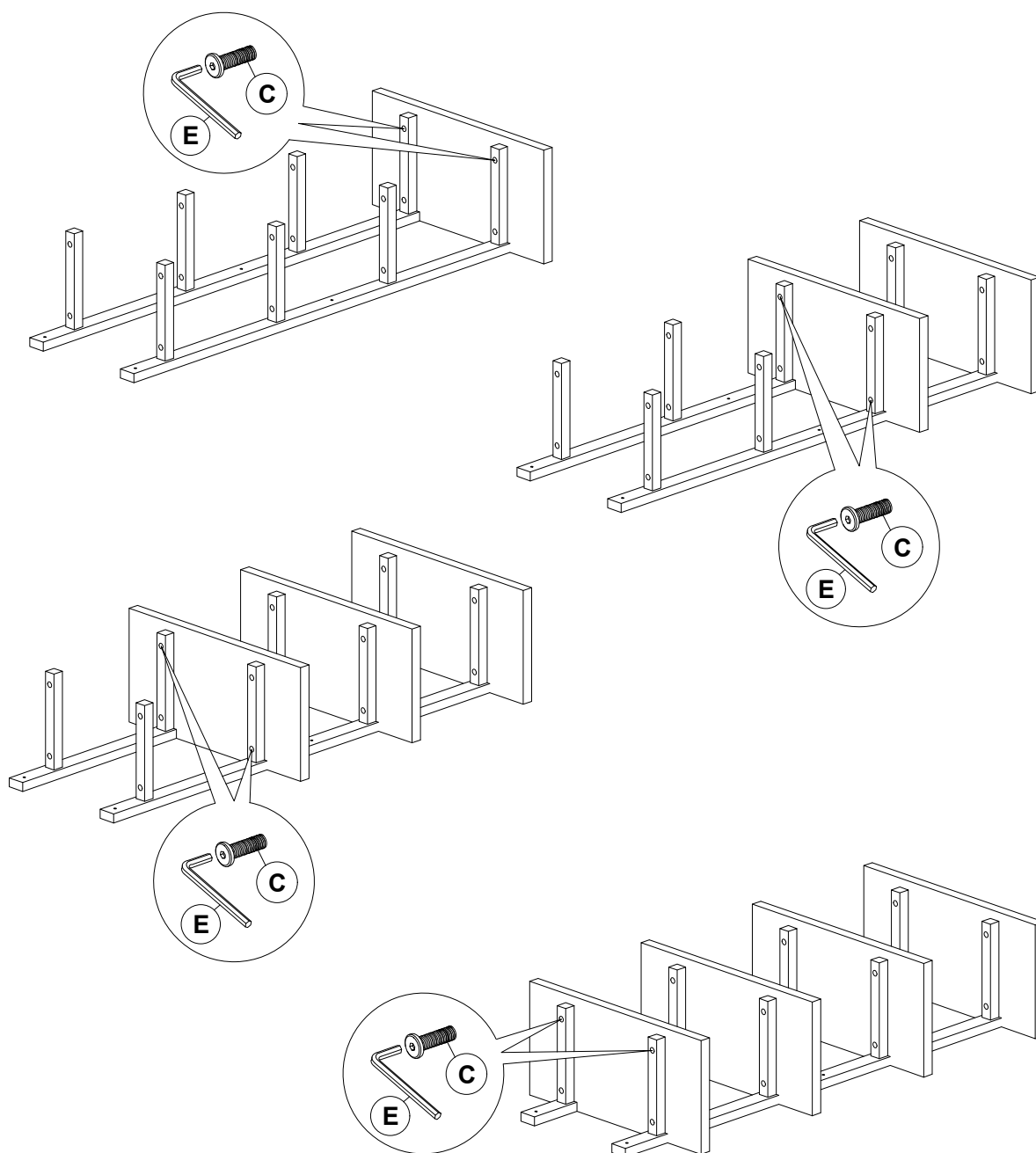

## Step 4

Position Wall Storage in desired location. Mark holes where metal frame will be attach to wall. If possible, attach the Wall Storage to a stud (when possible) behind drywall using 6-4x60MM Wood Screws (D).

NOTE: If hole locations do not align with stud, install the Drywall EZ Anchors (F). Tap the EZ Anchor into the drywall up to the thread. Using a Phillips head screw driver, secure the EZ Anchor in the drywall at the desired locations. Attach the Wall Storage to the EZ Anchors using 6-4x60MM Wood Screws.

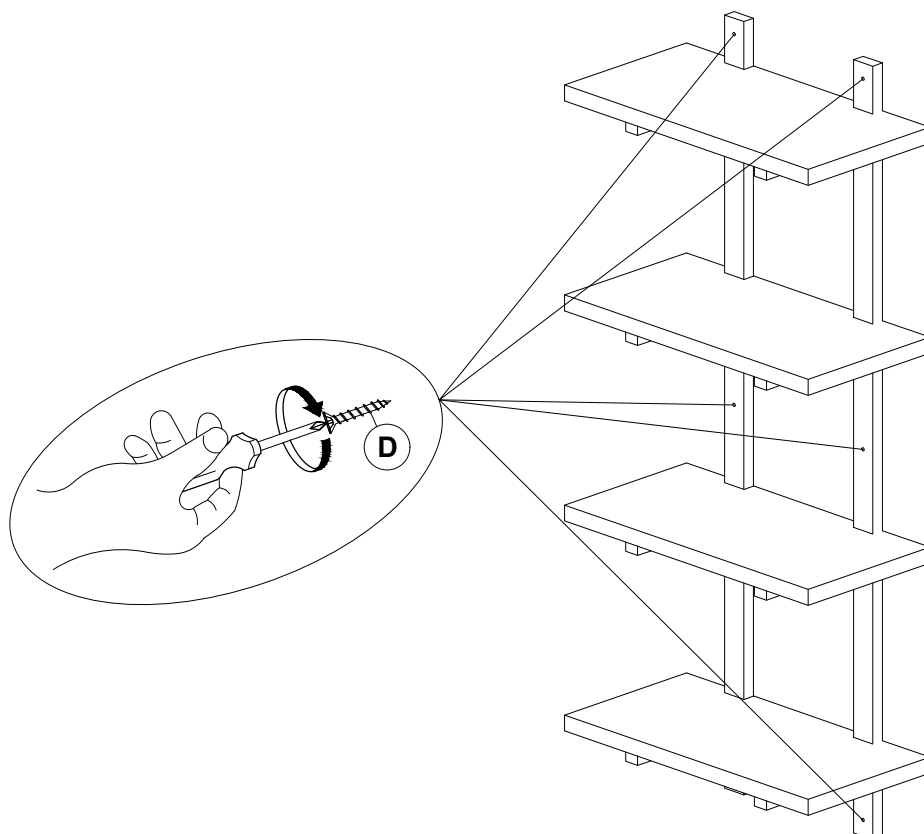

---

## CARE

Clean with a non abrasive cloth using a mild soap. Make sure to wipe dry.

---