

Installation instructions

01 Screw in six screws but do not tighten them yet. Keep them loose so that they can be adjusted when installing the seat plate later.

Key Point 1: After completing Step 2, tighten the six screws again.

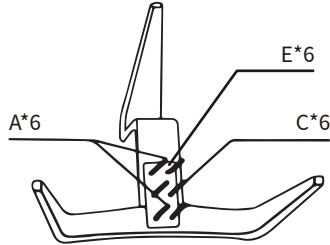

02 After aligning the holes, insert the screws and tighten them once. Then tighten the six screws at the iron plate position.

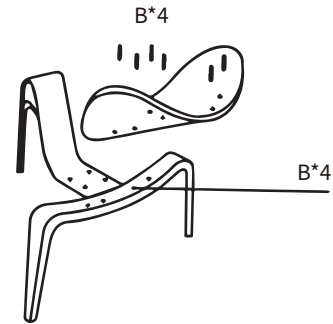

03 Tighten the screws to secure the backrest to the rear feet.

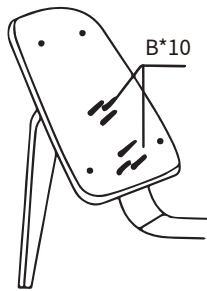

04 Do not use tools, tighten by hand. After inserting the four screws, align the lumbar support with the backrest and push it into place with force.

Key Point 1: Do not use tools to tighten; just tighten by hand.

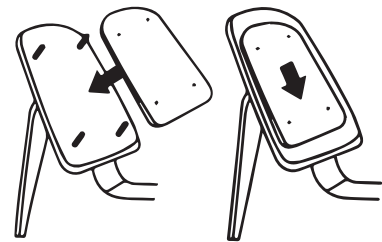

05 When tightening the first few screws, do not fully tighten them. After the last screw is positioned, fully tighten all screws.

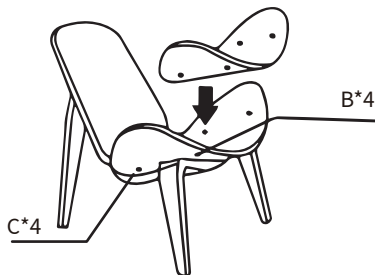

Component Description

Lable	A*M6*15	B*M6*20	C	D	E
Picture					
Description	Screw*6	Screw*22	Washer*10	Screwdriver *1	Iron plate*1