

1

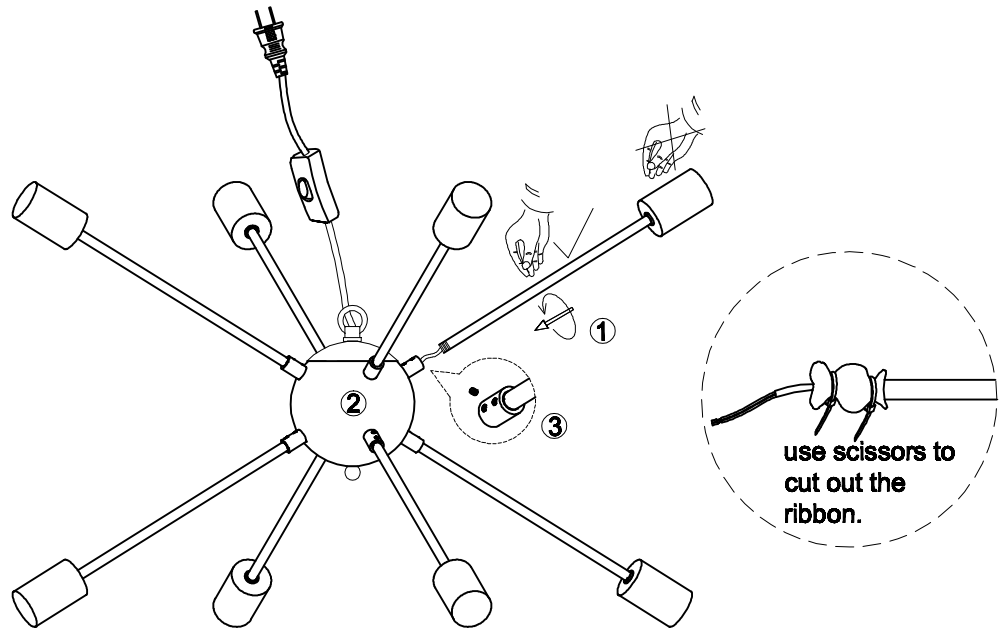

1. Rotate to fix the arms 1 to the ball 2, lock the arms 1 with grub screw.

2

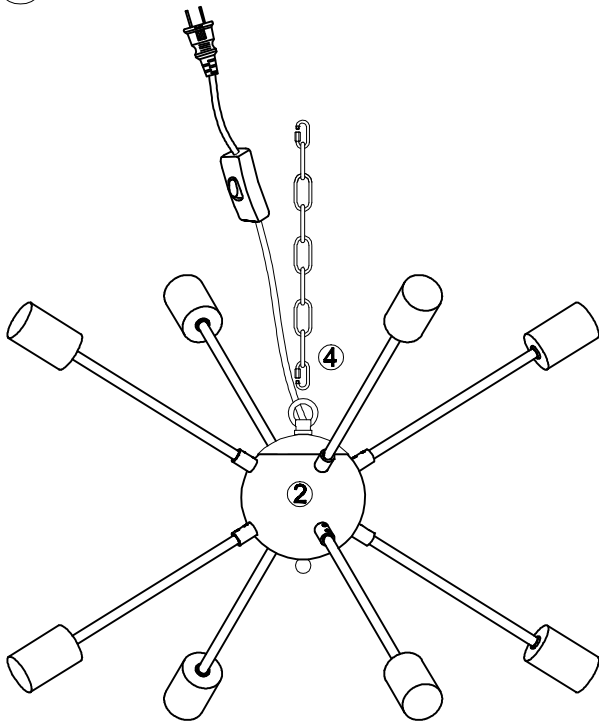

2. Install the chain 4 on the ball 2.

3

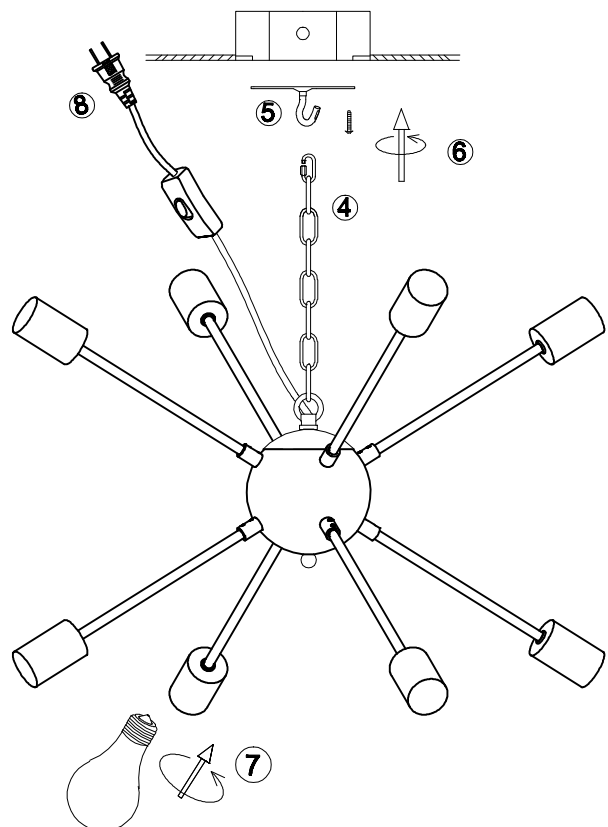

3. Install the hook 5 to the junction box with scrw 6.  
4. Put the chain 4 on the hook 5.  
5. Install the bulbs 7 and plug the switch 8 into the electric socket.

### Y0005S series Installation Manual

Please read carefully before installation!!!

Note : Please make sure that the electricity is powered off during installation !

Only a professional electrician should install this kind of product !