

ASSEMBLY INSTRUCTIONS

MODEL: WATERFALL CONSOLE TABLE

CAUTIONS :

1. Check contents against list for quantity.
2. Familiarize yourself with the components and hardware by reviewing the Assembly Instructions.
3. Do not over tighten the screws and bolts as it may damage the threads.
4. Keep all hardware parts out of the reach of children.

PARTS :

NO	COMPONENT	QTY
1	TOP PANEL	1 PC
2	LEG	2 PCS

HARDWARE :

NO	HARDWARE	QTY
A	JCBC BOLT M6X40MM	8 PCS
B	SPRING WASHER M6X13MM	8 PCS
C	FLAT WASHER M6X19MM	8 PCS
D	L-KEY M4X110MM	1 PC

1

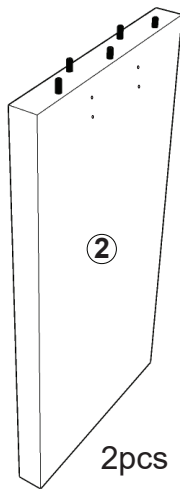

2pcs

*wood dowel already installed

2

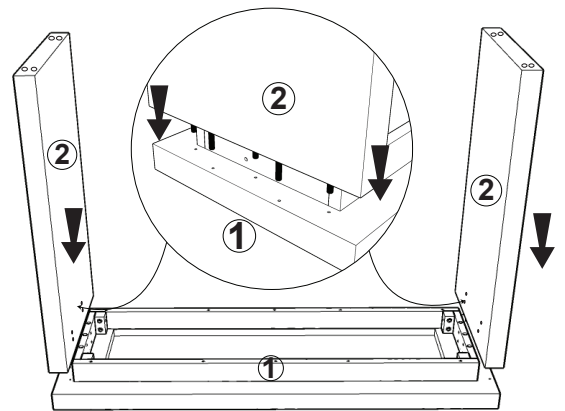

3

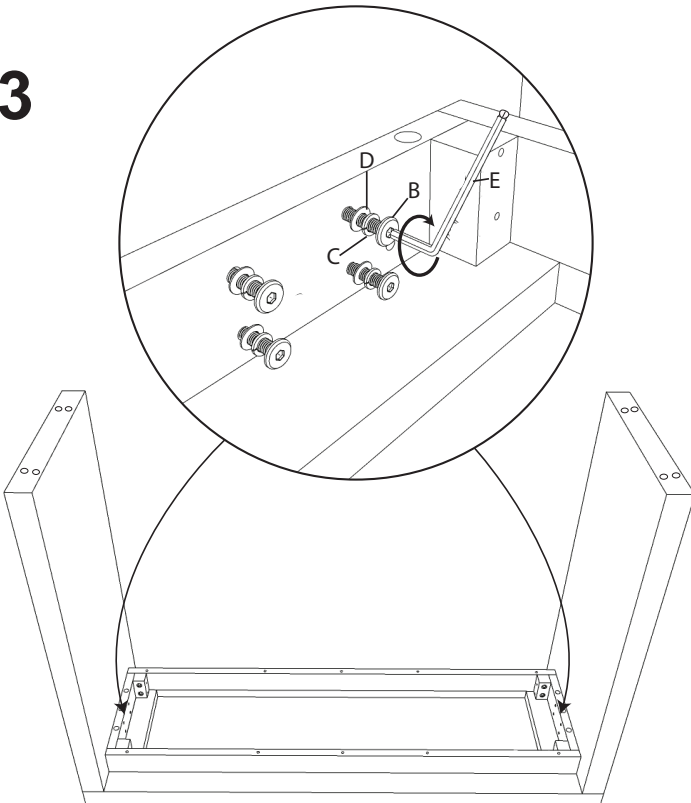

4

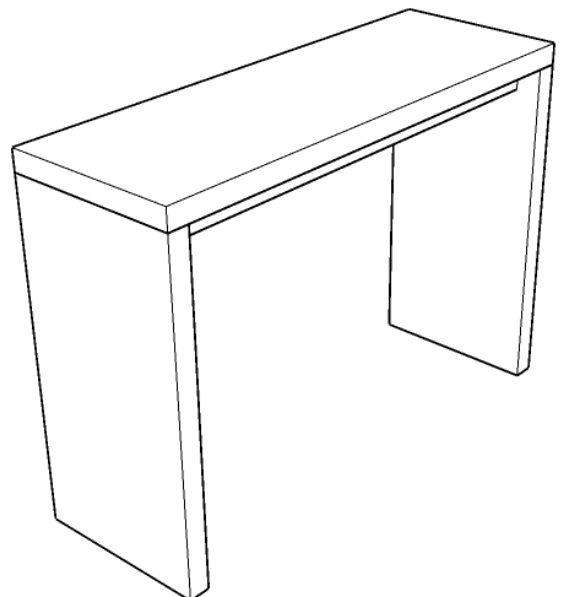

FULLY ASSEMBLE

ASSEMBLY INSTRUCTIONS

MODEL: WATERFALL BENCH

CAUTIONS :

1. Check contents against list for quantity.
2. Familiarize yourself with the components and hardware by reviewing the Assembly Instructions.
3. Do not over tighten the screws and bolts as it may damage the threads.
4. Keep all hardware parts out of the reach of children.

HARDWARE:

NO	HARDWARE	QTY
A	JCBC BOLT M6X40MM	8 PCS
B	SPRING WASHER M6X13MM	8 PCS
C	FLAT WASHER M6X19MM	8 PCS
D	L-KEY M4X110MM	1 PC

PARTS:

	COMPONENT	QTY
①	TOP PANEL	1 PC
②	LEG	2 PCS

1

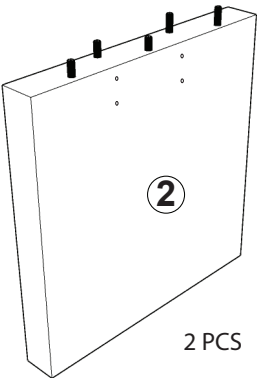

*wood dowel already installed

2

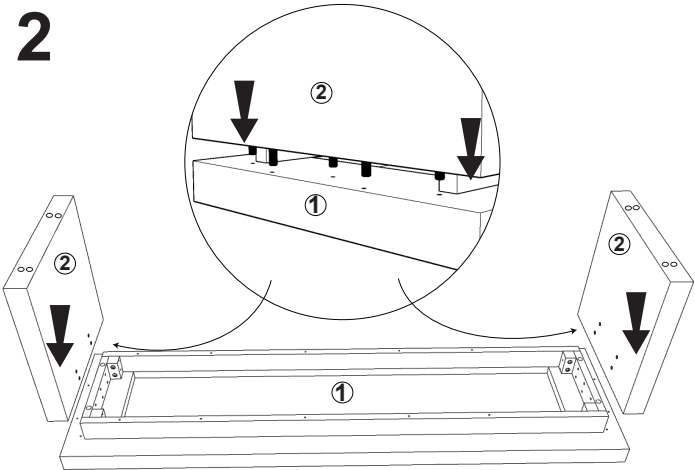

3

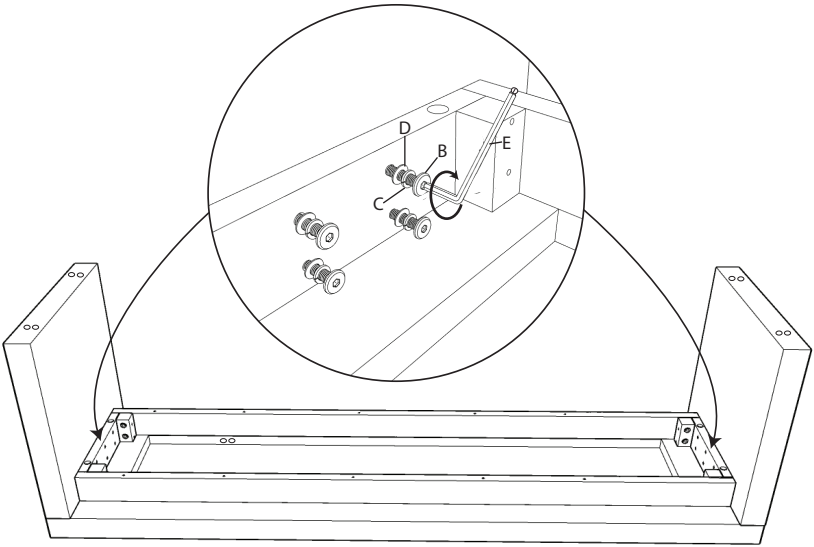

4

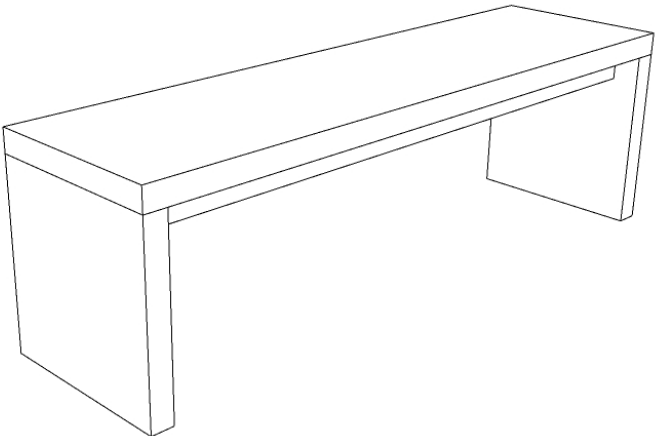

FULLY ASSEMBLE

ASSEMBLY INSTRUCTIONS

MODEL: WATERFALL COFFEE TABLE

CAUTIONS :

1. Check contents against list for quantity.
2. Familiarize yourself with the components and hardware by reviewing the Assembly Instructions.
3. Do not over tighten the screws and bolts as it may damage the threads.
4. Keep all hardware parts out of the reach of children.

PARTS :

NO	COMPONENT	QTY
1	TOP PANEL	1 PC
2	LEG	2 PCS

HARDWARE :

NO	HARDWARE	QTY
A	JCBC BOLT M6X40MM	8 PCS
B	SPRING WASHER M6X13MM	8 PCS
C	FLAT WASHER M6 X 19MM	8 PCS
D	L-KEY M4X110MM	1 PC

1

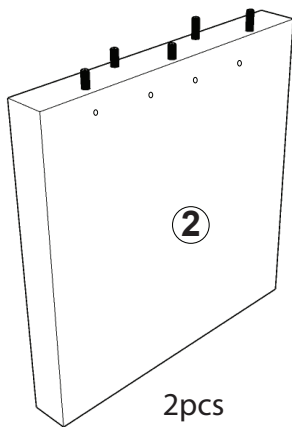

*wood dowel already installed

2

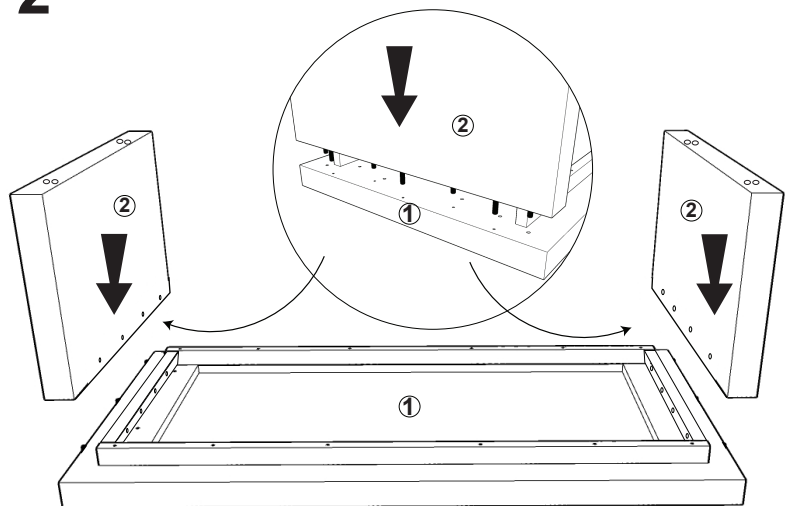

3

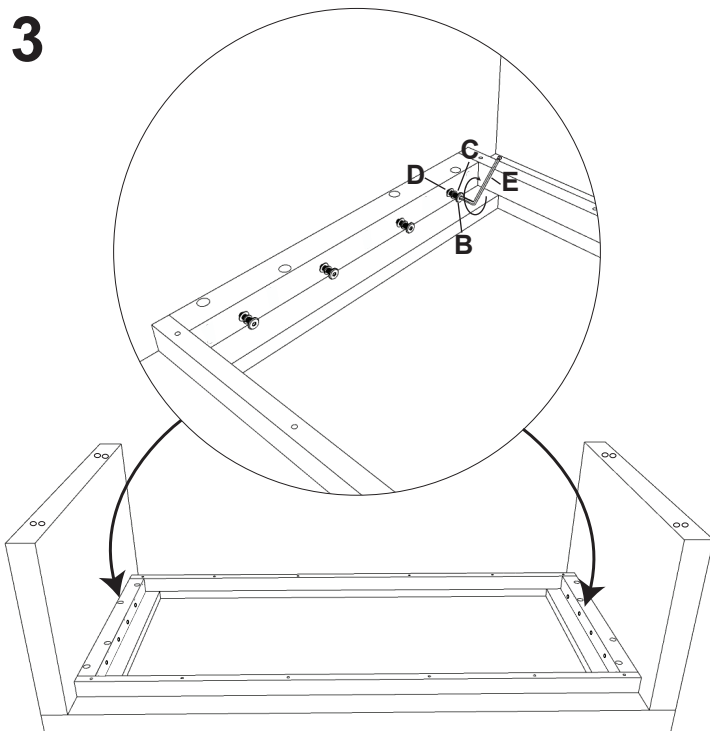

4

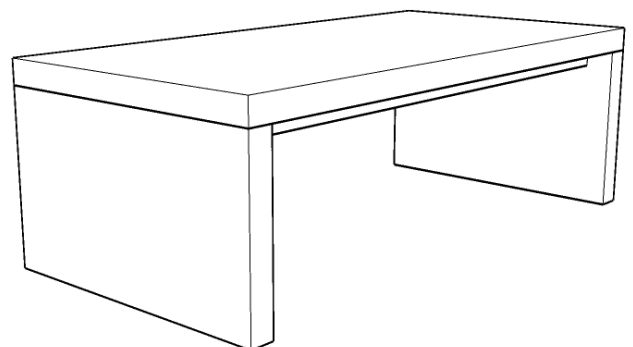

FULLY ASSEMBLE

ASSEMBLY INSTRUCTIONS

MODEL: WATERFALL DINING TABLE

CAUTIONS :

- 1. Check contents against list for quantity.
- 2. Familiarize yourself with the components and hardware by reviewing the Assembly Instructions.
- 3. Do not over tighten the screws and bolts as it may damage the threads.
- 4. Keep all hardware parts out of the reach of children.

HARDWARE :

NO	HARDWARE	QTY
A	JCBC BOLT M6X40MM	16 PCS
B	SPRING WASHER	16 PCS
C	FLAT WASHER	16 PCS
D	L-KEY	1 PC

PARTS :

NO	COMPONENT	QTY
1	TOP PANEL	1 PC
2	LEG	2 PCS

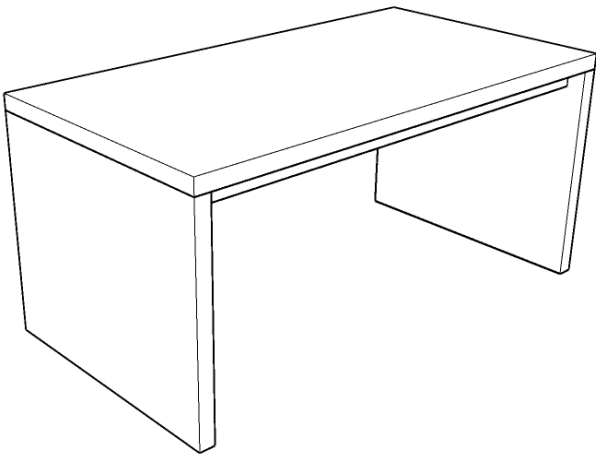
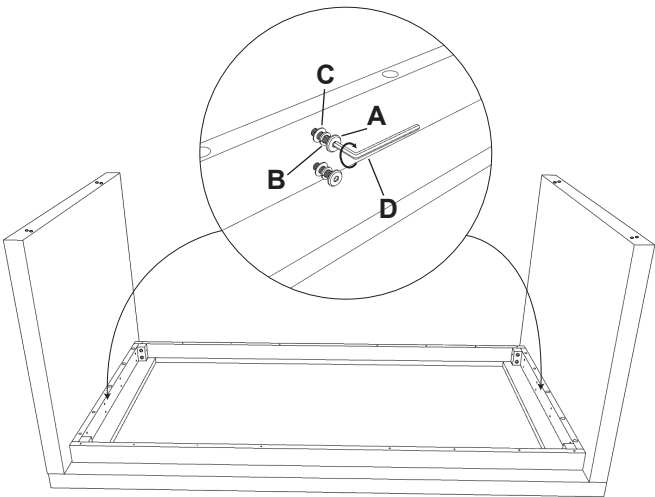
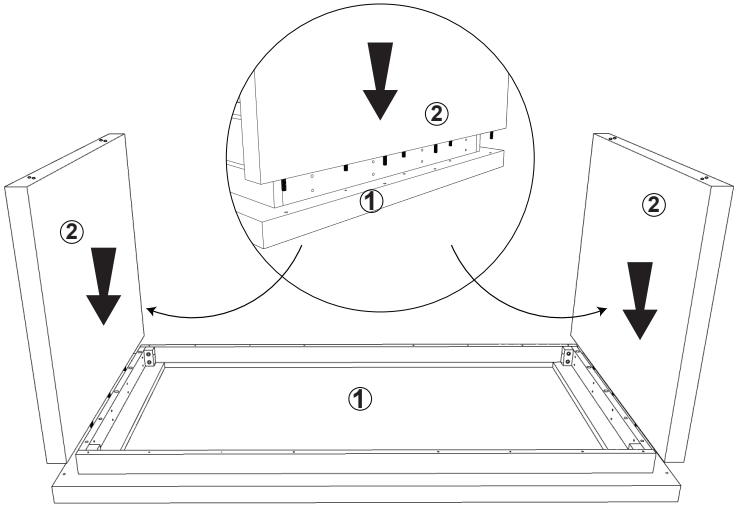
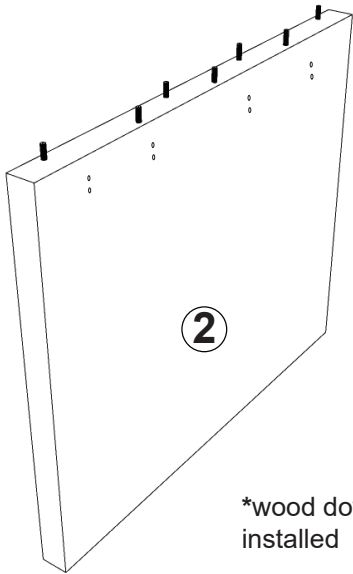

FULLY ASSEMBLE