

Installation sequence

1

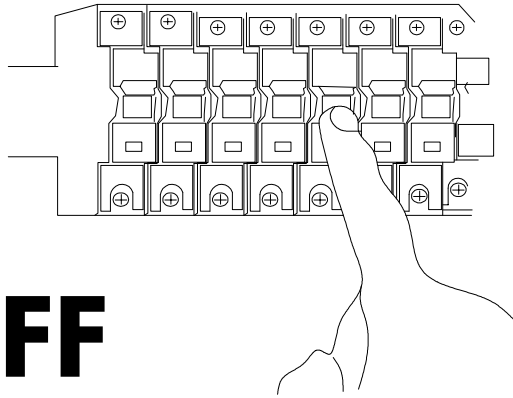

OFF

STEP1

Turn off the power.

2

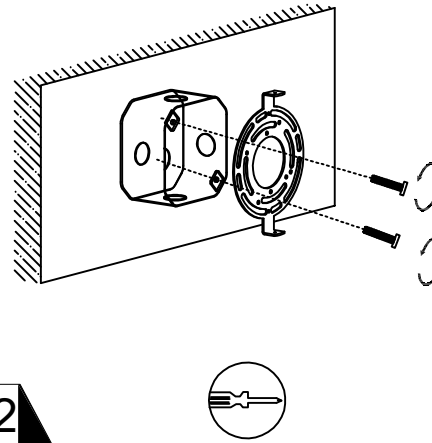

STEP2

Secure the mounting bracket to the junction box using the provided screws.

3

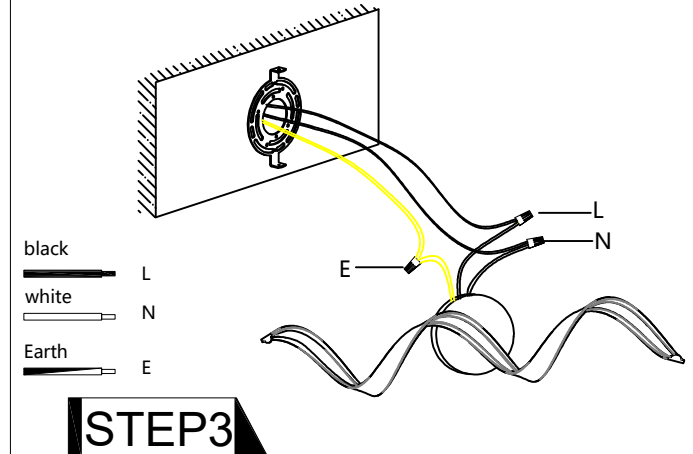

STEP3

Connect the fixture wires to the reserved power supply wires using wire connectors. Make sure to match the live, neutral, and ground wires correctly.

4

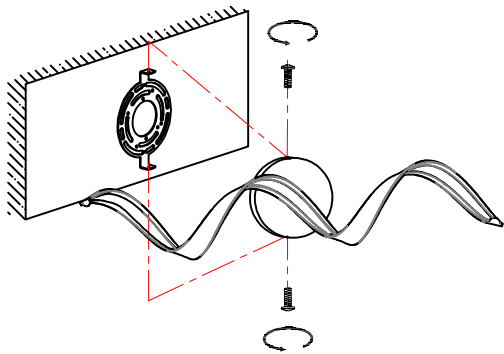

STEP4

Place the canopy on the mounting bracket and secure it with the provided screws.

5



STEP5

Installation is Complete!

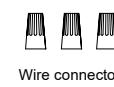

Before installation, please check whether the accessories are complete. If you have any problem, please contact our customer service in time.

Note:

1. Voltage: 110-130V-60Hz
2. Bulb Type: LED
3. Before installation, please cut off the power supply to prevent electric shock.
4. Please be sure the installation step according to the company's instructions.