

Starck Tubs/Shower trays Bathtub # 700009000000090

| < 70 7/8" Inch > |

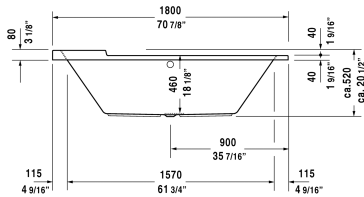
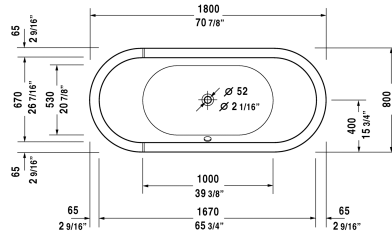

Bathtub	Dimension	Weight	Order number
oval, drop-in, with two backrest slopes, cUPC® listed*, Sanitary acrylic , Filling capacity 45 gal , water level 14 Inch			
Colors			
00 White			
Variant			
incl. support frame, Base tub	70 7/8" x 31 1/2" Inch	57.3 lb	700009000000090
Infobox			
* Complies with the following standards: CSA B45.5/IAPMO Z124			
Suitable products			
Cable-driven waste and overflow ,			790219
Cable-driven waste and overflow brass,			790250
Support frame (included), for bathtubs,			790133

All drawings contain the necessary measurements which are subject to standard tolerances. They are stated in inch & mm and are non-binding. Exact measurements, in particular for customized installation scenarios, can only be taken from the finished ceramic piece.