

MELBOURNE FULL / QUEEN / KING BED

ASSEMBLY INSTRUCTIONS

BOX #1

A. HEADBOARD 1PC

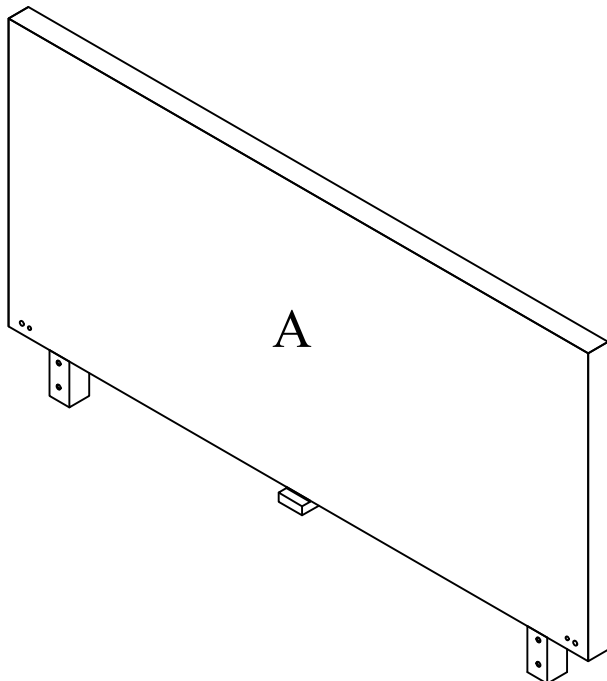

BOX #3

D. SIDE RAIL 2 PCS

E. CENTER SLAT SUPPORT 1 PC

F. SUPPORT LEG 3 PCS

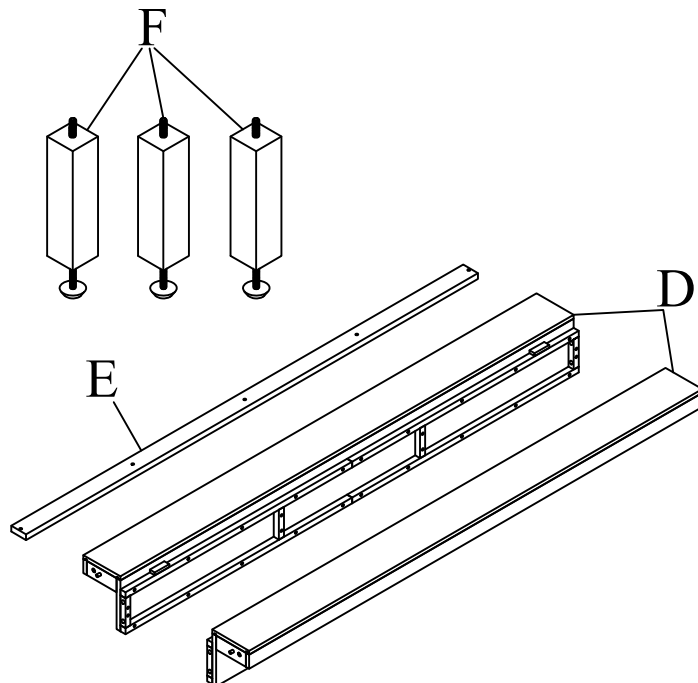

BOX #2

B. FOOTBOARD 1PC

C. SLAT ROLL 1 SET

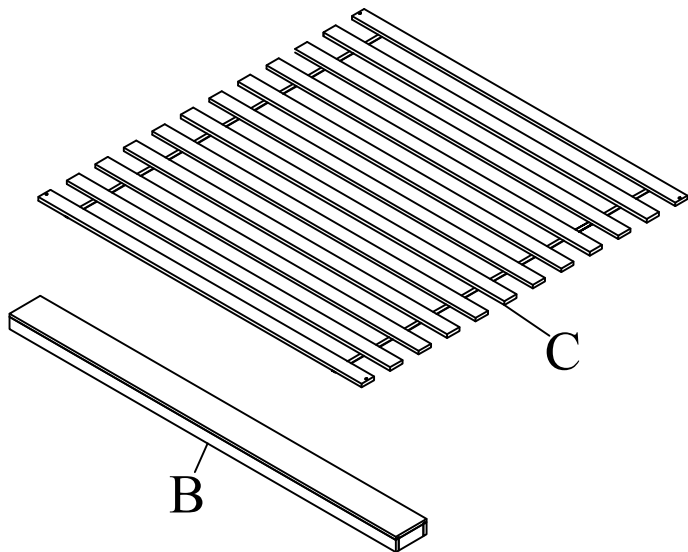

HARDWARE PACKED IN BOX #2

1	ALLEN BOLT (M8X90)		2 PCS
2	ALLEN BOLT (M8X40)		10 PCS
3	SPRING WASHER (M8X13)		12 PCS
4	FLAT WASHER (M8X16)		12 PCS
5	WOOD SCREW (M4X30)		6 PCS
6	ALLEN KEY		1 PC

TOOL REQUIRED
PHILLIPS HEAD SCREW DRIVER
(NOT PROVIDED)

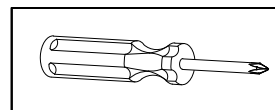

MELBOURNE BED FULLY ASSEMBLED

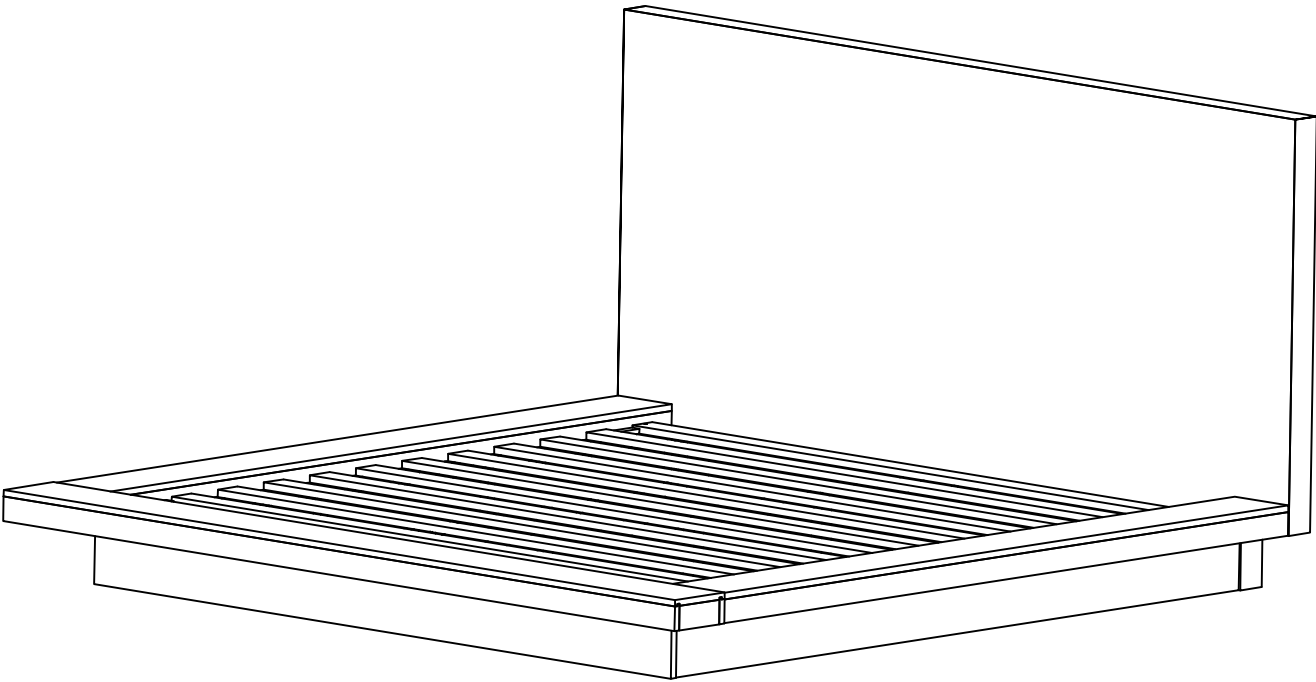

STEP 1:

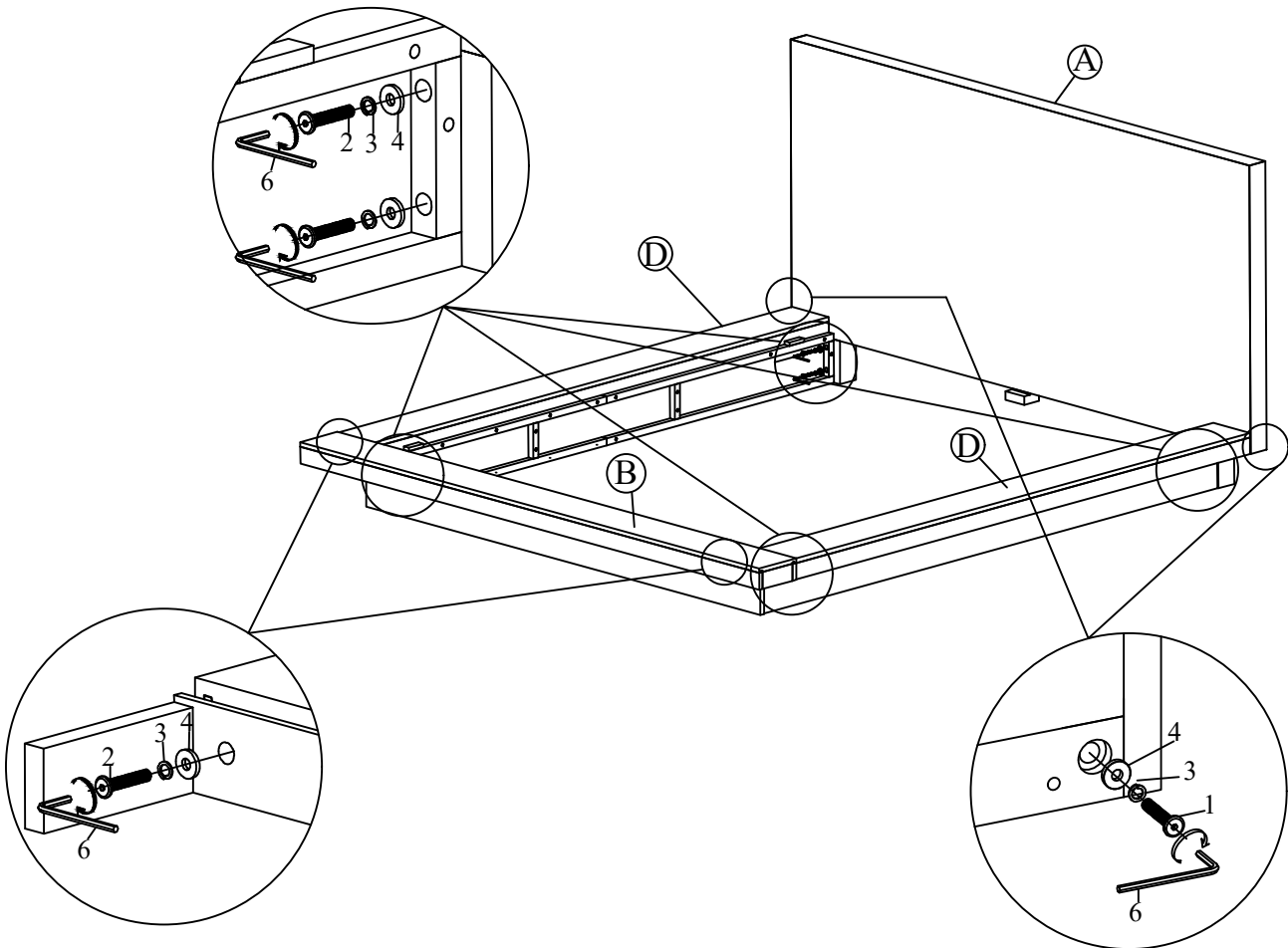

STEP 2:

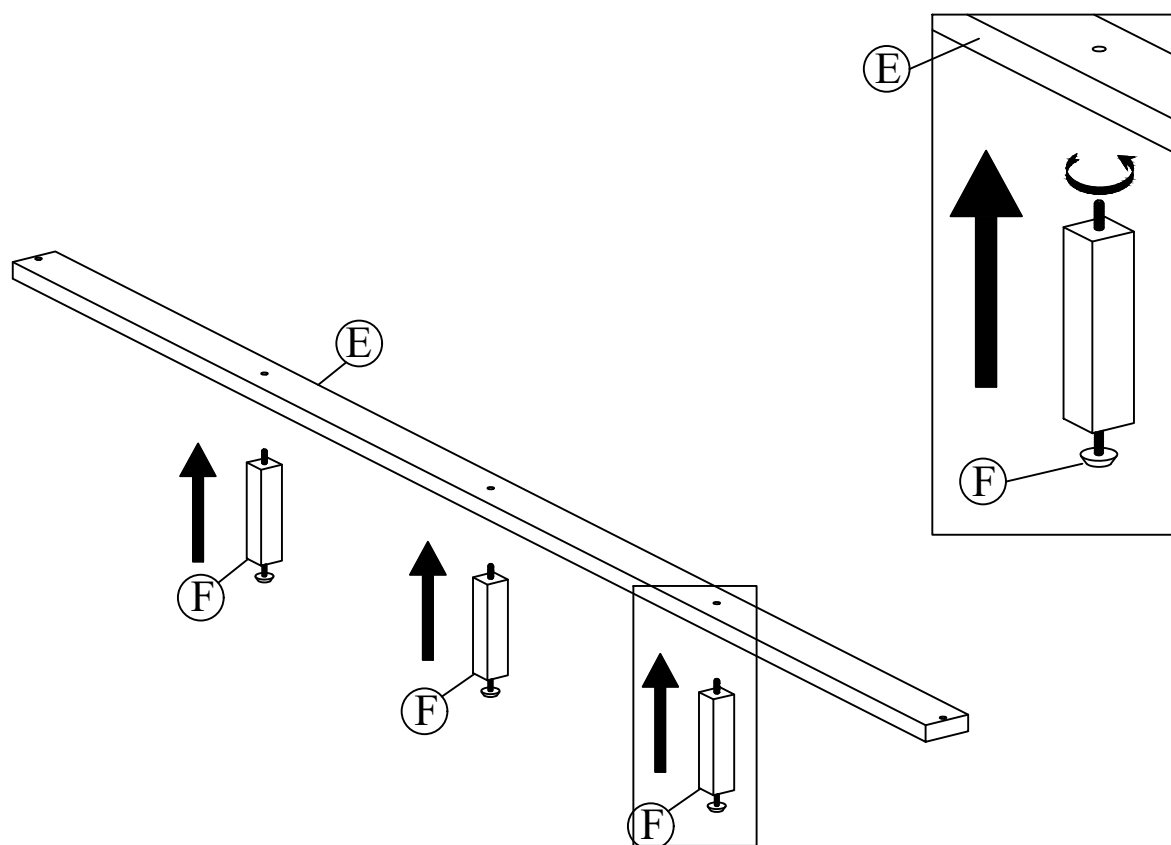

STEP 3:

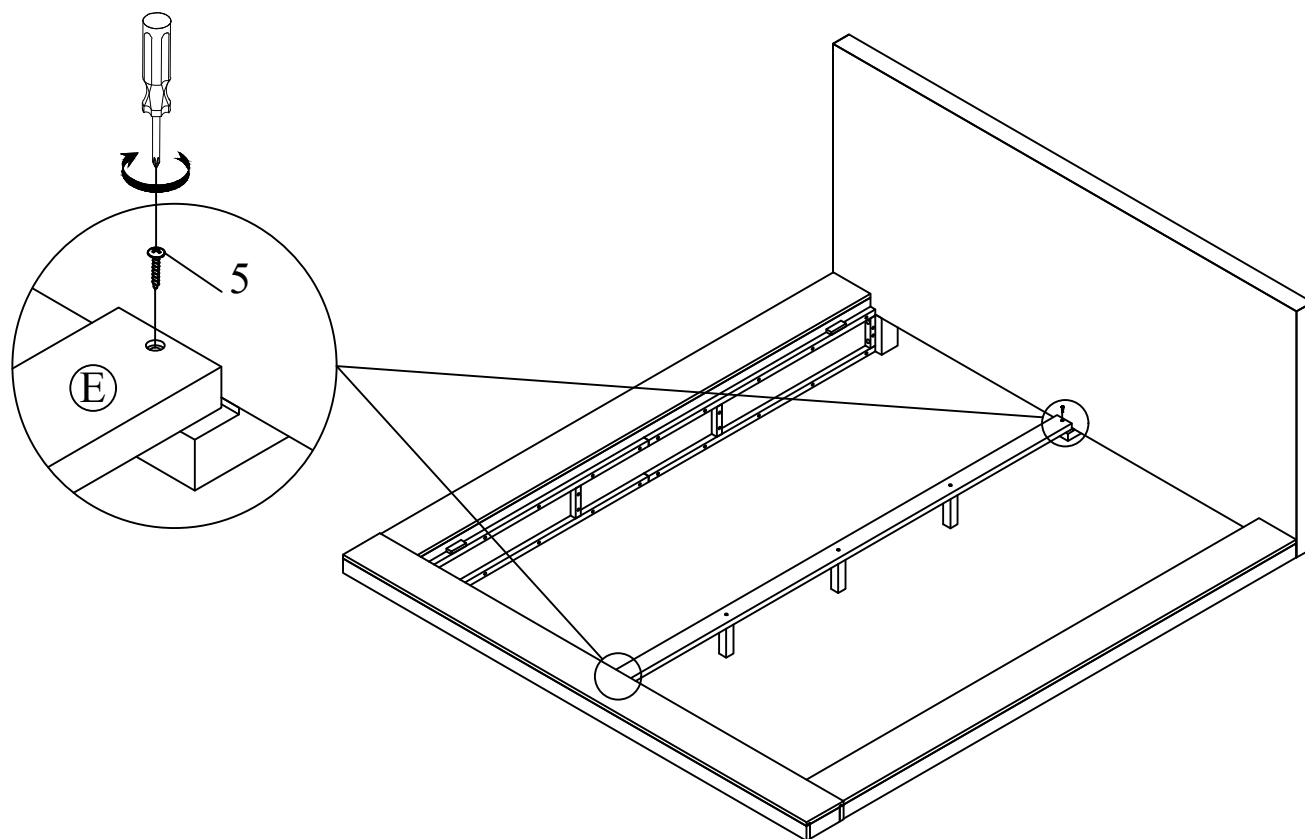

STEP 4:

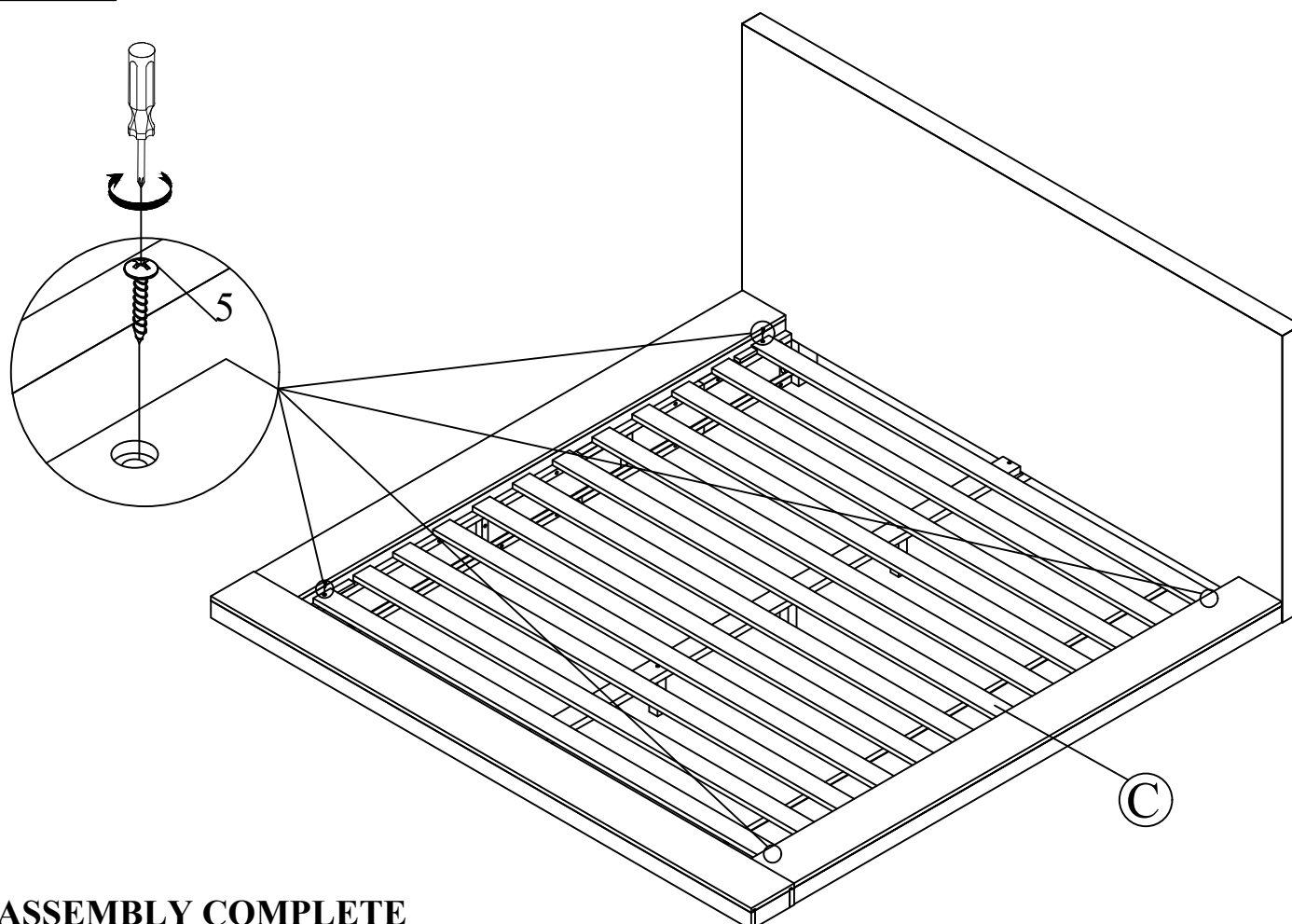

INSTRUCTIONS FOR ADJUSTING LEVELER:

**POSITION THE BED IN YOUR SPACE
AND LOCATE THE LEVELER UNDER
EACH SUPPORT LEG. TURN THE
LEVELER COUNTER-CLOCKWISE
TO EXTEND THE LEVELER AND
CLOCKWISE TO RETRACT IT.**

**ADJUST EACH LEVELER UNTIL
EACH SUPPORT LEG IS APPLYING
EQUAL, UPWARD PRESSURE ON
THE SUPPORT SLAT.**

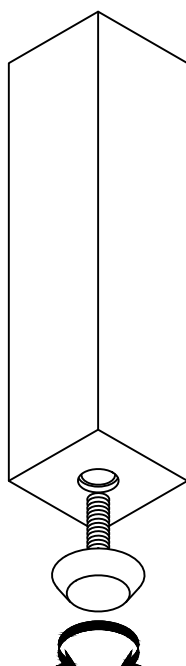

MAINTENANCE INSTRUCTIONS:

**REMOVE YOUR MATTRESS, AND
BOX SPRING IF APPLICABLE,
BEFORE MOVING YOUR BED.**

**LIFT YOUR BED WHEN MOVING IT;
DRAGGING CAN DAMAGE THE
SUPPORTS.**

**RE-ADJUST THE LEVELERS AFTER
MOVING YOUR BED.**