

Hall Tree

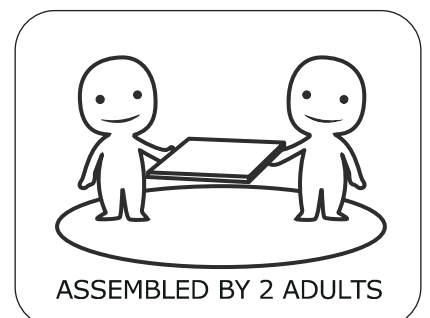

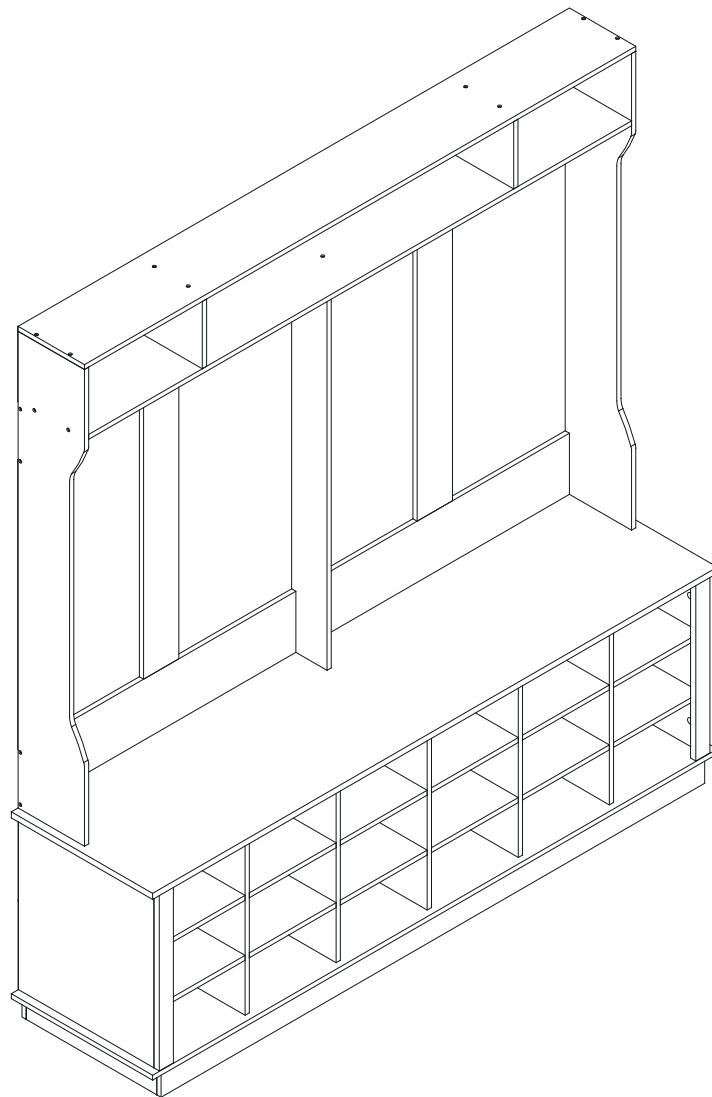
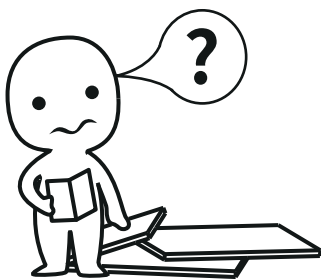

IMPORTANT INFORMATION!

please read the entire manual before starting to assemble and/or using this product. follow the manual thoroughly and keep it for further reference.

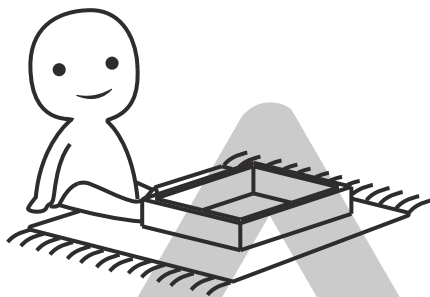

AVOID SCRATCHES!

In order to avoid scratching this furniture should be assembled on a soft layer-could be a rug.

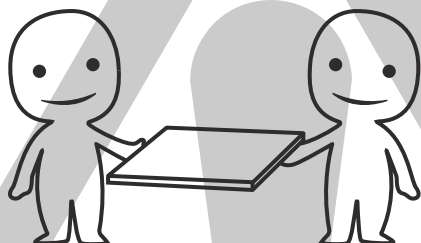

IMPROVE EFFICIENCY !

Try to find a partner to install with you, which can speed up the installation efficiency and shorten the time.

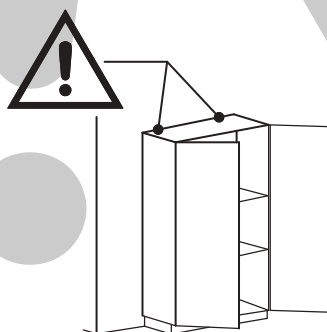
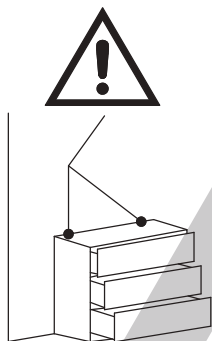

ANTI-TOPPLE WARNING !

Overturned furniture can cause serious or fatal crush injuries. To prevent tipping over, be sure to use the wall attachment, if not included with this product. Please purchase the wall attachment that fit your wall. If unsure, seek professional advice. Please read and follow each step of the instructions carefully.

IMPORTANT !

It is important that any product which is assembled using any kind of screw is re-tightened 2 weeks after assembly, and once every 3 months - in order to assure stability throughout the lifespan of the product.

For regular maintenance and cleaning of the product, for the frame, please use a rag dipped in neutral detergent to fully wipe it, and then dry it with a clean rag. For glass materials, wipe with a rag dampened with water glass cleaner, and then dry with a dry rag.

Do not use an electric screwdriver, and do not use too much force when installing, because the board is easy to break.

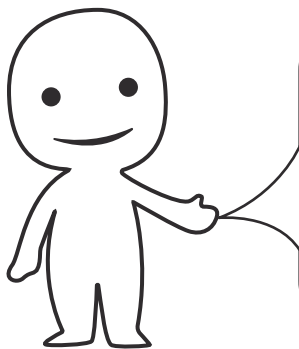

Please prepare the following tools

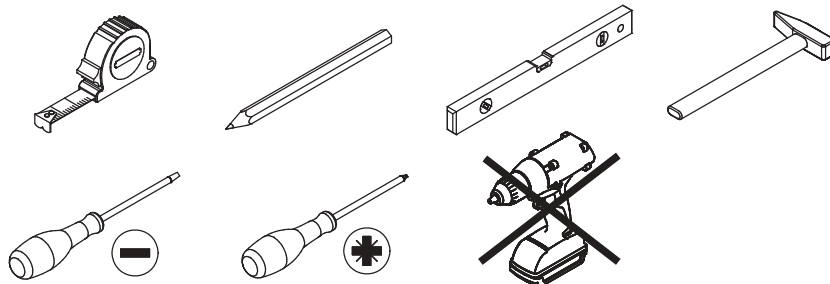

When installing, please carefully confirm whether each screw corresponds to the manual, accessories with similar shapes can be distinguished by size

A x 98

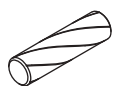

Φ6 x 30 mm

B x 54

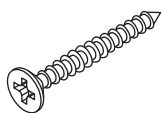

Φ4 x 40 mm

C x 34

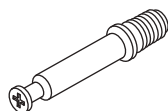

Φ6 x 35 mm

D x 34



Φ15 x 9 mm

E x 12



Φ3 x 12 mm

F x 6



G x 24



Φ6 x 50 mm

H x 70



Φ3 x 12 mm

K x 16



! WARNING



Children have died from furniture tipover. To reduce the risk of furniture tipover:

- ALWAYS install tipover restraint provided.
- NEVER put a TV on this product.
- NEVER allow children to stand, climb or hang on drawers, doors, or shelves.
- NEVER open more than one drawer at a time.
- Place heaviest items in the lowest drawers.

*This is a permanent label.
Do not remove!*

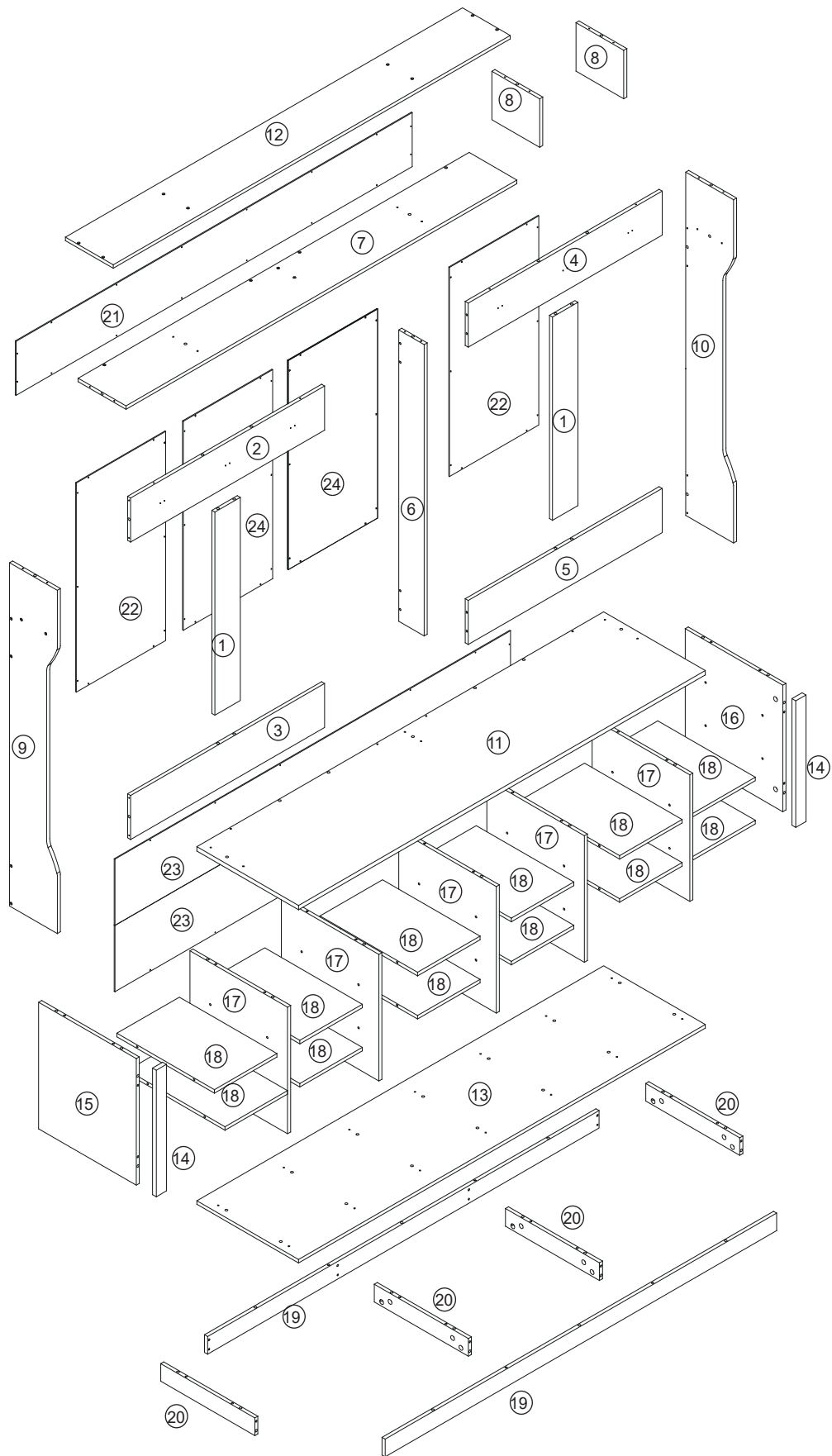

1

F x 6



E x 12



Φ3 x 12 mm

A x 8



Φ6 x 30 mm

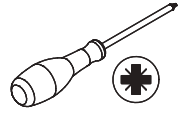

Fix hook(F) to plate 2 and 4 using screw(E) as shown.
Connect plate 2 and 3 with plate 1 using wooden dowel(A) as shown.

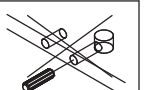
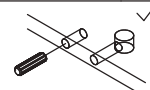

Connect plate 4 and 5 with plate 1 using wooden dowel(A) as shown.

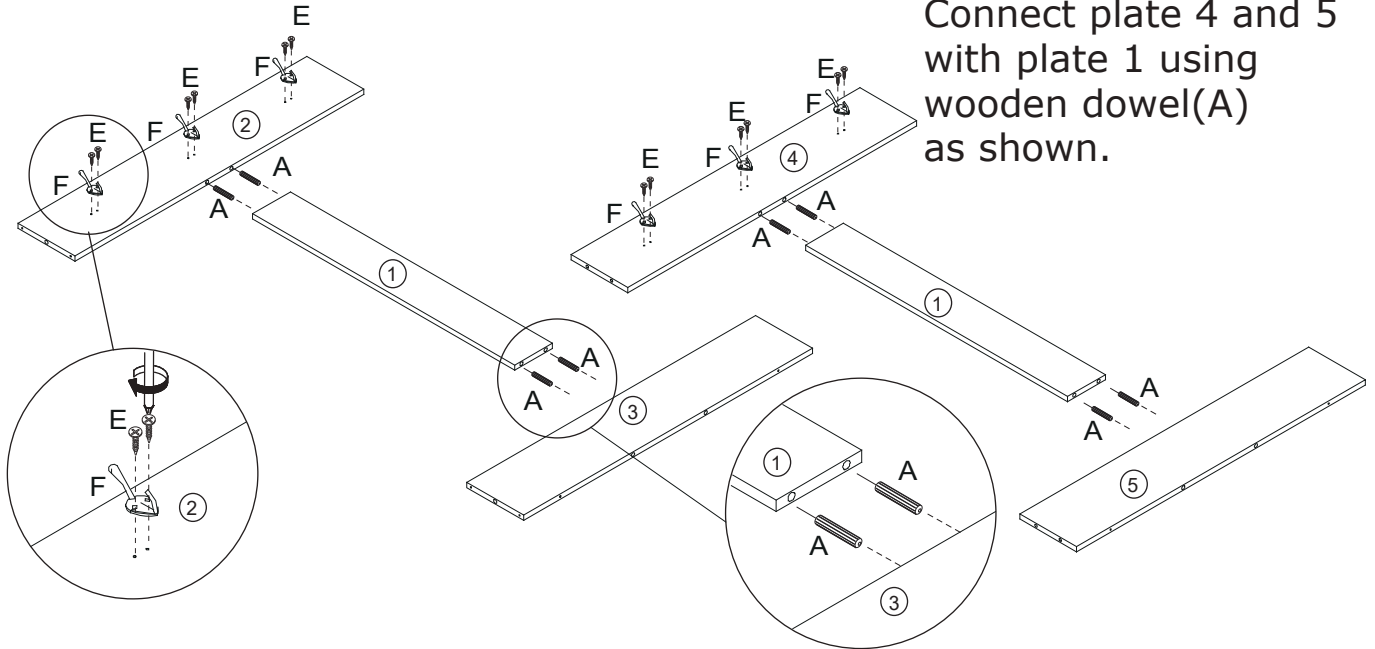

2

G x 4



Φ6 x 50 mm

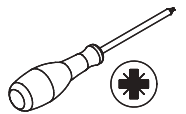

Connect the two components with plate 6 using LONG wooden dowel(G) as shown.

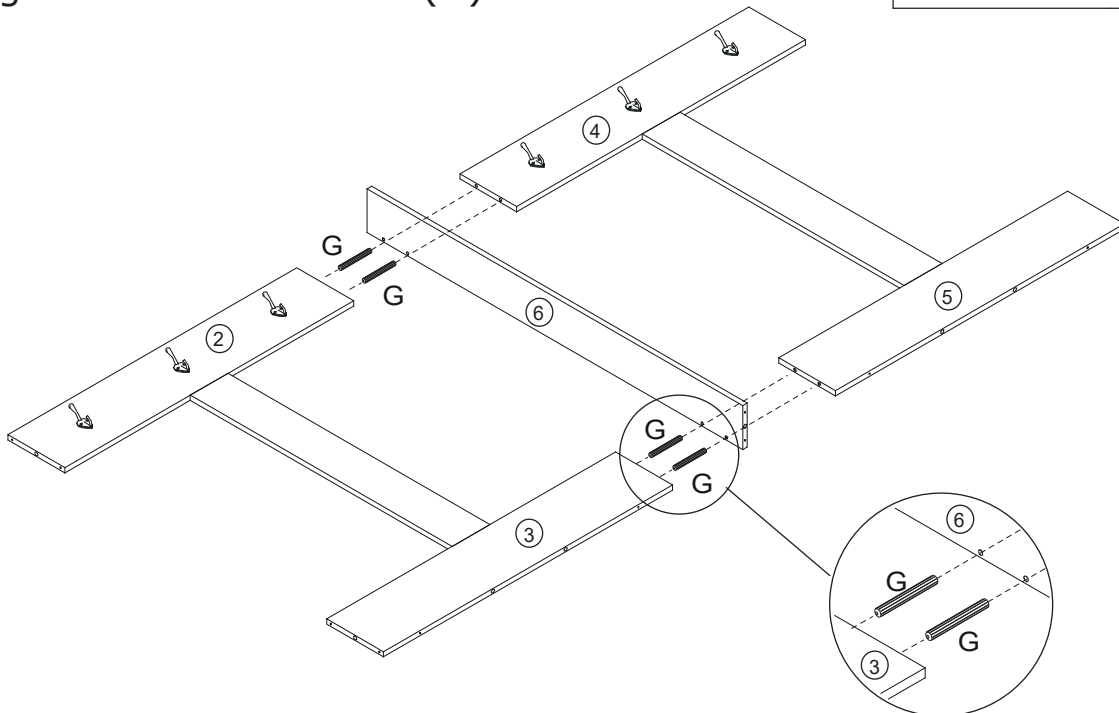
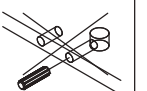
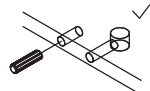

3

A x 5



Φ6 x 30 mm

B x 6



Φ4 x 40 mm

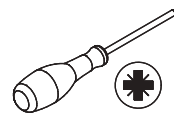

Attach plate 7 to plate 2,6 and 4 with wooden dowel(A), then fix using screw(B) as shown.

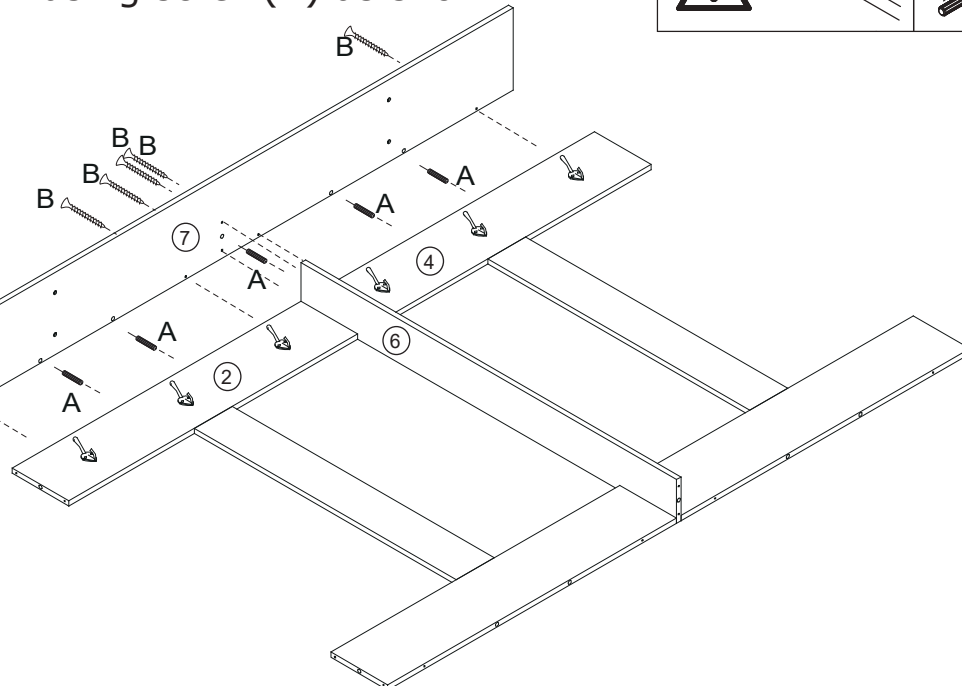
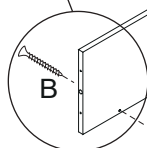
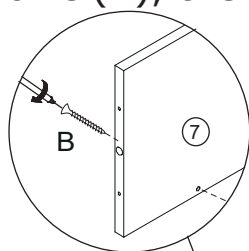
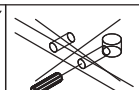
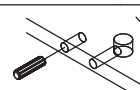

4

A x 8



Φ6 x 30 mm

B x 16



Φ4 x 40 mm



Attach plate 9 to plate 7,2 and 3 with wooden dowel(A), then fix using screw(B) as shown. Attach plate 10 to plate 7,4 and 5 with wooden dowel(A), then fix using screw(B) as shown.

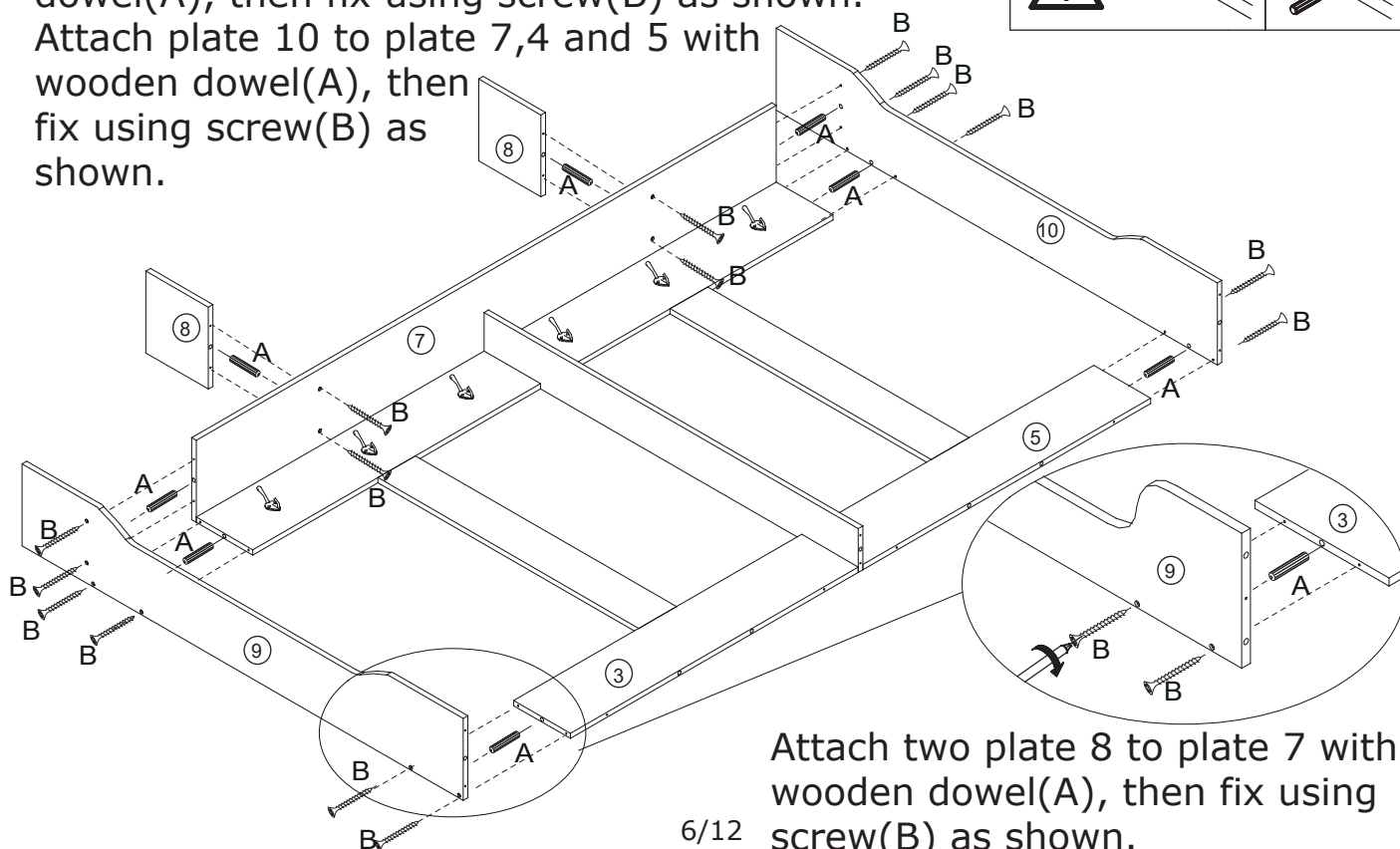
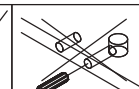
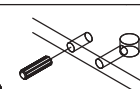

Attach two plate 8 to plate 7 with wooden dowel(A), then fix using screw(B) as shown.

5

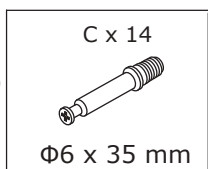

Insert quickfit screw(C) into corresponding holes in plate 11 with a screwdriver as shown.

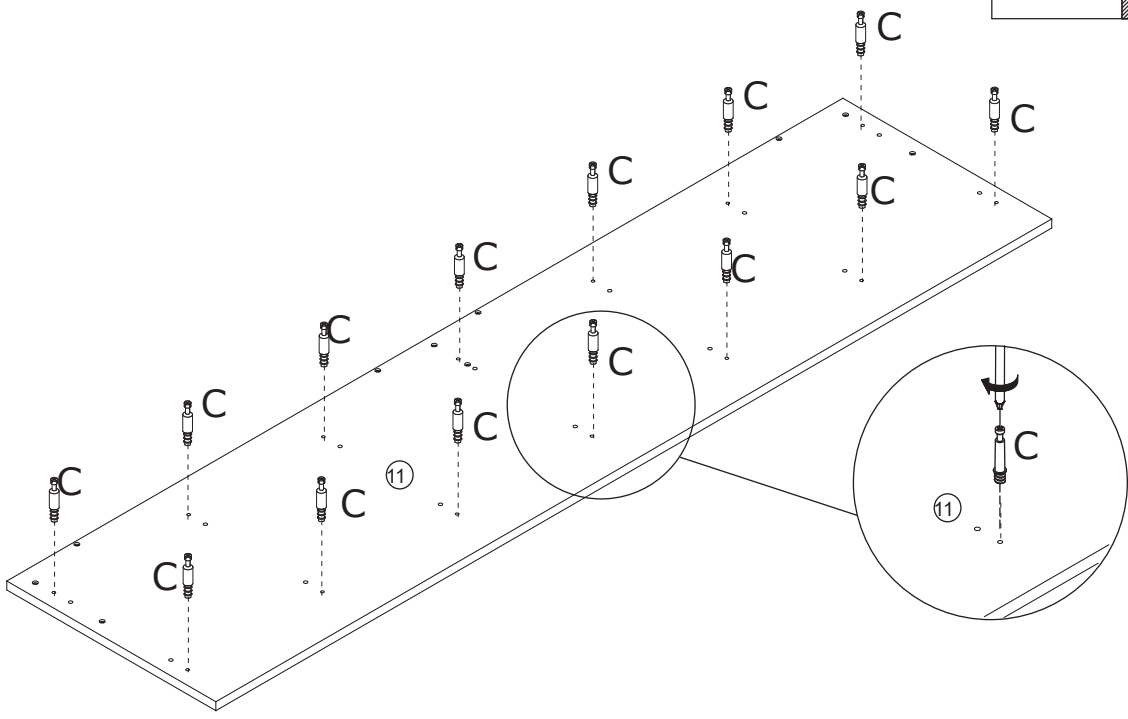
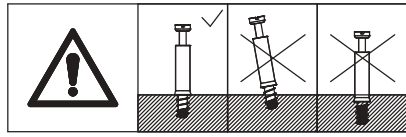

6

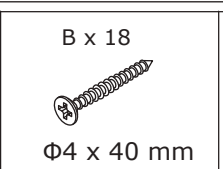
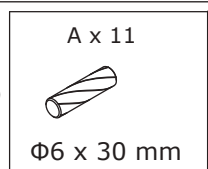

Attach plate 12 to the top of the component with wooden dowel(A), then fix using screw(B) as shown.

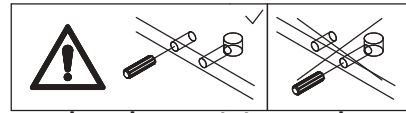

Attach plate 11 to the bottom of the component with wooden dowel(A), then fix using screw(B) as shown.

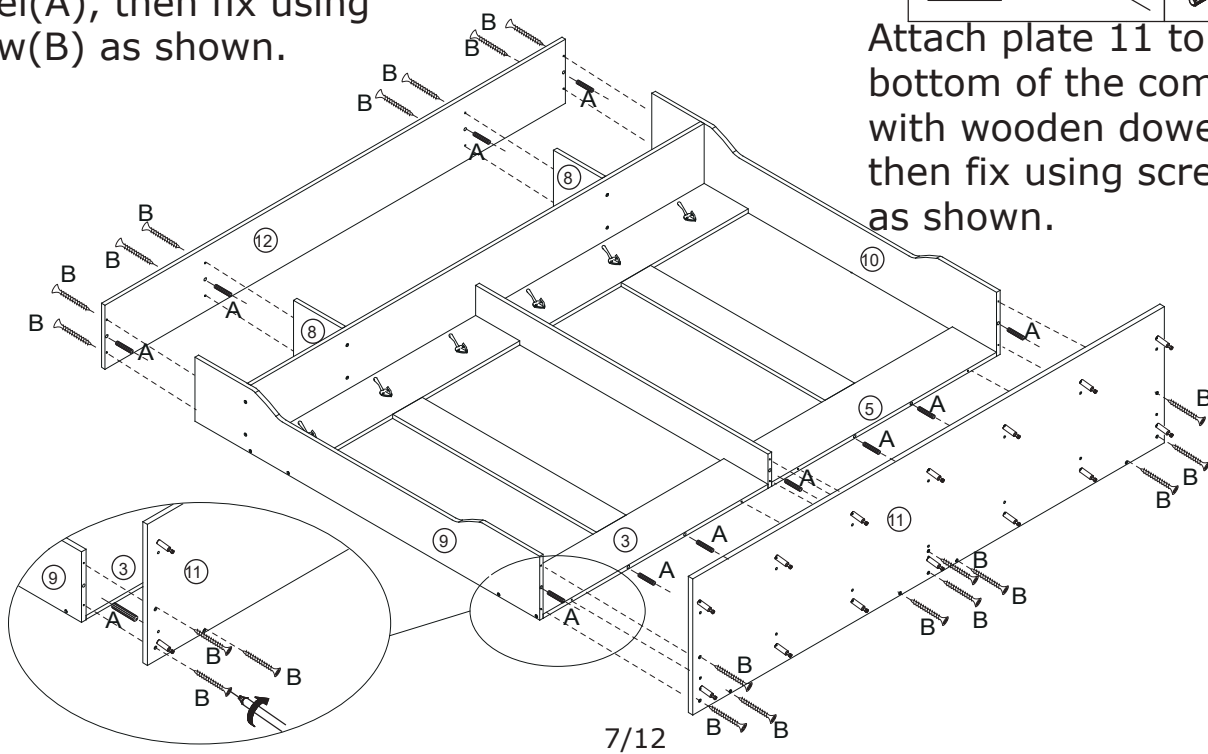

7

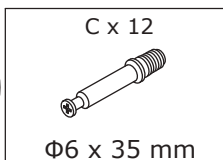

Insert quickfit screw(C) into corresponding holes in plate 13 with a screwdriver as shown.

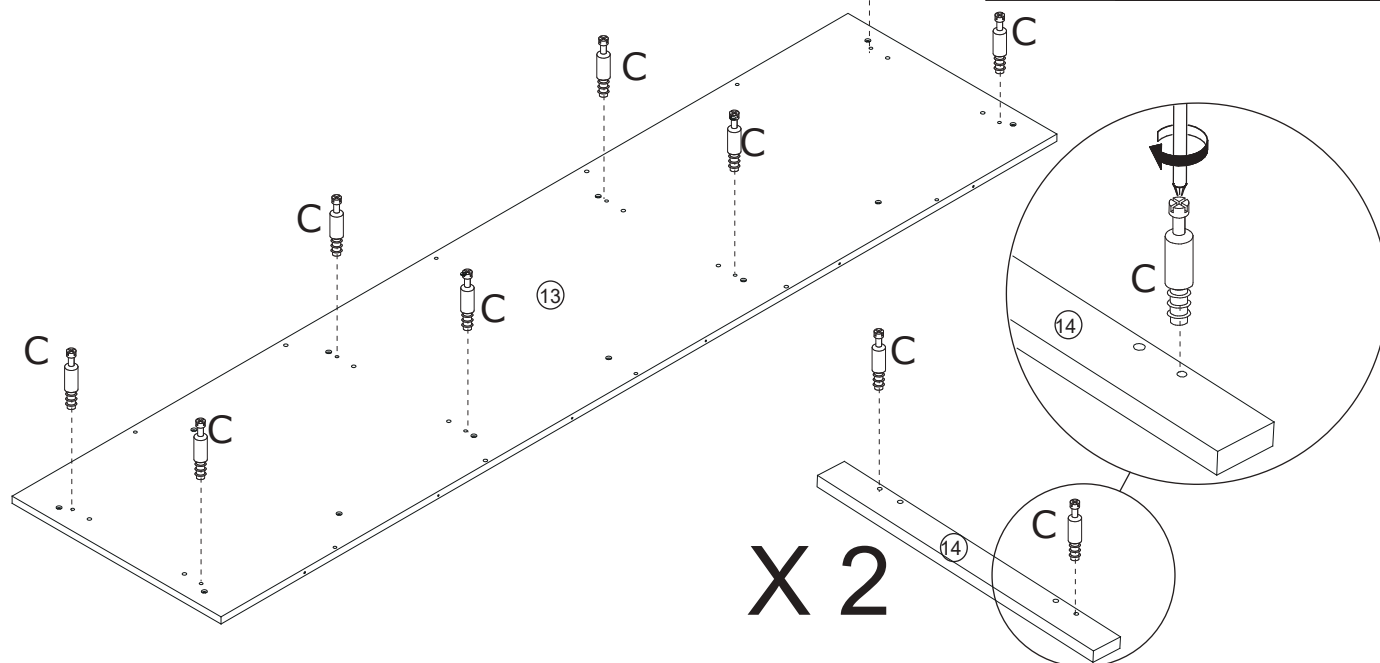
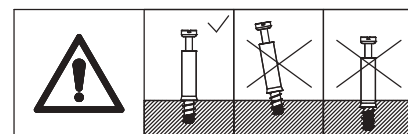

8

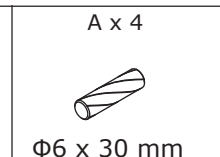
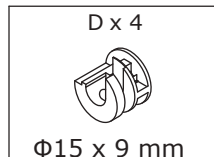

Attach plate 16 to plate 14 with wooden dowel(A), put cam lock(D) into holes in plate 16 and turn clockwise to tighten as shown.

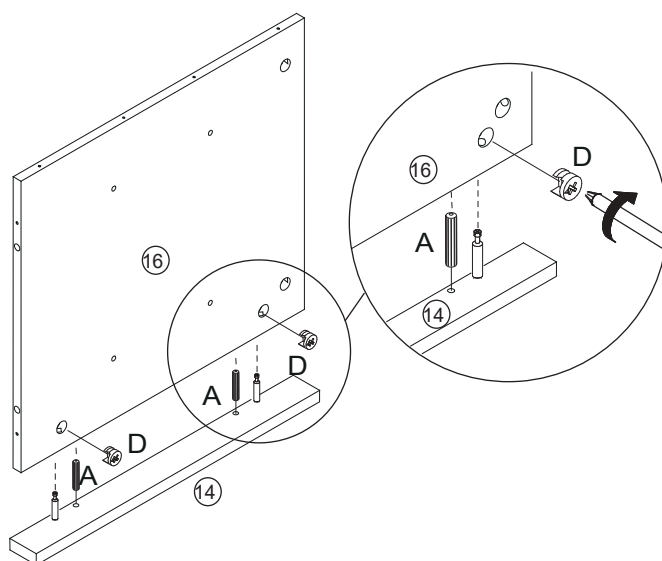
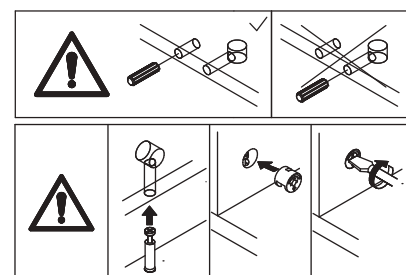

Attach plate 15 to plate 14 with wooden dowel(A), put cam lock(D) into holes in plate 15 and turn clockwise to tighten as shown.

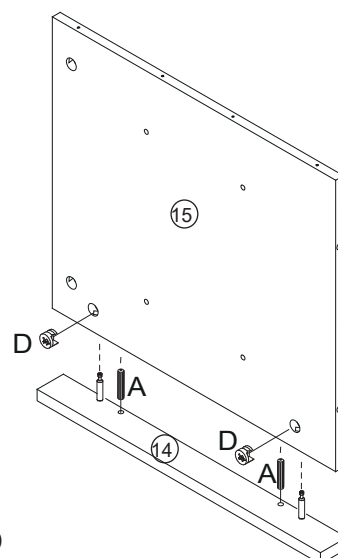

9

G x 20

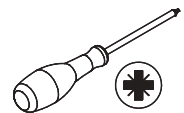
 Φ6 x 50 mm

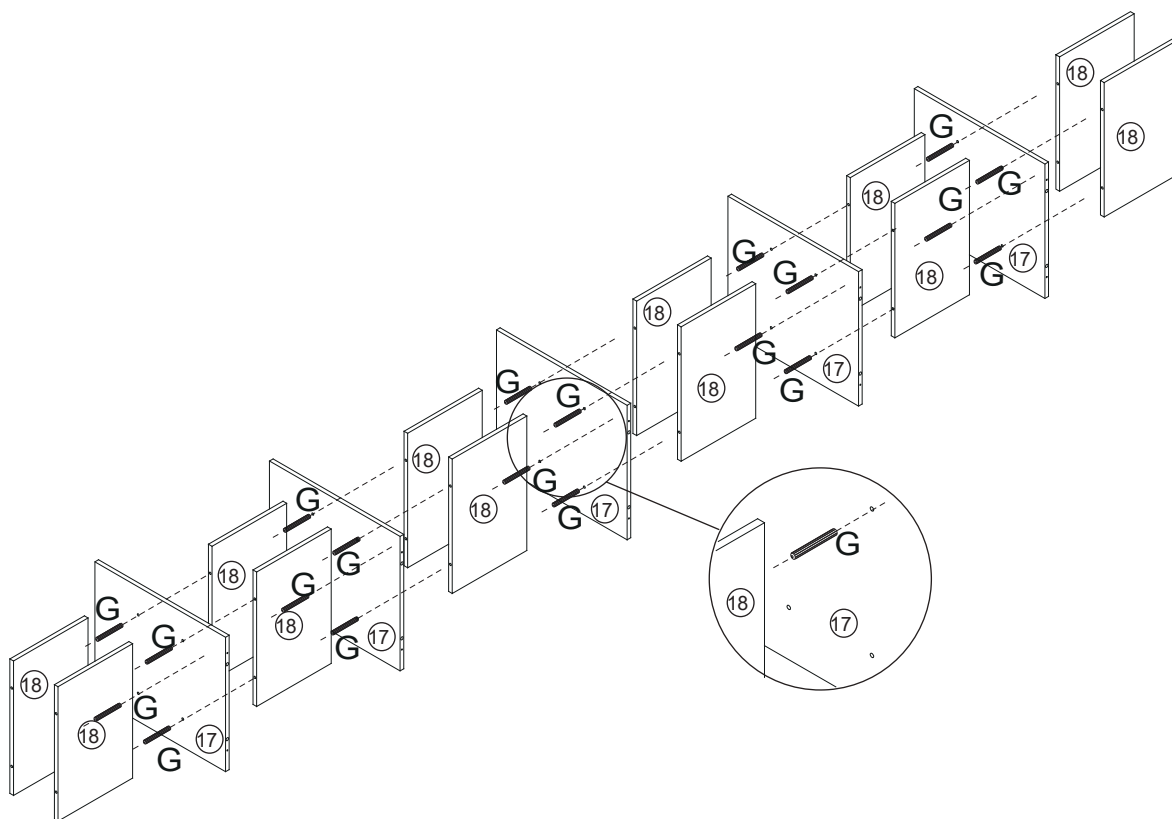
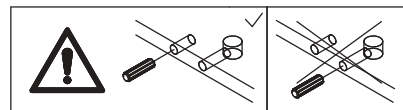

Connect plate 17 with plate 18 together using LONG wooden dowel(G) as shown.



10

A x 8

 Φ6 x 30 mm

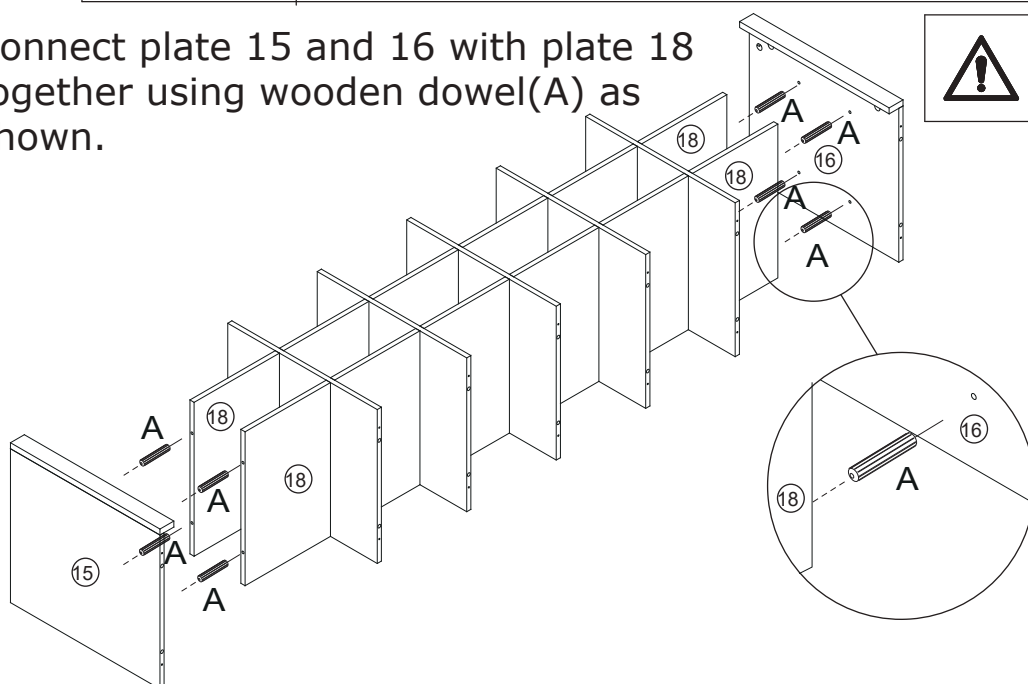
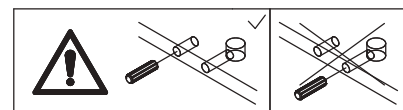

Connect plate 15 and 16 with plate 18 together using wooden dowel(A) as shown.



11

A x 14



Φ6 x 30 mm

B x 14



Φ4 x 40 mm



Attach plate 13 to plate 15,17 and 16 with wooden dowel(A), then fix using screw(B) as shown.

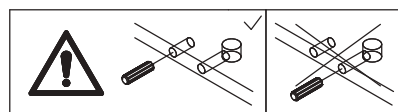
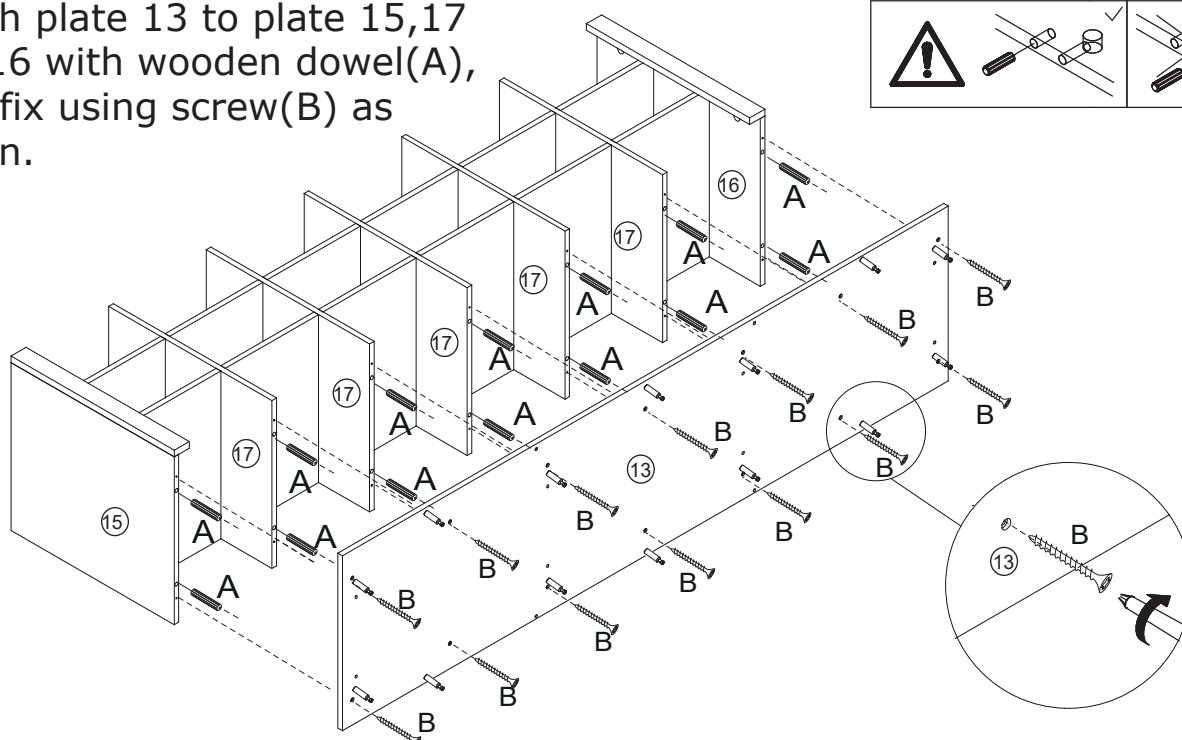

12

C x 8

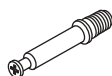

Φ6 x 35 mm



X 2

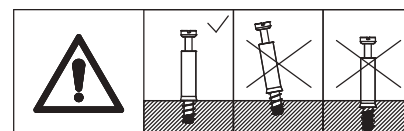
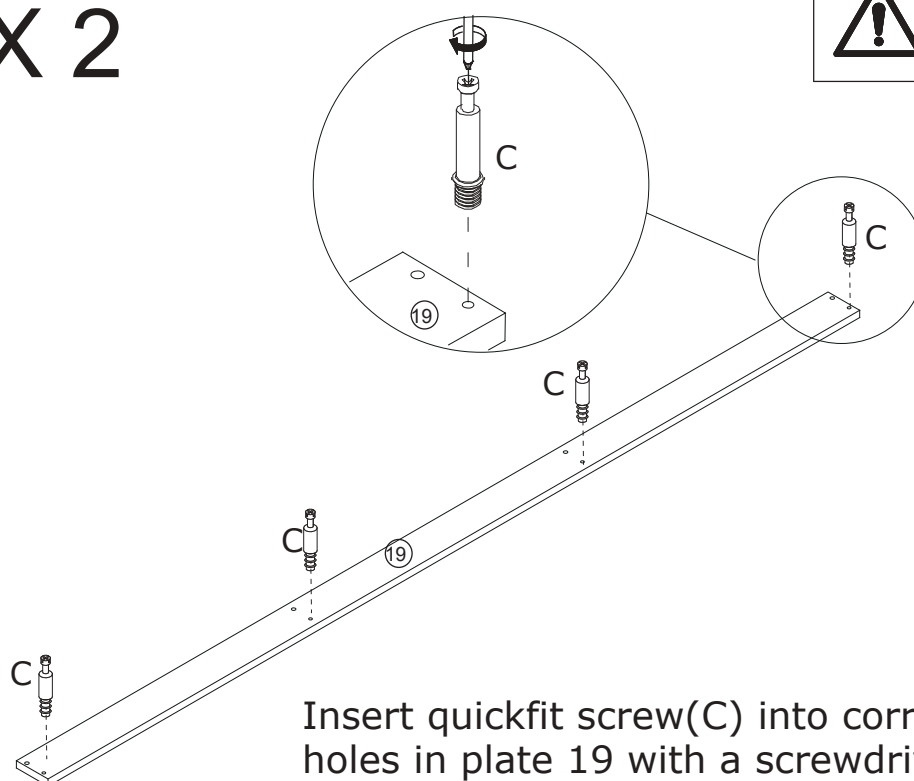

Insert quickfit screw(C) into corresponding holes in plate 19 with a screwdriver as shown.

13

D x 8



Φ15 x 9 mm

A x 8



Φ6 x 30 mm



Connect plate 19 with plate 20 together using wooden dowel(A), put cam lock(D) into holes in plate 20 and turn clockwise to tighten as shown.

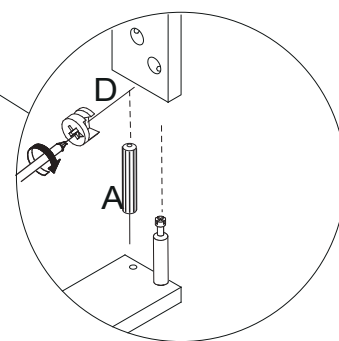
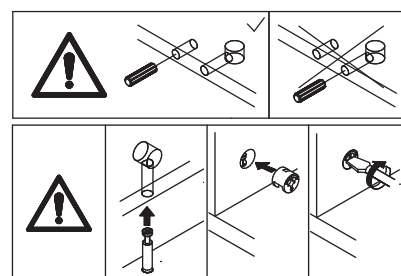
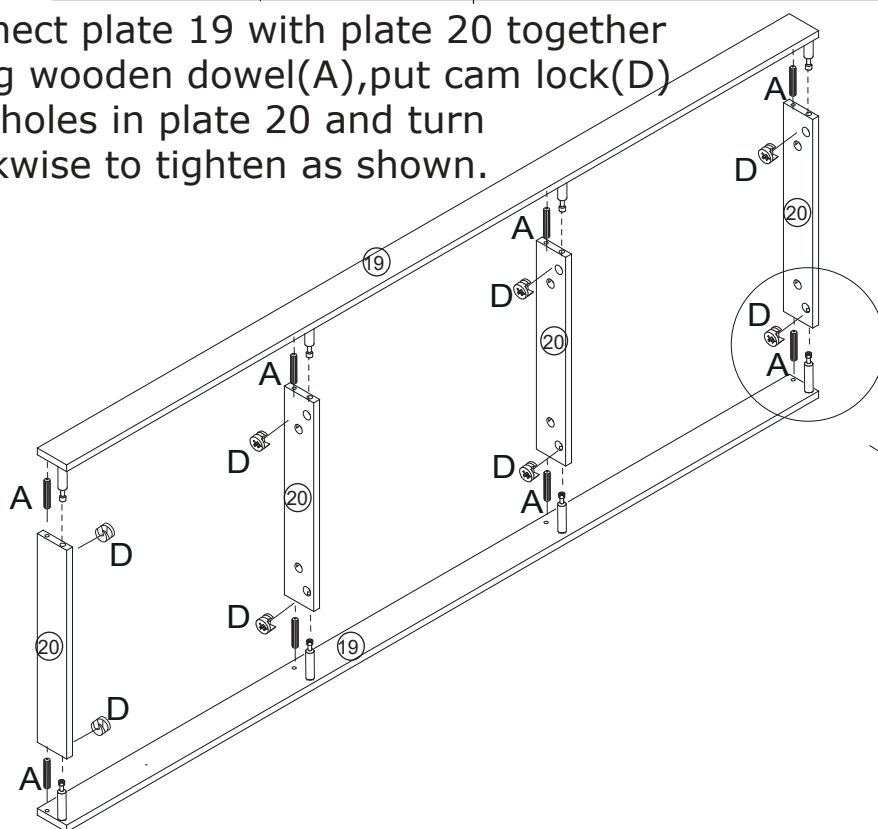

14

D x 8



Φ15 x 9 mm

A x 18



Φ6 x 30 mm



Attach the base component to plate 13 with wooden dowel(A), put cam lock(D) into holes in plate 19,20 and turn clockwise to tighten as shown.

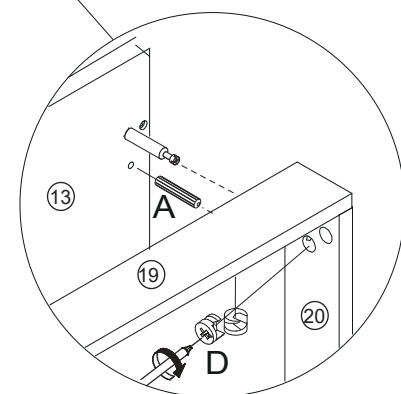
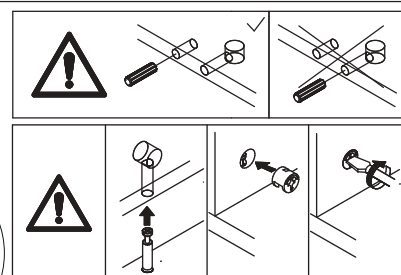
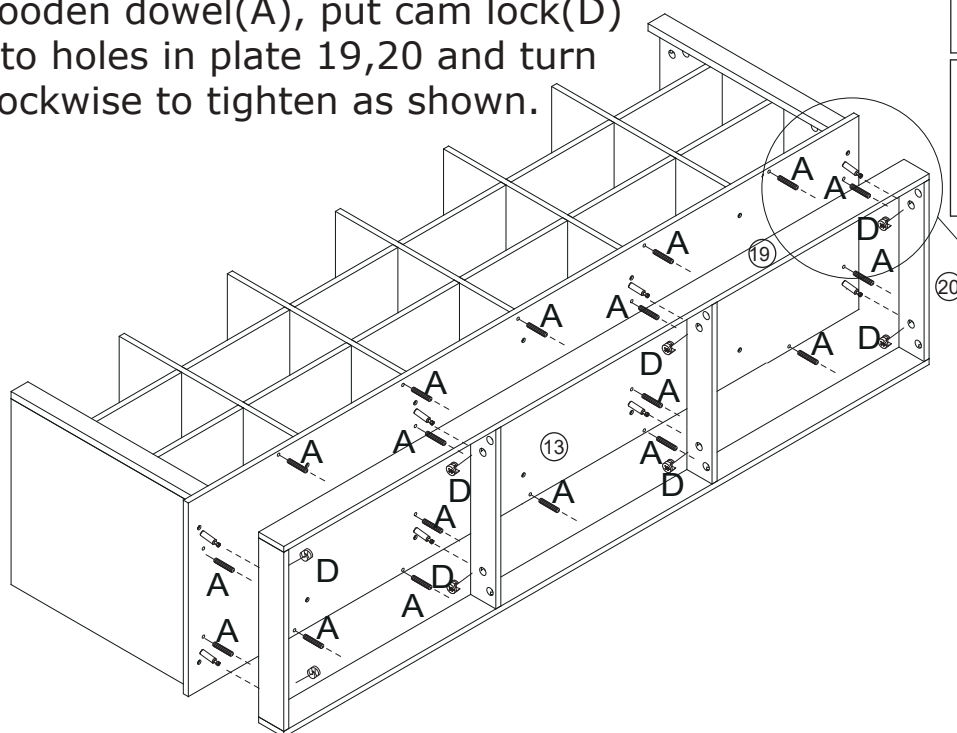

15

D x 14



Φ15 x 9 mm

A x 14



Φ6 x 30 mm

K x 16

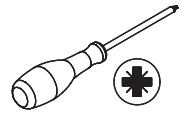

Connect the two assembled component with wooden dowel(A), put cam lock(D) into holes in plate 15, 17,16 and turn clockwise to tighten as shown.

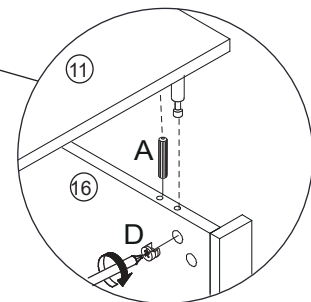
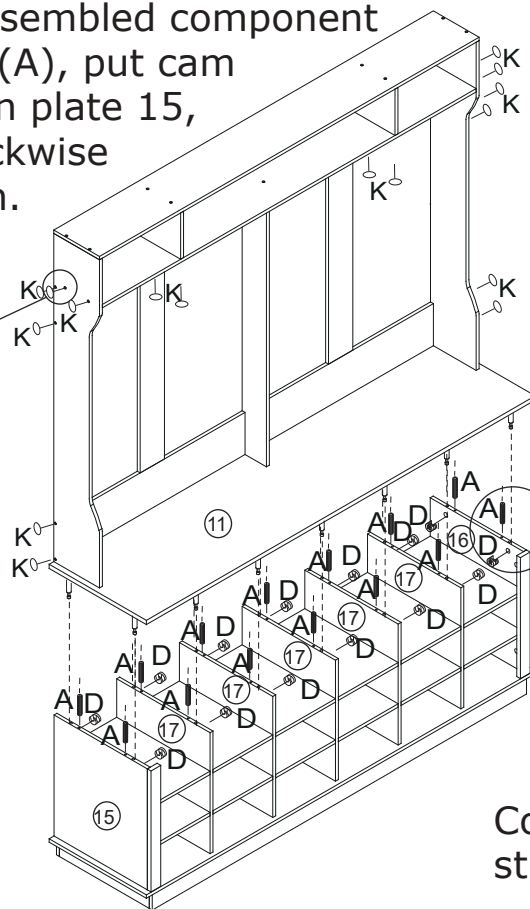
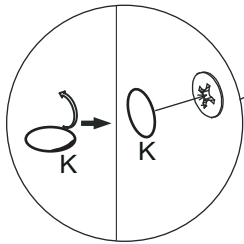
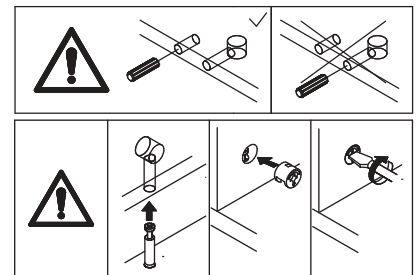

Cover cam lock holes using sticker(K) as shown.

16

H x 70



Φ3 x 12 mm

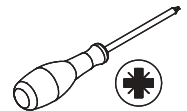

Fix back plate 21,22,23 and 24 using screw(H) as shown.

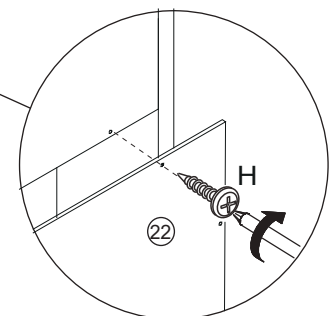
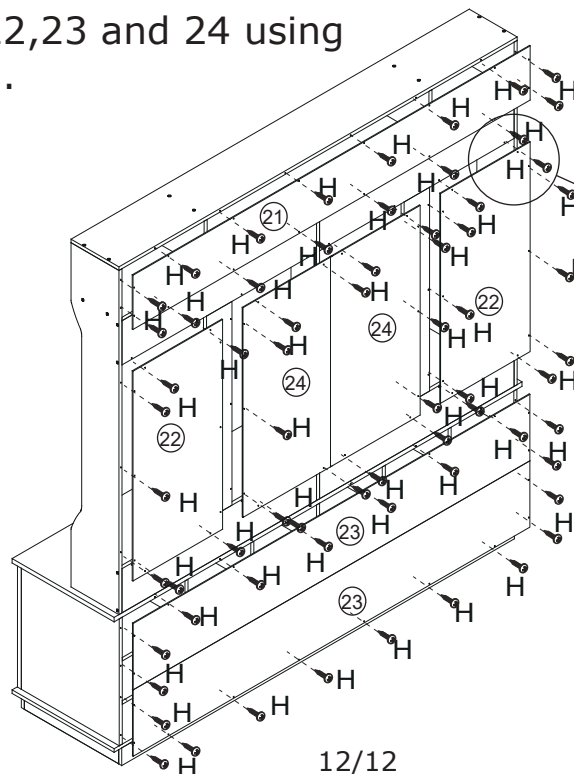

WARRANTY

WARRANTY CLAIMS

- There is a 30-day warranty for broken furniture or any other problems that do not work properly. The warranty will start from the date of purchase which must be verified by proof of purchase.
- Before making a claim, we may be able to answer your query, simply call us. Please leave your purchase order number, along with some details of the problem, if you want a replacement part. We will arrange within 48 hours. If there is out of stock, we will reply with a shipping date.
- The product must be used in accordance with the instructions provided. For health reasons.
- For other reasons, if the furniture needs to be returned, it must be cleaned and dried and operated within 30 days of receipt.

Type of Warranty Claim

- Failure to follow the furniture instructions will invalidate the warranty. Attention please.
- Does not include damage during installation, but includes damage during transportation.

Scope of responsibility

- Shall not bear any responsibility for misuse or user damage and / or loss of parts during the installation of furniture.
- After using, the damage and scratches of the furniture are not covered by the warranty.

The Warranty Relates to All Bought in The Us and Covers The Following Areas

- Sheet parts: 1 month from the date of purchase.
- Electrical parts: 1 month from the date of purchase.