

# ASSEMBLY INSTRUCTIONS

## 30" Stool (Set of 2)

ASSEMBLY	Assembly Time	30	1-Person
REQUIREMENTS	Per Stool (Approximate)	MINUTES	Assembly

### Thank you for purchasing our product!

Please refer and use this assembly instruction to assemble the product.

Contact our customer service department in case there are any missing or damage parts or hardware. Replacement parts are normally shipped within 2 or 3 days.

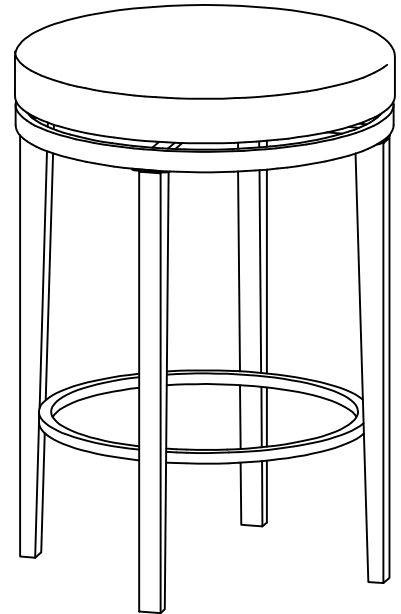

### ASSEMBLY PREPARATION

1. Remove all packaging materials, staples and packing straps from the carton.
2. Refer to Parts List and Hardware List and ensure they are complete before you start assembling.
3. Place all wooden parts on a clean, flat and soft surface (e.g. carpet or rug) to prevent parts from getting scratched.

### SAFETY PRECAUTION:

1. KEEP ALL HARDWARE PARTS OUT OF REACH OF CHILDREN.
2. DISPOSE PLASTIC PACKAGING MATERIAL IMMEDIATELY TO AVOID ANY RISK OF SUFFOCATION TO CHILDREN AND ANIMALS.

### TIPS FOR ASSEMBLY:

1. Allow ample room for assembly and in close proximity to where product will be placed.
2. Assemble the product on a surface that does not scratch or damage the exterior gloss and finish of the furniture.
3. Please check all of the parts and quantities are included before assembly. Contact customer service for missing parts.
4. Identify all of the parts, hardware and quantities required for each step.
5. During assembly, do not over-tighten any fittings as this may cause damage.
6. DO NOT USE POWER TOOLS TO ASSEMBLE THIS PRODUCT.
7. Always place the product on a flat surface.
8. Do not sit or stand on the partially assembled product; only use the product for which it is intended.

### CARE AND MAINTENANCE

- Use a slightly damp cloth to clean the product. Do not use bleach or abrasive cleaning material.
- Check all the fittings periodically and re-tighten as necessary. Do not use the product if any of the parts is damaged or broken.
- Never allow any kind of liquid to remain on your furniture. Absorption can cause wood to warp or delaminate.
- Do not place hot items (e.g. hot drinks) directly onto the wood surface.
- Do not drag and/or pull the furniture.

This product is for indoor and household use only - not for commercial use.

# ASSEMBLY INSTRUCTIONS 30" Stool

## (Set of 2)

### PARTS & HARDWARE LISTS

A		Seat Frame	1PC	F		1/4*12MM	Bolt	16PCS
B		Leg Frame	1PC	G		1/4*20MM	Bolt	4PCS
C		Leg	4PCS	H		1/4*30MM	Bolt	4PCS
D		Cushion	1PC	I			Allen Key	1PC
E		Seat Swivel	1PC					

#### STEP 1

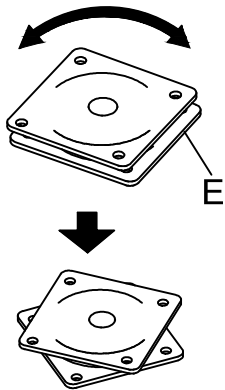

Rotate Seat Swivel (E) as shown to expose all of the bolt holes

#### STEP 2

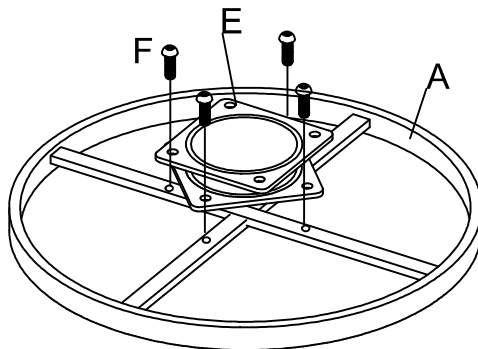

- Position Seat Swivel (E) to align bolt holes on (E) to bolt holes on Seat Frame (A).
- Use Bolt (F) to fasten (E) to (A). Use Allen Key (I) to drive (F).

#### STEP 3

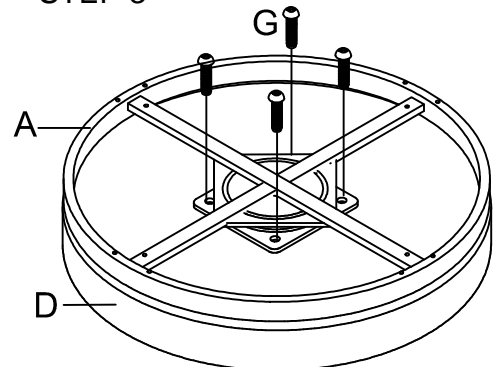

- Place Cushion (D) bottom-side up.
- Position Seat Frame (A) from STEP 2 bottom-side up. Align bolt holes on Swivel to bolt holes on (D).
- Use Bolt (G) to fasten Seat Swivel to (D). Use Allen Key (I) to drive (G). Do not tighten bolt completely until all 4 bolts are in place

#### STEP 4

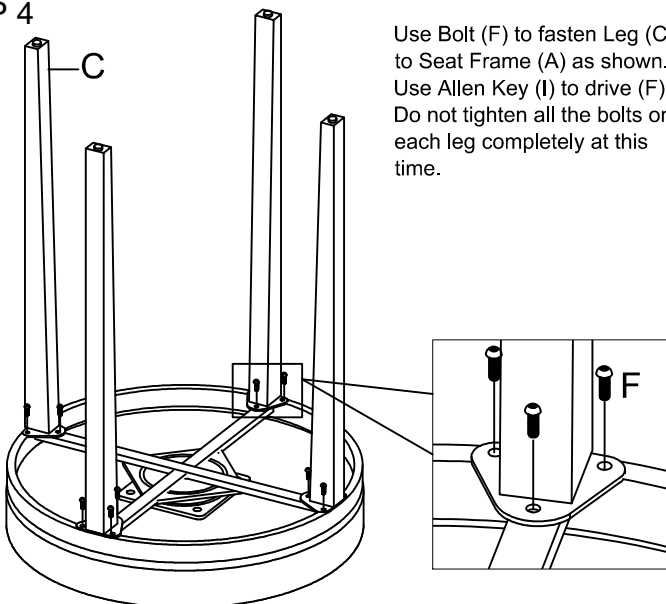

Use Bolt (F) to fasten Leg (C) to Seat Frame (A) as shown. Use Allen Key (I) to drive (F). Do not tighten all the bolts on each leg completely at this time.

Do not tighten all the bolts completely at this time. See STEP 5.

#### STEP 5

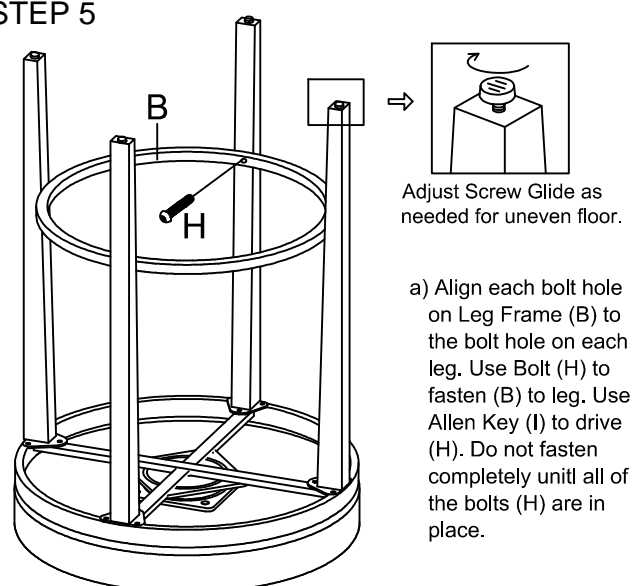

Adjust Screw Glide as needed for uneven floor.

- Align each bolt hole on Leg Frame (B) to the bolt hole on each leg. Use Bolt (H) to fasten (B) to leg. Use Allen Key (I) to drive (H). Do not fasten completely until all of the bolts (H) are in place.

- Tighten all the Screws (F) on each leg (that was not tighten in STEP 4) completely at this time.