

# ASSEMBLY INSTRUCTIONS



**TURN TOP UPSIDE DOWN ON A SOFT WORKING SURFACE**

<p>①</p>	<p>②</p>	<p>③</p>
<p>④</p>	<p>⑤</p>	
<p>A</p> <p>x4</p>	<p>B</p> <p>x1</p>	

**STEP1**

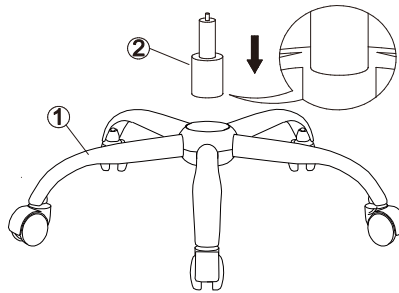
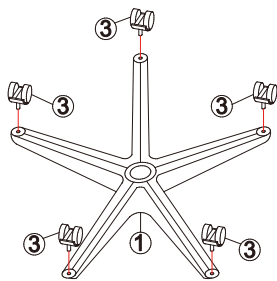

**STEP2**

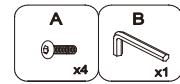
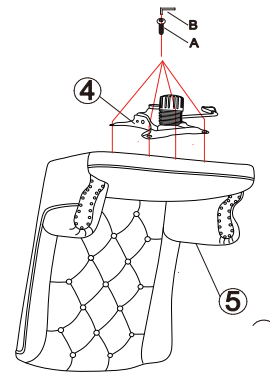

**Hardware & Tools Required**

**STEP3**

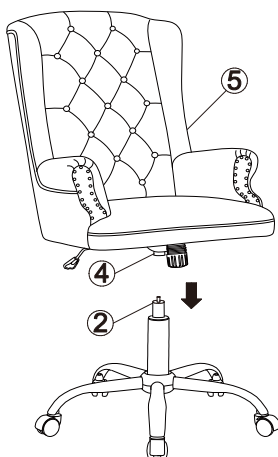

**STEP4**

