

Assembly Instructions

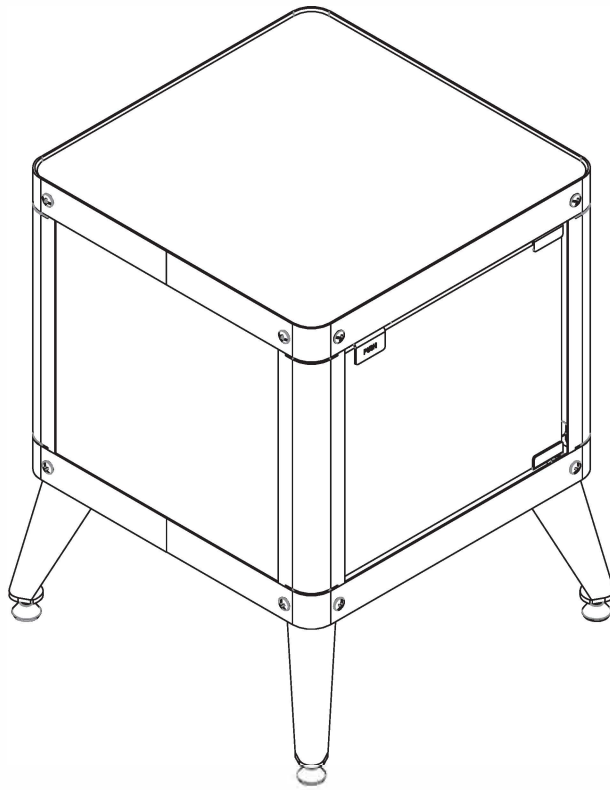

ASSEMBLY RATING

The Assembly Rating is a 5-point system that shows the degree of effort needed in assembling a specific product (with 1 being easy and 5 being difficult). For some products, two persons are recommended.

EASY



DIFFICULT

Tools Required For Assembly:

Allen Wrench

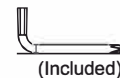

Phillips Screwdriver



2 PERSONS RECOMMENDED

ASSEMBLY & CARE ADVICE

FOR YOUR FURNITURE TO LAST, CORRECT ASSEMBLY AND PROPER MAINTENANCE ARE NECESSARY. PLEASE FOLLOW THE INFORMATION PROVIDED BELOW TO FULLY ENJOY YOUR FURNITURE.

BASIC ASSEMBLY TECHNIQUES

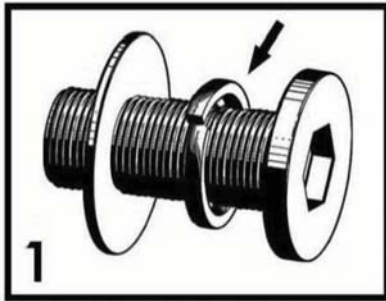

When lock or spring washer is used in an assembly, please make sure the lock or spring washer is placed between the larger flat washer and the head of the screw or bolt.

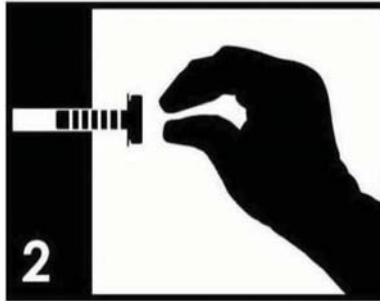

Position each part correctly and insert screws or bolts into their respective holes by hand tighten or using the proper hand tool. Only tighten when step is completed or when instructed to do so.

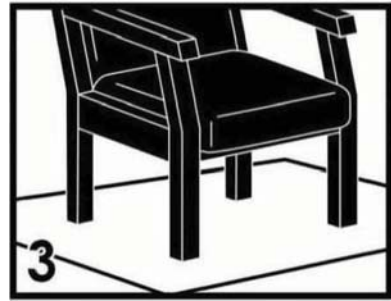

Use cardboard or carpet area when assembling furniture to prevent scratches. Make sure the furniture rests on a flat and level surface with each leg evenly touching the floor.

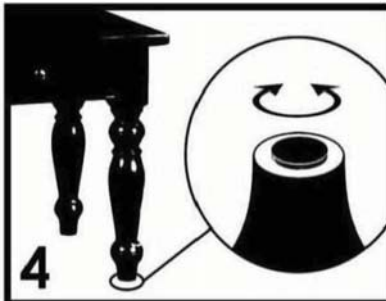

Some furniture comes with height adjustment knobs underneath each leg. To lower or to raise each leg, you need to turn clockwise or counterclockwise, respectively.

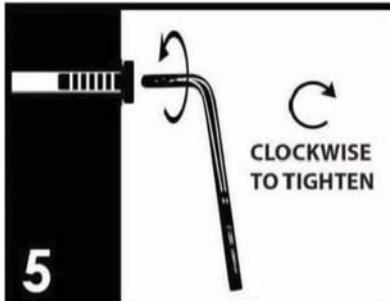

Make sure all parts are properly aligned, then use the appropriate hand tool to completely tighten the bolts or screws. Do not use power tools and do not overtighten.

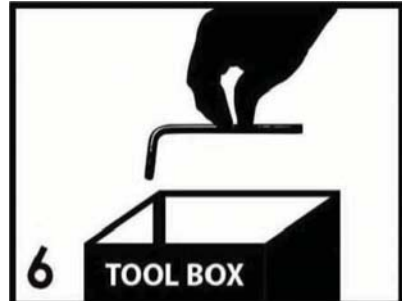

Save the instructions and store the Allen wrench or any supplied tool for later maintenance. After two weeks, check and tighten any loose hardware and repeat again every six months thereafter.

IT IS THE USER'S RESPONSIBILITY TO MAINTAIN THE FURNITURE. THE HARDWARE MAY LOOSEN OVER TIME AND MAY CAUSE THE FURNITURE TO BE WOBBLY AND UNABLE TO SUPPORT ITS INTENDED WEIGHT CAPACITY. THIS MAY LEAD TO COLLAPSE AND MAY CAUSE SERIOUS INJURY.



FAILURE TO FOLLOW THE GUIDELINES ABOVE MAY RESULT IN INJURY AND/OR PROPERTY DAMAGE.



Before you begin, please read Page 2 of "Assembly and Care Advice".

And remember, do not tighten until each step is completed or instructed.

Parts List

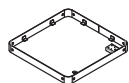

#1 x 1pc
Top Panel

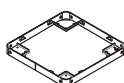

#2 x 1pc
Bottom Panel

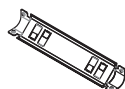

#3 x 4pcs
Crossbar



#4 x 1pc
Cover Panel



#5 x 4pcs
Leg



#6 x 1pc
Top Glass



#7 x 3pcs
Side Glass



#8 x 1pc
Door Glass

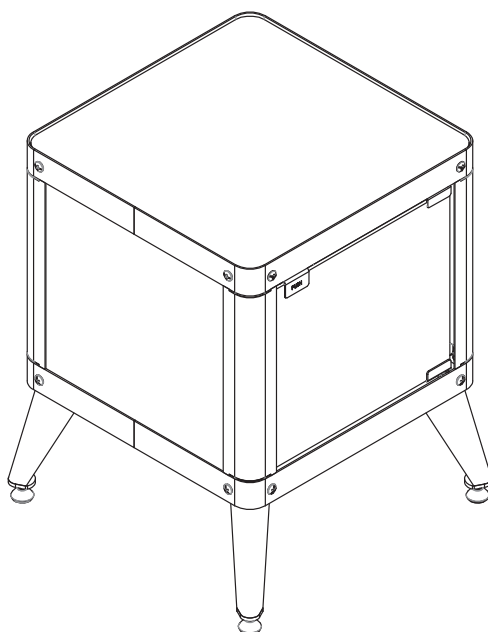



Before you begin, please read Page 2 of "Assembly and Care Advice".

And remember, do not tighten until each step is completed or instructed.

Hardware List



#A x 28pcs
Bolt 1/4" x 3/8"



#B x 4pcs
Leveler



#C x 4pcs
Bolt M3 x 10L

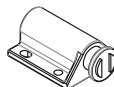

#D x 1pc
Handle



#E x 2pcs
Hinge insert

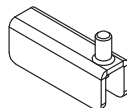

#F x 1pc
Hinge

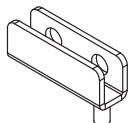

#G x 1pc
Hinge



#H x 4pcs
Bolt M8 x 9L

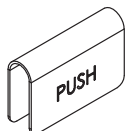

#I x 1pc
Metal Contact

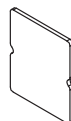

#J x 1pc
Adhesive



#K x 1pc
Allen Wench



#C x 4pcs
#D x 1pc

Align the handle (#D) to the top panel (#1) and insert 4 bolts (#C). Secure using the Allen wrench (#O).

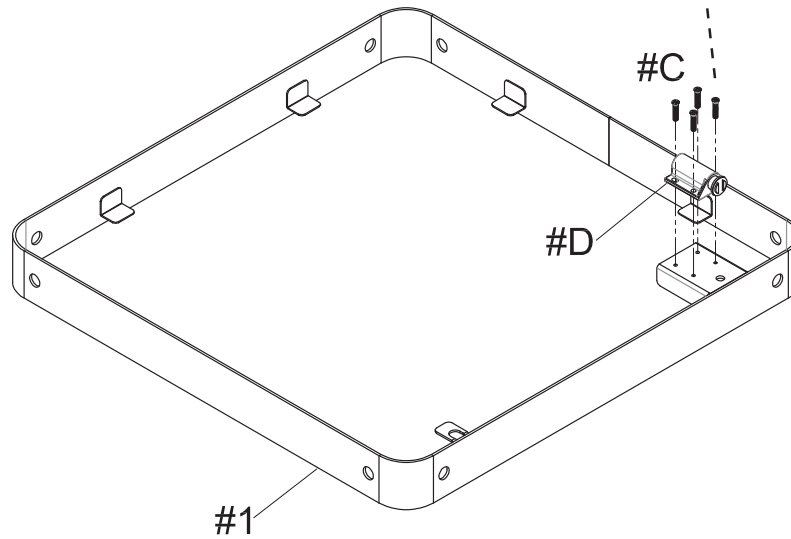

#A x 4pcs

1. Align the crossbars (#3) to the inner corners of the top panel (#1) and bottom panel (#2).

2. Insert a bolt (#A) into each end and secure using the Allen wrench (#O).

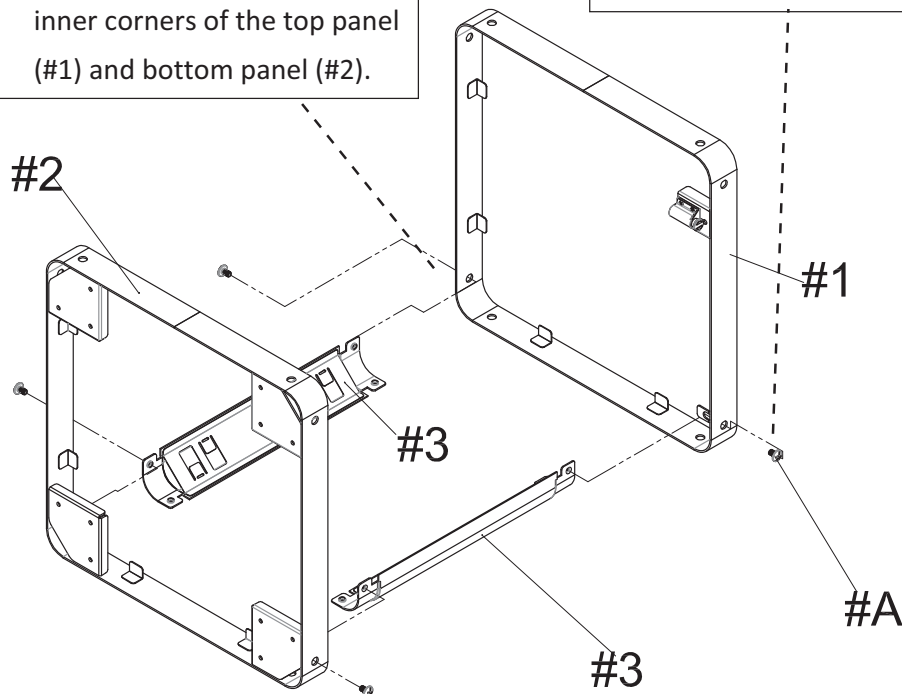



#A x 4pcs

3. Insert a bolt (#A) into the remaining holes on the other corners. Secure using the Allen wrench.

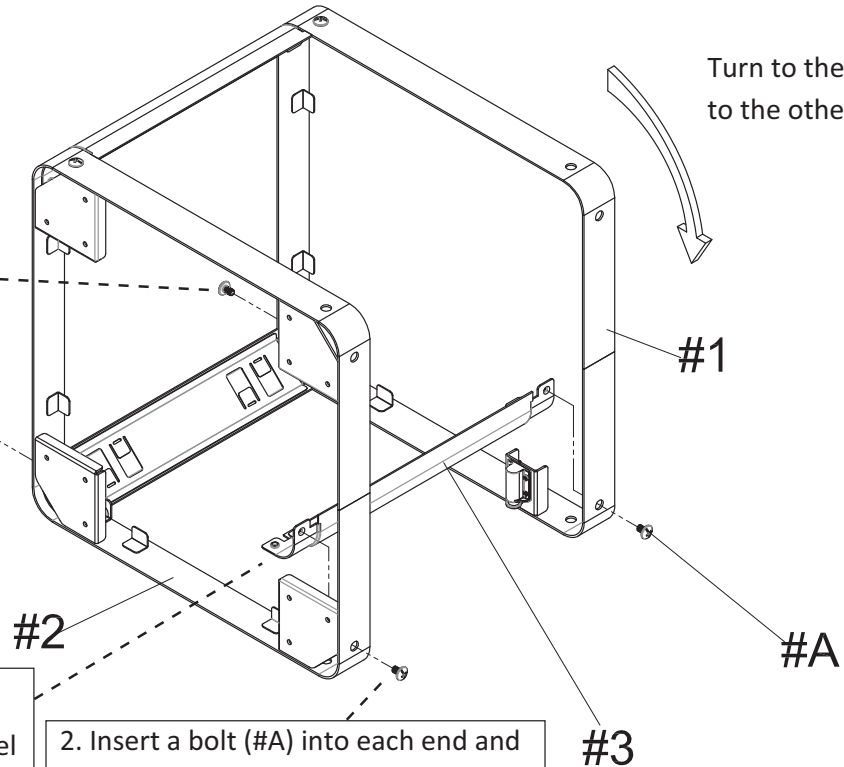

1. Align a crossbar (#3) to the inner corners of the top panel (#1) and bottom panel (#2).

2. Insert a bolt (#A) into each end and secure using the Allen wrench (#0).



#A x 6pcs

3. Insert a bolt (#A) into the remaining holes on the other corners. Secure using the Allen wrench.

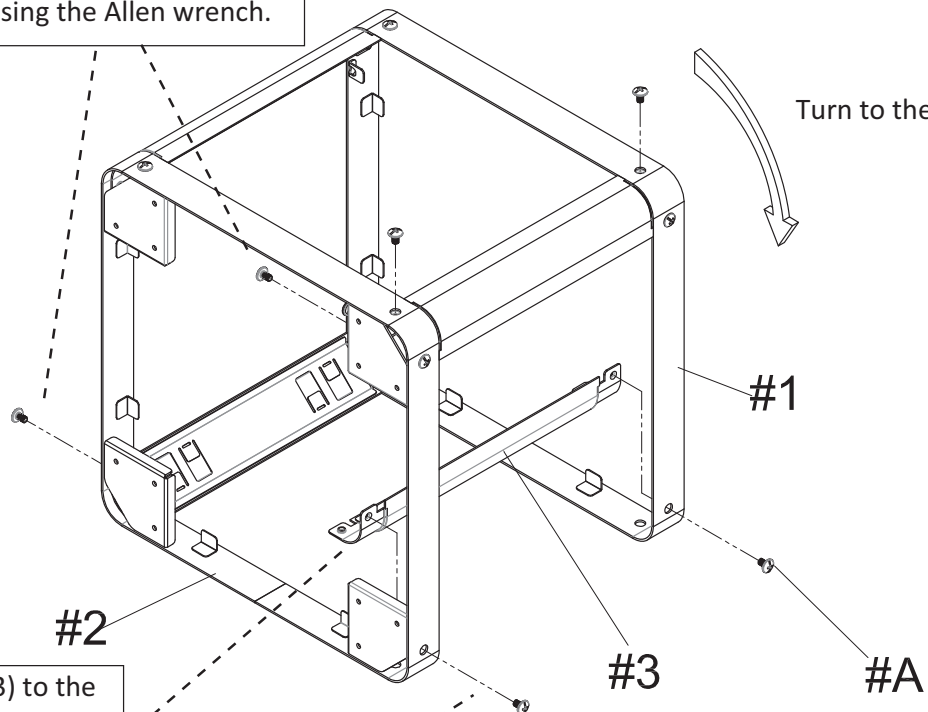

1. Align the crossbar (#3) to the inner corners of the top panel (#1) and bottom panel (#2).

2. Insert a bolt (#A) into each end and secure using the Allen wrench (#0).



#A x 2pcs

Insert a bolt (#A) into the remaining holes on the other corners. Secure using the Allen wrench.

#A

#2

#1

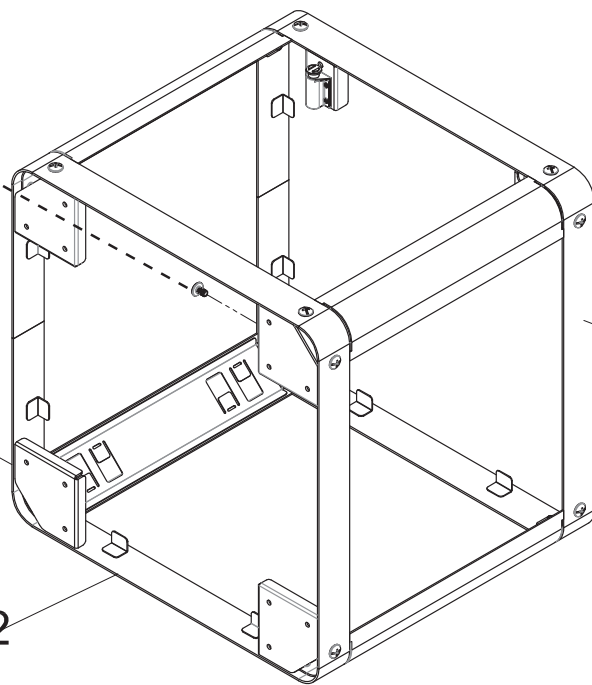

#B x 4pcs

Insert the threaded ends of the levelers (#B) into the bottom holes of the legs (#5). Turn right to tighten.

#B

x 4

#5

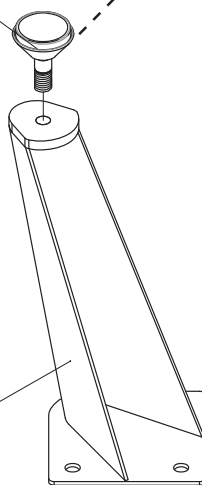



#A x 12pcs

#B

#A

3. Insert 3 bolts (#A) into each leg (#5) and secure using the Allen wrench.

2. Align the legs (#5) to the bottom corners of the bottom panel (#2).

#2

1. Carefully place facing down.

#1



1. Turn upright, make sure all parts are firmly secured.

2. Place the cover panel (#4) onto the bottom panel (#2).

#4

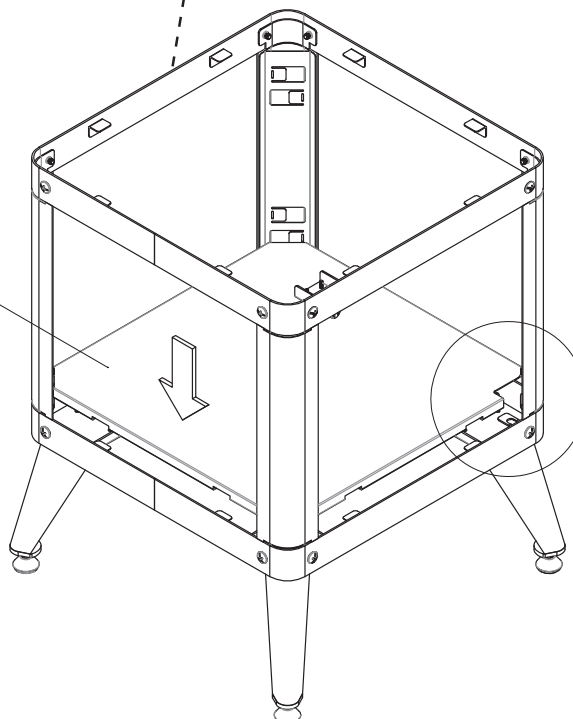

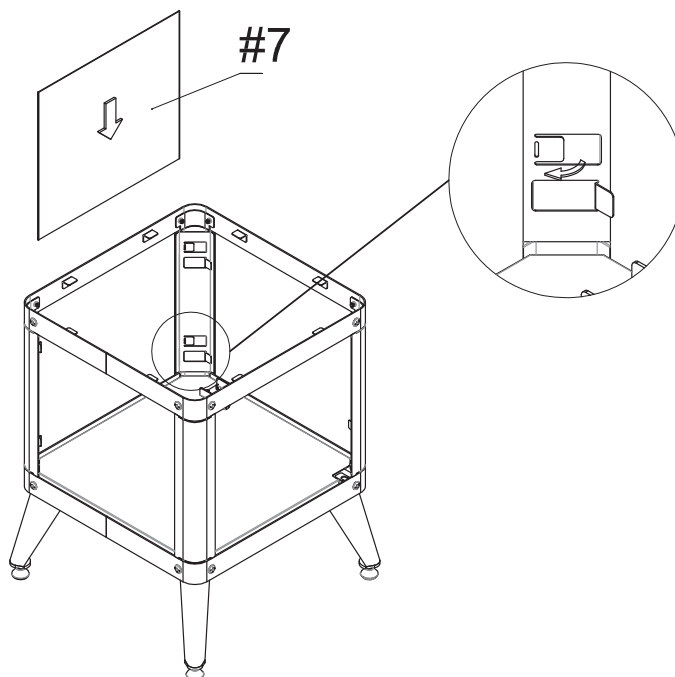
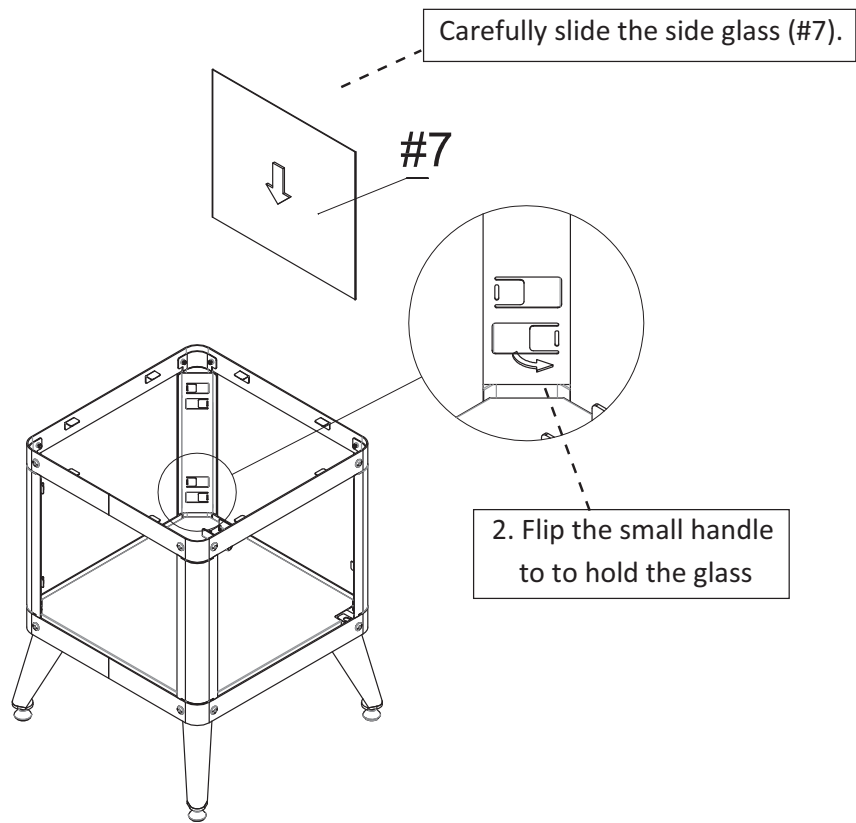

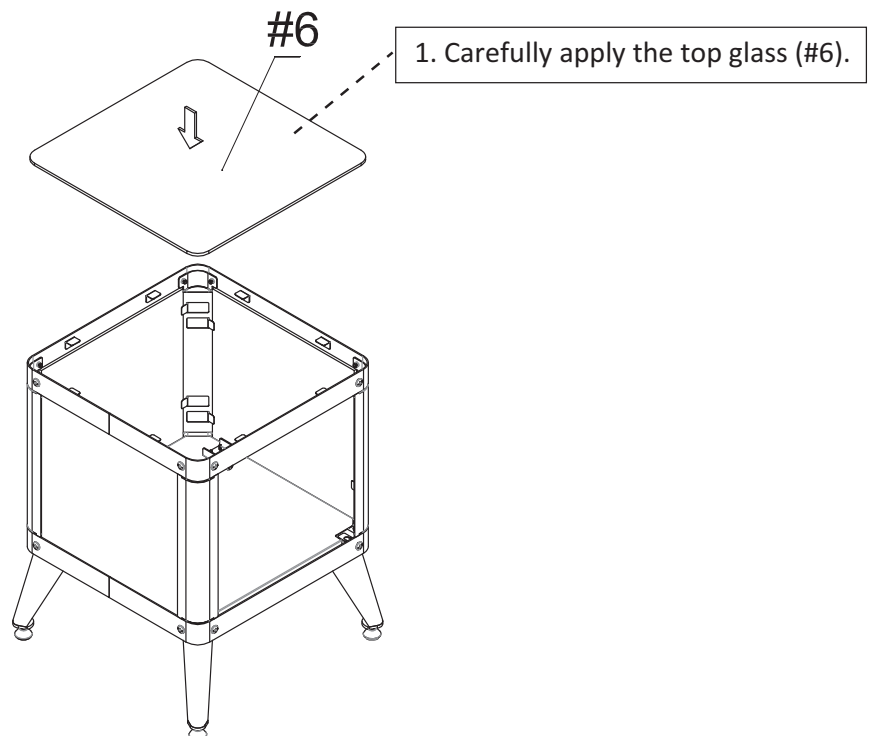
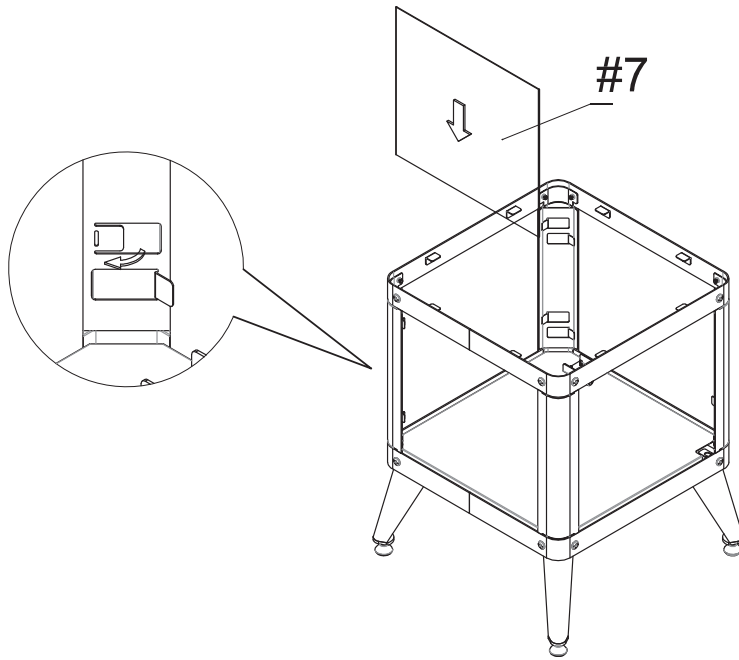



#E x 2pcs
#G x 1pc
#F x 1pc

Insert the hinges (#F) and (#G) into the hinge inserts (#E).

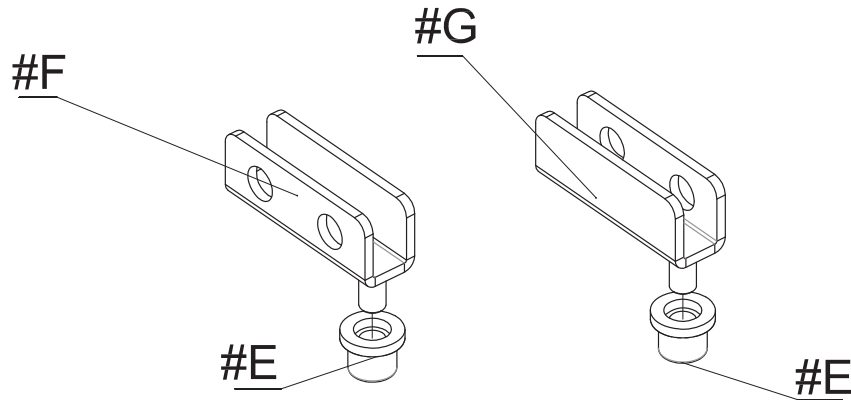

#H x 4pcs
#I x 1pc
#J x 1pc

1. Slide the glass door (#8) into the ridges and insert 2 bolts (#H) into each. Secure using the Allen wrench.

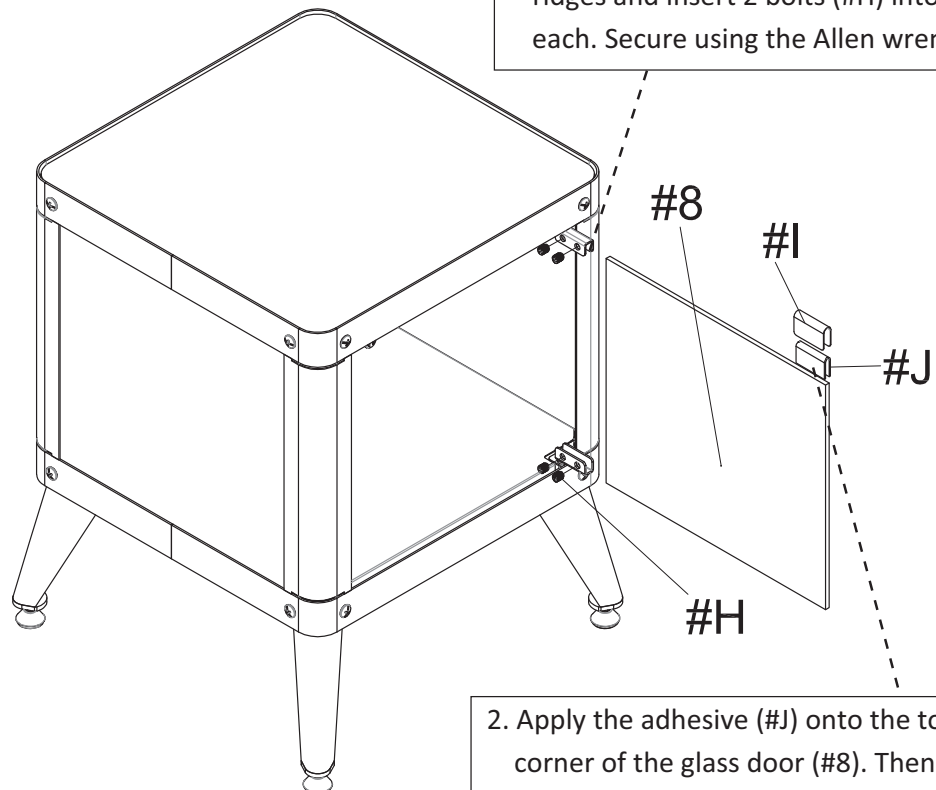

2. Apply the adhesive (#J) onto the top corner of the glass door (#8). Then the metal contact (#I) onto that.

ASSEMBLY IS COMPLETED