

注：此页为技术说明，非印刷内容

刀模线：——  
内折线：——

展开尺寸图：

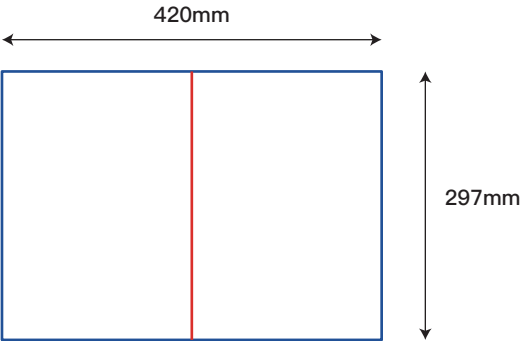

装订效果图：

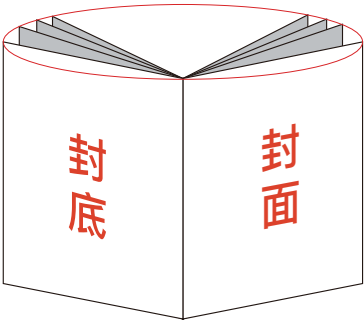

- 技术要求：
- 1、材质：封页105g 铜板纸；内页80g双胶纸
  - 2、展开尺寸：A3，如图所示装订成型为A4，24P
  - 3、颜色：单色
  - 4、印刷：印刷图档见后续页，双面印刷
  - 5、装订方式：骑马钉

符号标识



关键尺寸

XXX

编号

XXX

XXX

								名 称		Manual(全球版)		PLM 号				
												投影法			第一角投影法	
																
除 非 另 有 说 明		标记	处数	ECO#		发行时间		图 号				版 本		重量G	比例	
0-30 ±1		设 计		P M				材 料				00				
30-150 ±2		绘 图		日期		2022/08/08						共 1 页		第 1 页		
150-300 ±3		审 批		日期				规 格								
300-450 ±4																
>450 ±5			除去所有利边, 尖点, 毛刺													

# INSTRUCTION MANUAL

Rev00(A)

---

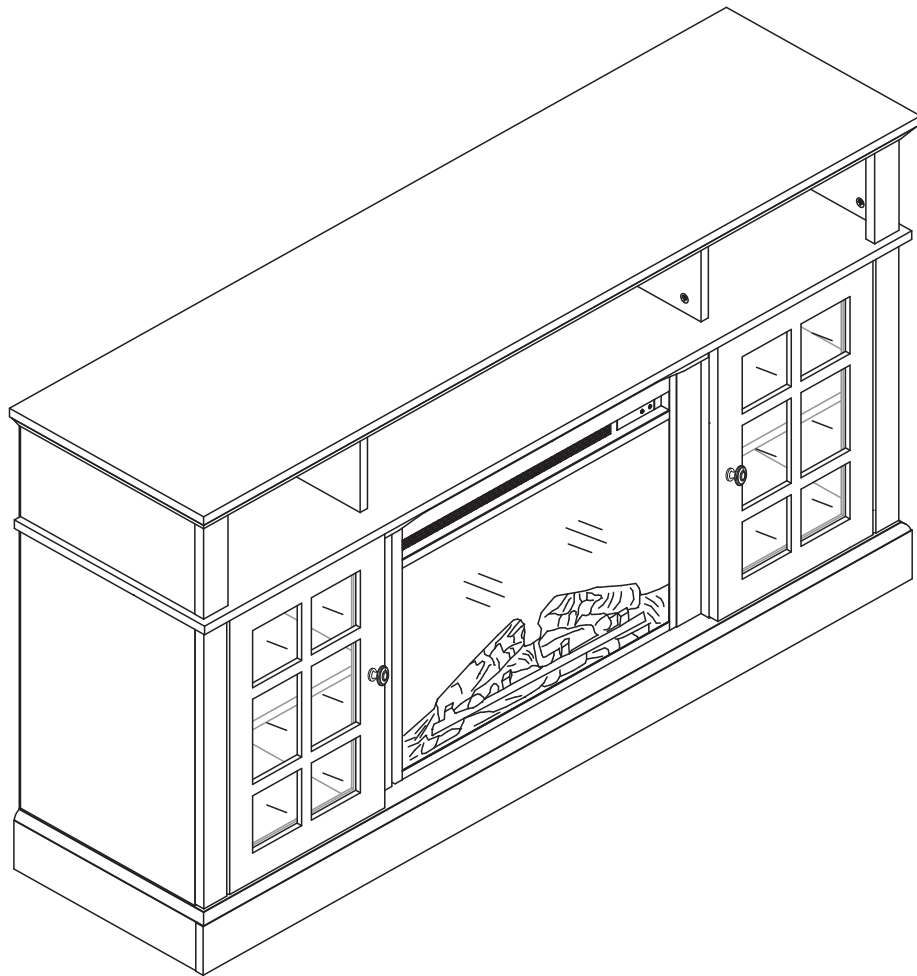

## Fireplace TV Stand

---

## Important Safety Information

Please carefully read all instructions before installation. Follow the instructions to install the product correctly. If you have any concerns or questions, please contact our Technical Support

This unit is not intended for use with CRT TVs. Use only with flat panel TVs and audio / video equipment meeting recommended size and weight limits. To avoid instability, place the TV in the center of the unit; the base of the TV must be able to rest on the supporting surface of the unit without over-hanging the edges. Avoid the risk of personal injury or property damage. Do not exceed recommended size and weight limits.

To prevent the stand from tipping over, use the wall attachment device provided with this product.



**Top Shelf Weight Capacity:**  
200 lbs (90 kg)

Fits up to most 65" / 165.1cm diagonal flat panel TVs

**Middle Shelf Weight Capacity:**  
50 lbs (22.7 kg)



**Left & Right Shelf Weight Capacity:**  
20 lbs (9 kg)

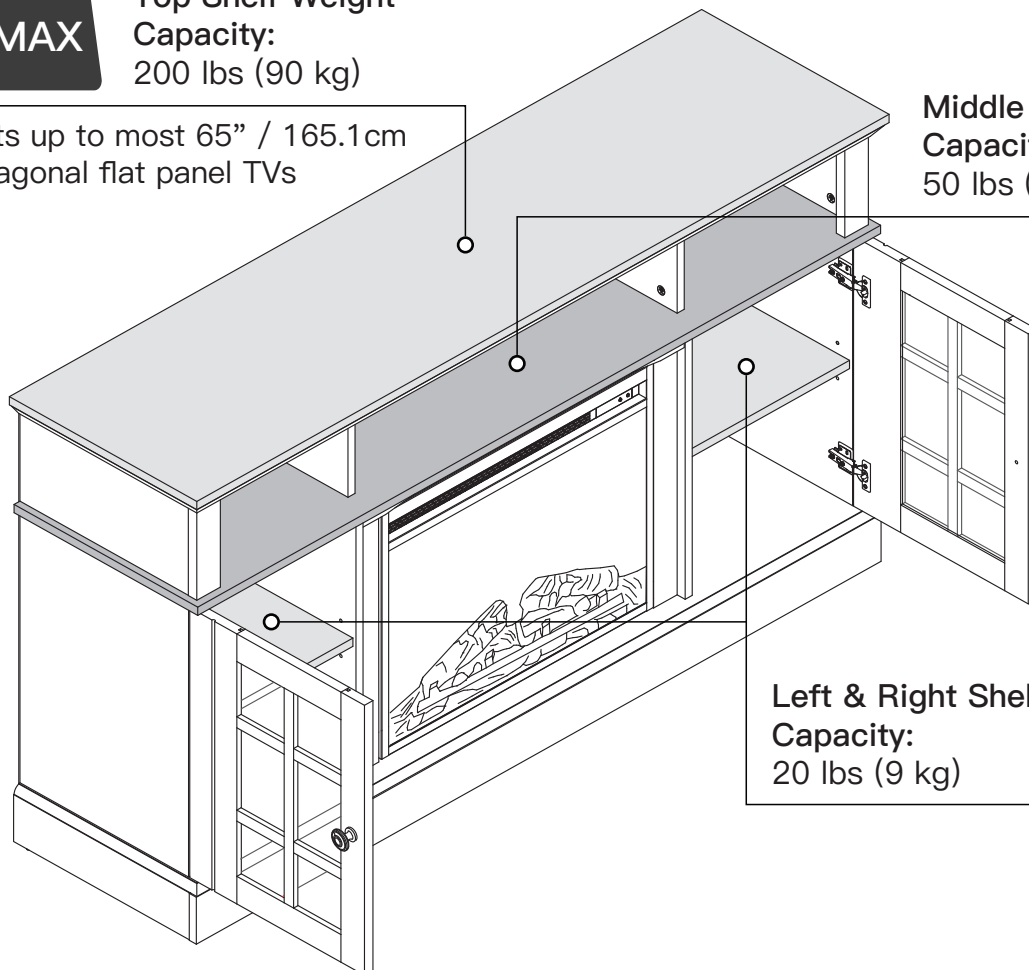

## Tools Needed (Not Included)

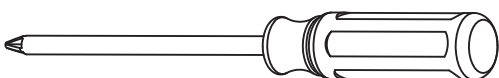

Phillips Screwdriver

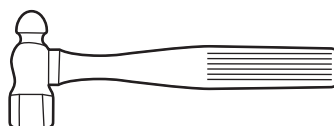

Hammer

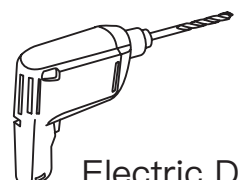

Electric Drill

## How the Assembly System Works

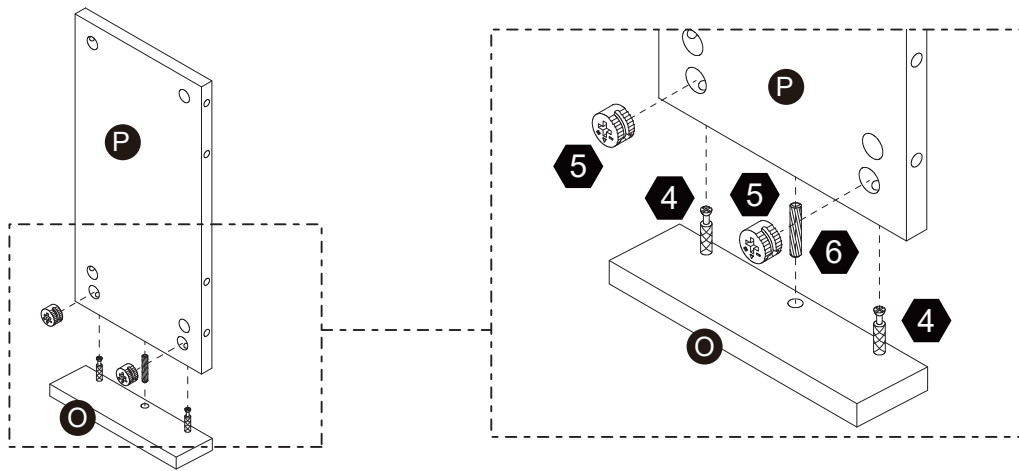

## How to Install Wood Dowel

Insert the wood dowel [6] at least half-way. IF NECESSARY, lightly tap the wood dowel with a self-supplied rubber mallet.

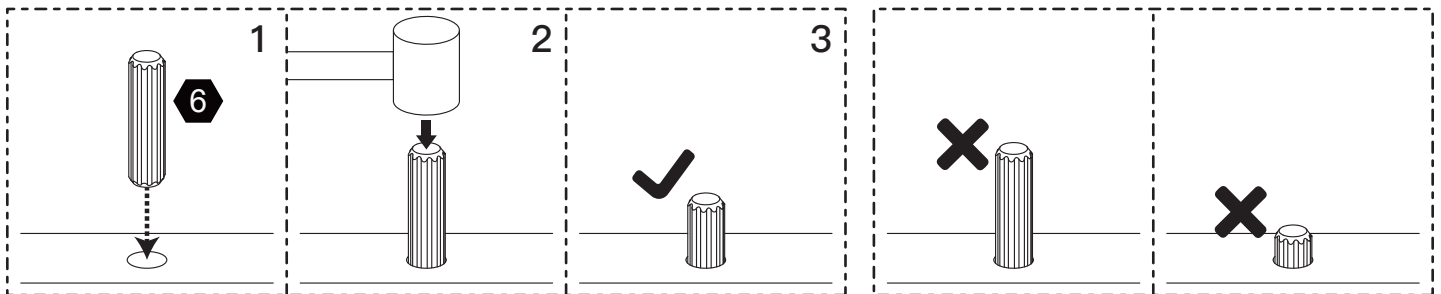

## Cam Lock System Operation

1. Screw the cam bolt [4] into the threaded insert on the panel.
2. Connect both panels together making sure cam bolt [4] goes into the pre-drilled large hole on the end of panel for cam lock [5].
3. Insert the cam lock [5] into the pre-drilled large hole on the panel. Make sure the cross slot of cam lock [5] faces out.
3. Rotate the cam lock [5] clockwise to lock the cam bolt [4] in place.

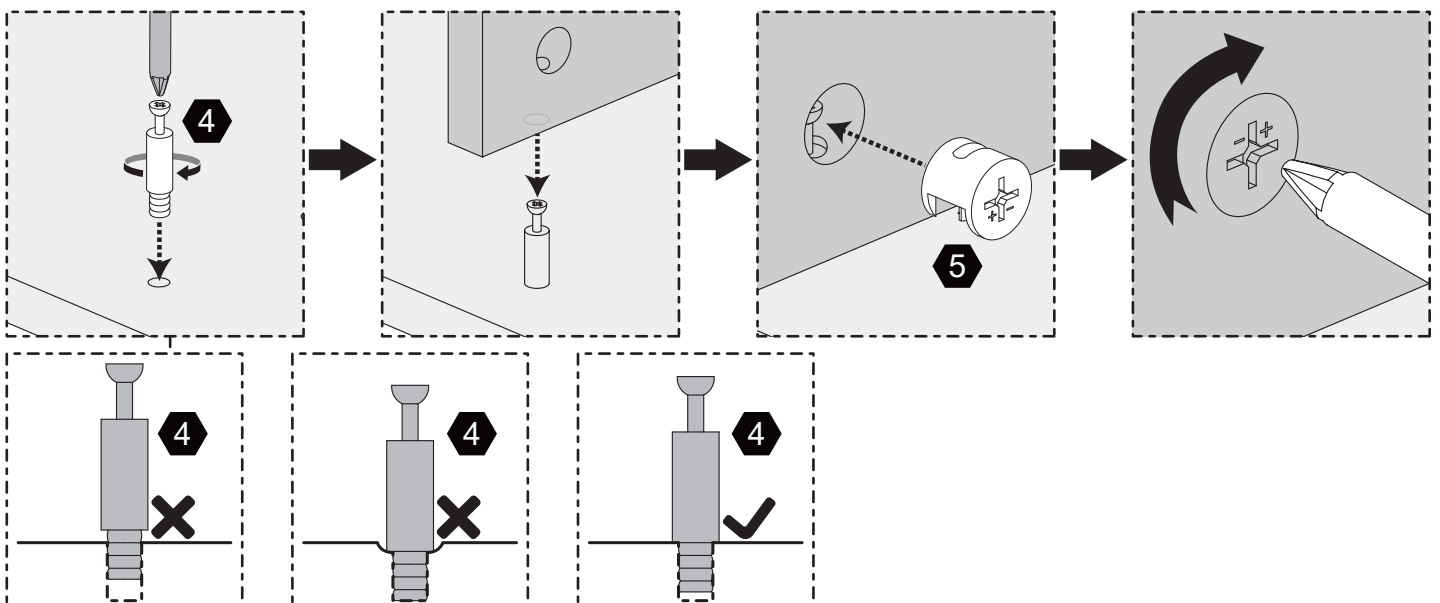

You are now ready to assemble the Fireplace TV Stand.



# Exploded Drawing

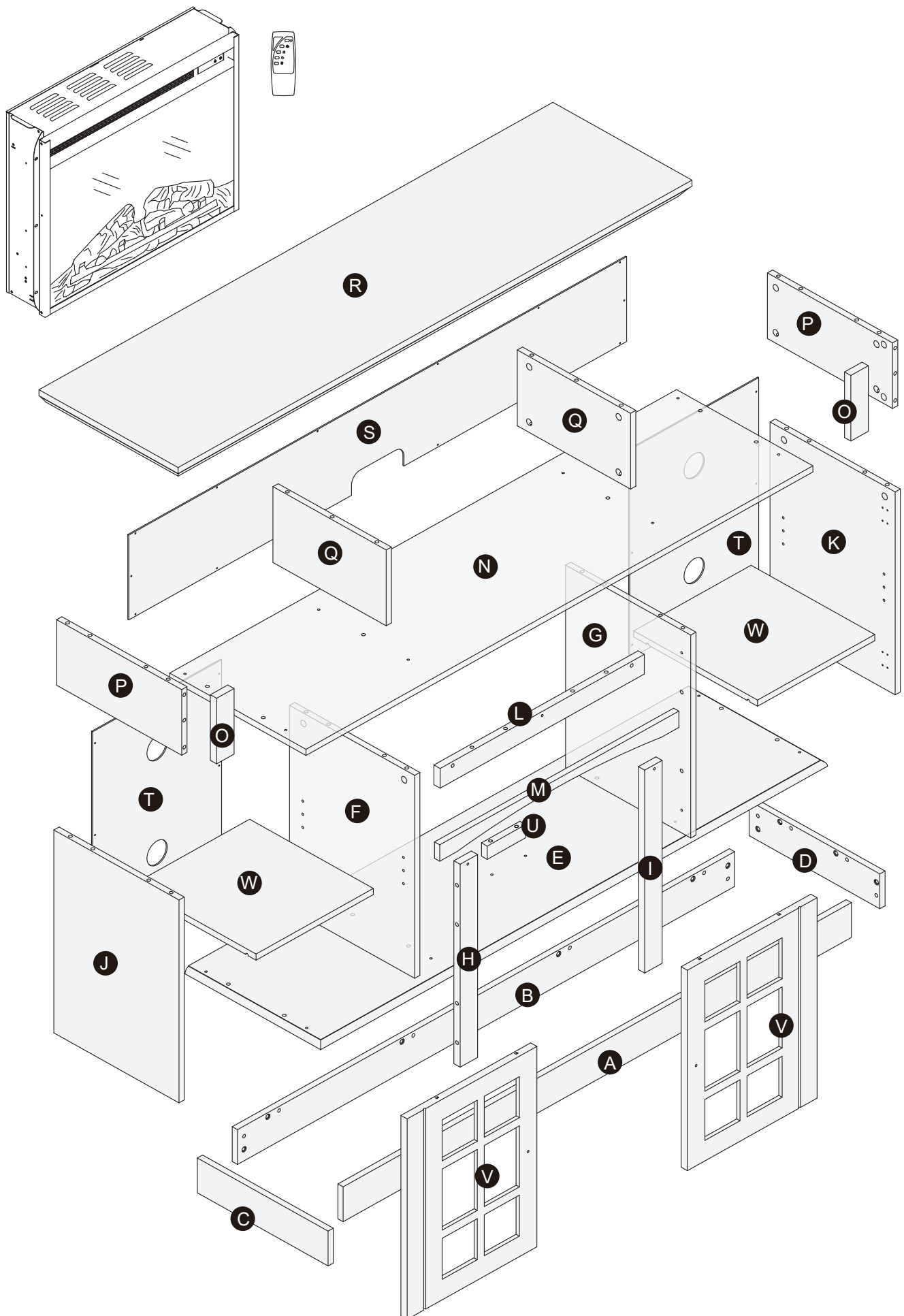

# Contents

**A**

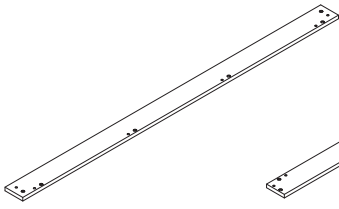

1 pc

**B**

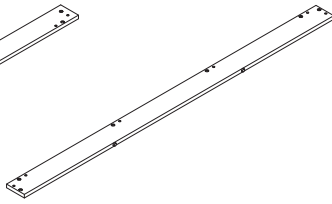

1 pc

**C**

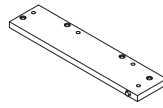

1 pc

**D**

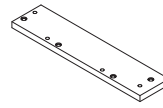

1 pc

**E**

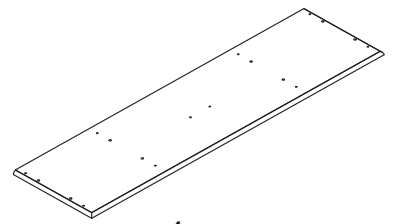

1 pc

**F**

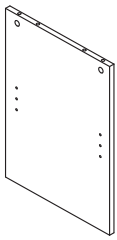

1 pc

**G**

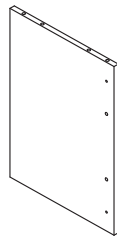

1 pc

**H**



1 pc

**I**



1 pc

**J**

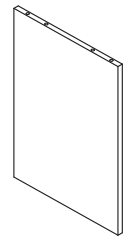

1 pc

**K**

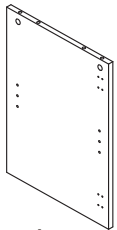

1 pc

**L**

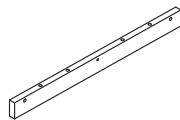

1 pc

**M**

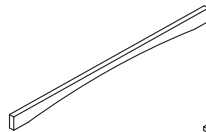

1 pc

**N**

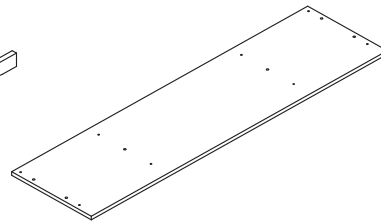

1 pc

**O**



2 pcs

**P**

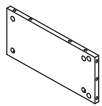

2 pcs

**Q**

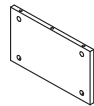

2 pcs

**R**

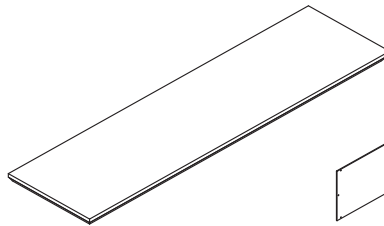

1 pc

**S**

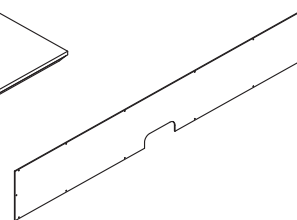

1 pc

**T**

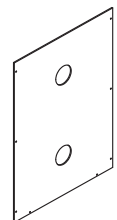

2 pcs

**U**



1 pc

**V**

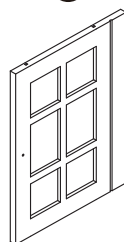

2 pcs

**W**

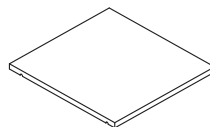

2 pcs

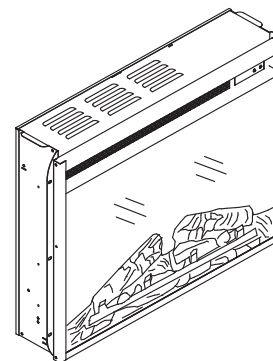

# Contents

1

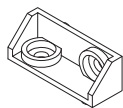

16 pcs

2



M6\*12mm

32 pcs

3



4mm

1 pc

4



M6\*35mm

34 pcs

5



Ø15\*12

34 pcs

6



Ø8\*30mm

36 pcs

7

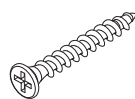

M5\*35mm

8 pcs

8

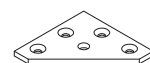

2 pcs

9



M3\*15mm

8 pcs

10



1/4-20\*5/8"

2 pcs

11



Ø8\*20mm

2 pcs

12

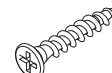

M4\*28mm

3 pcs

13



M3\*15mm

30 pcs

14

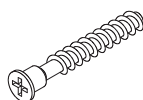

M6\*50mm

2 pcs

15

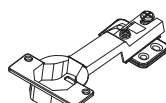

4 pcs

16



M3.5\*12mm

24 pcs

17



2 pcs

18



M4\*28

2 pcs

19



Ø8\*16

8 pcs

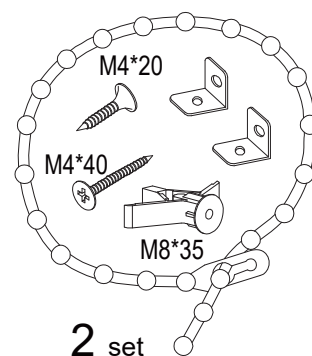

2 set

## Step 1

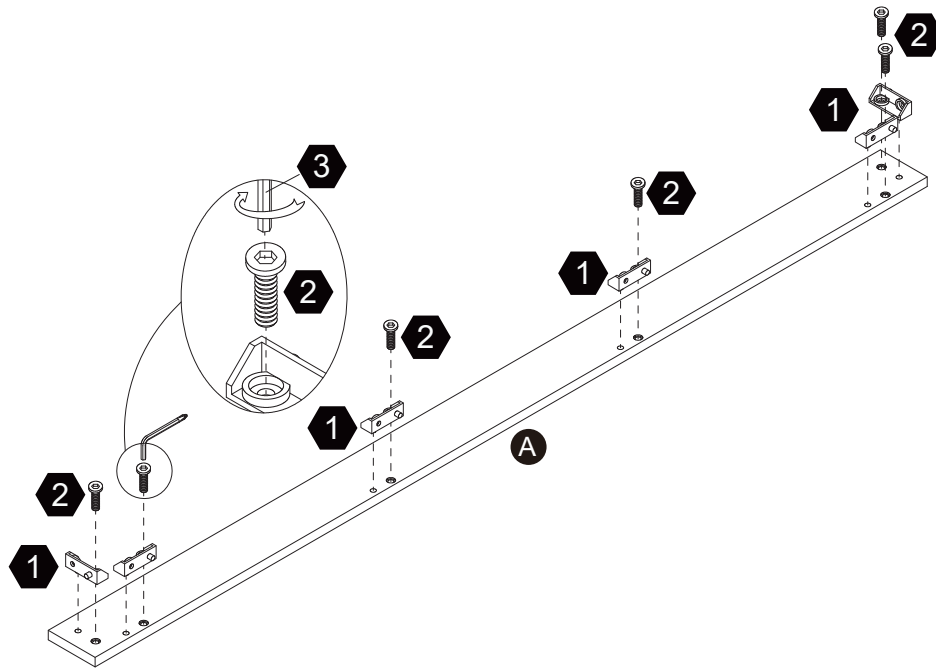
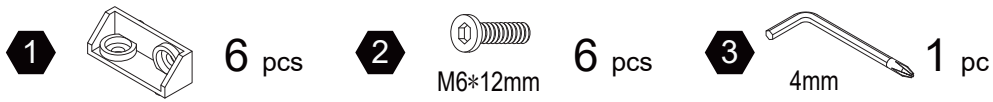

## Step 2

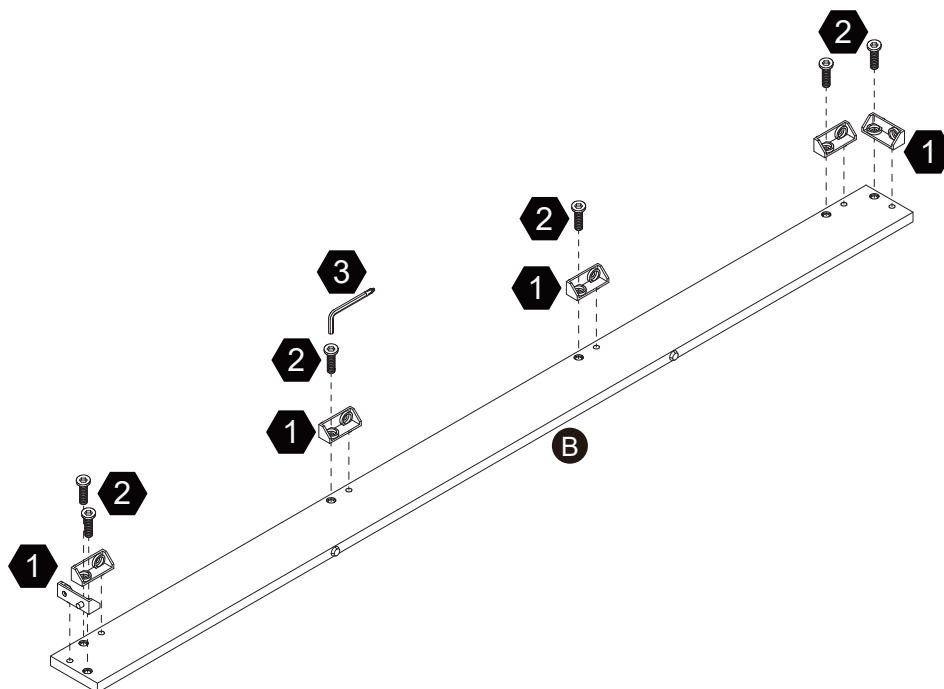
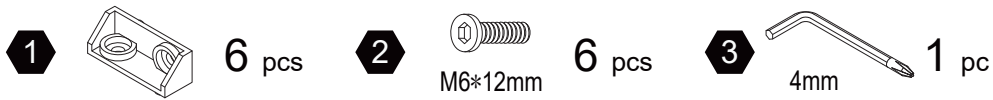

## Step 3

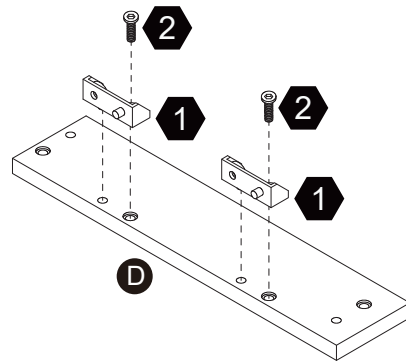
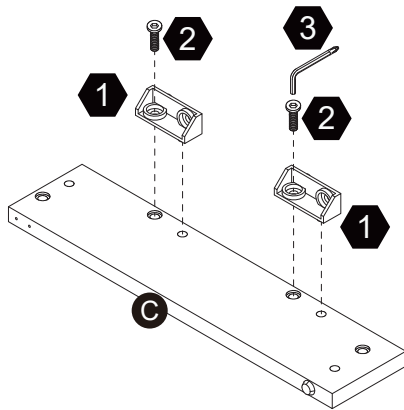

## Step 4

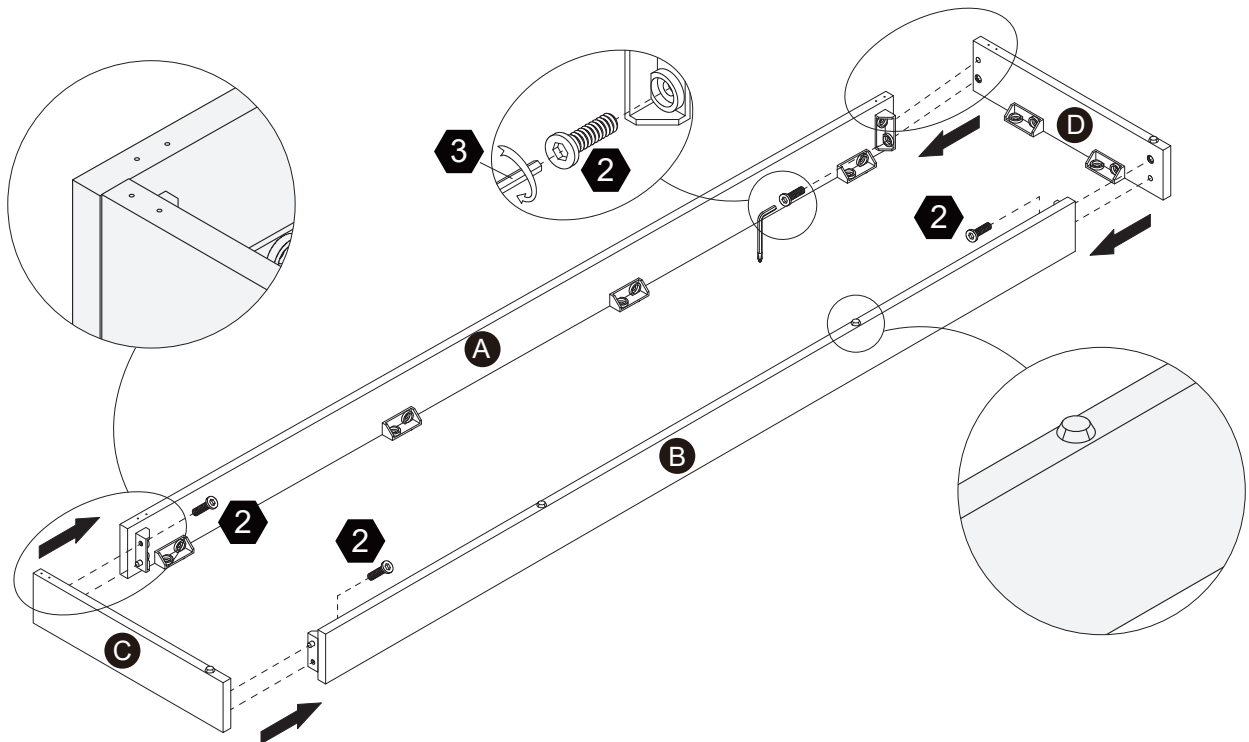

## Step 5

2 M6\*12mm 12 pcs 3 4mm 1 pc

NOTE: The round edge of the panel [E] and the panel [A] should face the same direction.

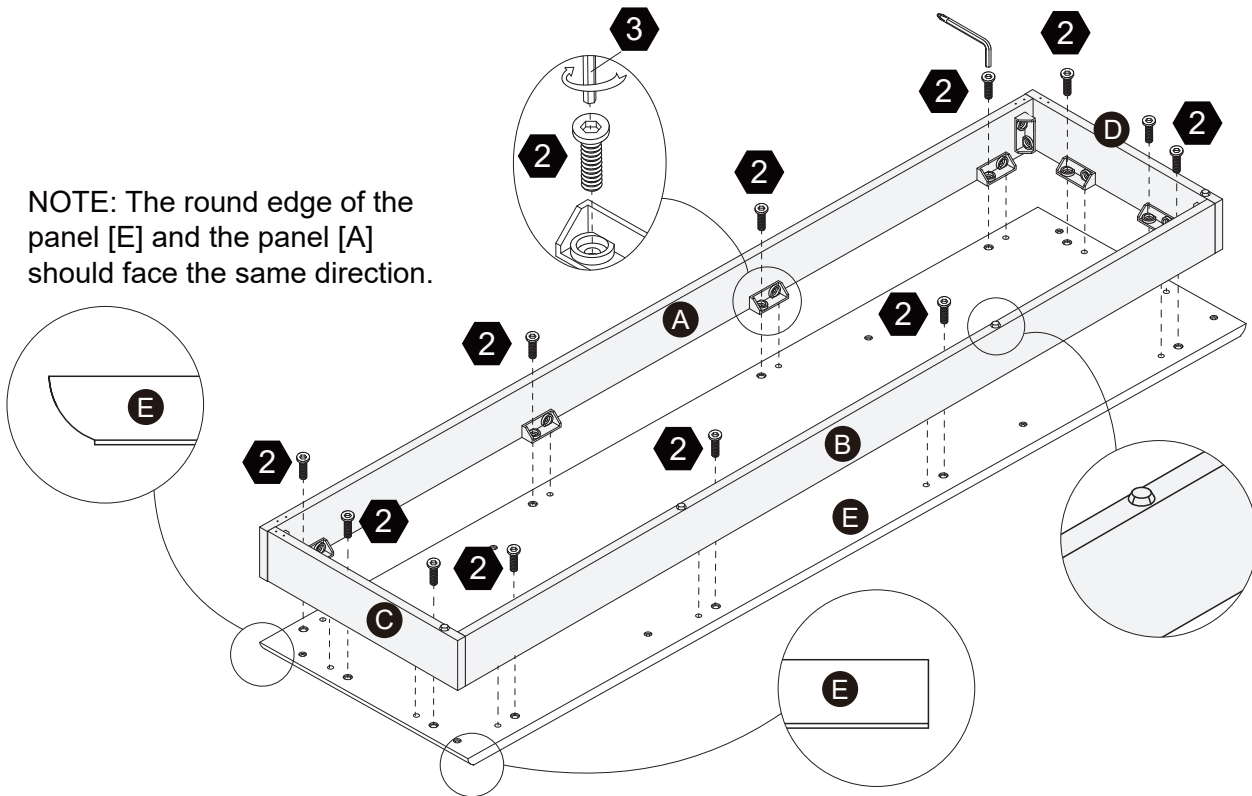

## Step 6

4 M6\*35mm 4 pcs

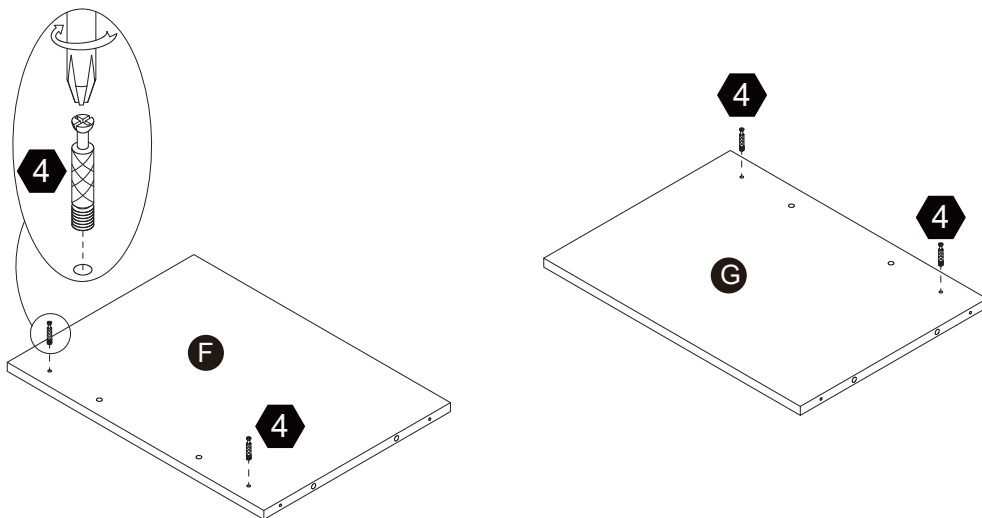

## Step 7

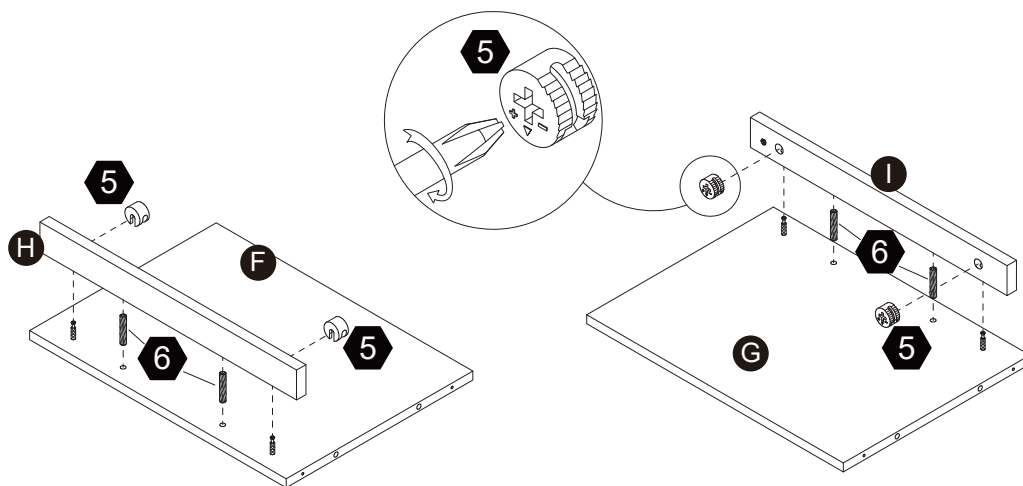

## Step 8



NOTE: The side with cam lock holes of the panel [J] and [K] should face each other. It is the same with the panel [G] and [K].

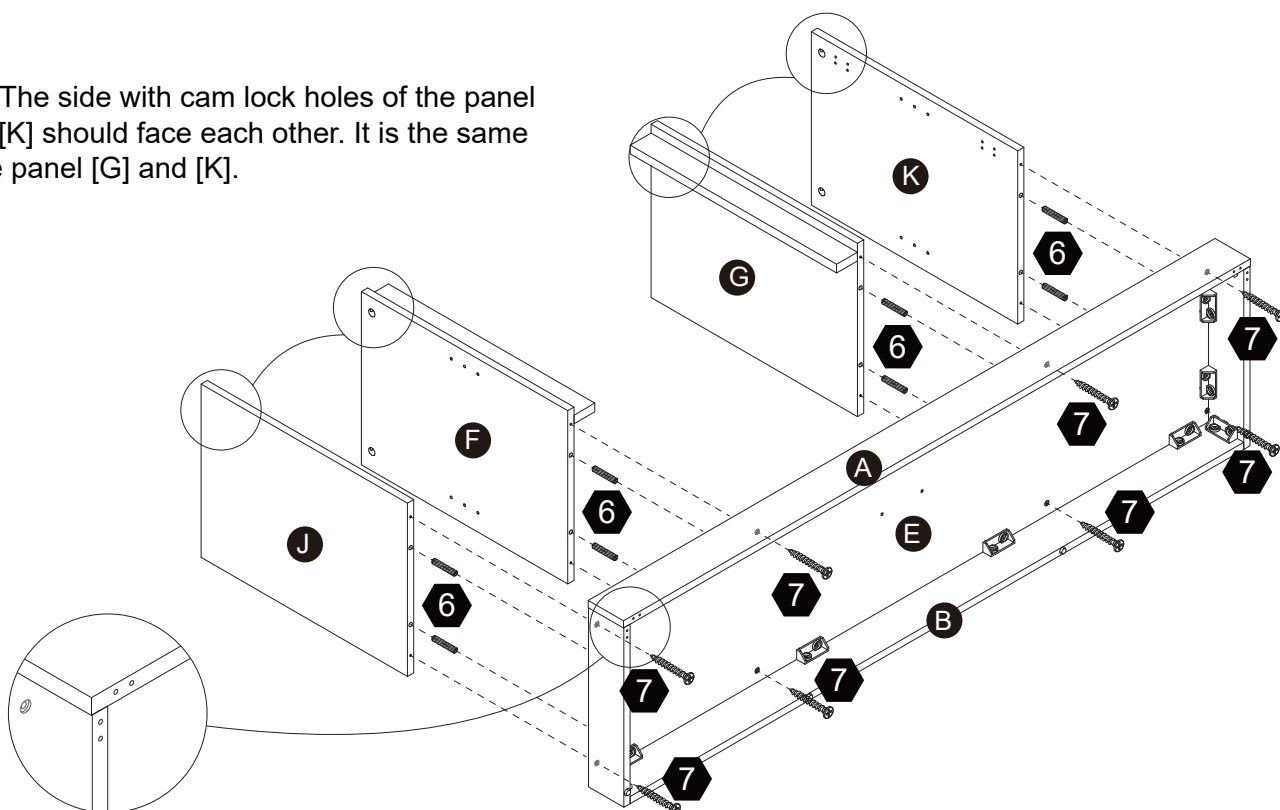

## Step 9

- 8**  2 pcs    **9**  M3\*15mm 8 pcs

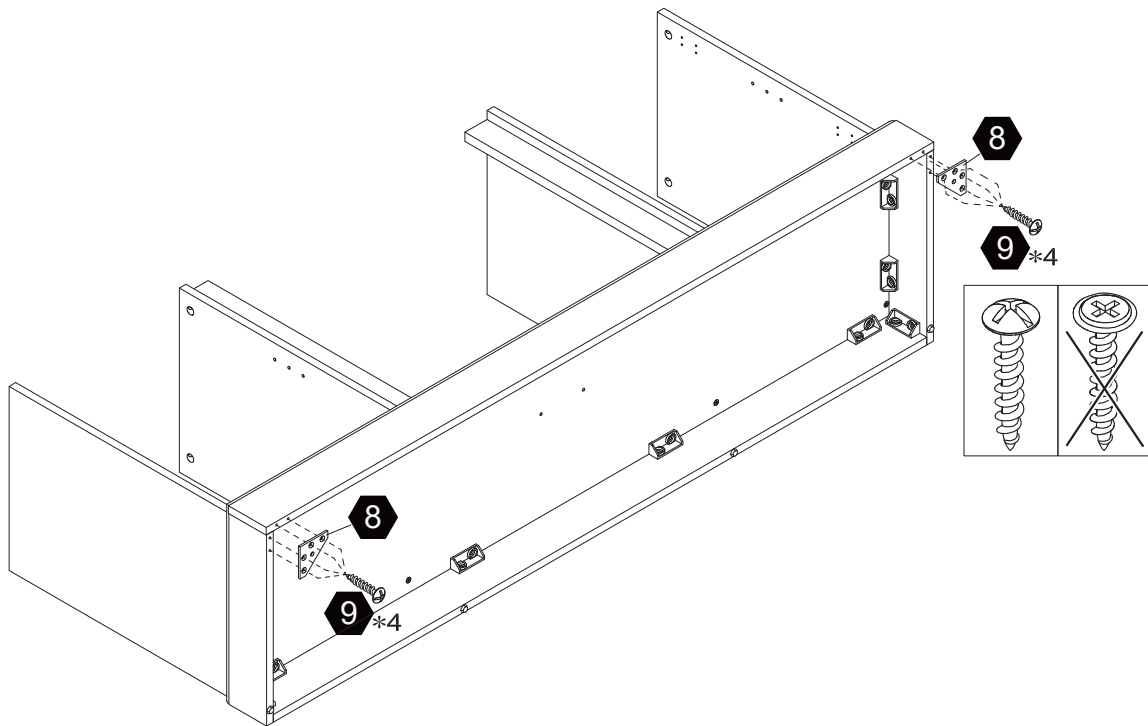

## Step 10

- 10**  1/4-20\*5/8" 2 pcs

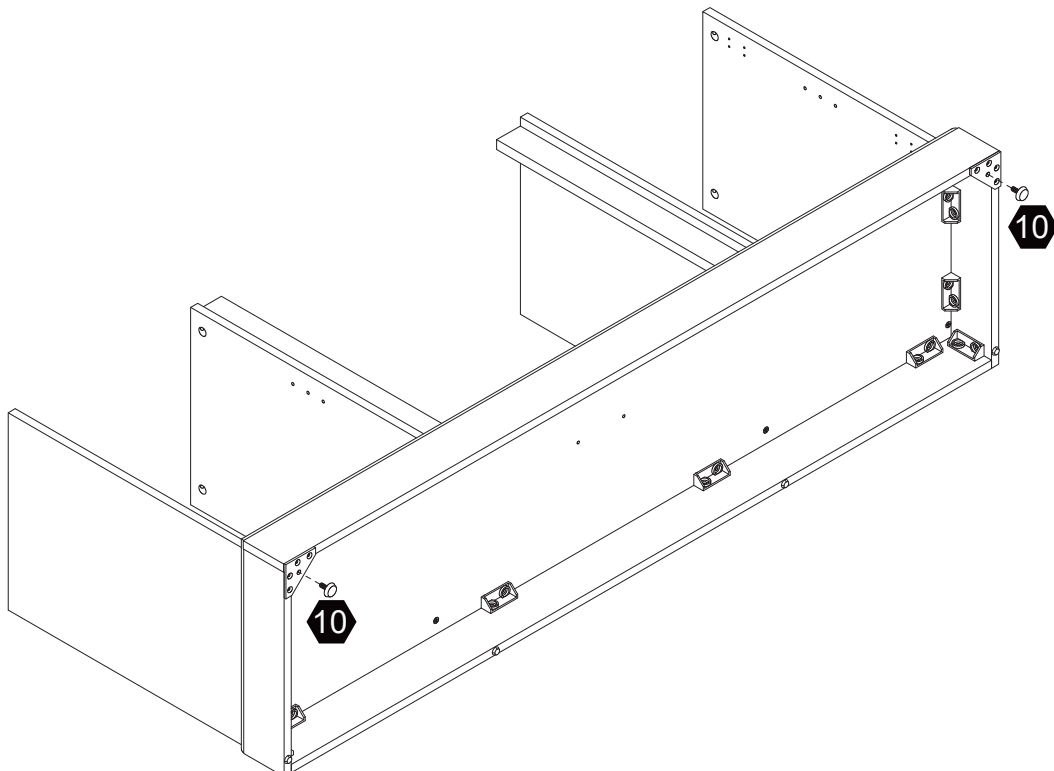



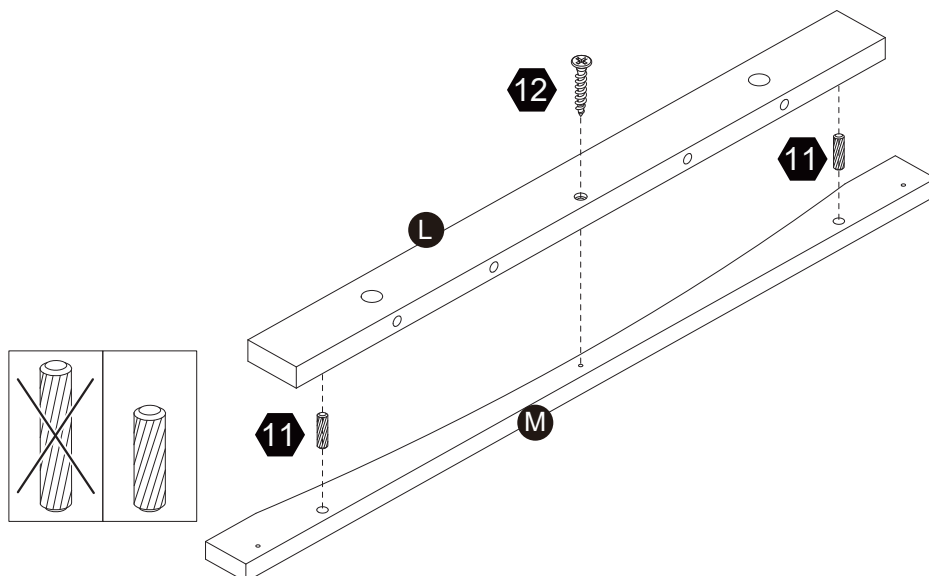

## Step 11

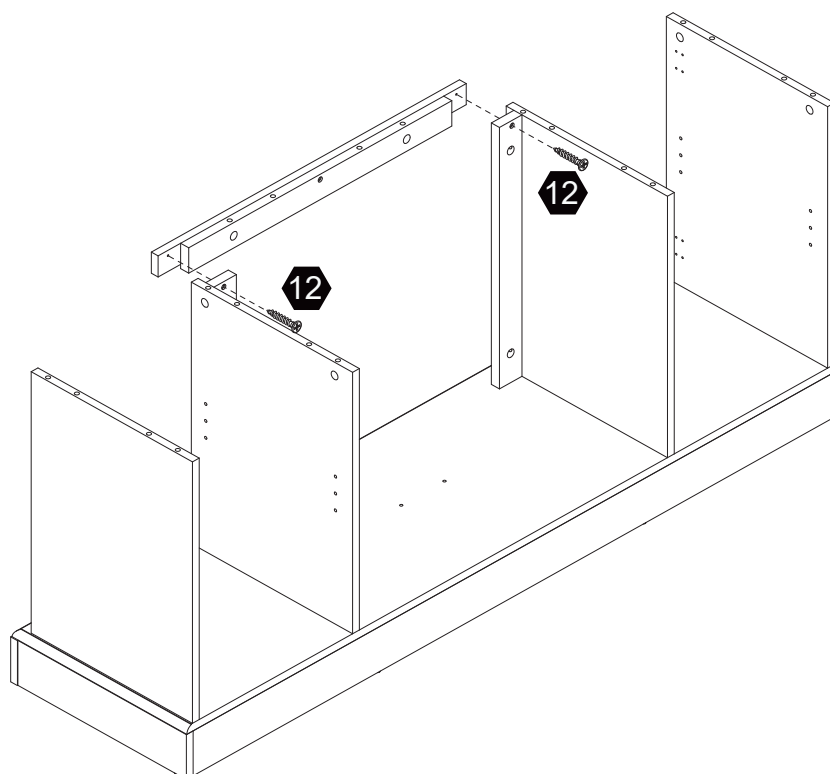

## Step 12



## Step 13

**4**  M6\*35mm 10 pcs

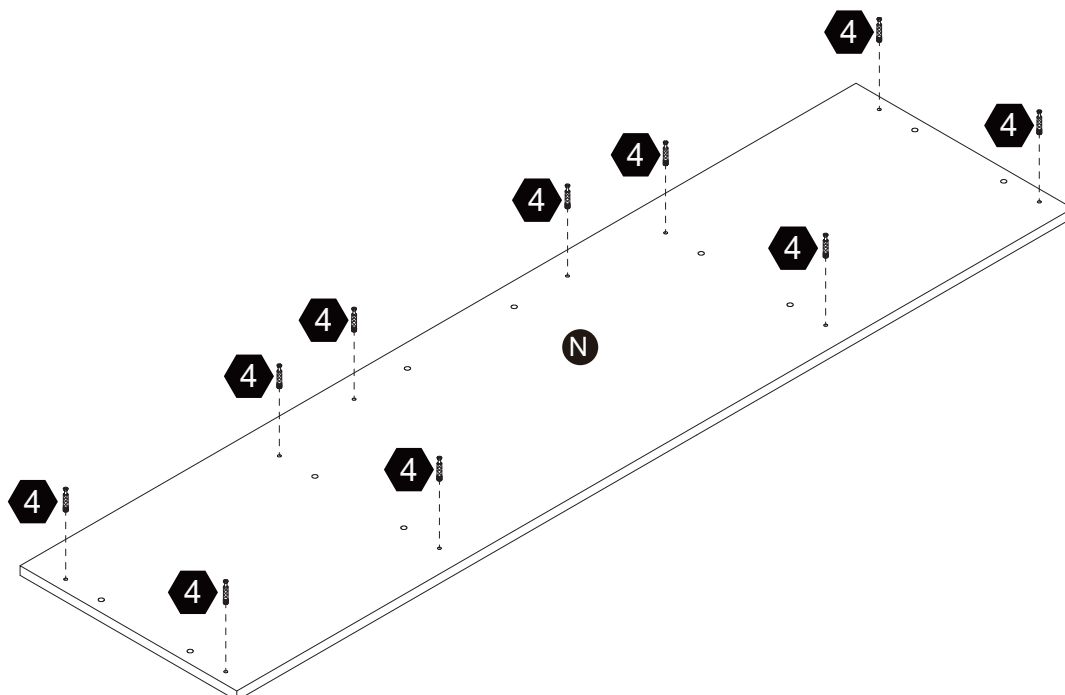

## Step 14

**5**  Ø15\*12 10 pcs      **6**  Ø8\*30mm 10 pcs

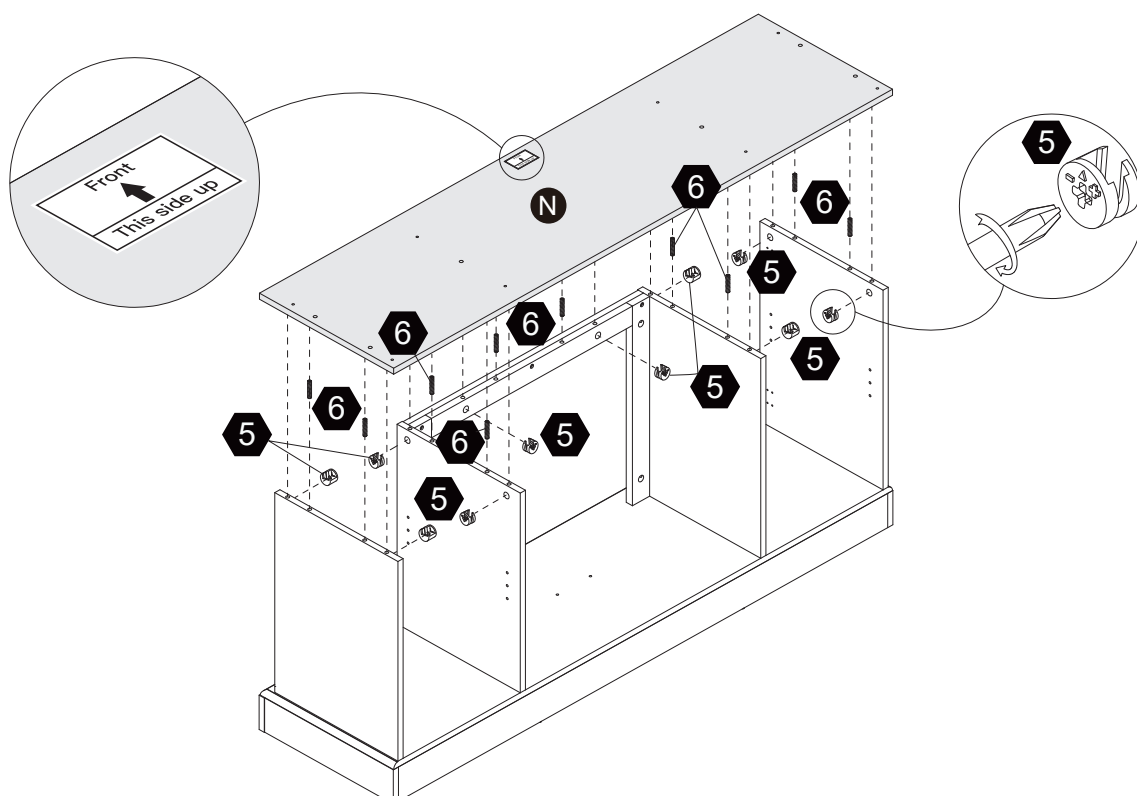

## Step 15

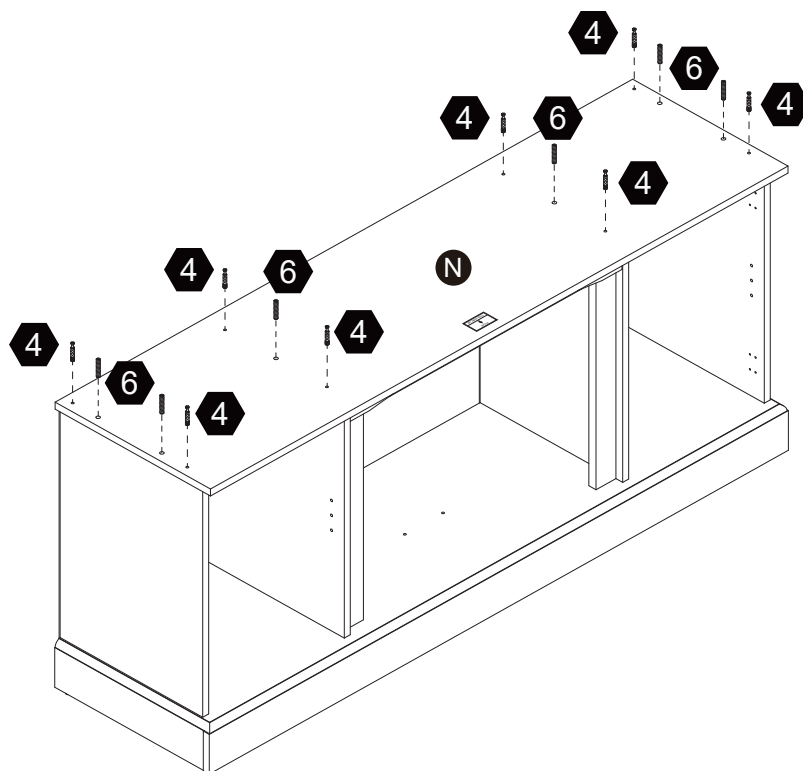

## Step 16

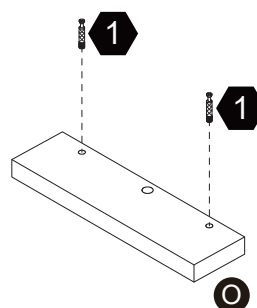
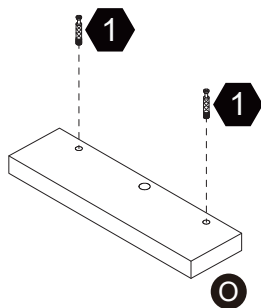
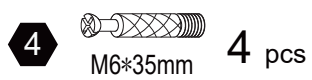

## Step 17

5



Ø15\*12

4 pcs

6

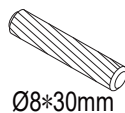

Ø8\*30mm

2 pcs

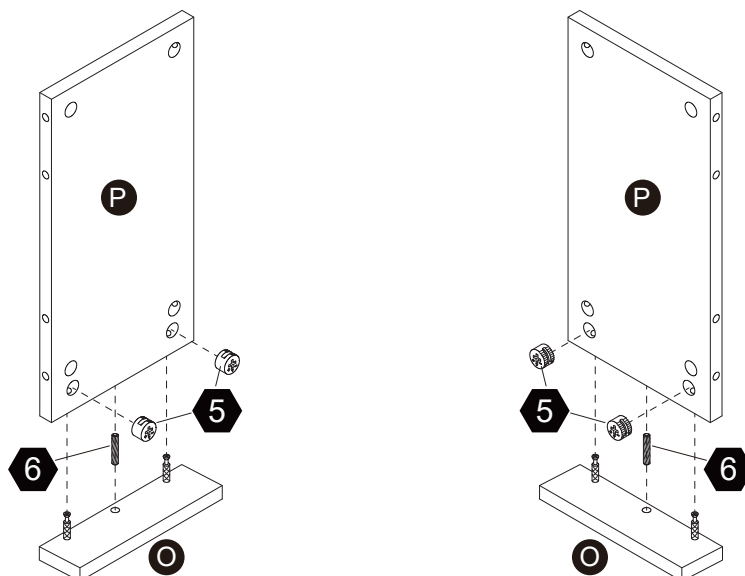

## Step 18

5



Ø15\*12

8 pcs

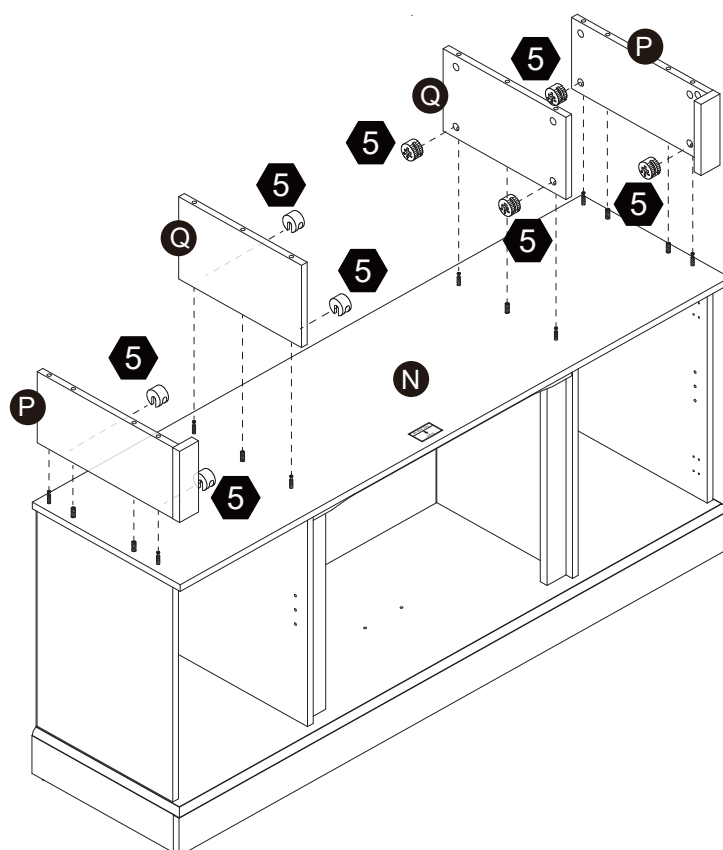

## Step 19

**4**  M6\*35mm **8 pcs**

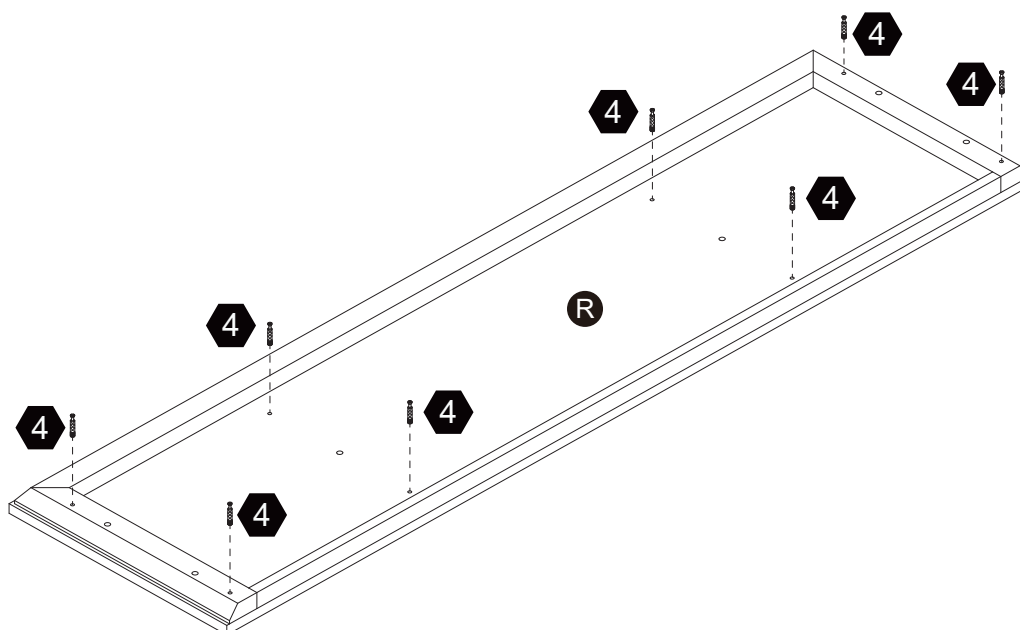

## Step 20

**5**  Ø15\*12 **8 pcs** **6**  Ø8\*30mm **6 pcs**

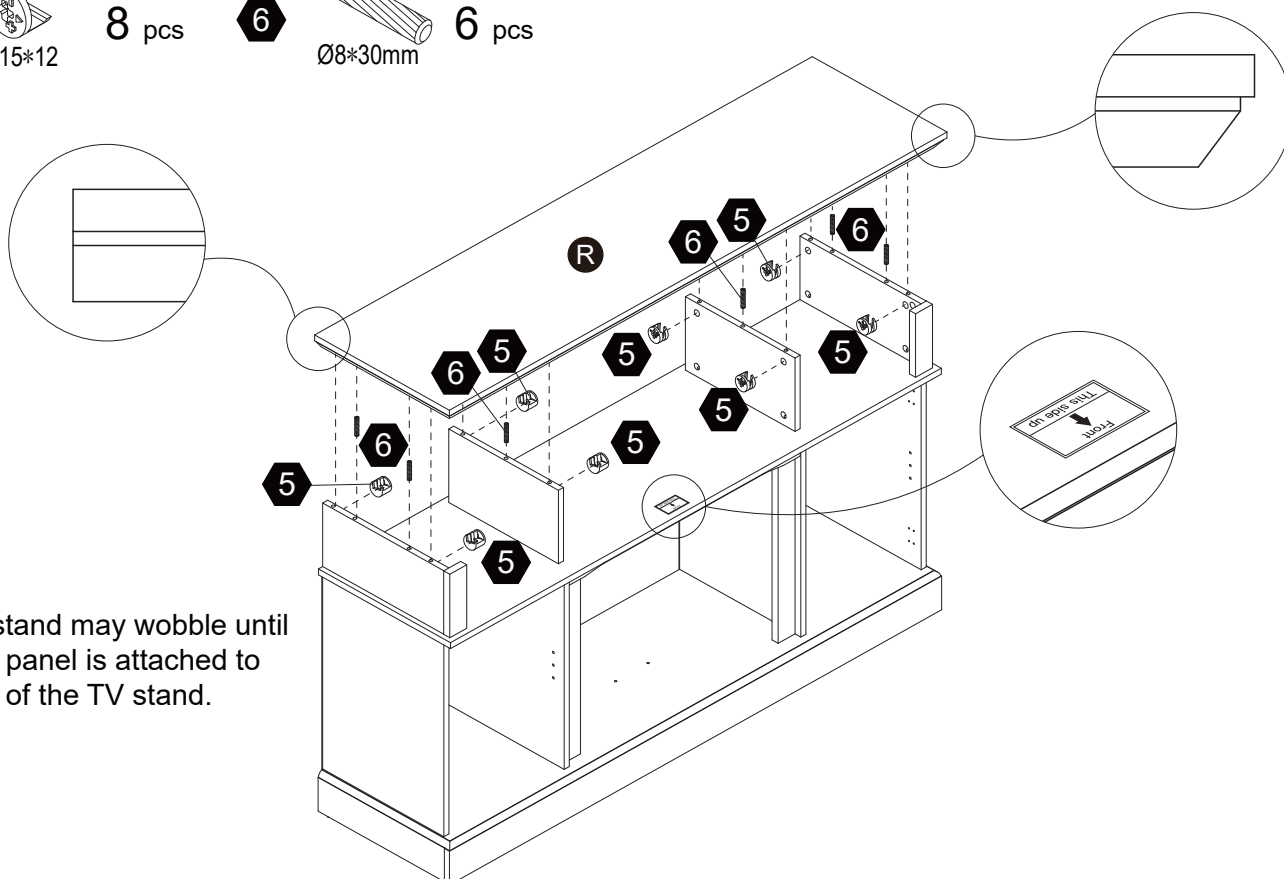

The TV stand may wobble until the back panel is attached to the back of the TV stand.

## Step 21

13



M3\*15mm

14 pcs

**Helpful Tip:** There are only 2 pilot holes on the top panel for locating the back panel on the back of the TV stand. We do not pre-drill pilot holes on the sides and bottom. It is recommended to attach the back panel [S] at the top panel [R] first, then use a Phillips screwdriver to screw the screws into the TV stand. Do not fully tighten all the screws [13] until all of them are in correct position.

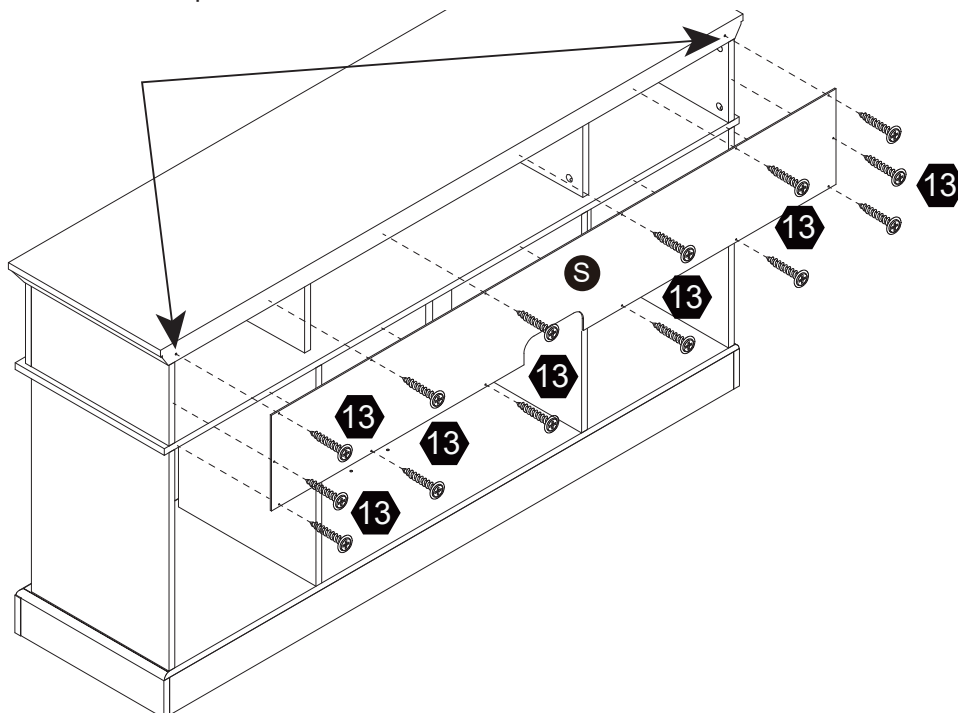

## Step 22

13

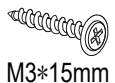

M3\*15mm

16 pcs

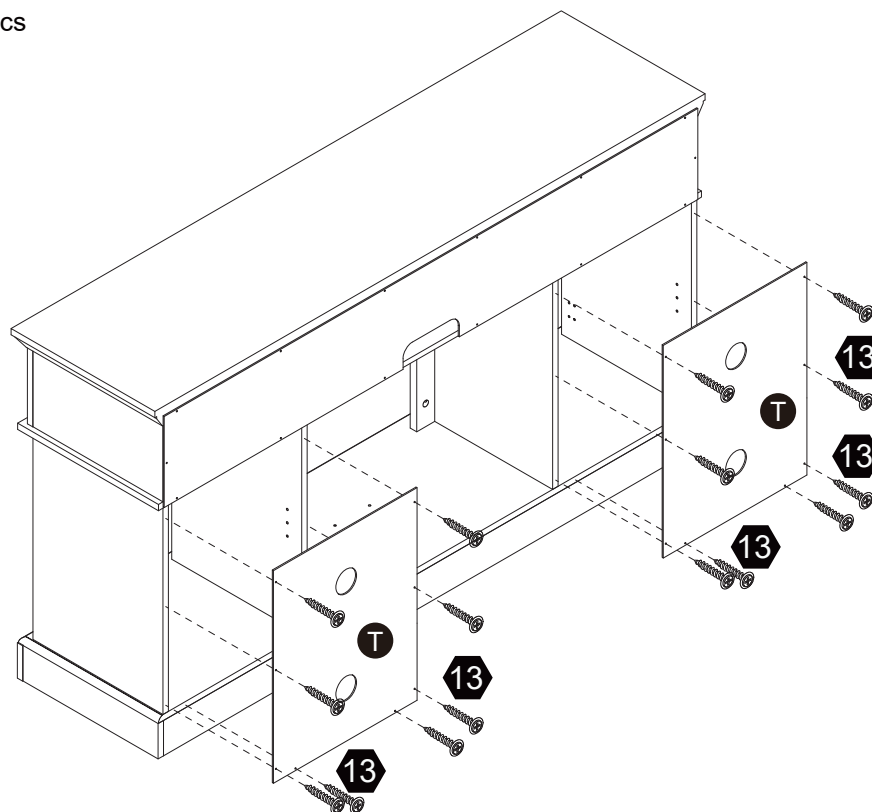

## Step 23

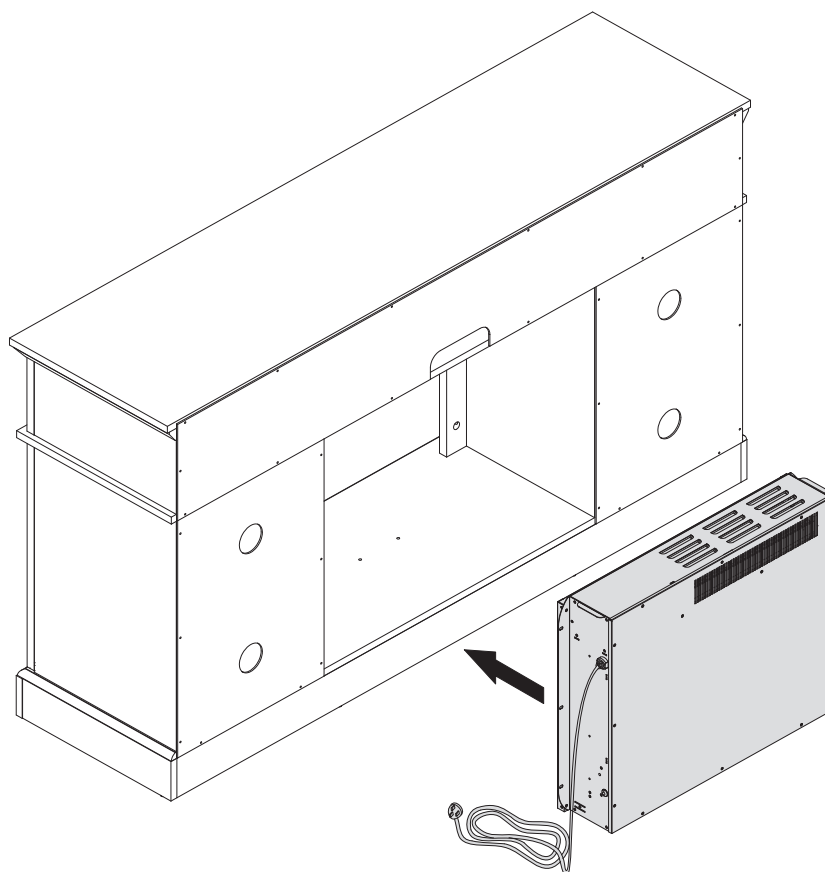

## Step 24

**14**  2 pcs  
M6\*50mm

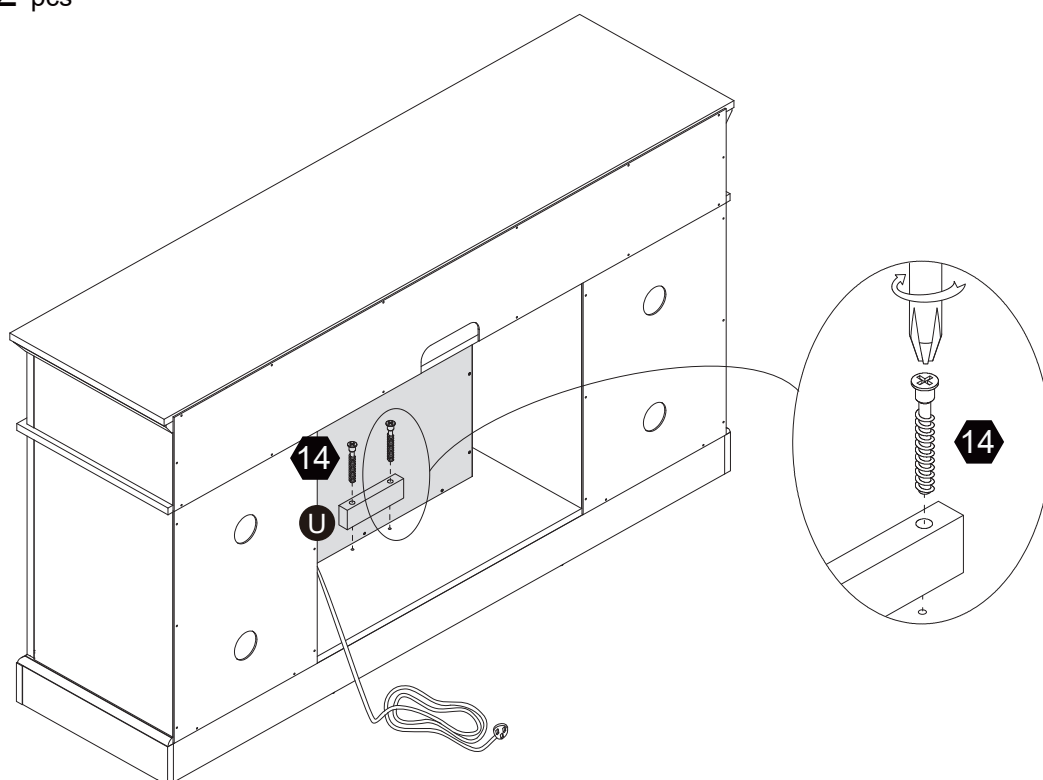

## Step 25

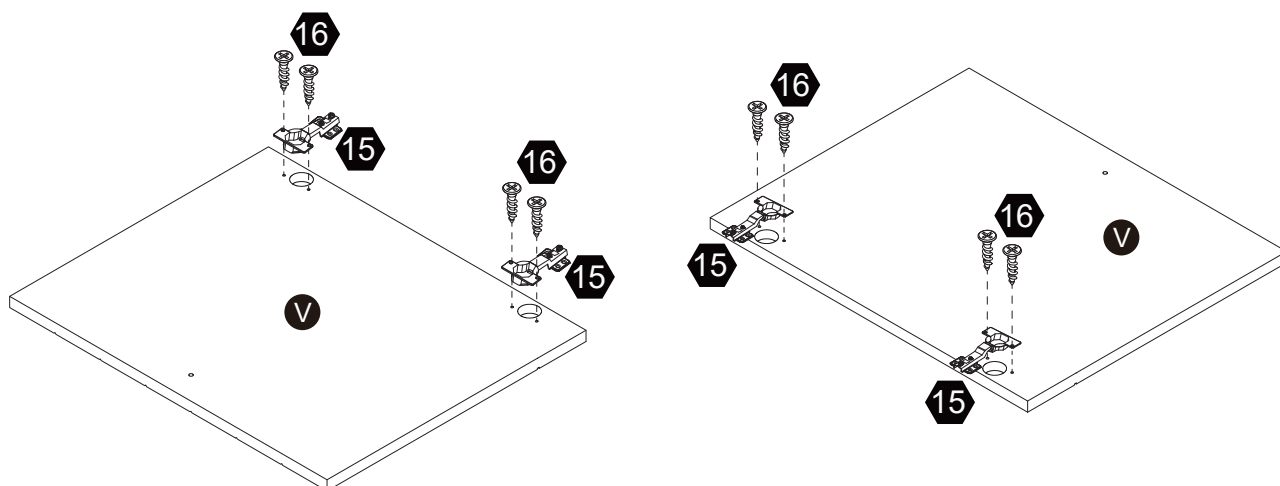

## Step 26

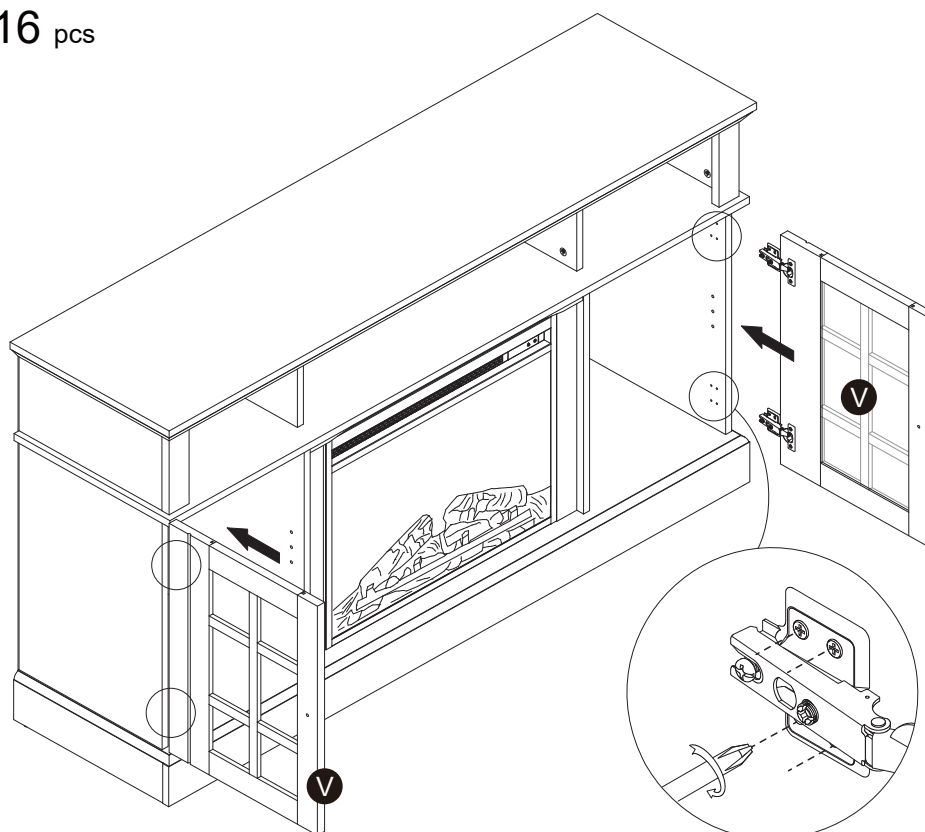



## Step 27

The door may go out of alignment during shipping. Open and close the doors to make sure they are aligned and shut correctly. If you find that the doors need to be adjusted, turn the appropriate screw, as illustrated.

Three-way adjustable hinge for perfectly aligned doors:

1. To adjust door up or down.
2. To adjust door forward or backward.
3. To adjust door right or left.

Turn the set screw [S] clockwise to narrow the gap between the door and the side panel.

Turn the set screw [S] counter-clockwise to enlarge the gap between the door and the side panel.

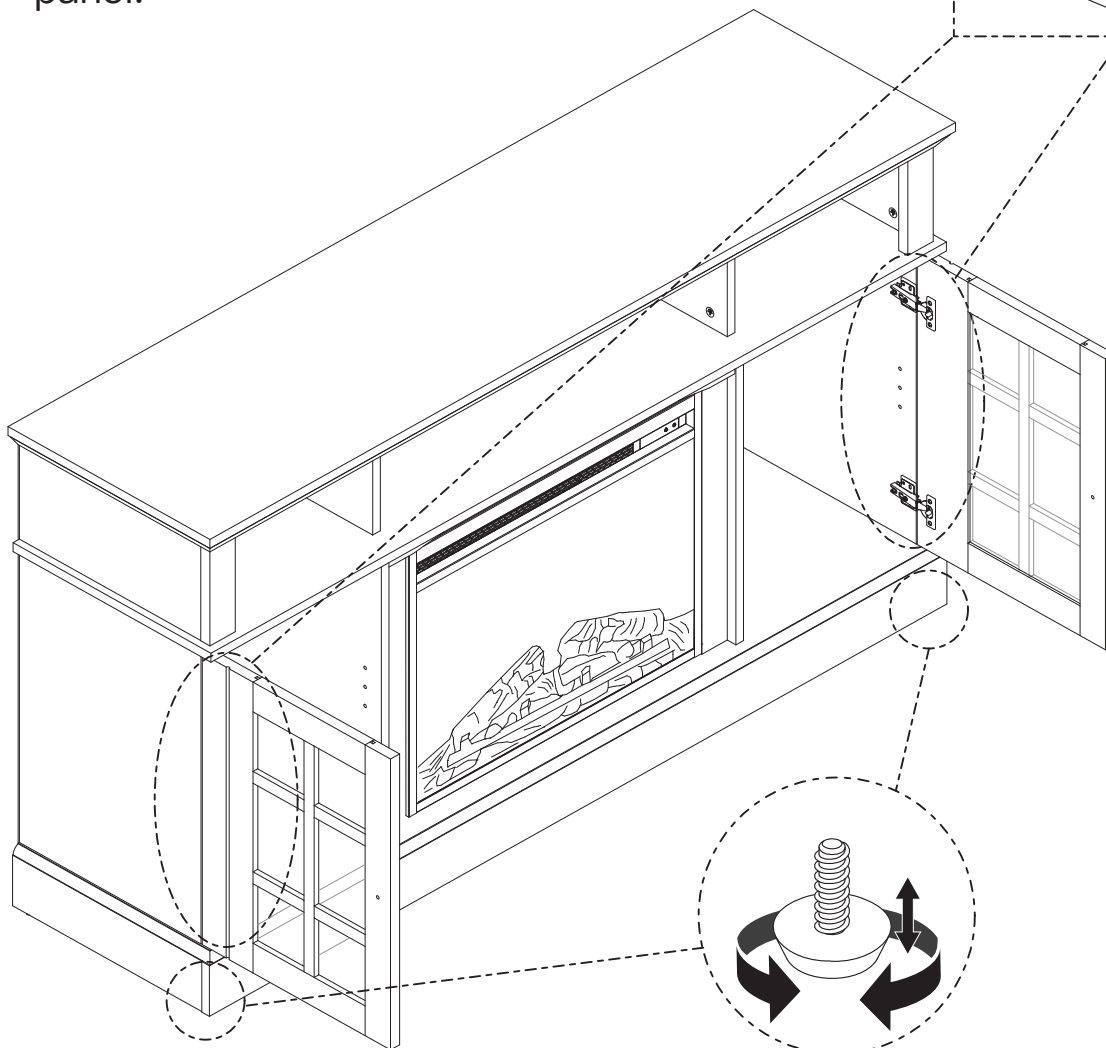
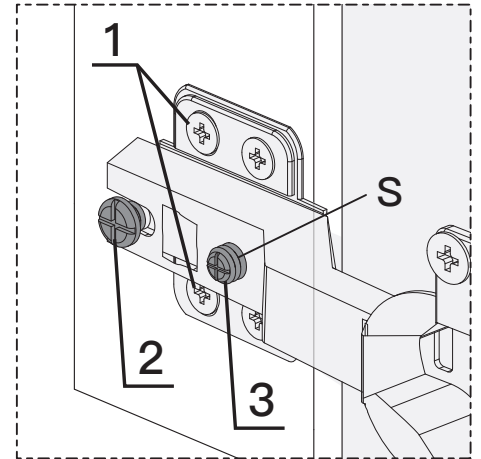

**NOTE:** It helps to prevent your TV from tipping over if you turn the two feet to raise the front corners.

## Step 28

- 17 2 pcs 18 M4\*28 2 pcs 19 Ø8\*16 8 pcs

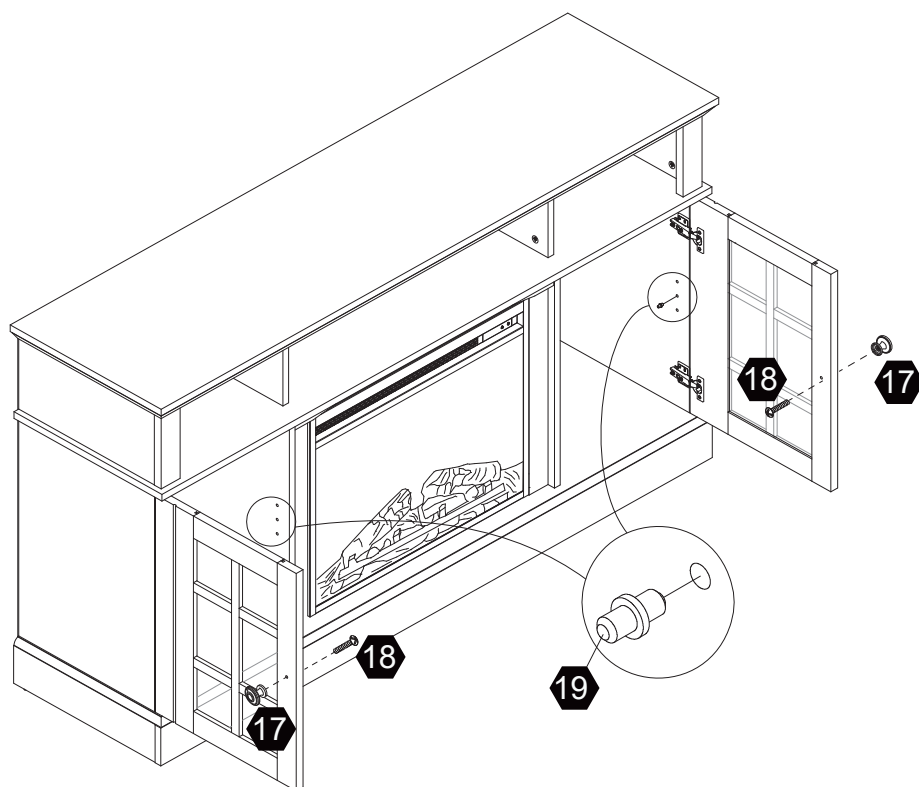

## Step 29

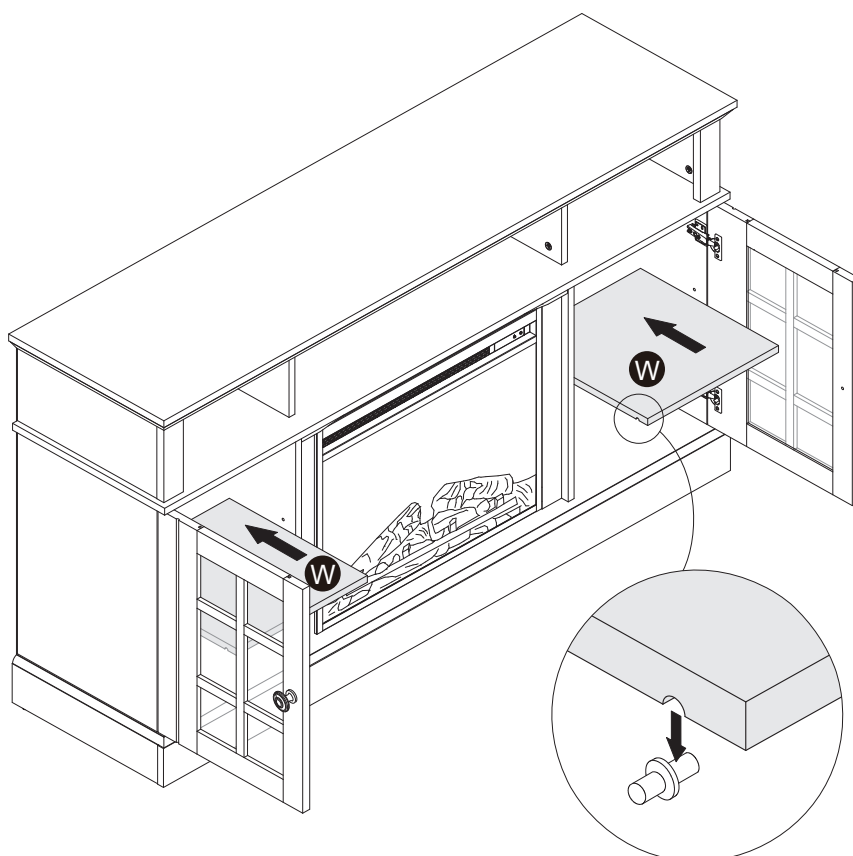

# Step 30

