



## WARNING:

CHOKING HAZARD/SHARP POINTS- Assembly hardware contains small parts and components with sharp points.  
Adult assembly required.

## Instructions for: 4697JC3 4-Section Stackable Locking Lockers-Top

### Required Tools:

-Standard and Phillips  
Screwdriver

### Hardware Package **HBWA**

Qty Description

(3) **XAFH** 3" Drywall Screw

(4) **XCND** Lock Core with Key

(4) **XADO** 1/4" X 1-1/4" Trusshead Bolt

### Assembly Instructions:

1. Wall mount bracket is required on stacking three units high and is only required on top unit in stack.
2. Stack Lockers beginning with **Base Locker** (4697JC1). Stack **Mid Locker** (4697JC2) and bolt together with 1/4" x 1 1/4" bolts through bottom of unit into top of lower unit. Repeat for **Top Locker** (4697JC3).

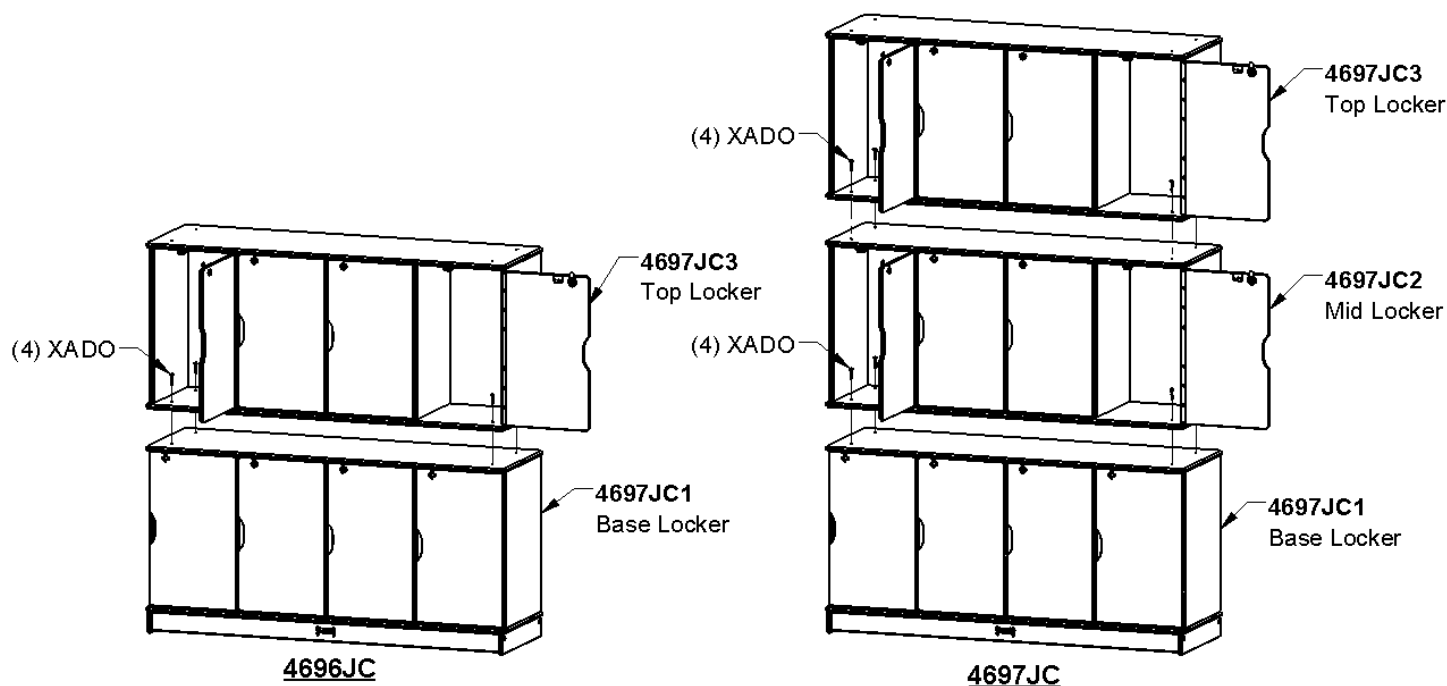

3. Locate wall studs and attach Wall-Mount Bracket (Supplied with Top Locker 4697JC3) to the wall studs using three 3" drywall screws.

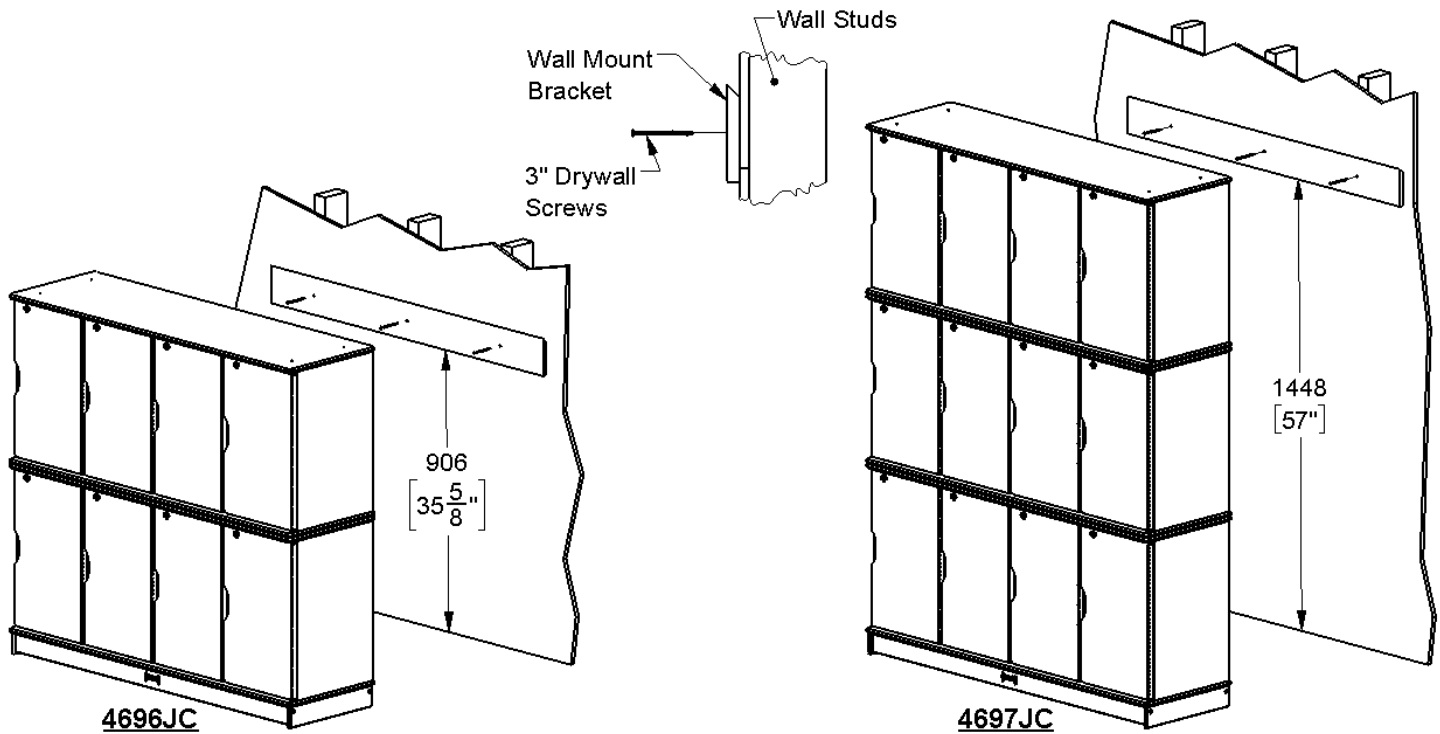

4. Place unit over wall-mounted bracket and units are ready to be used.
5. Insert the lock core into the barrel of the dead bolt lock by aligning the tumbler tabs of the lock core with either of the slots found in the dead bolt lock. Using your thumb press the lock core firmly until it clicks into place.
6. **NOTE:** if the lock core does not snap into place you may need to insert a flat screwdriver into the barrel of the dead bolt lock and turn the screwdriver either direction so that the locking mechanism is in line with the slots in the barrel of the dead bolt lock.
7. Follow directions found attached to the provided master key to remove cores from the dead bolt lock.

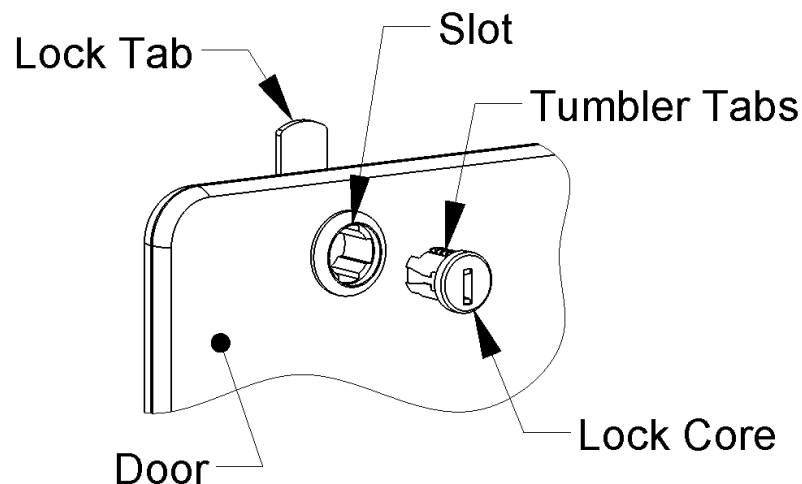

8. If you experience any difficulties when assembling this product, please contact the Jonti-Craft Customer Relations Team at (800) 543-4149 or [sales@jonti-craft.com](mailto:sales@jonti-craft.com). All other requests for assistance must be directed to your Jonti-Craft Dealer.