

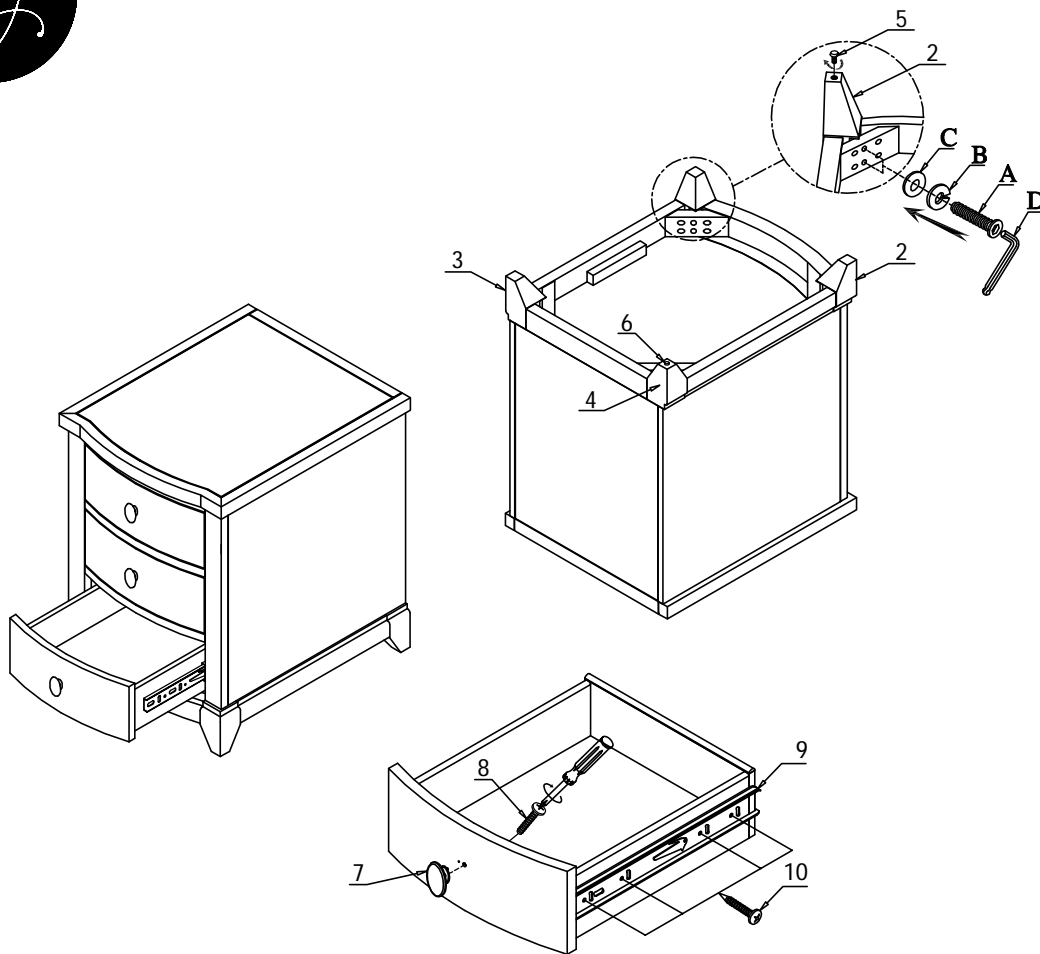

656/657-811 3 DRAWER CHAIRSIDE CHEST



WARNING! Failure to follow each of the following assembly instructions precisely may result in damage to the product and / or injury to consumer.

1. REMOVE ALL PARTS FROM CARTON AND SEPARATE THEM INTO PART NUMBER GROUPS AS INDICATED ON THE PART LIST. WHEN ORDERING ADDITIONAL PARTS, INDICATE MANUFACTURER REPLACEMENT PART NUMBER (MRP#) AS WELL AS PART NAME.

2. PLACE THE CHAIRSIDE CHEST ON ITS BACK ON A SMOOTH AND FLAT SURFACE. ATTACH LEGS (2,3,4,) TO THE CORNERS FOLLOWING FIGURE 1. SECURE WITH FLAT WASHERS (C) LOCK WASHERS (B) AND BOLTS (A) USING ALLEN WRENCH (D).

3. TURN THE ASSEMBLED CHAIRSIDE CHEST UPRIGHT NOW.

| PARTS | MRP# | DESCRIPTION | Q'TY |
|-------|------|--|------|
| A | 1 | BOLT $\Phi 5/16"$ *2-1/2" | 8 |
| B | | LOCK WASHER $\Phi 5/16"$ | 8 |
| C | | FLAT WASHER $\Phi 5/16"$ *19*2mm | 8 |
| D | | ALLEN WRENCH $\Phi 5/16"$ | 1 |
| 2 | 2 | FRONT LEGS | 2 |
| 3 | 3 | BACK LEG LEFT | 1 |
| 4 | 4 | BACK LEG RIGHT | 1 |
| 5 | 5 | LEVELER (PRE-ASSEMBLED) | 2 |
| 6 | 6 | FLOOR GLIDE(PRE-ASSEMBLED) | 2 |
| 7 | 7 | KNOB (PRE-ASSEMBLED) | 3 |
| 8 | 8 | BOLT $\Phi 5/32$ *1-3/8" (PRE-ASSEMBLED) | 3 |
| 9 | 9 | BALL BEARING GLIDE(PRE-ASSEMBLED) | 3Set |
| 10 | 10 | SCREW 6.5*12(PRE-ASSEMBLED) | 60 |