

Installation Guide

Tools Required

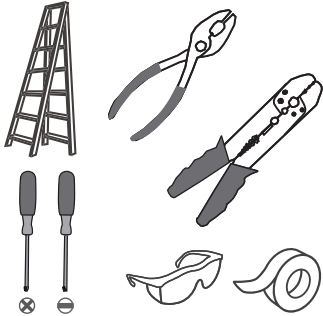

Light Source

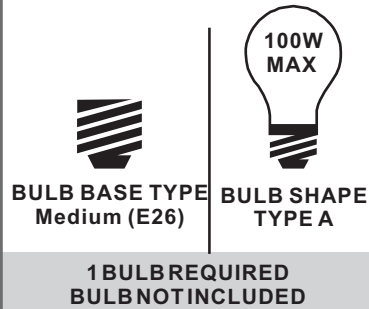

Warnings and Cautions

Turn off the electricity at the circuit breaker before installation. Consult a licensed electrician if in doubt about installation.

Turn off power to the fixture and allow the bulbs to cool before replacing.

Package Contents

Preparation: Identify and inspect all parts before beginning the installation.

Missing or damaged parts? Contact your original place of purchase.

PARTS BAG

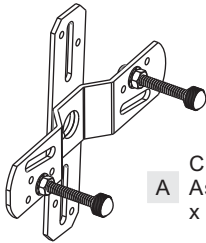

A Crossbar Assembly x 1



B Alternate Mounting Screw x 2



C Outlet Box Screw x 2



D Wire Connector x 3



E Fixture Loop x 1

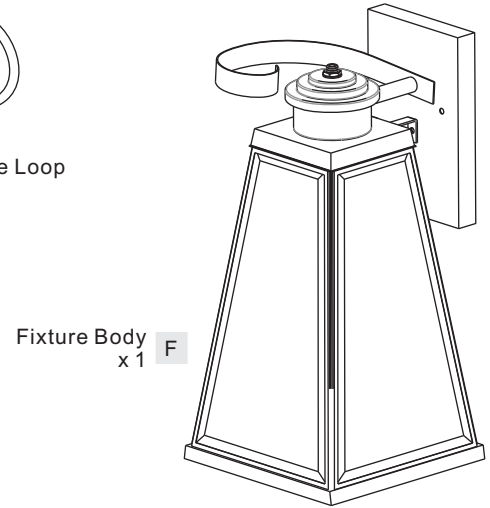

F Fixture Body x 1

Table of Contents

Fixture Loop & Scroll



STEP 1

Alternate Mounting Screw



STEP 2

Crossbar Assembly

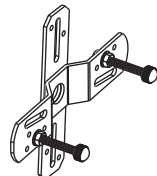

STEP 3

Wiring

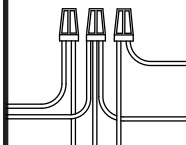

STEP 4

Fixture Body

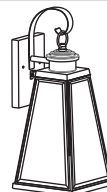

STEP 5

Bulb



STEP 6

Caulk

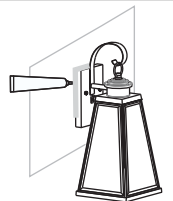

STEP 7

STEP 1

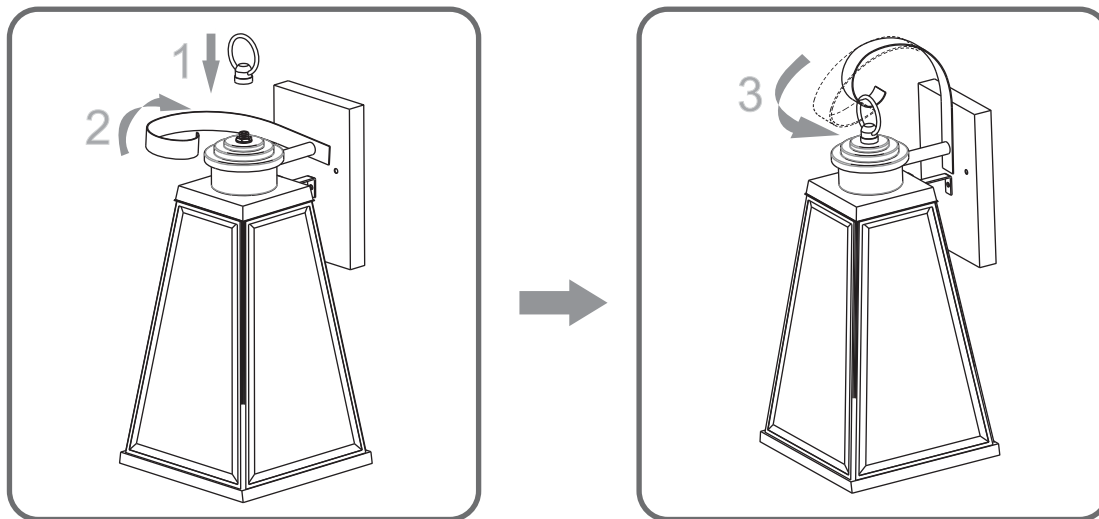

STEP 2

OPTION 1

Standard
Mounting
Screw

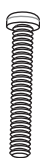

Included
(Pre-assembled)

OPTION 2

Alternate
Mounting
Screw



Included

skip to next page

1

2

3

Steps 1-3 to remove standard mounting screws

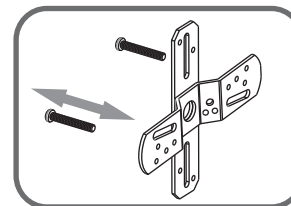
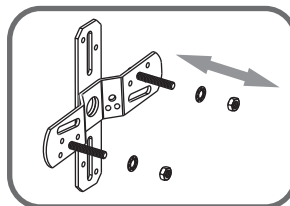
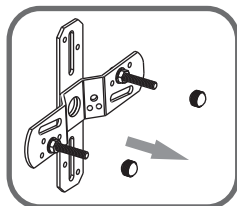

4

Steps 4-6 to reassemble with alternate mounting screws

6

5

STEP 3

1

2

3

Step 1
Install crossbar assembly

Step 2 - 3
Test fitting backplate to mounting screws

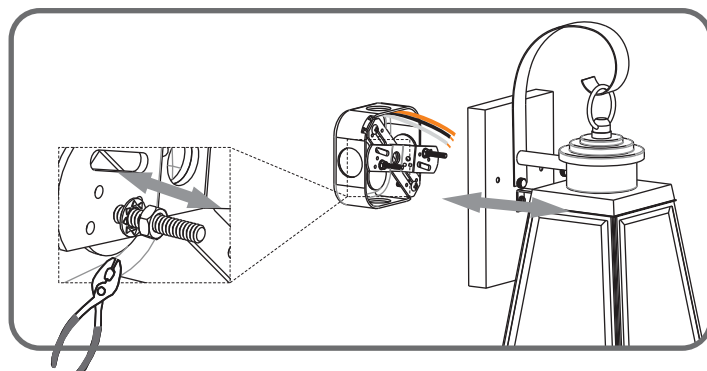
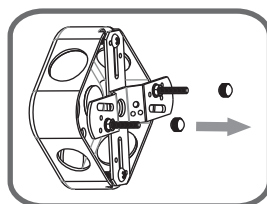
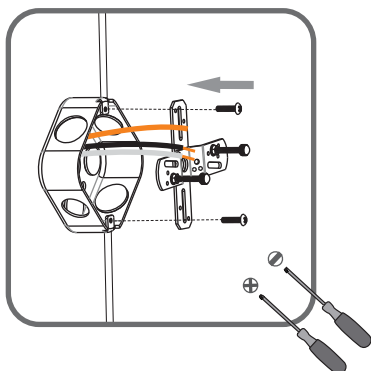

STEP 4

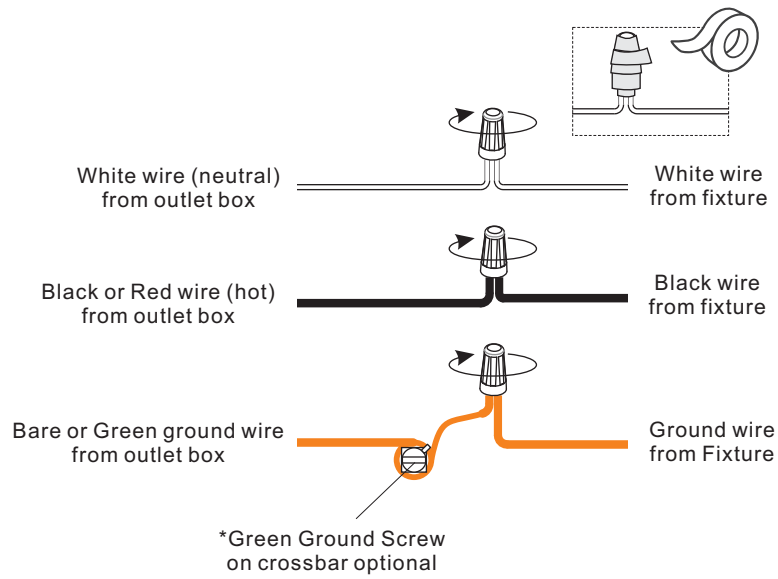

STEP 5

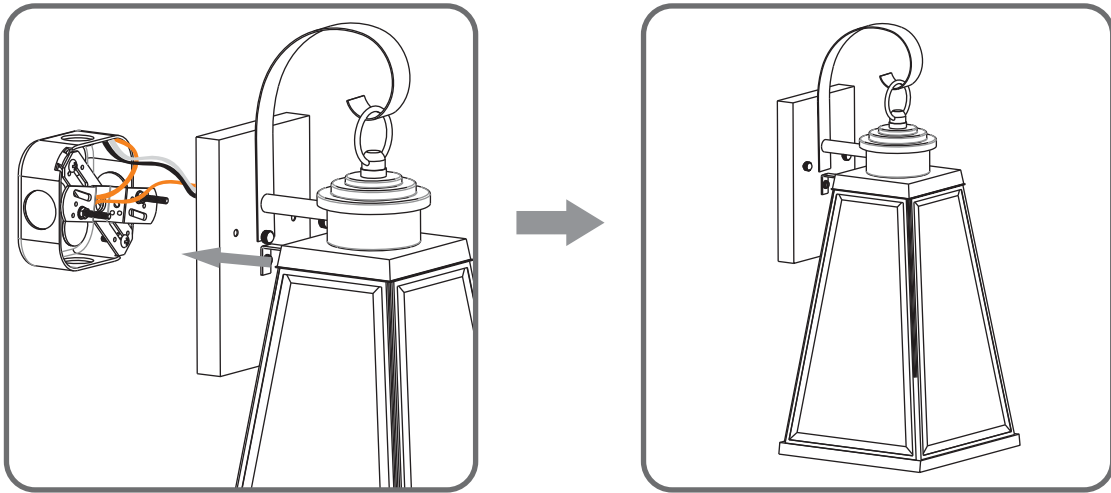

STEP 6

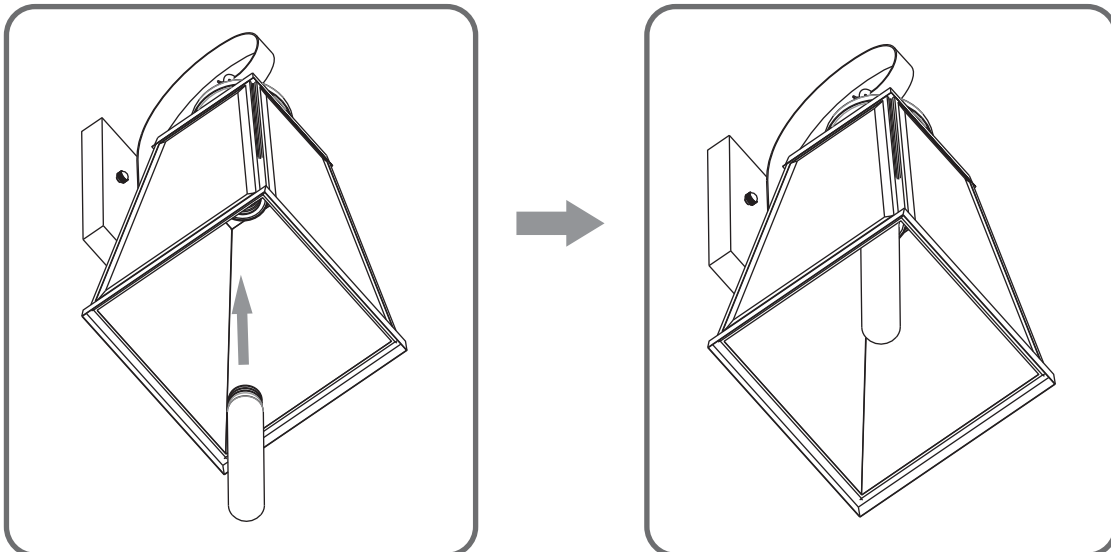

STEP 7

