

NINJA®

QB3001UKS

INSTRUCTIONS

SMOOTHIE MAKER



ninjakitchen.co.uk

THANK YOU FOR PURCHASING
your Ninja® Smoothie Maker



REGISTER YOUR PURCHASE

- ninjakitchen.co.uk/register-guarantee/
- Scan QR code using mobile device

RECORD THIS INFORMATION

Model Number: _____

Serial Number: _____

Date of Purchase: _____
(Keep receipt)

Store of Purchase: _____

TECHNICAL SPECIFICATIONS

Voltage: 220-240V~, 50-60Hz

Power: 700 Watts

CUP CAPACITY:

470ml

PLEASE READ CAREFULLY AND
KEEP FOR FUTURE REFERENCE.

CONTENTS

Important Safeguards.....4

Getting to Know Your Ninja Smoothie Maker.....7

Before First Use.....8

Blending Instructions.....9

Care & Maintenance.....10

Cleaning.....10

Storing.....10

Resetting the Motor Thermostat.....10

Troubleshooting Guide.....11

PRODUCT REGISTRATION

Please visit ninjakitchen.co.uk to register your new Ninja® product within 28 days of purchase. You will be asked to provide the store name, date of purchase, and model number along with your name and address.

The registration will enable us to contact you in the unlikely event of a product safety notification.

IMPORTANT SAFETY INSTRUCTIONS

HOUSEHOLD USE ONLY • READ ALL INSTRUCTIONS BEFORE USE

⚠ WARNING

To reduce the risk of injury, fire, electrical shock or property damage, basic safety precautions must always be followed, including the following numbered warnings and subsequent instructions. Do not use appliance for other than intended use.

- 1 Read all instructions prior to using the appliance and its accessories.
- 2 Carefully observe and follow all warnings and instructions. This unit contains electrical connections and moving parts that potentially present risk to the user.
- 3 **ALWAYS** exercise care when handling the Pro Extractor Blades® Assembly. The blades are sharp. **ONLY** grasp the Pro Extractor Blades® Assembly by the outer perimeter of the blade assembly base. Failure to use care when handling the blade assembly will result in a risk of laceration.
- 4 Take your time and exercise care during unpacking and appliance setup. This appliance contains sharp, loose blades that can cause injury if mishandled.
- 5 Take inventory of all contents to ensure you have all parts needed to properly and safely operate your appliance.
- 6 Turn the appliance **OFF**, then unplug the appliance from the socket when not in use, before assembling or disassembling parts, and before cleaning. To unplug, grasp the plug by the body and pull from the socket. **NEVER** unplug by grasping and pulling the flexible cord.
- 7 Before use, wash all parts that may contact food. Follow washing instructions covered in this instruction manual.
- 8 Blades are sharp. Handle carefully.
- 9 To protect against the risk of electric shock, **DO NOT** submerge the appliance or allow the power cord to contact any form of liquid.
- 10 **DO NOT** use this appliance outdoors. It is designed for indoor household use only.
- 11 **DO NOT** operate any appliance with a damaged cord or plug, or after the appliance malfunctions or is dropped or damaged in any manner. This appliance has no user-serviceable parts. If damaged, contact SharkNinja for servicing.
- 12 **DO NOT** abuse the power cord. Never carry the appliance by the power cord or yank it to disconnect from electrical socket; instead grasp the plug and pull to disconnect.
- 13 Extension cords should **NOT** be used with this appliance.
- 14 **DO NOT** allow children to operate this appliance, to play with it, or use as a toy. Keep the appliance and its cord out of reach of children.
- 15 This appliance is **NOT** intended to be used by people (including children) with reduced physical, sensory, or mental capabilities, or lack of experience and knowledge, unless they are given supervision or instruction concerning use of the appliance by a person responsible for their safety.

- 16 Before each use, inspect blade assemblies for damage. If a blade is bent or damage is suspected, contact SharkNinja to arrange for replacement.
- 17 **DO NOT** attempt to sharpen blades.
- 18 Keep the appliance and its cord out of reach of children.
- 19 **DO NOT** allow the unit or the cord to hang over the edges of tables or worktops. The cord may become snagged and pull the appliance off the work surface.
- 20 **DO NOT** allow any part of the unit to contact hot surfaces, including stoves and other heating appliances.
- 21 **ALWAYS** use the appliance on a dry and level surface.
- 22 **NEVER** place a blade assembly on the motor base without it first being attached to its corresponding container (bowl, pitcher, cup) and lid.
- 23 **ONLY** use attachments and accessories that are provided with the product or are recommended by SharkNinja. The use of attachments not recommended or sold by SharkNinja may cause fire, electric shock, or injury.
- 24 The use of attachments, including canning jars, not recommended by the manufacturer may cause a risk of injury to persons.
DO NOT use stainless steel cup accessory model XSKDWSS24 with blender.
- 25 During operation and handling of the appliance, avoid contact with moving parts.
- 26 **DO NOT** operate the appliance with an empty container.
- 27 **DO NOT** fill containers past the **MAX FILL** or **MAX LIQUID** lines.
- 28 **DO NOT** microwave any containers or accessories provided with the appliance.
- 29 **DO NOT** perform grinding operations with the Single-Serve Cup and Pro Extractor Blades® Assembly.
- 30 Before operation, ensure all utensils are removed from containers. Failure to remove utensils can cause containers to shatter and potentially result in personal injury and property damage.
- 31 Keep hands, hair, clothing, as well as utensils out of container while processing to reduce the risk of severe injury to persons or damage to the appliance. A scraper may be used but only when the appliance is not running.

SAVE THESE INSTRUCTIONS

IMPORTANT SAFETY INSTRUCTIONS

32 NEVER operate the appliance without lids and caps in place. **DO NOT** attempt to defeat the interlock mechanism. Ensure the container and lid are properly installed before operation.

33 DO NOT expose the containers and accessories to extreme temperature changes. They may experience damage.

34 NEVER leave the appliance unattended while in use.

35 DO NOT blend hot liquids. Doing so may result in pressure buildup and steam exposure that can pose a risk of the user being burned.

36 DO NOT remove the cup from the motor base while the appliance is running.

37 Remove the Pro Extractor Blades® Assembly from the Single-Serve Cup upon completion of blending. **DO NOT** store ingredients before or after blending them in the cup with the blade assembly attached. Some foods may contain active ingredients or release gases that will expand if left in a sealed container, resulting in excessive pressure buildup that can pose a risk of injury. For ingredient storage in the cup, use only Spout Lid to cover.

38 The maximum wattage rating for this appliance is based on the configuration of the Pro Extractor Blades® Assembly and Single-Serve Cup. Other configurations may draw less power or current.

39 Max **ON** time is 30 seconds under 700W load. If the appliance overheats, a thermal switch will become activated and shut off the motor. To reset, unplug the appliance and let it cool down for approximately 30 minutes before using again.

40 DO NOT process dry ingredients without adding liquid to the Single-Serve Cup. The Single-Serve Cup is not intended for dry blending.

41 To protect against risk of electrical shock, **DO NOT** immerse the motor base in water or other liquid.

42 DO NOT spray the motor base with any liquids. Turn off and unplug the motor base before cleaning.

43 The maximum wattage rating for this appliance is achieved by chopping 200g beef in the 470ml (16oz) cup for 5 seconds.



Indicates to read and review instructions to understand operation and use of product.



Indicates the presence of a hazard that can cause personal injury, death or substantial property damage if the warning included with this symbol is ignored.



For indoor and household use only.

GETTING TO KNOW YOUR NINJA® SMOOTHIE MAKER

MAIN UNIT

- A** 470ml Single Serve Cups (x 2)
- B** Pro Extractor Blades® Assembly
- C** Motor Base (attached power cord not shown)
- D** Spout Lid (x2)

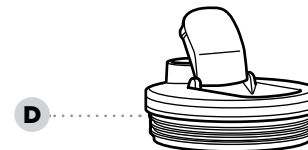
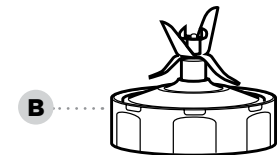
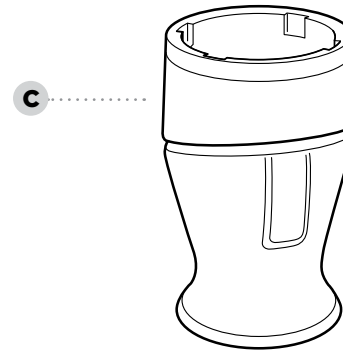

SAVE THESE INSTRUCTIONS

To order additional parts and accessories, visit ninjakitchen.co.uk

BEFORE FIRST USE

DID YOU KNOW?

- You can take your drinks on the go using the Spout Lids.
- The containers, blade assemblies, and lids are BPA free and dishwasher safe.

NOTE: Handle the Pro Extractor Blades® Assembly by grasping around the perimeter of the blade assembly base.

NOTE: All attachments are dishwasher safe. It is recommended that the lids, containers and blade assemblies be placed on the top rack of the dishwasher. Ensure blade assemblies and lids are removed from their containers before placing in the dishwasher. Exercise care when handling blade assemblies.

- 1** Remove all packaging materials from the appliance. Exercise care when unpacking blade assemblies. All blade assemblies are sharp.
- 2** Wash containers, lids, and blade assemblies in warm, soapy, water using a dishwashing utensil with a handle to avoid direct contact with the blades. Exercise care when handling blade assemblies, as the blades are sharp.
- 3** Thoroughly rinse and air-dry all parts.

BLENDING INSTRUCTIONS



- 1** Add ingredients to the Single-Serve Cup. **DO NOT** add ingredients past the **MAX LIQUID** line on the cup.

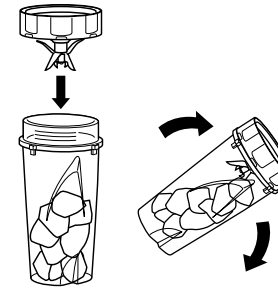

- 2** Place the Blade Assembly on the top of the cup and turn clockwise to seal.
- 3** Turn cup upside down so the bottom of the blade assembly is flat on the worktop.
- 4** Place the cup upside down on the motor base. Press down on the cup to pulse or blend.

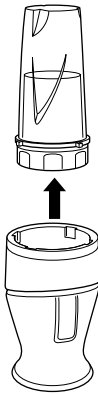
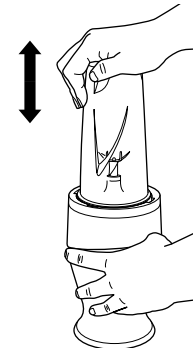

- 5** When blending is complete, lift up the cup to remove.

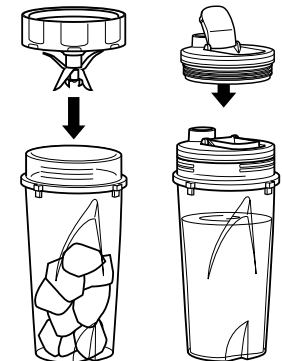

- 6** Turn cup over so blade assembly is on top. Twist blade assembly anti-clockwise to remove. To take your blended contents on the go, place the spout lid on cup and turn clockwise to seal. Do not store with the blades attached.

CARE & MAINTENANCE

CLEANING

- 1 Separate all parts.
- 2 Wash all containers in warm, soapy water with a soft cloth.
- 3 **Hand-Washing**
Wash cups, lids and blade assembly in warm, soapy water. Use a dishwashing utensil with a handle to avoid direct contact with the blades. Exercise care when handling the blade assembly as the blades are sharp. Thoroughly rinse and air-dry all parts.

Dishwasher

Cups, lids, and blade assembly are dishwasher safe. Place the cups, lids, and blade assembly on the top rack of the dishwasher **ONLY**. Ensure the blade assembly and lid are removed from the cup before placing in the dishwasher.

Motor Base

Turn off the unit and unplug the motor base before cleaning. Wipe motor base with a clean, damp cloth.

NEVER directly spray the base with water or other liquids.

DO NOT use abrasive cloths/pads/brushes to clean the base, as this can dull or scratch the surface.

RESETTING THE MOTOR THERMOSTAT

This unit features a unique safety system that prevents damage to the motor and drive system should you inadvertently overload it. If the unit is overloaded, the motor will be temporarily disabled. Should this occur, follow the reset procedure below.

- 1 Unplug the unit from the socket.
- 2 Allow the unit to cool for approximately 30 minutes.
- 3 Remove the container's lid and blade assembly. Empty the container and ensure no ingredients are jamming the blade assemblies.

IMPORTANT: Ensure that maximum capacities are not exceeded. This is the most typical cause of appliance overload.

TROUBLESHOOTING GUIDE

WARNING: To reduce the risk of shock and unintended operation, turn power off and unplug unit before troubleshooting.

Motor doesn't start or blade assembly doesn't rotate

- Make sure the cup is securely placed onto the motor base.
- Check that the plug is securely inserted into the socket.
- Check fuse or breaker in your home. Replace the fuse/reset breaker.
- Check that the inside of the motor base is clean and there is no food blocking the connection between the motor base and the cup.
- There is too much food in the container. Unplug the motor base. Remove some food and try again.
- The unit has overheated. Unplug and wait approximately 30 minutes before using again.

Food collects on the sides of the cup

- Too much food is being processed at one time. Turn the motor base off. When the blades stop rotating, remove the cup from the motor base. Remove some of the food being processed.

Snow from ice cannot be achieved

- Do not use ice that has been sitting out or has started to melt.
- Be sure to use short pulses in the beginning to break up large pieces.

VISIT US ONLINE AT:

ninjakitchen.co.uk

Or follow us on any of our social media pages:



@ninjakitchenuk



NOTE: Save these instructions. Keep for future reference.



This marking indicates that this product should not be disposed of with other household wastes. To prevent possible harm to the environment or human health from uncontrolled waste disposal, recycle it responsibly to promote the sustainable reuse of material sources. To return your used device, please use the return and collection systems or contact the retailer where this product was purchased. They can take this product for environmentally safe recycling.

SharkNinja Europe Limited
3150 Century Way
Thorpe Park
Leeds
LS15 8ZB
UK
ninjakitchen.co.uk

SharkNinja Germany GmbH,
c/o Regus Management GmbH
Excellent Business Center 10
+11/Stock Westhafenplatz 1
60327 Frankfurt am Main,
Germany

Illustrations may differ from actual product. We are constantly striving to improve our products; therefore the specifications contained herein are subject to change without notice.

NINJA and PRO EXTRACTOR BLADES are registered trademarks of SharkNinja Operating LLC.

© 2021 SharkNinja Operating LLC.

QB3001UKS_30_IB_MP_210628_Mv1
PRINTED IN CHINA

