

DRAWER SLIDES: If it becomes necessary to remove drawers, follow these drawer removal instructions:

A) Pull drawer all the way out, then push back a fraction of an inch.

B) Insert a screwdriver into slot in the slide and push in on the stop until it clears the lance. Repeat the procedure on the other slide and remove drawer.

C) To re-install drawer, pry stop far enough out to engage lances(3/16" to 1/4") and push drawer onto slide until stops engage lances.

8 Drawer Chest & Cabinet

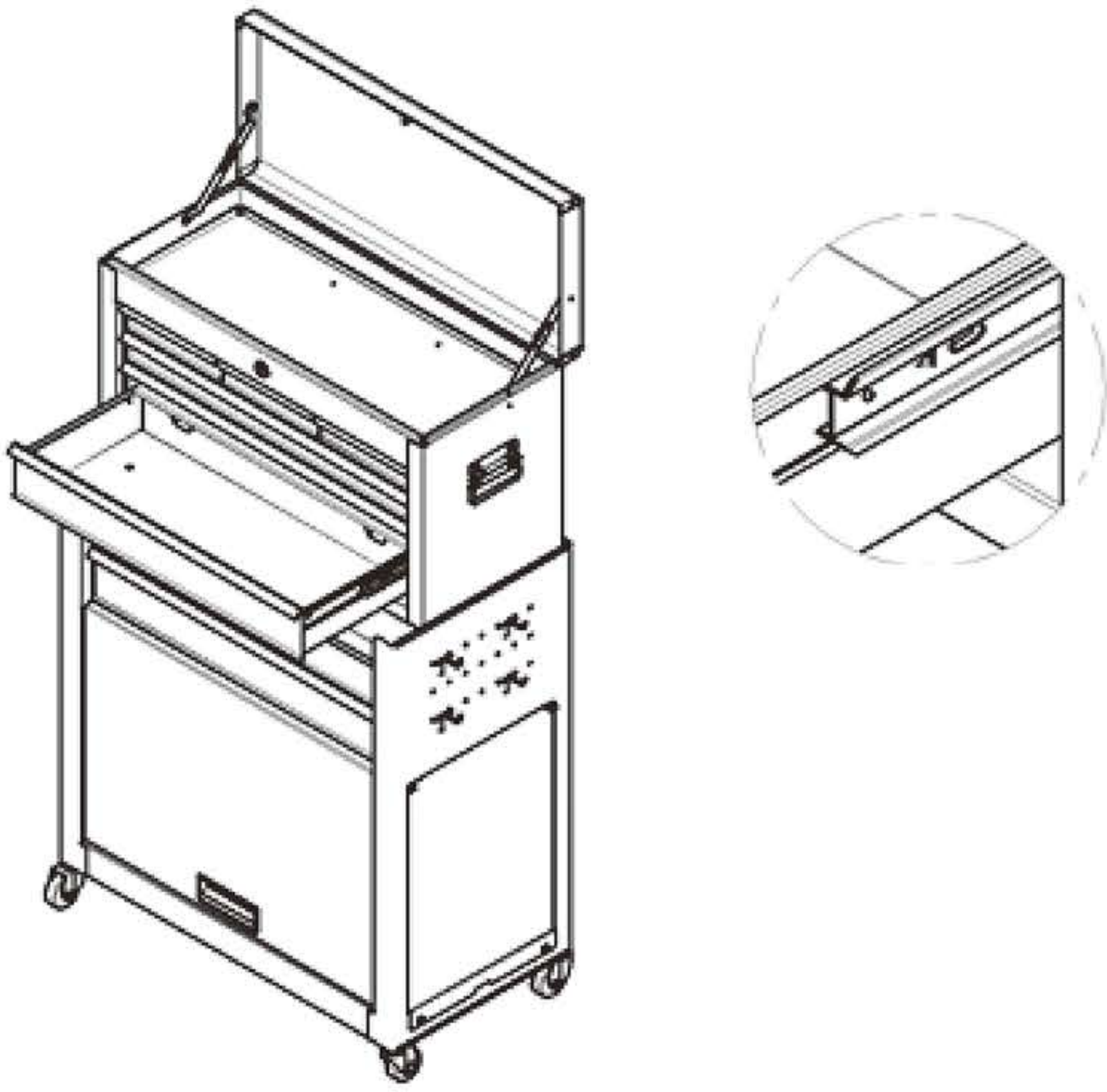
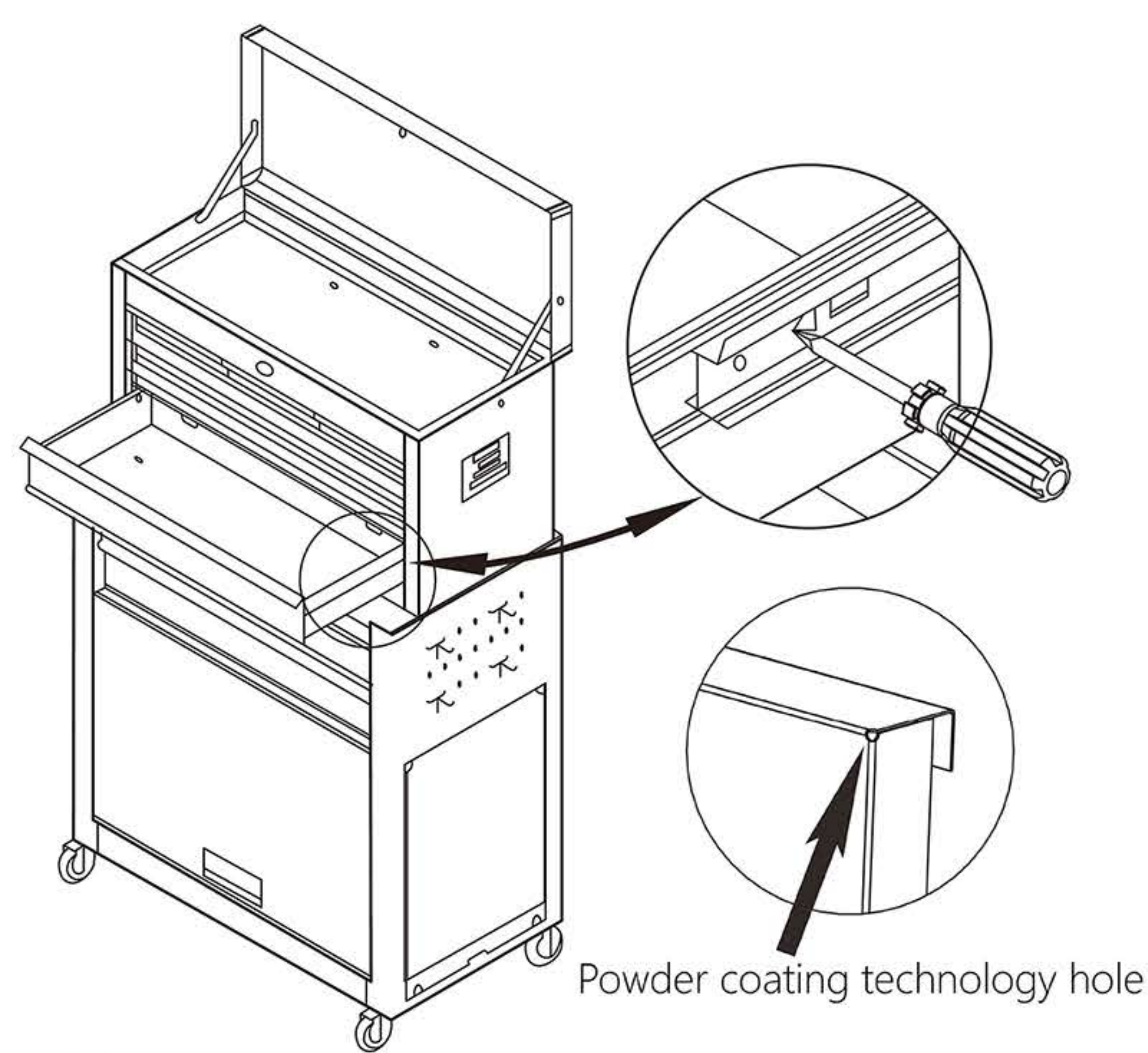

WARNING

A) Lubricate the top and the bottom channels of the drawer slides at least twice a year.

B) Do not open more than one loaded drawer at a time.

C) The maximum loading capacity is 70kgs (154lbs).

6

1



Parts	No.	QTY.
	1	1
	2	1
	3	4
	4	4
	5	2
	6	4
	7	4
	8	2
	9	1

Note: parts of NO.5 and NO.6 have been assembled on tool cart.

2

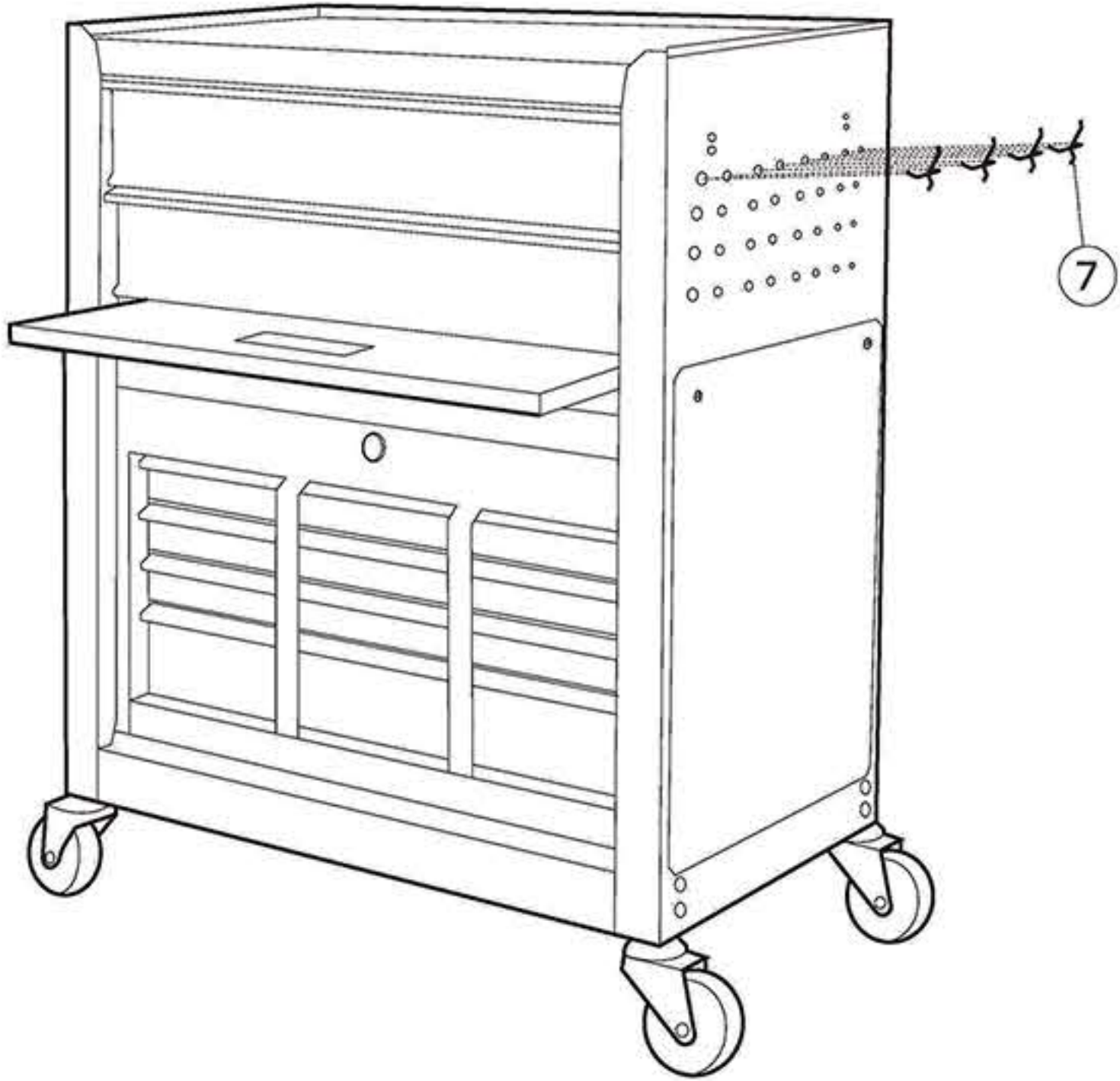

5