

ASSEMBLY INSTRUCTIONS

SIDE TABLE

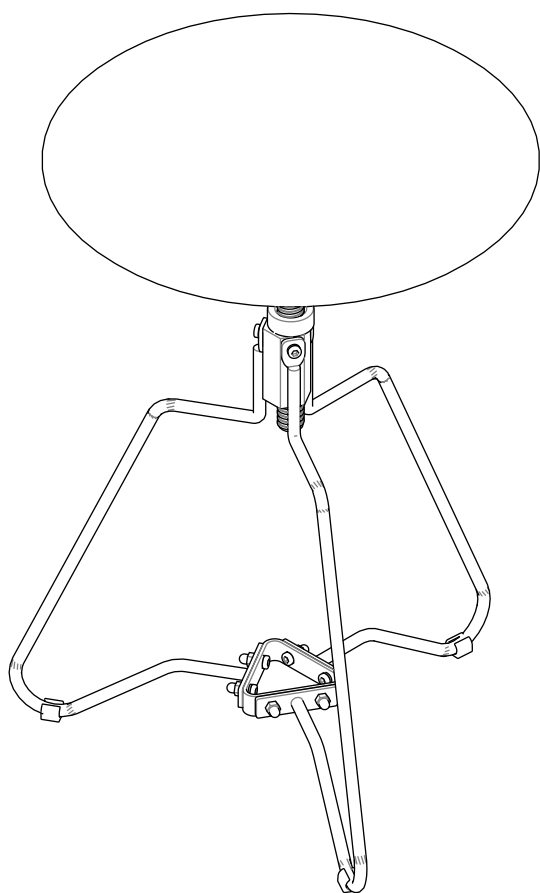

SIDE TABLE

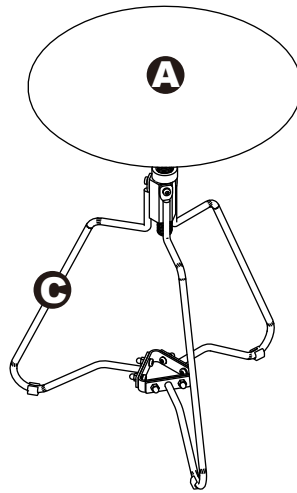

DIMENSIONS

Width - 31.5"
Depth - 31.5"
Height - 16.73"

PARTS LIST

A X1

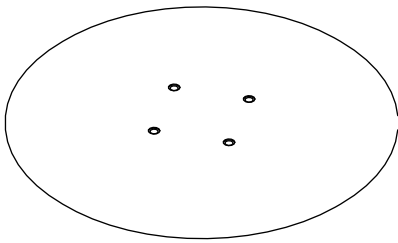

D X1

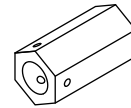

B X1

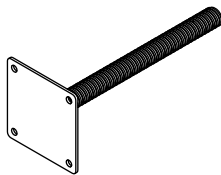

E X1



C X3

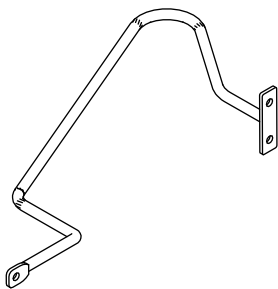

F X1

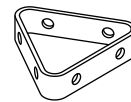

HARDWARE LIST

1 X3



2 X10

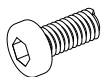

3 X13



(four for spare)

4 X6



5 X3



6 X1



ASSEMBLY INSTRUCTIONS

Step 1.

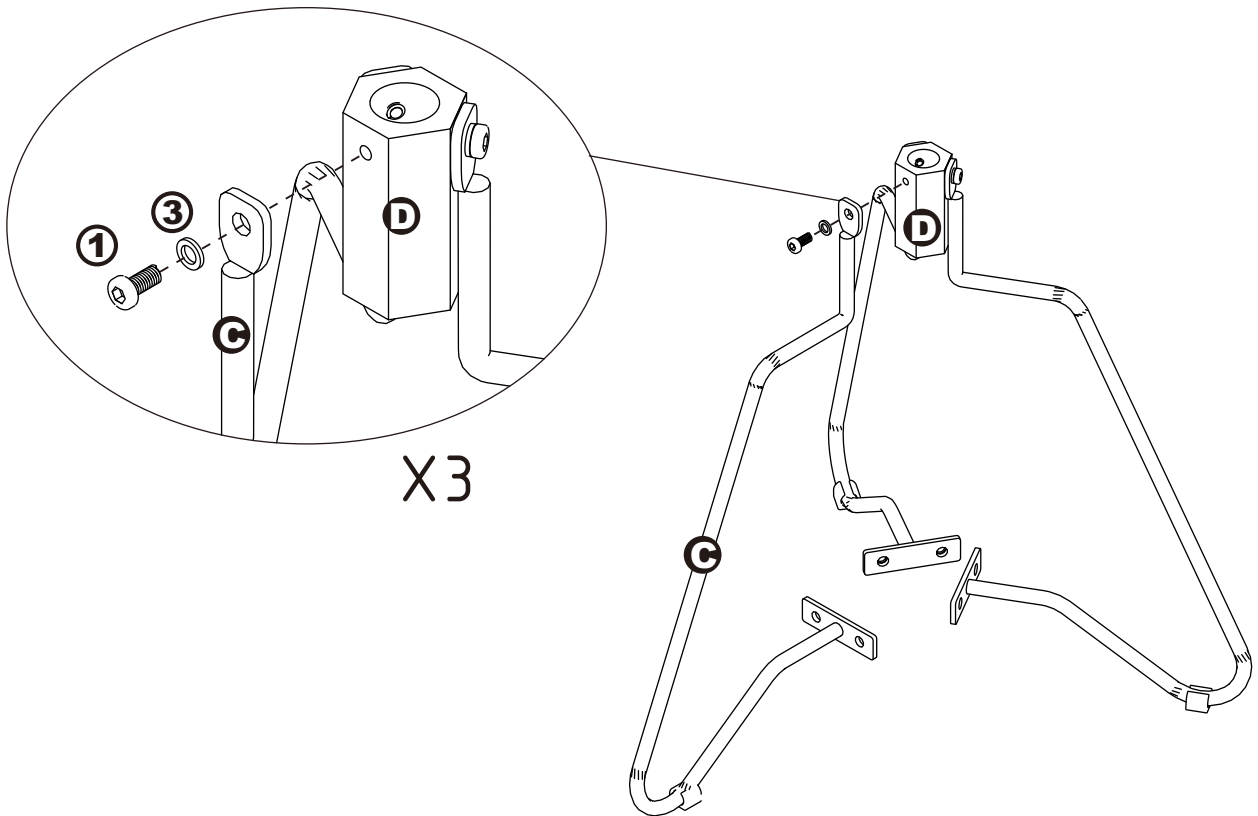
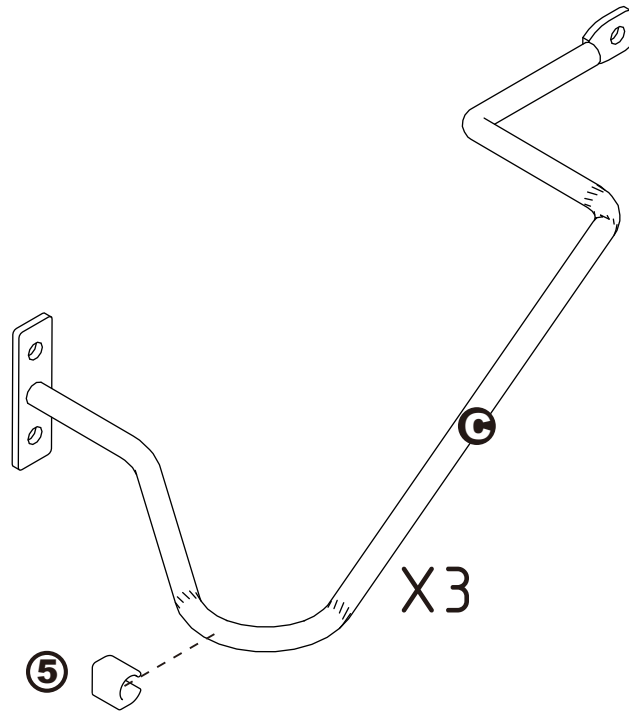

ASSEMBLY INSTRUCTIONS

Step 2.

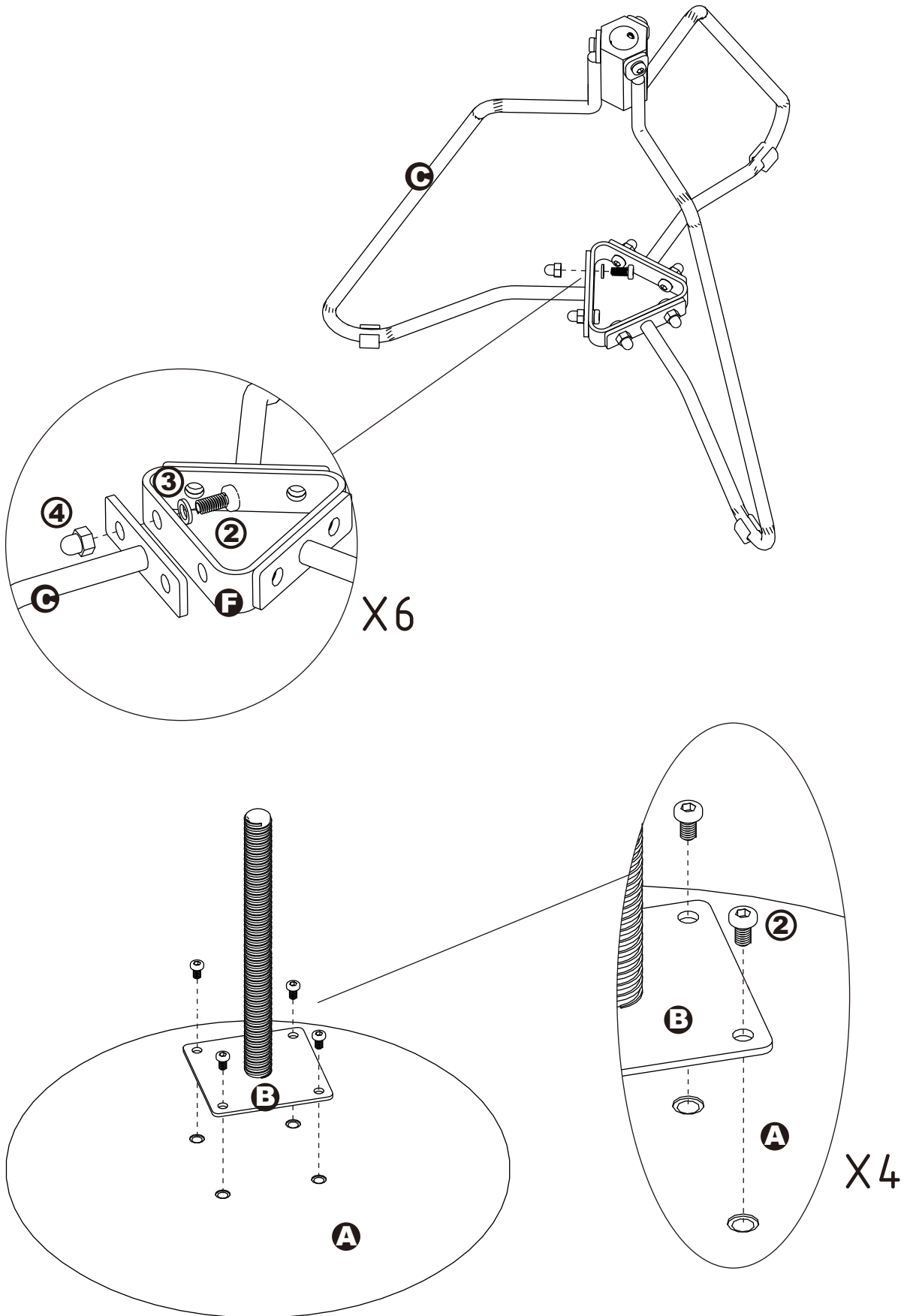

ASSEMBLY INSTRUCTIONS

Step 3.

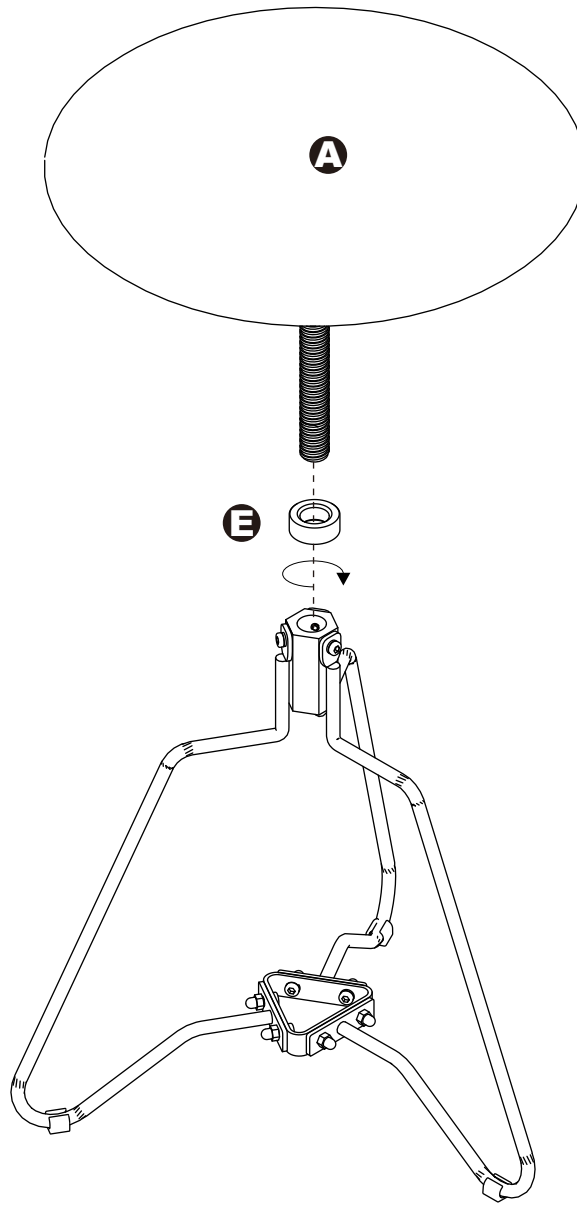

ASSEMBLY IS COMPLETED

Make sure the product is rested on a flat surface and does not feel loose or wobbly. If it does, double check that the bolts/screws are secured and properly tightened.