

# ADJUSTABLE STEEL GANTRY CRANE - KNOCKDOWN - AHSN-2-10-16

APPROX WEIGHT: 970.21 lbs.  
DOES NOT INCLUDE WEIGHT OF POWER OR PACKAGING!!!

\*\*\* ANY ADDITIONS, DELETIONS, OR OMISSIONS MUST BE CORRECTED ON THIS DRAWING AS THIS DRAWING WILL BE CONSIDERED ALL INCLUSIVE \*\*\*

ALL GRAPHICS PROVIDED ARE FOR REFERENCE ONLY. IF CERTAIN DIMENSIONS ARE CRITICAL PLEASE VERIFY THOSE DIMENSIONS WITH YOUR SALESPERSON

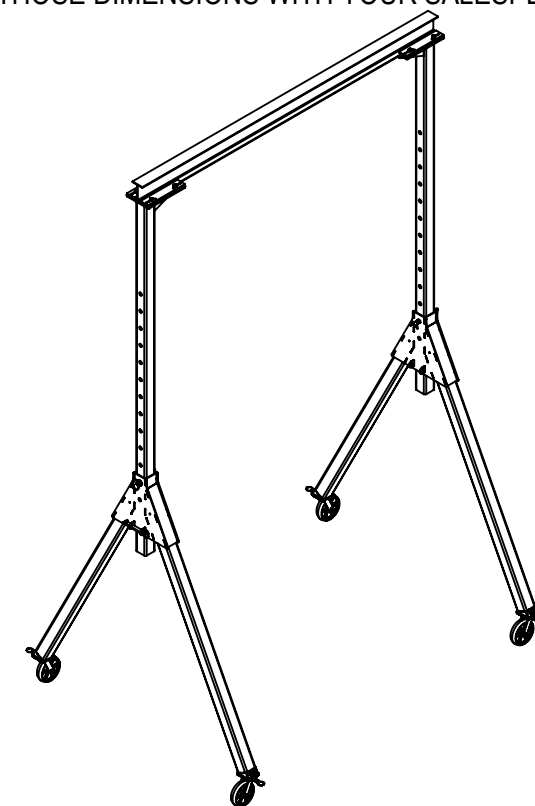
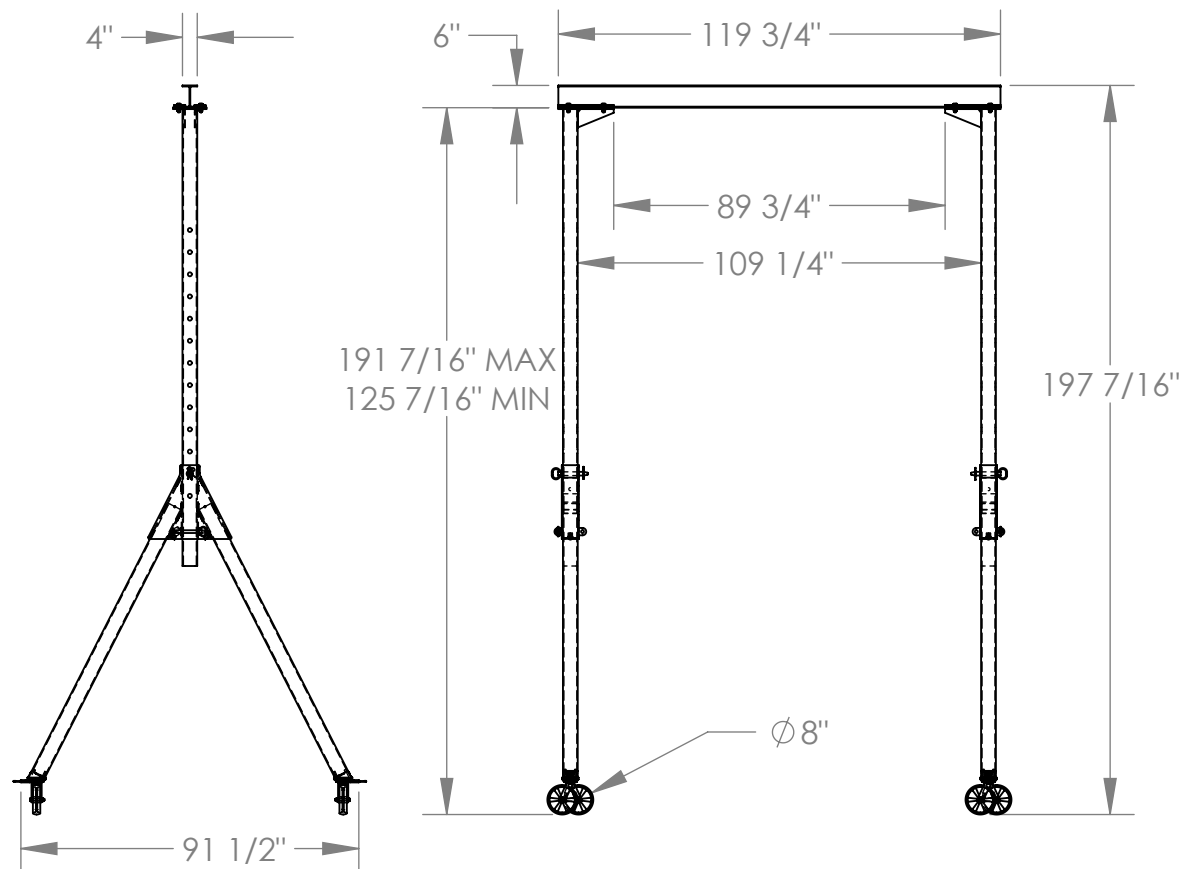

3D VIEW FOR REFERENCE ONLY

DIMENSION TOLERANCE  $\pm 1/4"$

## STANDARD FEATURES

MODEL NUMBER IS AHSN-2-10-16  
CAPACITY IS 2,000 LBS.  
BASE WIDTH IS 91 1/2"  
MAX OVERALL HEIGHT IS 197 7/16"  
I-BEAM HEIGHT IS 6"  
I-BEAM FLANGE WIDTH IS 4"  
OVERALL I-BEAM LENGTH IS 119 3/4"  
USABLE I-BEAM LENGTH IS 89 3/4"  
ADJUSTABLE UNDER I-BEAM HEIGHT  
191 7/16" MAX  
125 7/16" MIN  
HEIGHT IS ADJUSTABLE IN 6" INCREMENTS  
CASTERS: (4) Ø8" X 2" WIDE GLASS FILLED  
NYLON SWIVEL CASTERS WITH FOUR  
LOCKING POSITIONS

## SPECIAL FEATURES

NONE

APPROVAL

I, THE UNDERSIGNED, AGREE THAT THE PRODUCT AS REPRESENTED SATISFIES DESIGN AND DIMENSION REQUIREMENTS. I ALSO ACKNOWLEDGE MY DUTY TO CONFIRM PRODUCT AND INSTALLATION COMPLIANCE WITH ALL APPLICABLE FEDERAL, STATE AND LOCAL REGULATIONS AND STANDARDS.

**ANY MODIFIED UNITS ARE NON-RETURNABLE**

[ ] As drawn [ ] As marked

Signed: \_\_\_\_\_ Date: \_\_\_\_\_

Printed Name: \_\_\_\_\_

LEAD TIME WILL START UPON RECEIPT OF SIGNED APPROVAL DRAWING

FOR INTERNAL USE ONLY  
PROJECT SIGN OFF

SALES	
ENG.	
FAB.	
POWER	

DISTRIBUTOR'S NAME:

VESTIL MANUFACTURING

DRAWN BY: DLS

DATE: 06/30/14

REFERENCE: X

SCALE: 1:52

QUOTED LEAD TIME: X

QUOTE # X

P.O.# X

W.O.# X

SALES: X

FILE NAME:

28-007-300