

Features

- Micro dual mount installation. Sink can be installed under counter mounted or top mounted where the rim of the sink sits on the counter top. Sink has a thin 2mm edge when installed as top mount.
- 15" (381) x 17" (432) x 10" (254) kitchen sink.
- Single compartment.
- Handcrafted from 16 gauge 304 stainless steel. Channel grooves in sink bottom direct water to drain. Premium brushed finish.
- Includes a stainless steel bottom sink grid and stainless covered flip-top sink strainer.
- 10mm radius corners.
- 5mm sound deadening pads.
- Fits 18" (457) minimum base cabinet width.

Components

- Product includes:
 TSGD15171 Bottom Sink Grid (see back)
 2210R Covered Sink Strainer
 Cutout Template
 Installation Hardware
 Installation Instructions

Warranty

- Lifetime Limited Warranty



Specified Model

Model	DTSB151710
Overall Dimensions	L15" x W17" x D10" 381 x 432 x 254
Bowl Dimensions	L12 ¹¹ / ₁₆ " x W11 ¹⁵ / ₁₆ " x D10" 322 x 303 x 254
Drain hole:	3 ⁵ / ₈ " (92mm)
Shipping Weight	20 lbs.
Material	16 gauge 304 stainless steel
Installation	top or under counter mounted
Required	template, included

To Be Specified:

see back for configurations available for this sink

Faucet Hole Drillings	
<input type="checkbox"/>	1 Hole
<input type="checkbox"/>	3 Holes

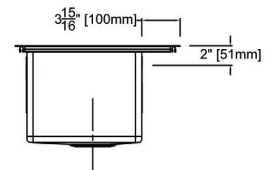
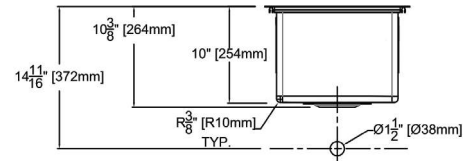
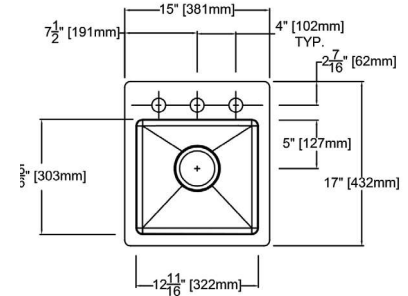

Codes/Standards

ASME A112.19.3/CSA B45.4

Notes

Install this product according to the installation instructions.

Faucet Hole Configurations available for this sink model

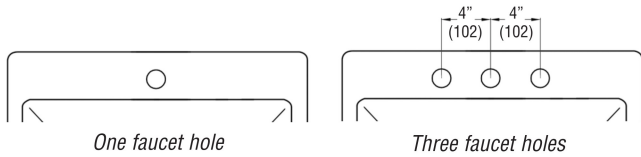

Components

Product includes:

TSGD15171 Bottom Sink Grid

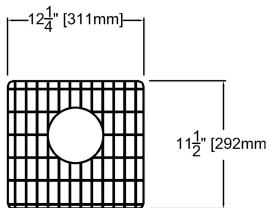

2210R Covered Flip Top Sink Strainer.

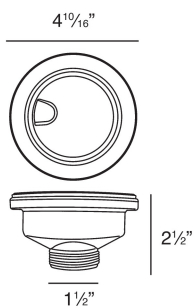

Water drains easily when cover is in place. Cover flips up with easy touch. Polypropylene housing. Fits standard 3 ¹/₂" opening.

Optional 2310 Remote Covered Flip Top Sink Strainer is available.

Optional 4010 Covered Flip Top Disposer Strainer is available.

See Accessories to order.