

INSTALLATION GUIDE

LED Linear Suspended Down Light

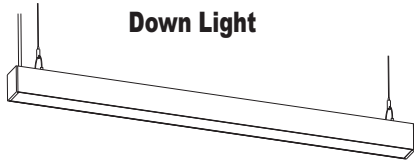

LD Series Accessories Joint Part- L Shape/ T Shape/ CROSS Shape

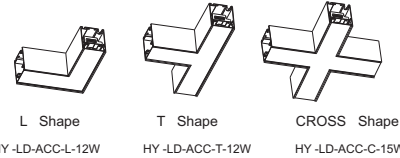

L Shape HY-LD-ACC-L-12W
T Shape HY-LD-ACC-T-12W
CROSS Shape HY-LD-ACC-C-15W

Note: This accessory needs to be purchased separately

Please take the time to read this installation guide carefully. The guide contains important information and notes regarding installation and operation.

Product Specifications

Model No.	Input Vac	Wattage	C.C.T	PF	THD	CRI	Lifespan
HY -2FT-LD-25W-3CCT	120-277	25W	3000K/4000K/5000K	>0.9	<10%	>80	5 Year
HY -4FT-LD-50W-XXK	120-277	50W	3000K/4000K/5000K	>0.9	<10%	>80	5 Year
HY -8FT-LD-100W-3CCT	120-277	100W	3000K/4000K/5000K	>0.9	<10%	>80	5 Year
HY -LD-ACC-L-12W-CCT	120-277	12W	3000K/4000K/5000K	>0.9	<10%	>80	5 Year
HY -LD-ACC-T-12W-CCT	120-277	12W	3000K/4000K/5000K	>0.9	<10%	>80	5 Year
HY -LD-ACC-C-15W-CCT	120-277	15W	3000K/4000K/5000K	>0.9	<10%	>80	5 Year

Product Dimensions

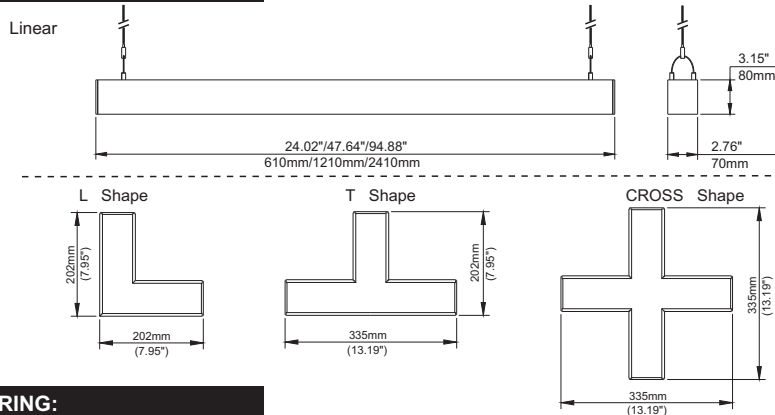

WARNING:

- This product must be installed in accordance with the applicable installation code by a person familiar with the construction and operation of the product and hazards involved
- Risk of fire or electric shock. LED lamp installation requires knowledge of luminaries electrical systems. If not qualified, do not attempt installation. Contact a qualified electrician.
- Use in Damp.
- This lamp supports dimming function, must use with dimmers.
- Small noises when shaking does not affect the quality.



Accessories bag includes:

Suspension Kit and Canopy

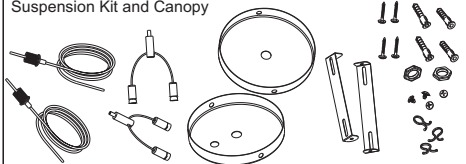

Connection Plate and tool

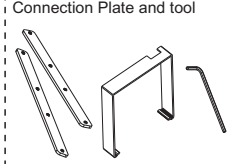

Sold Separately

Wall Mount Clip

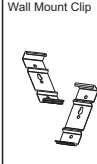

Surface Mount Clip

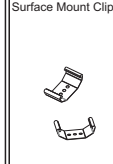

(Linear) Installation Instruction

Choose the following three installation methods as needed

A Suspension installation

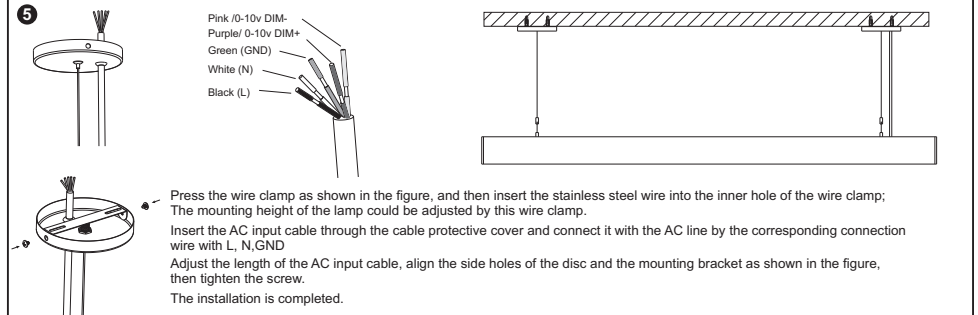
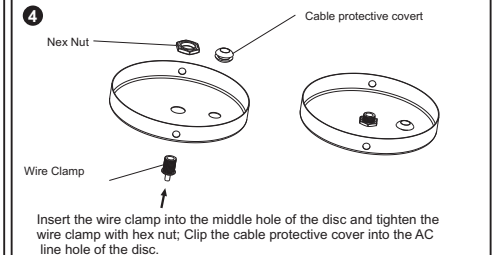
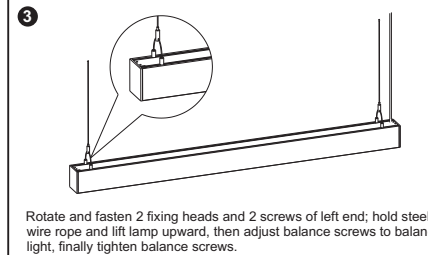
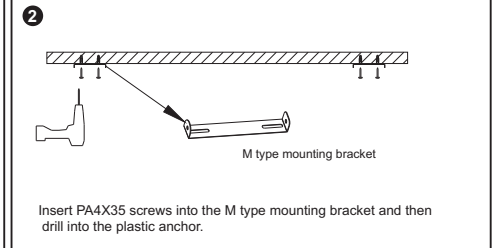
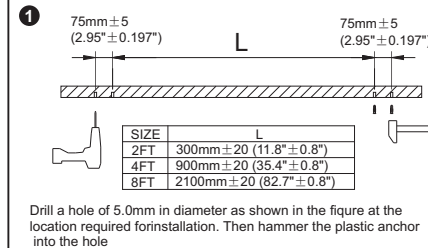

B Surface mount installation

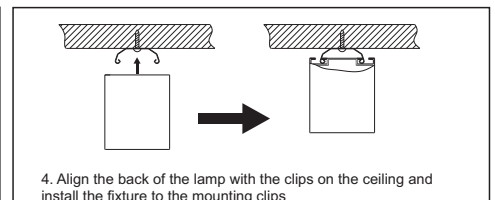
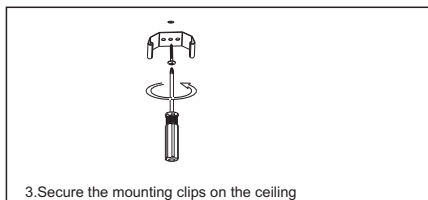
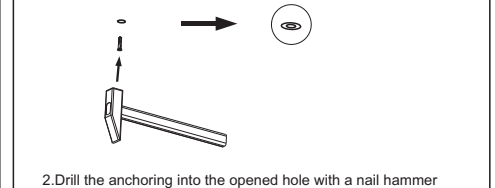
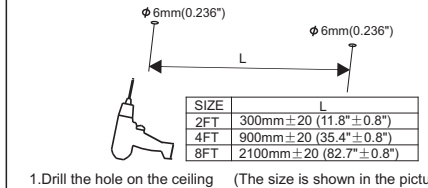

C Wall mounted installation

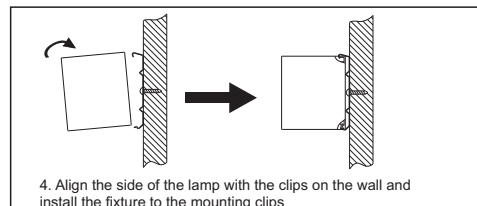
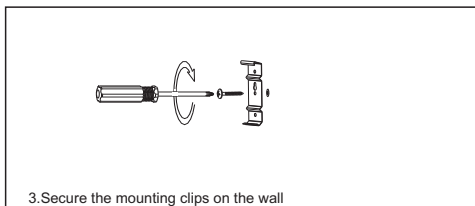
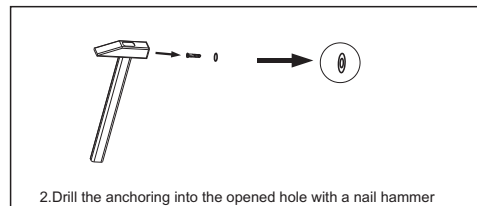
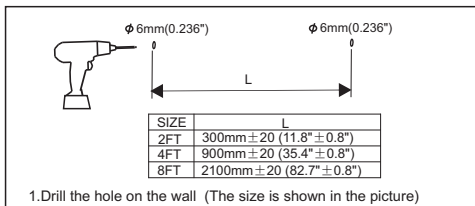

CCT Adjustable

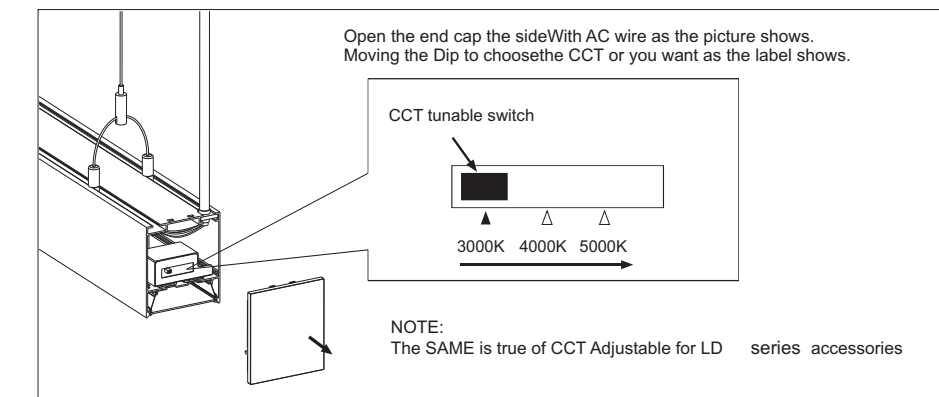

Connection Installation

Please find the connector in the accessories bag.

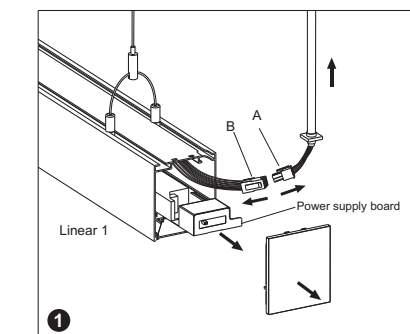

Install the Linear 1 to the ceiling as instruction of Suspension Installation. Open the end cap as the picture shows. Pull out 1/2 Power supply board of Linear1, and move out the AC wires. Disconnect the A and B parts.

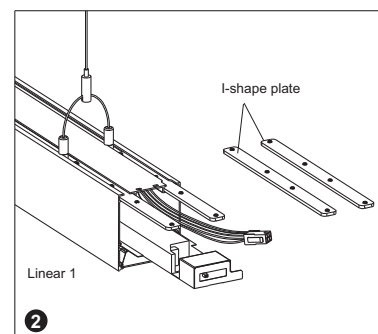

Insert the I-shape plate to the track as the picture shows.

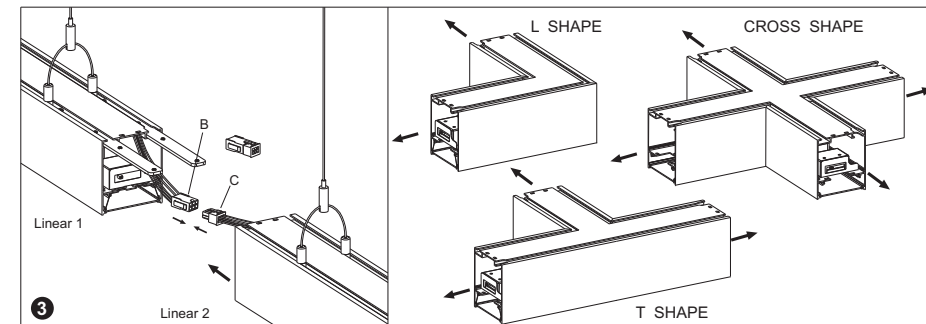

Install the Linear 2 (or L shape, T shape, CROSS shape combination connection fittings) to the ceiling and open the end cap, connect B and C as the picture shows.

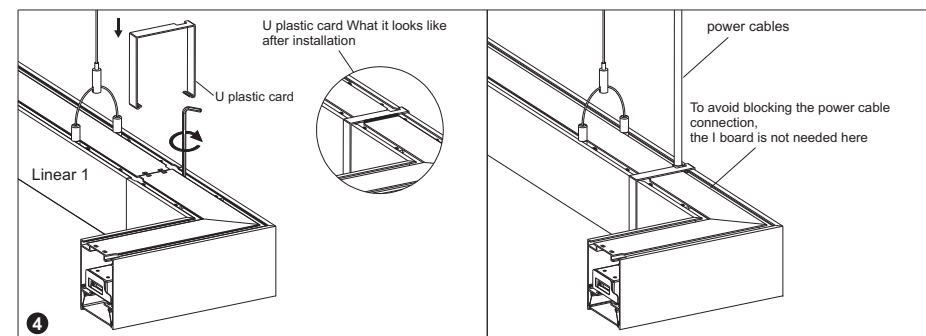

Push back Power Supply Board to Linear 1 then insert the I-shape plate to Linear 2 (or L shape, T shape, CROSS shape Combination connection fittings), tighten the I-shape plate with 8 pcs screws. Finally, the U plastic card is buckled at the joint to make the lamps and lanterns more beautiful

Install the Linear Light as above method, keep one main input cord on one side.

NOTE: LED LINEAR CAN BE JOINED TOGETHER AS NEEDED, BUT THE TOTAL NUMBER OF FIXTURES SHOULD BE NOT MORE THAN 7PCS (INCLUDING 7PCS) If you order to use 18# cord, More Links can be Customized.

Examples of product portfolio shapes

