

# Assembly Manual

## Electric Height Adjustable Desk

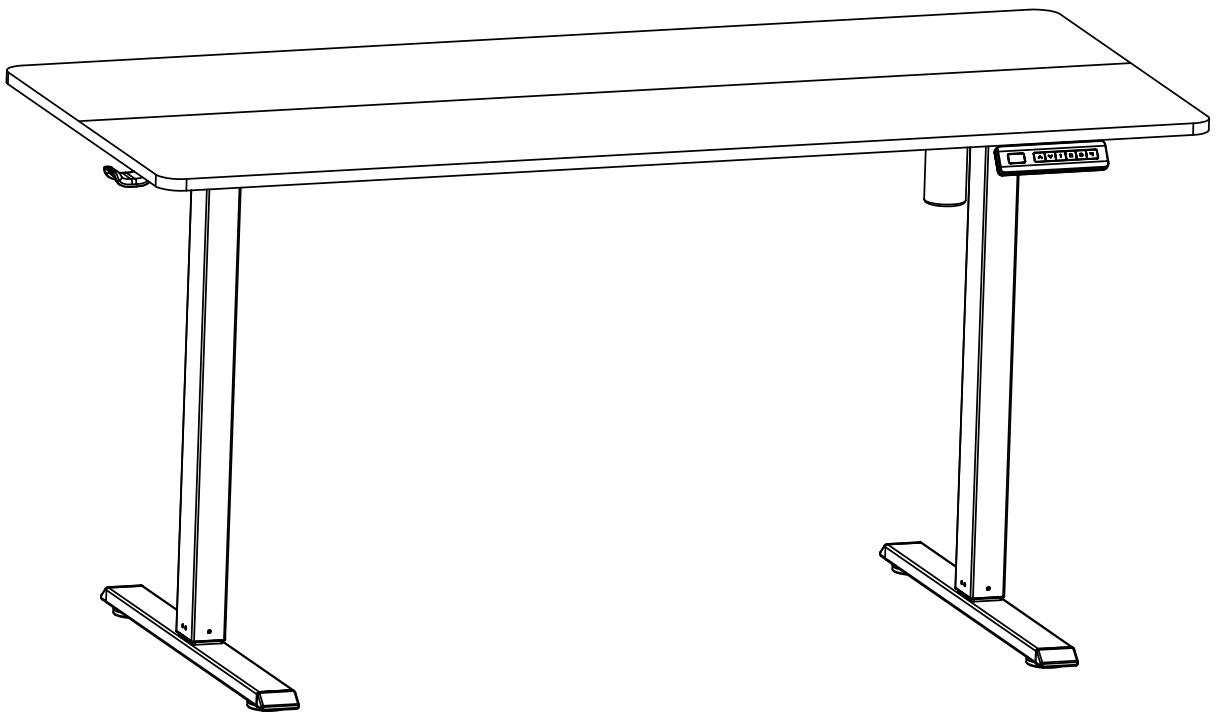

Please read this manual carefully before any operation and keep it properly for future use.

## Warnings



Keep children, pets, etc. away from the product during table lifting operation. Unplug the product in lightning weather and when it will be unused for a long time.



Keep proper distance between the table and the wall.



Keep obstacles away in the running process of the table, and there should be no obstacles higher than 500mm under the table.



Better keep environment temperature 0-40°C, the product is far away from corrosive gases, liquids and dusty objects.



To avoid malfunction and harm to human body, it is strictly prohibited to disassemble the product without instruction.



Please read the operation instructions carefully before using the product. Sunon does not assume any responsibility for the damage of the product or human injury caused by abnormal operation.



Reset manually after first use or power off.

# Components list

30 min

Assembly Time

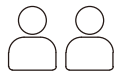

Two People

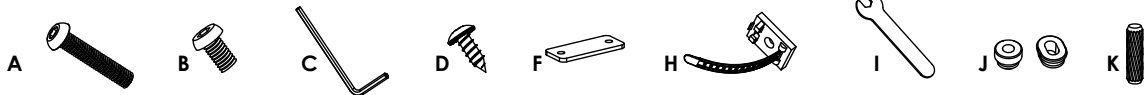
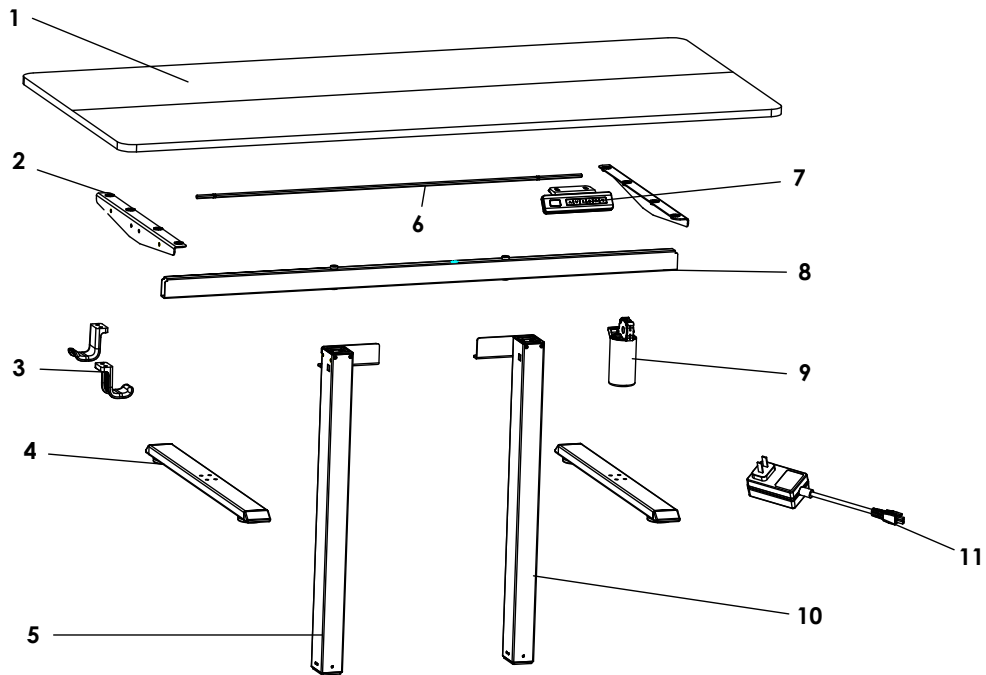

No.	Component	PCS
1	Desktop	1
2	Side bar	2
3	Hook	2
4	Foot	2
5	Right lift column	1
6	Drive rod	1
7	Controller	1
8	Frame	1
9	Motor	1
10	Left lift column	1
11	Adapter	1

No.	Component	PCS
A	Bolt(M6*30)	8+1
B	Bolt(M6*10)	10+1
C	Allen wrench(M4)	1
D	Screw(ST5*14)	22+5
F	Connector	3+1
H	Cable clip	2+2
I	Wrench	1
J	Rubber pad	0+2
K	Wooden dowel	4+0

Note: The number after "+" sign indicates the extra piece(s).

# Assembly Instruction

## STEP 1

Align drive rod **6** with the hexagonal hole of the mechanism **9**, and insert through the mechanism.

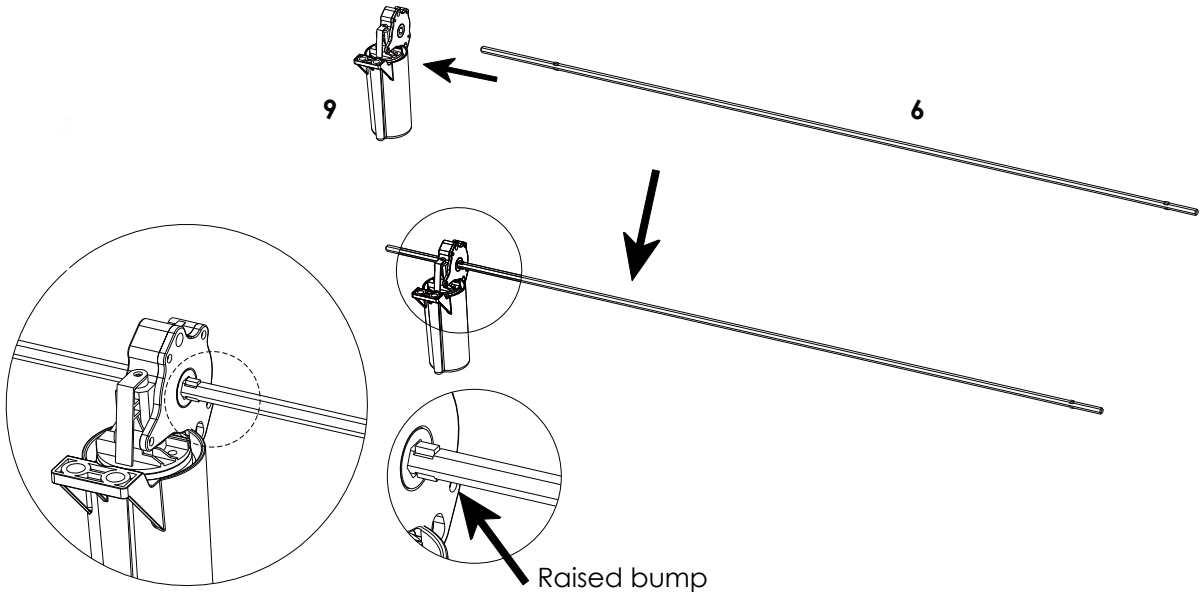

## STEP 2

Align the plastic part holes on the mechanism with the left-upper welding block holes of left column **10**, while inserting drive rod **6** into the left column. Use Allen wrench **C** and bolts **B** to tighten.

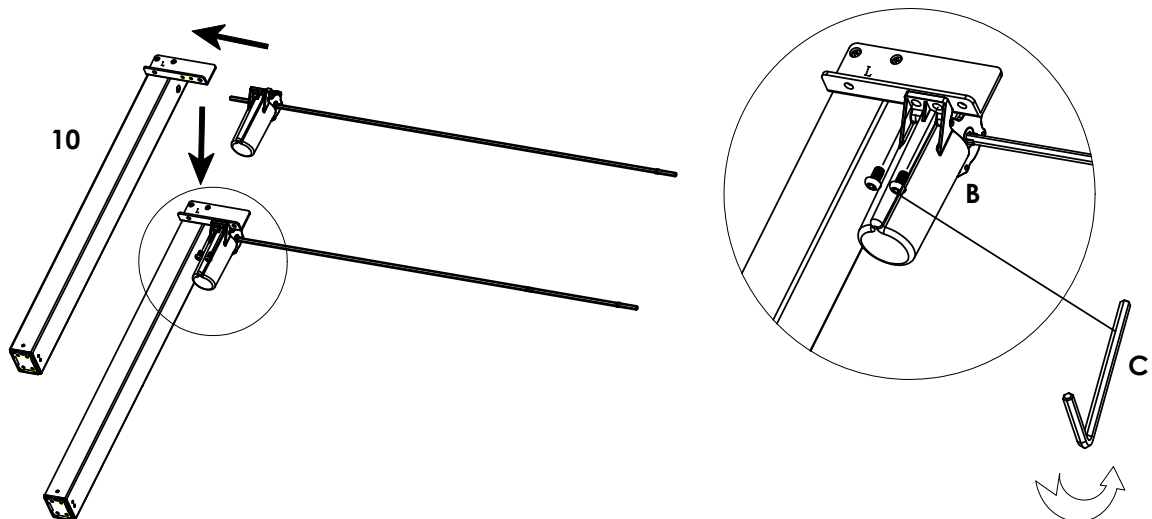

## Assembly Instruction

### STEP 3

Align the right side of right column 5 with the hexagonal drive rod and insert it through the column. During alignment, rotate the hexagonal drive rod with the wrench 1 for adjustment if needed.

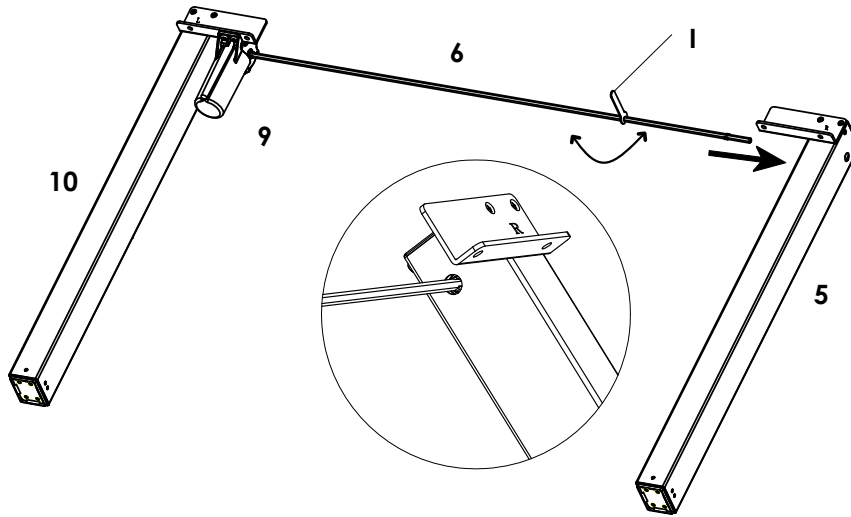

### STEP 4

Align Frame 8 with the pre-assembled column's welding block holes, and use Allen wrench C with bolts B to secure Frame to Column.

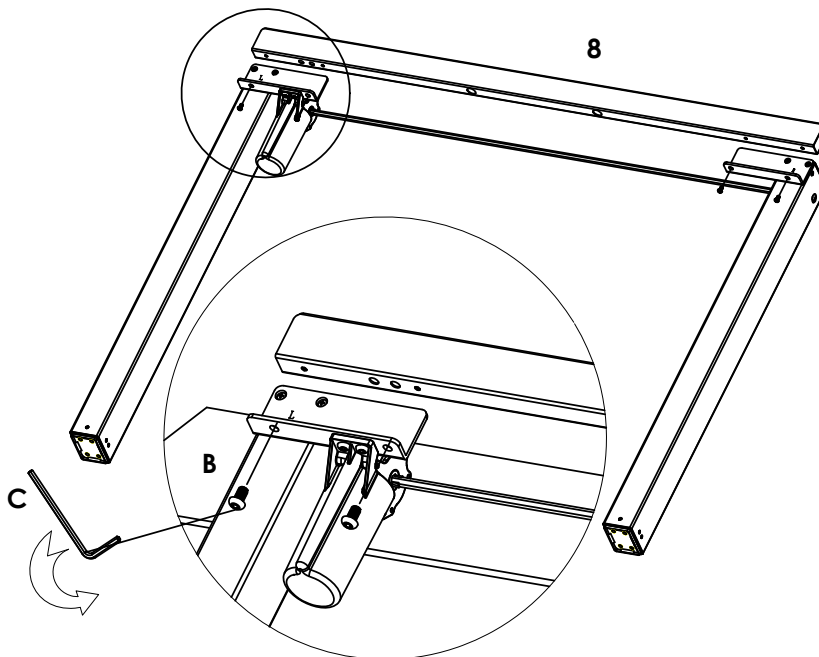

## Assembly Instruction

### STEP 5

Place a carpet or soft pad on the ground in case any scratches before assembly. Invert the frame onto carpet. Take out feet ④ and align with column end holes. Use Allen wrench ③ and bolts (M6\*30) ① to tighten column to feet.

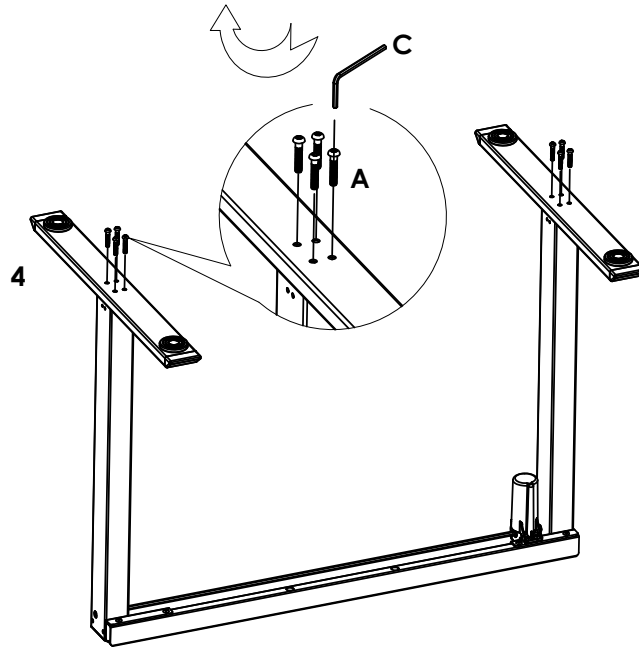

### STEP 6

Align side bars 2 with column holes, and use Allen wrench ③ with bolts ② to secure side bars to column.

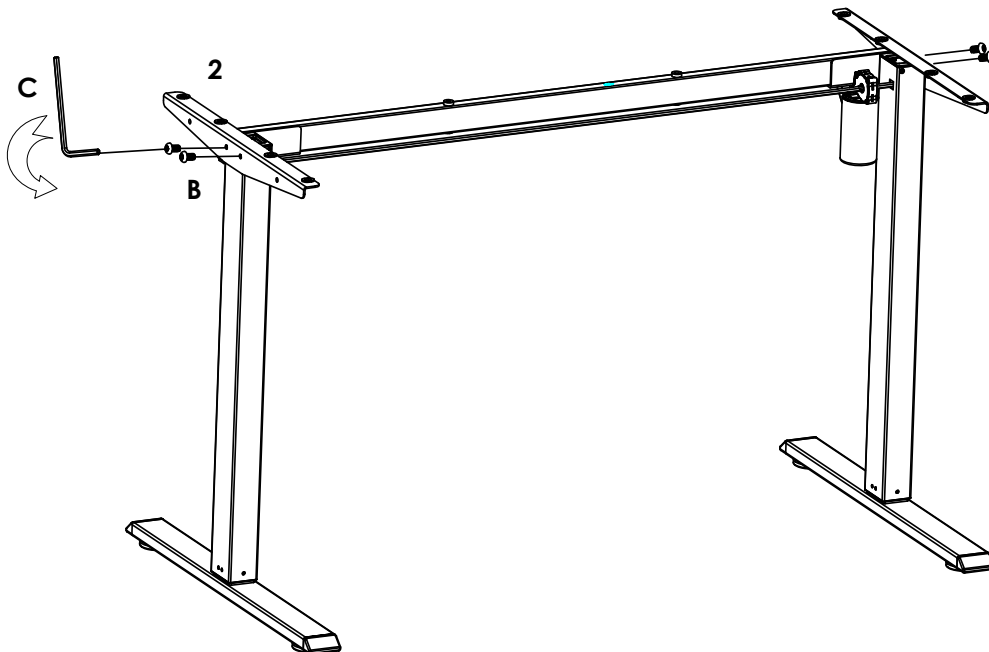

## Assembly Instruction

### STEP 7

Join the two tabletop boards using the provided wooden dowels. Insert the dowels into the pre-drilled holes on one board, then align and press the second board onto the dowels, ensuring proper orientation (front/back)

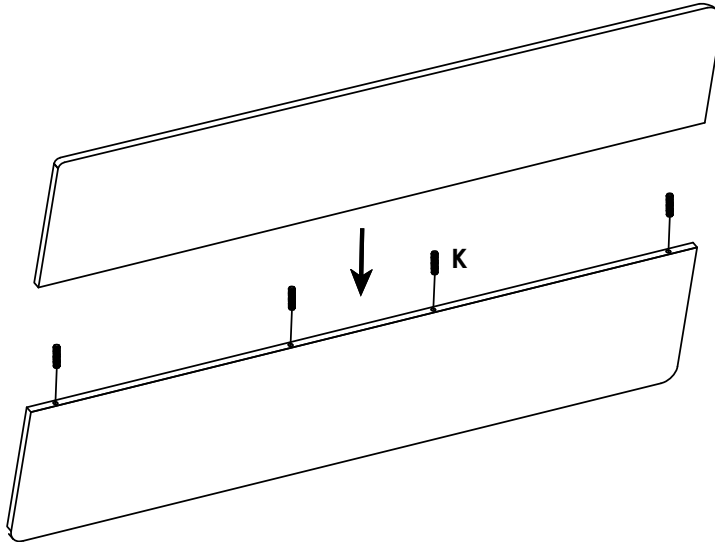

### STEP 8

Place the assembled tabletop horizontally. Use screw **D** (ST5\*14) to tighten the frame connector **F**, the hook **3**, and the tabletop.

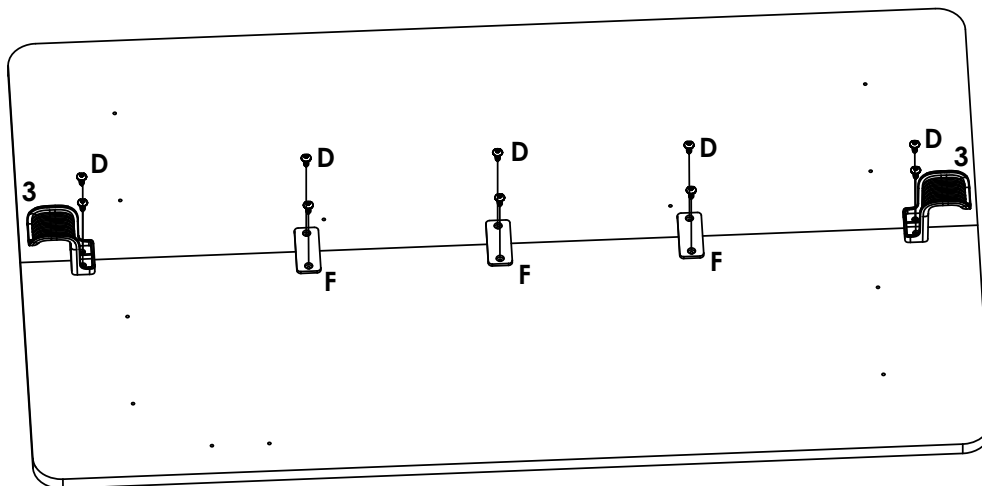

## Assembly Instruction

### STEP 9

Place the assembled tabletop and the hand controller ⑦ horizontally. Align according to the holes on the panel and place the assembled frame on the panel. Then use self-tapping screws to fix the frame and the hand controller onto the panel.

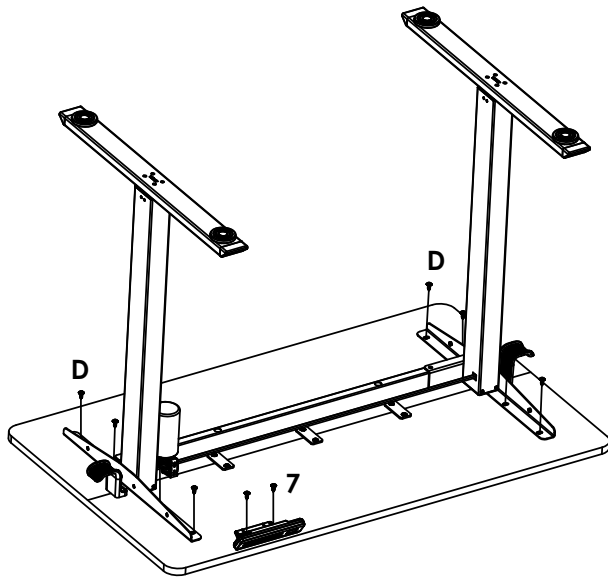

### STEP 10

Insert wall adapter plug and motor plug into controller ⑦ as picture shown. Arrange wires using cable clips fixed to the desk-top. (Note: Ensure power cord length provides sufficient lifting range for normal frame operation)

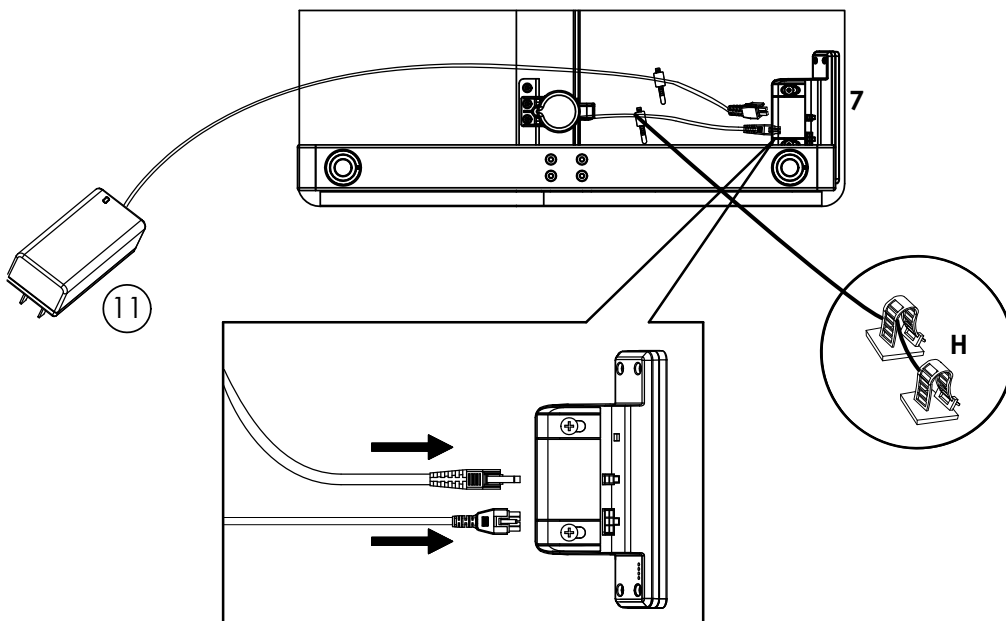

## Assembly Instruction

### STEP 11

Flip the table frame over, switch on, and perform controller reset procedure for normal operation. The assembly is done. See the detailed steps for reset on the next page.

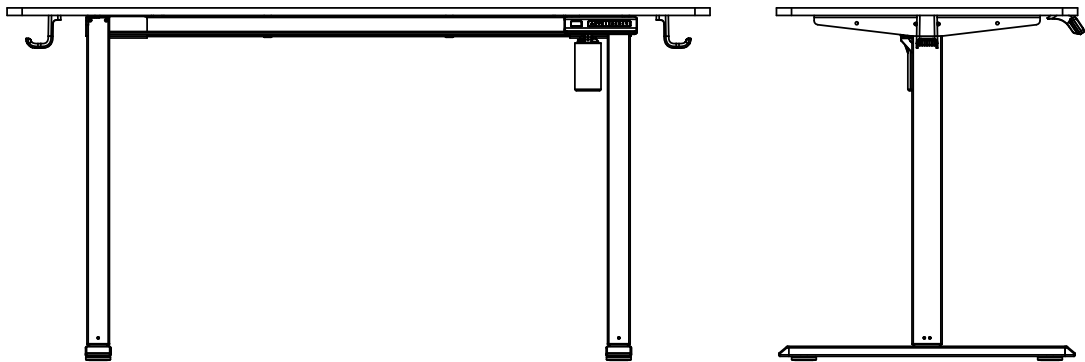
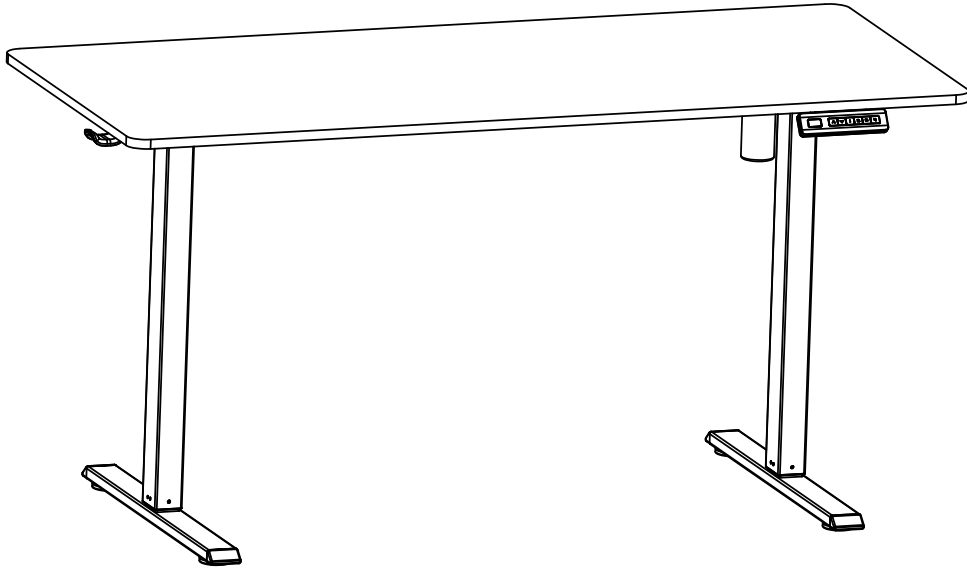

**THE LIFTING TABLE DIAGRAM**

# Function Instruction

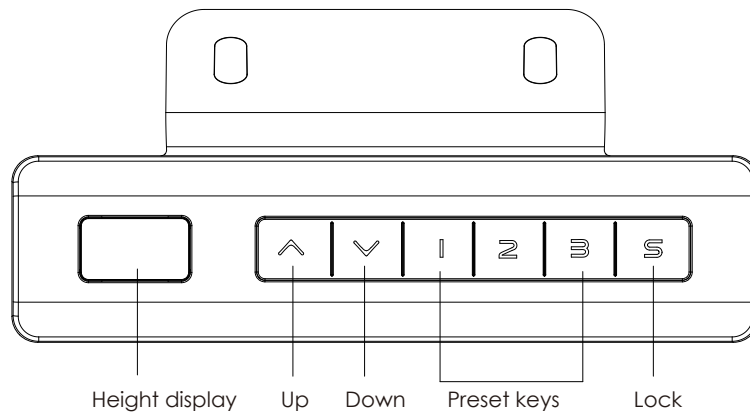

## 1. RESET

Ensure that no obstacles exist during the table lifting, and the table is not against the wall, and wires are long enough for the table to move up and down.  
Before the first installation and use, to ensure stable use in the future, please perform a reset operation. The steps are as follows.

Preset the most comfortable sitting height as 1, and the most comfortable standing height as 2. Other digital keys can save other positions if need (Suggestion only).

## 2. Height Adjustment

Press and hold the up or down arrow key to raise or lower the table. Once reach the height you want, release the key

## 3. Memory height setting

Long press any of the digital keys(1-3) for 3 seconds ,and you'll see 3 times of digital number flashing on the display screen.Then it means current height has been preset successfully. Next time, when you press the digital key, it will automatically go to the preset height.

## 4. LOCK/UNLOCK

To lock the handset: In the normal operating mode, press and hold the "S" button (about 3 seconds) until the LED display "LOC", it means handset is locked and pressing the handset button again does not work.

To unlock the handset: In the locked state of the LED display "LOC", press and hold the "S" button (about 3 seconds) until the LED switches from "LOC" to the height display, it means handset is unlocked and pressing the handset button again does work.

## 5. UNIT SWITCH(CM/INCH)

Default unit is inch. If you want to switch to cm, press key 1 and 3 simultaneously for 3 seconds, and then you'll see the digits change. If you repeat the action above, it'll change back to inch