

Extra Large Desk Riser with Dual Monitor Mount

DESK-V048KB-M2
Assembly Manual

Need Help? We're Here For You

US-Based Customer Support from Trained Professionals

Monday-Friday from 7am-7pm CST
Saturday 8am-4pm CST



Email Us

help@vivo-us.com



Chat with Live Agent

www.vivo-us.com



Give Us a Call

309-278-5303 ext. 1



Assembly Video & Product Info

www.vivo-us.com/products/desk-v000k-m2



WARNING



If you do not understand these directions, or if you have any doubts about the safety of the installation, please contact our product support team at 309-278-5303 or help@vivo-us.com for further assistance. Check carefully to make sure there are no missing or defective parts. Failure to report missing parts within 30 days may result in denial of free replacement. Improper installation may cause damage or serious injury. Do not use this product for any purpose that is not explicitly specified in this manual. Do not exceed weight capacity. We cannot be liable for damage or injury caused by improper mounting, incorrect assembly or inappropriate use.



WARNING: CHOKING HAZARD

SMALL PARTS - NOT FOR CHILDREN UNDER 3 YEARS. ADULT SUPERVISION IS REQUIRED.



DO NOT EXCEED WEIGHT CAPACITY

NEVER PLACE EXCESSIVE FORCE ON THE RISER OR EXCEED THE STATED WEIGHT CAPACITY. FAILURE TO DO SO MAY RESULT IN SERIOUS PERSONAL INJURY AND/OR DAMAGE TO SETUP EQUIPMENT.

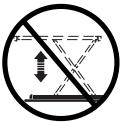

NEVER OPERATE RISER UPSIDE DOWN

NEVER ATTEMPT TO RAISE RISER WHEN UPSIDE DOWN; DOING SO MAY RESULT IN SERIOUS PERSONAL INJURY. ENSURE RISER IS RIGHT SIDE UP ON A STABLE SURFACE BEFORE ATTEMPTING ANY HEIGHT ADJUSTMENTS.



DO NOT ROUTE CABLES WITHIN SUPPORT FRAME

NEVER ROUTE CABLES WITHIN THE INNER SUPPORT FRAME OF RISER. DOING SO MAY CAUSE SERIOUS PERSONAL INJURY AND/OR DAMAGE TO SETUP EQUIPMENT.



KEEP HANDS FREE OF SUPPORT FRAME

NEVER PLACE HANDS WITHIN SUPPORT FRAME. DOING SO MAY RESULT IN SERIOUS PERSONAL INJURY.



CHECK CABLE LENGTH

TO PREVENT ACCIDENTAL DAMAGE TO DEVICES AND/OR PERSONAL INJURY, PLEASE ENSURE POWER CABLES HAVE ADEQUATE LENGTH TO ACCOMMODATE THE CHOSEN HEIGHT OF YOUR DESK RISER.



KEEP DEVICE & DESK ITEMS AWAY FROM DESK EDGE

ALWAYS KEEP LAPTOP, MONITORS, AND OTHER DESKTOP ITEMS AWAY FROM THE EDGE OF THE DESK. FAILURE TO DO SO MAY RESULT IN ACCIDENTAL DAMAGE OF DEVICE AND/OR SERIOUS PERSONAL INJURY.



USE CAUTION WHEN ADJUSTING

NEVER STAND OVER THE DESK RISER WHEN ADJUSTING THE HEIGHT. DOING SO MAY CAUSE PERSONAL INJURY TO THE FACE OR EXTREMITIES.

Package Contents

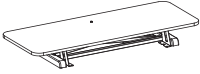

A (x1)
Desk



B (x1)
Keyboard Tray



C (x1)
Stopper



D (x3)
Pad



E (x4)
Rubber Feet



F (x2)
Cable Clip

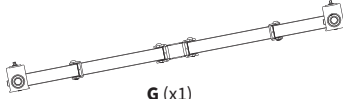

G (x1)
Swivel Arm

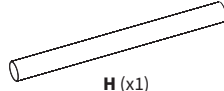

H (x1)
Pole



I (x2)
VESA Plate



J (x1)
Grommet
Plate



K (x1)
Clamp
Bolt



L (x1)
Support Plate



M (x1)
Pole Cable
Clip



N (x4)
Arm Cable
Clip



O (x1)
Pole Cap



P (x5)
Rubber Pad

Included Hardware & Tools



S-A (x2)
ST4.2x12mm Screw



S-B (x4)
M5x10mm Screw



S-C (x2)
M3x8mm Screw



S-D (x2)
Knob



M-A (x8)
M4x12mm
Screw



M-B (x8)
M4x16mm
Screw



M-C (x8)
M5x12mm
Screw



M-D (x8)
M5x16mm
Screw



M-E (x8)
M5 Washer



M-F (x8)
Spacer



T-A (x1)
6mm Allen
Wrench

Tools Needed:



**Phillips
Screwdriver**



Scissors

Weight Capacity:



DESKTOP



KEYBOARD TRAY



PER SCREEN

Assembly Steps

STEP 1

Apply Pads (D) to underside of Keyboard Tray (B).

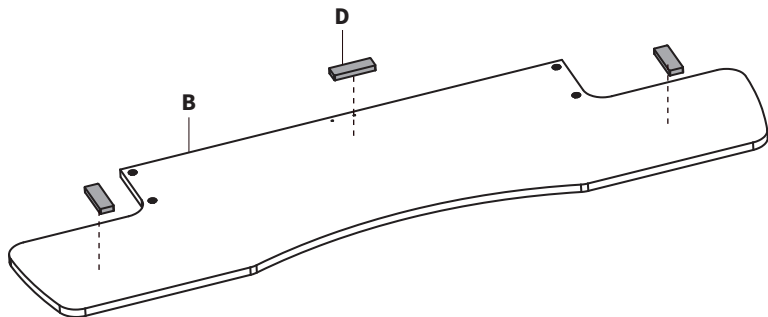

Assemble Stopper (C) to Keyboard Tray (B) using ST4.2x12mm Screws (S-A) and a Phillips screwdriver.

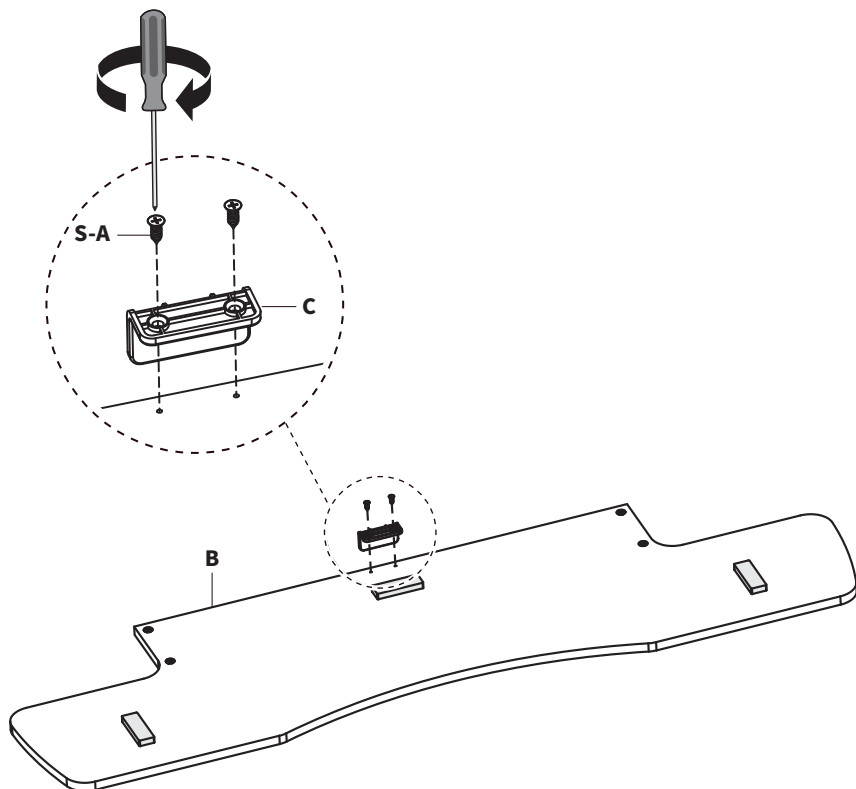

STEP 2

Install Rubber Feet (**E**) to the bottom of Desk (**A**). Remove **Shipping Tie** from desk and set right side up on solid surface.

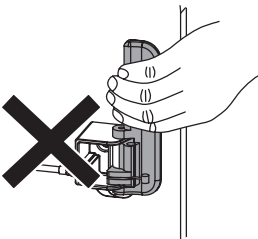
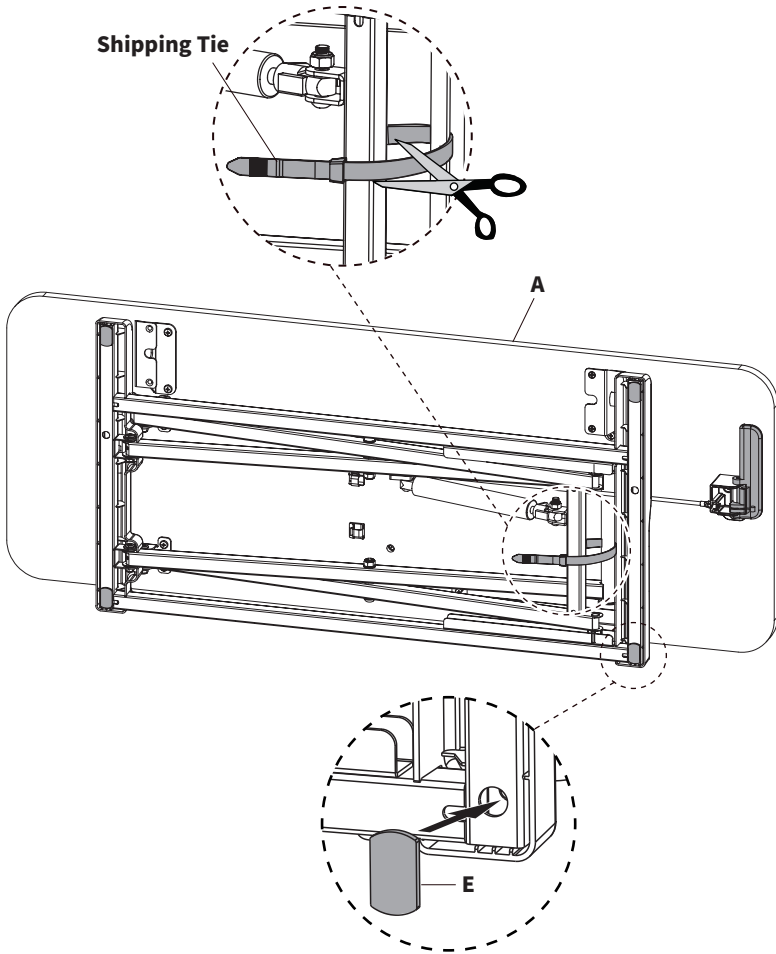

****Warning****

DO NOT press the handle until the desk is flipped upright. Doing so can result in personal injury.

STEP 3

Raise Desk **(A)** by lifting the handle on the right side of the frame.

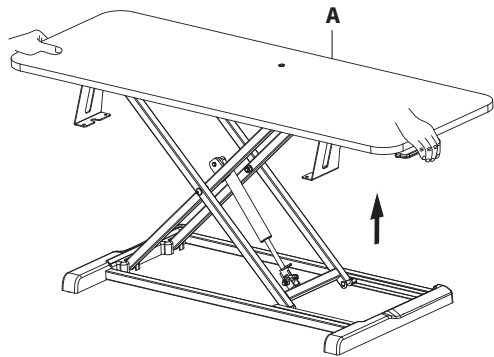

Place Keyboard Tray **(B)** on the metal brackets on Desk **(A)**.

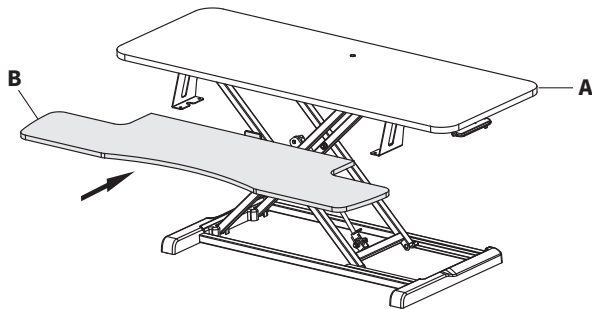

Secure Keyboard Tray **(B)** to brackets using M5x10mm Screws **(S-B)** and tighten with a Phillips screwdriver.

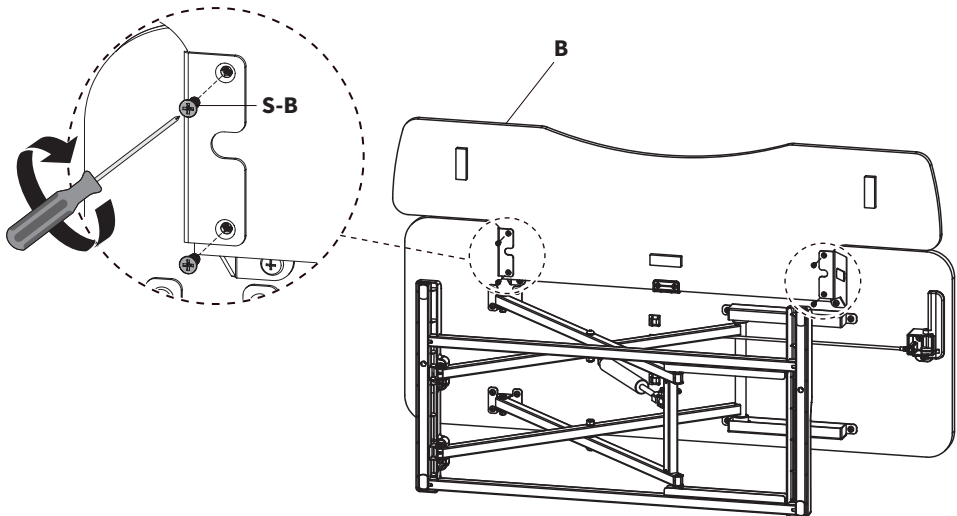

STEP 4

Install the Pole Cap (**O**) onto the top of the Pole (**H**).

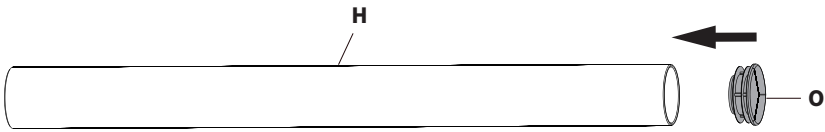

STEP 5

Remove the Grommet Cap from the top of the Desk (**A**).

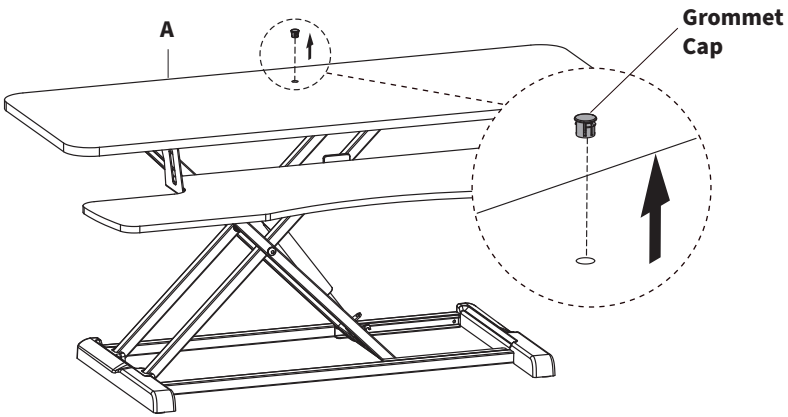

Remove adhesive cover and install the Rubber Pads (**P**) onto the underside of the Grommet Plate (**J**) in an even, circular pattern.

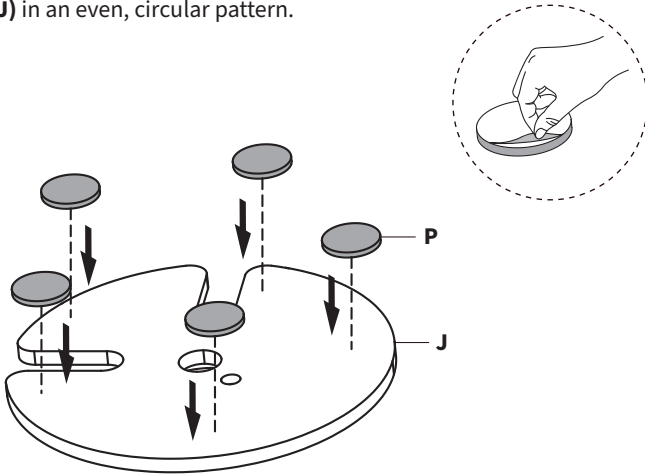

STEP 6

Place the Pole (**H**) onto the Grommet Plate (**J**). Slide Support Plate (**L**) onto Clamp Bolt (**K**).

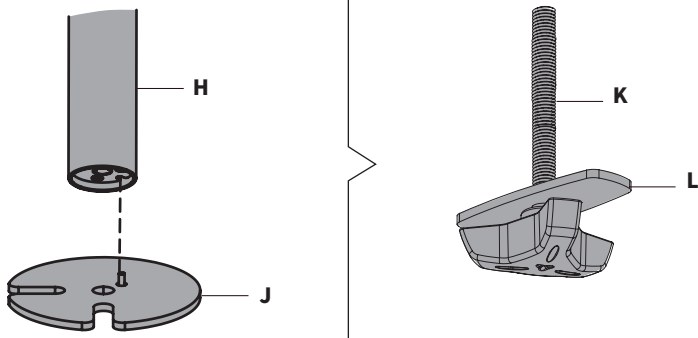

Thread Bolt (**K**) through mounting hole in Desk (**A**), anchoring into Pole with Grommet Plate.

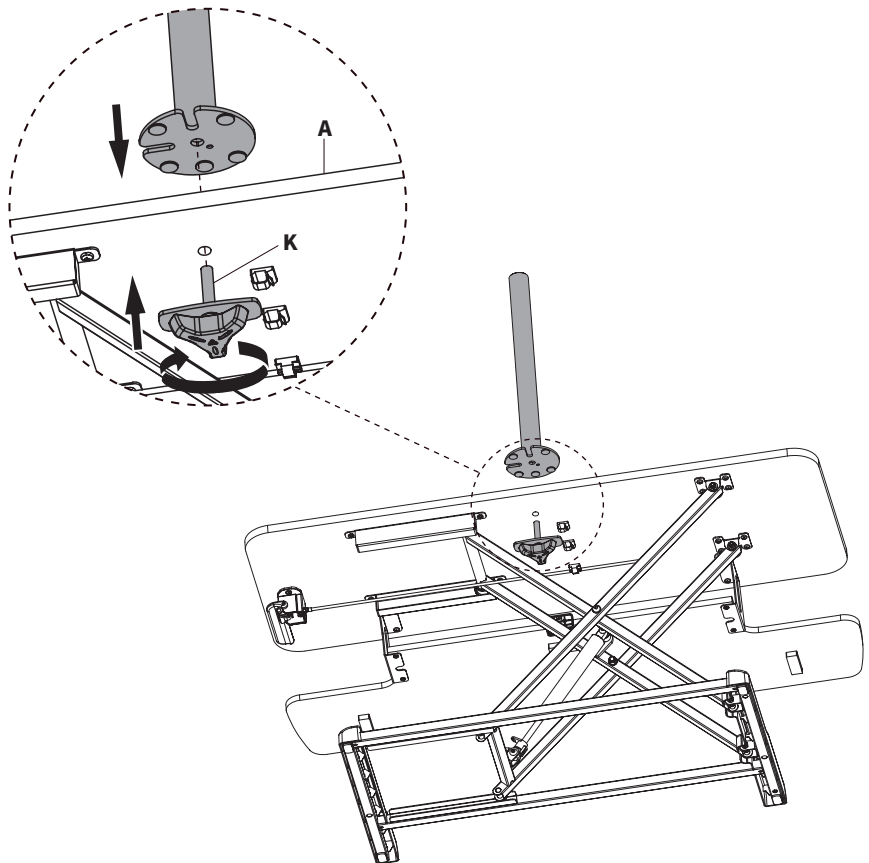

STEP 7

Slide Pole Cable Clip (**M**) and Swivel Arm (**G**) onto Pole (**H**). Secure Swivel Arm in place using 6mm Allen Wrench (**T-A**).

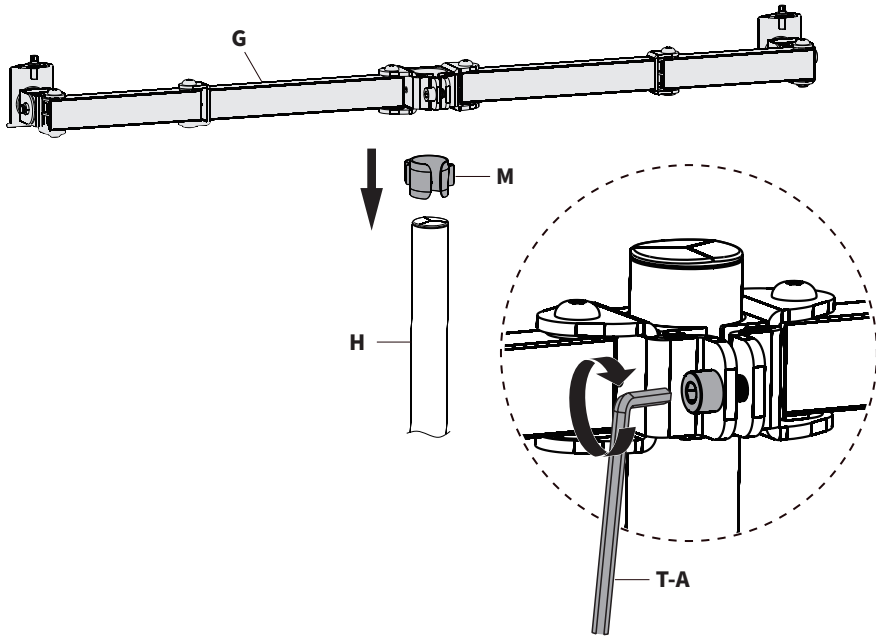

STEP 8

Attach Arm Cable Clips (**N**) to Swivel Arm.

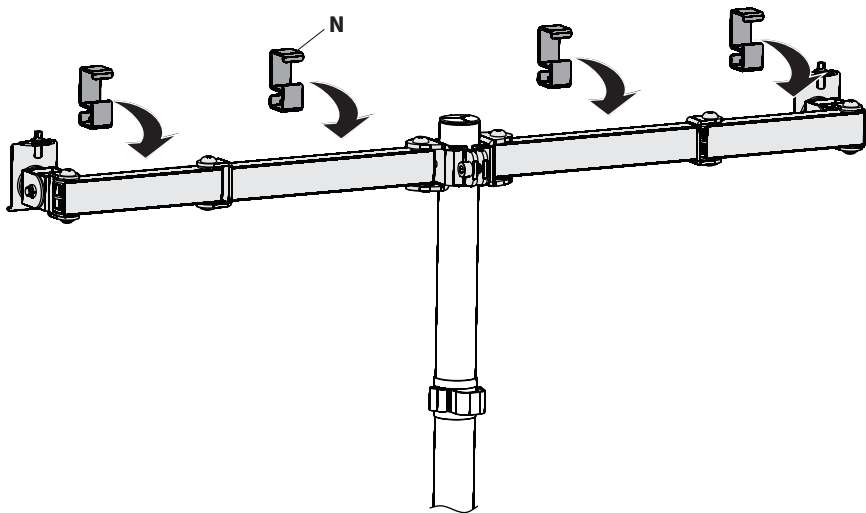

STEP 9

Install VESA Plates (**I**) to monitors using appropriate Screws (**M-A~M-D**), M5 Washers (**M-E**) and a Phillips screwdriver, being careful not to overtighten.

Flat Back Monitor

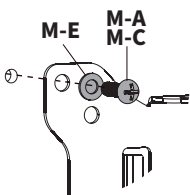

Non-Flat Back Monitor

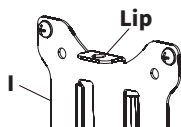
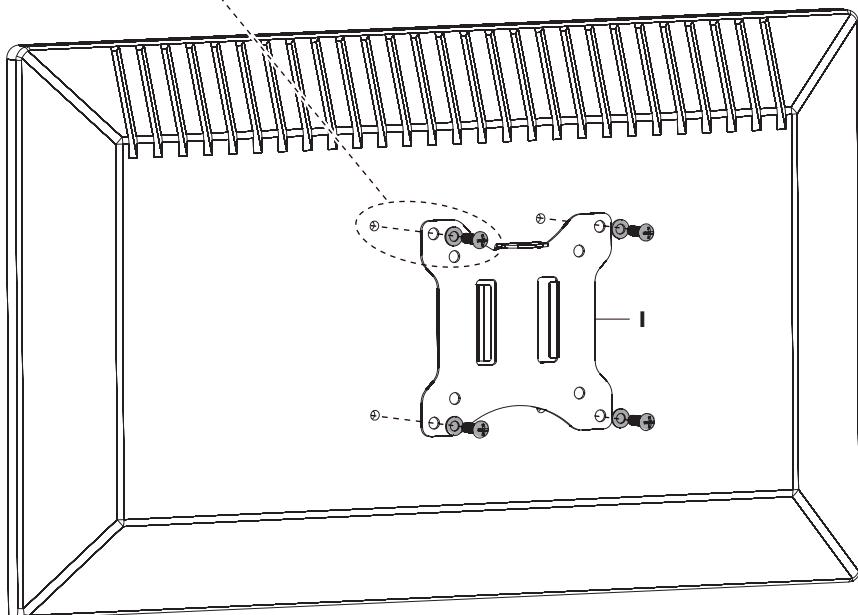
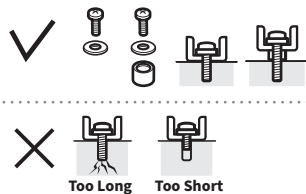
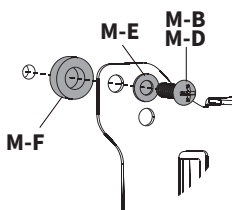

Make sure the **Lips** of the VESA Plates (**I**) face the top of the TV.

STEP 10

Slide monitors onto Swivel Arm (**G**). Place Knobs (**S-D**) on VESA Plates (**I**) and secure using M3x8 Screws (**S-C**) and a Phillips screwdriver.

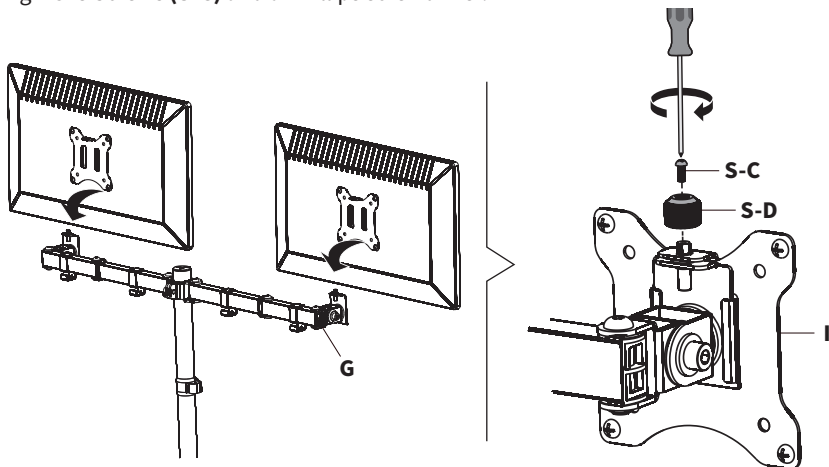

STEP 11

Adjust monitor tilt by using the 6mm Allen Wrench (**T-A**) to loosen and tighten the joint.

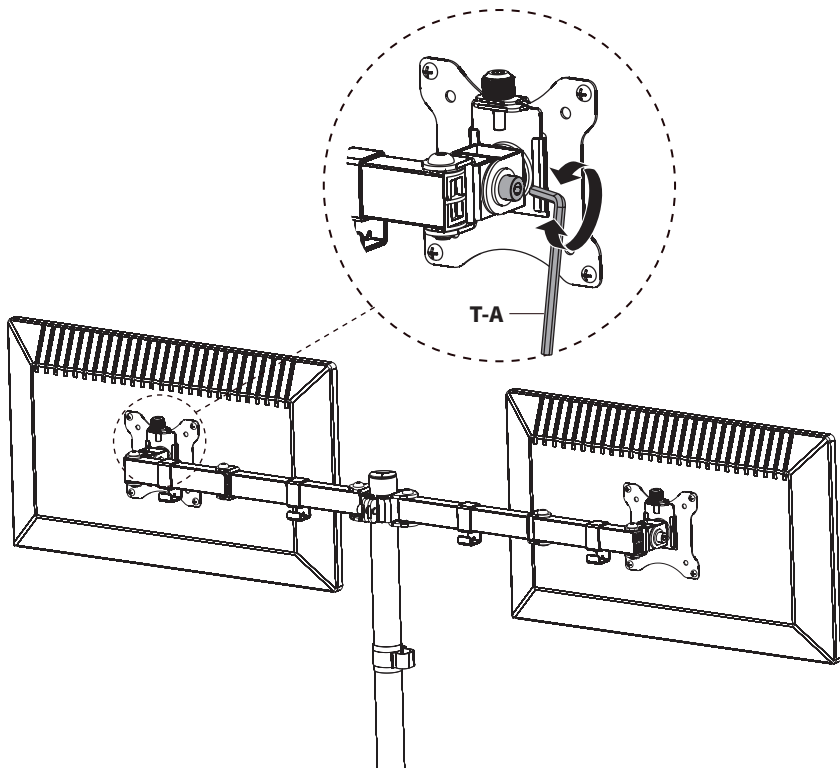

STEP 12

Manage cables using Arm Cable Clips (**N**) and Pole Cable Clip (**M**).

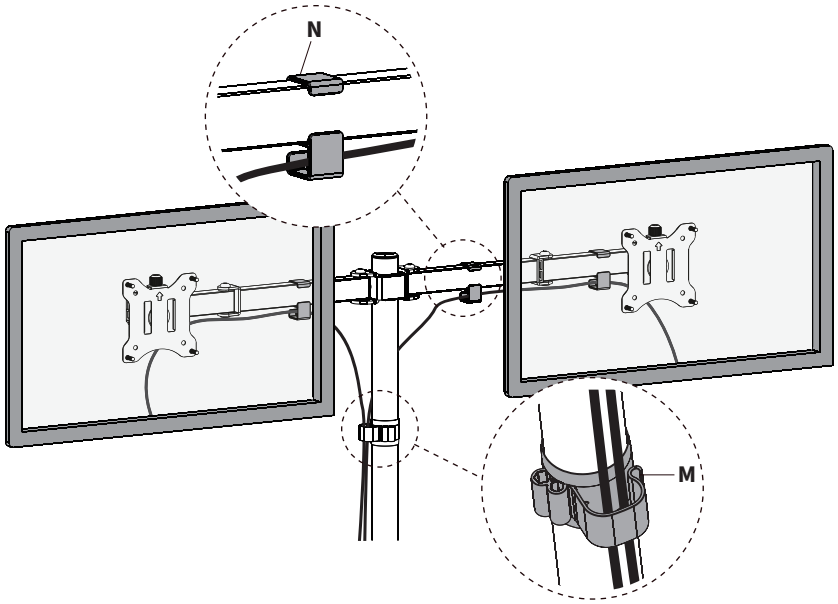

Peel off adhesive from Cable Clips (**F**) and apply to underside of Desk (**A**) and route cables.

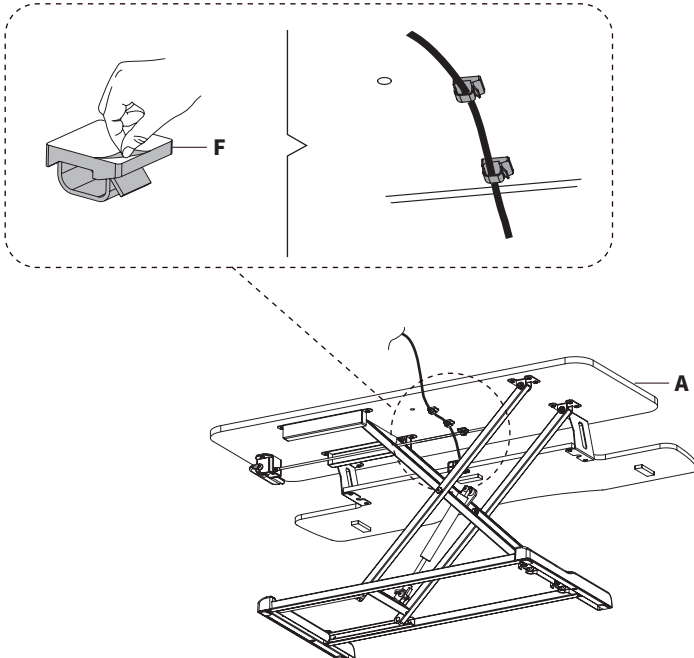



****WARNING – Risk of Tipping****

To prevent tipping, please be careful not to extend the arms too far forward or backward.

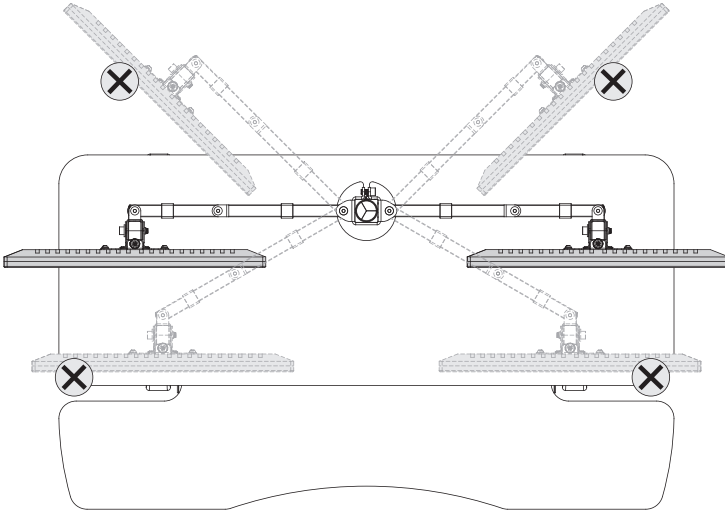

Adjustments

Position your monitors into a comfortable viewing orientation.

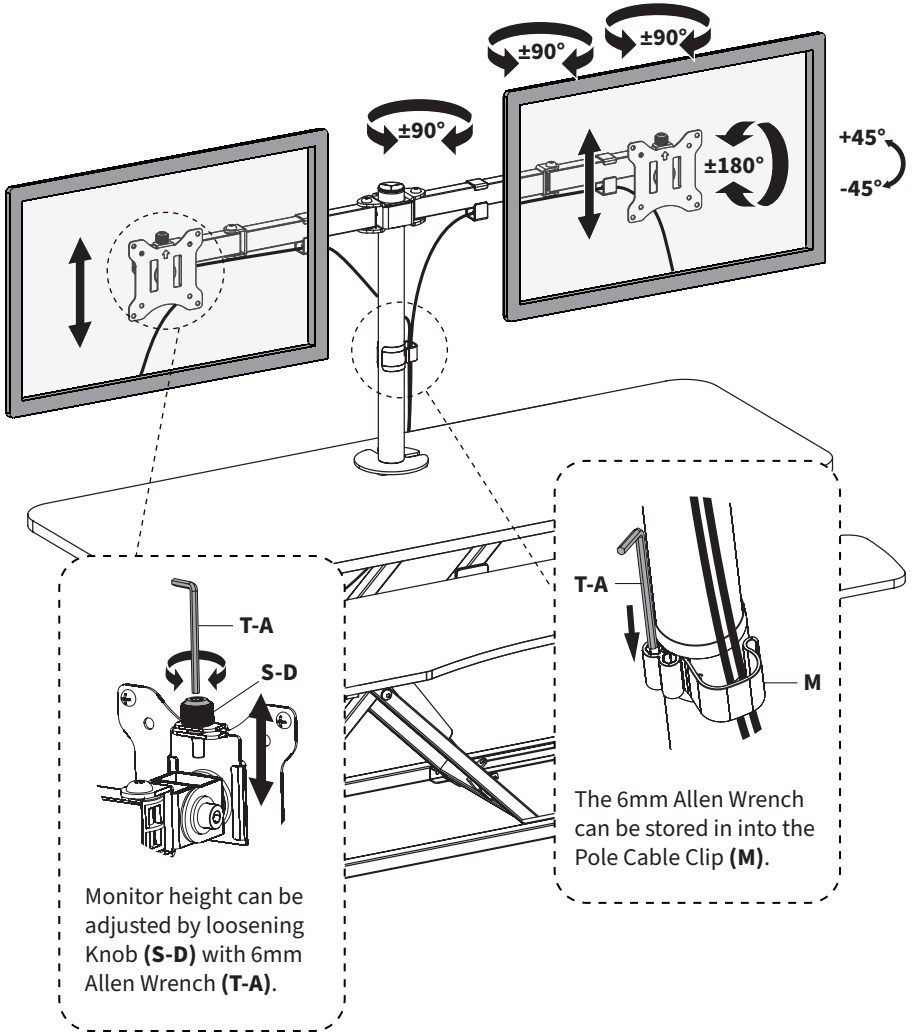



Need Help? **We're Here For You**

Monday-Friday from 7am-7pm CST

Saturday 8am-4pm CST



Email Us
help@vivo-us.com



Chat with Live Agent
www.vivo-us.com



Give Us a Call
309-278-5303 ext. 1



VIVO-us



@vivo_us



@VIVOus



VIVO