

# Numbering:SU-19

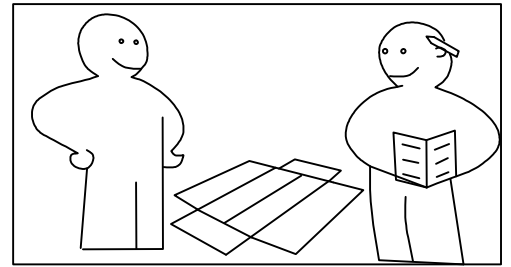

Attention: two people are required for assembly and lifting unit

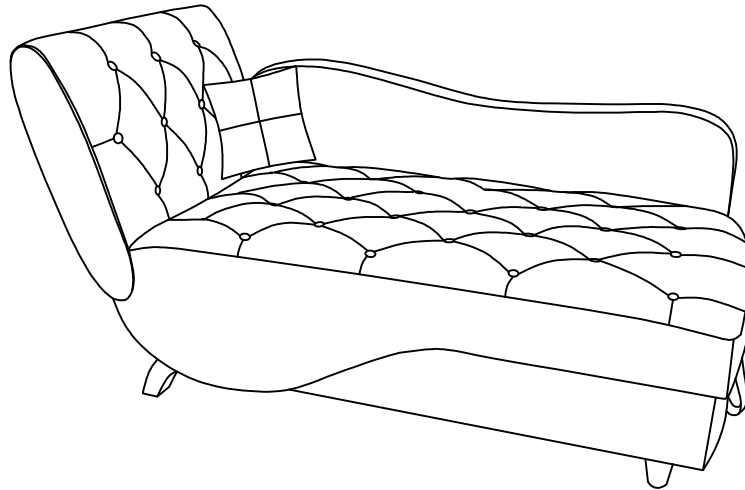

## Assembly parts

1.

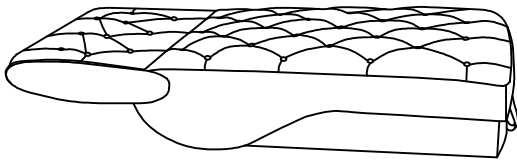

2.

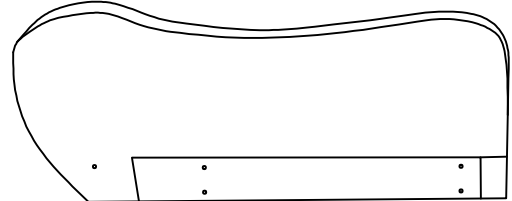

3.

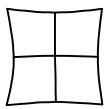

throw pillow (1PCS)

4.

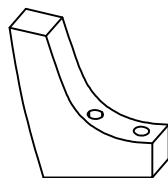

back foot (2PCS)

5.



forefoot (2PCS)

6.



screw (9PCS)

7.



Gasket (9PCS)

8.



wrench (1PCS)

9.



foot pad (2PCS)

# ASSEMBLY INSTRUCTION

