

Wall Sconce installation

STEP 1
Use the mounting screws to attach the mounting unit to the junction box

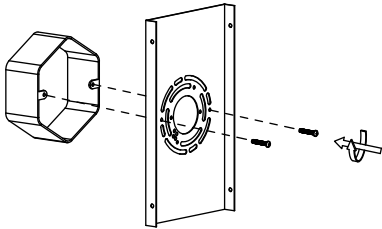

STEP 2
Make the electrical connection from the junction box to the fixture. Connect the ground wire to the mounting unit using the preinstalled green ground screw. Then, connect the positive, negative and ground wires with the supplied wire nuts. Secure with electrical tape

Connect Clear, Brown, Gold or Black Parallel Wire without tracer (round & smooth) or Black Fixture Wire to:

Connect Clear, Brown, Gold or Black *Parallel Wire with tracer (square & ridged) or White Fixture Wire to:

Black or Red Supply Wire or Insulated Wire (other than green) with copper conductor.

White Supply Wire or Insulated Wire (other than green) with silver conductor

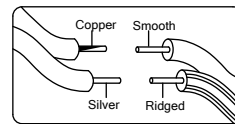
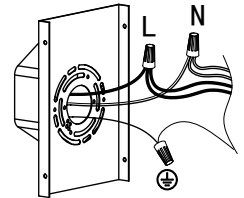

STEP 3
Place the canopy on the mounting unit and secure the fixture with side screws.

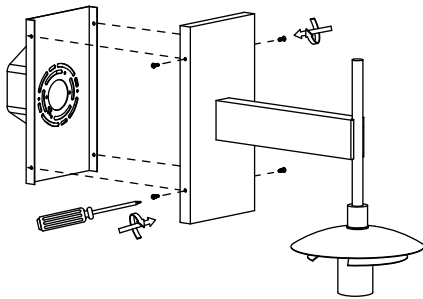

STEP 4
Loosen the fixing nut

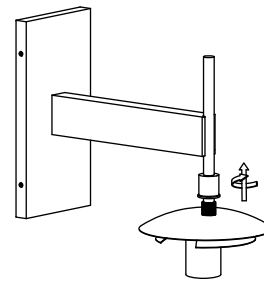

STEP 5
Snap the glass into the opening of the iron sheet, place the glass firmly in the iron cover
Install bulb (Not Included)
E26 TYPE A 60W*1

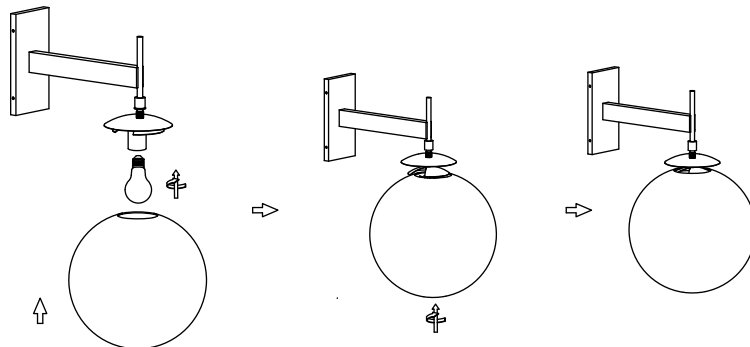

STEP 6
Place the canopy over the mounting unit and secure the fixture with the cap nuts.

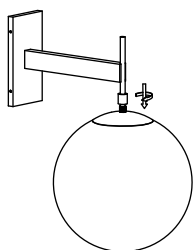

STEP 7
The installation is complete

