

Contents of the Package

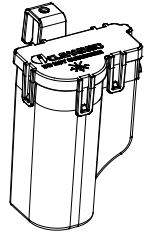

Drive Pneumatic

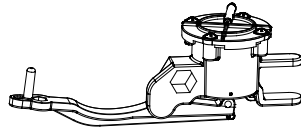

Flush Actuator



M8*15mm X4

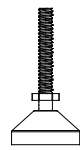

M8*50mm X4

Adjustable leveling foot

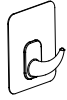

Plastic hook



Stainless steel chain



X2

M8 hex nut



Coil spring



Wrench



X2

Cable tie

This product must be used with a complete unit from the iCleaningo brand.
Compatible with DC01, DC01Pro, and DC02 models.

Installation for toilets with side-press flush valves

Actuator assembly

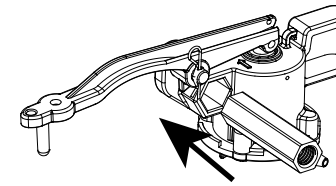

1. Insert the nut through the locking hole in the direction of the arrow.

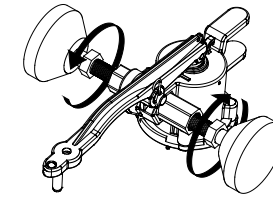

2. Connect the adjustable rod with the nut.

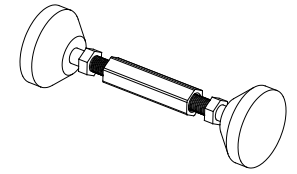

3. Assemble the second adjustable foot.

Install the actuator onto the water tank.

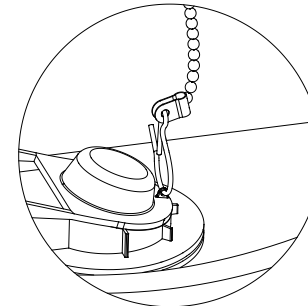

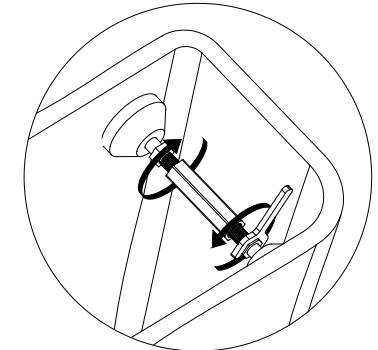

1. Attach one end of the chain to the flush valve.

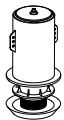

2. Install the adjustable foot and secure it with a wrench.

This product is compatible with the following flush valves.

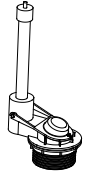
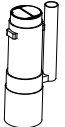
Flush valve type	Installation method
 Canister Flush Valve  Flapper  Flapper Valve	Chain-pull
 Top-Mount Dual Flush Valve	Push-down

Before installation, please measure the inner width of the ceramic tank to select the appropriate adjustable foot combination.

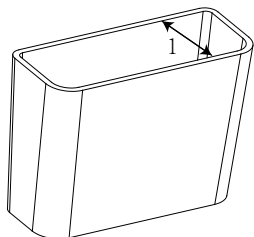

Inner width of the ceramic tank:
 100~125mm: M8*15+M8*15
 110~160mm: M8*15+M8*50
 120~195mm: M8*50+M8*50

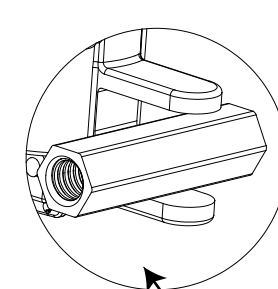

3. Install the actuating unit and tighten it with a wrench.

Note: This opening should be tightly aligned with the bottom side of the nut.

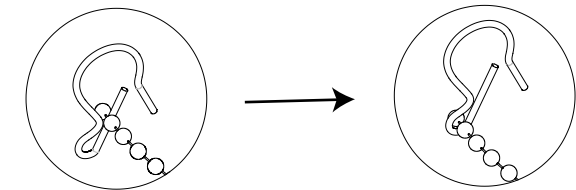

After adjusting the chain length, secure it in place.

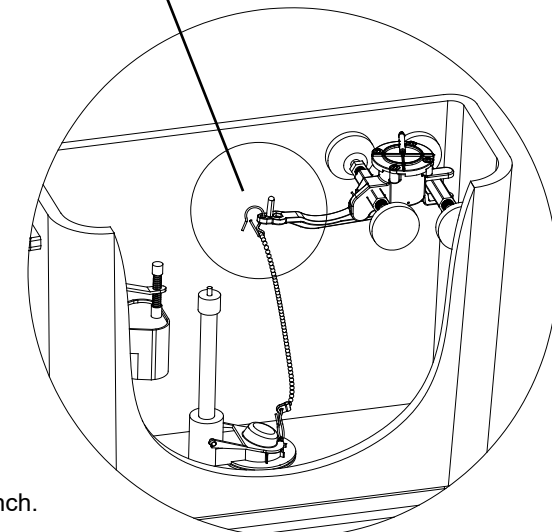

4. Connect the actuating unit to the original flush valve using the chain.
(Note: Adjust the chain so that it's nearly straight.)

Installation for toilets with top-press flush valves

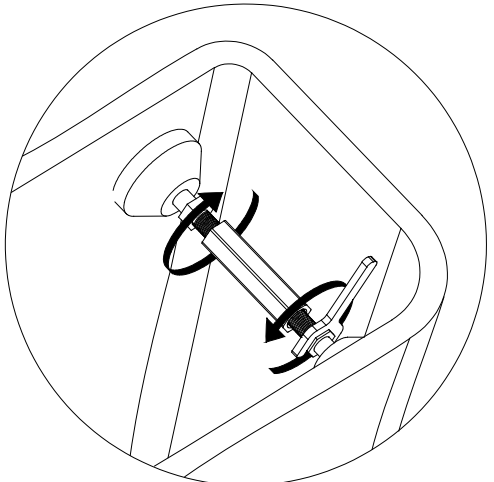

1. Install the adjustable foot and secure it with a wrench.

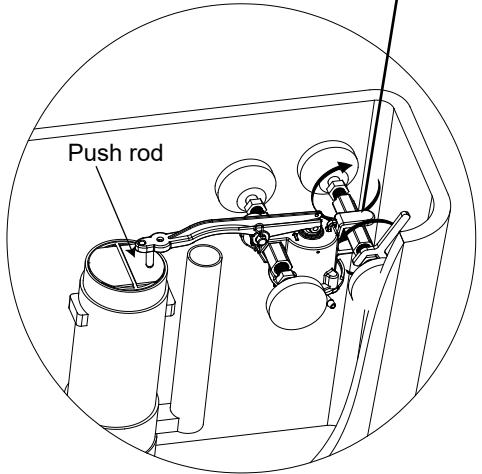

2. Install the second adjustable foot and tighten it with a wrench.

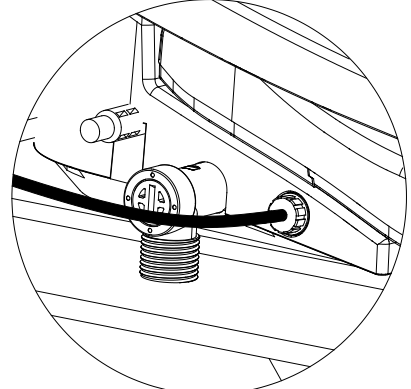

*Applicable to DC02

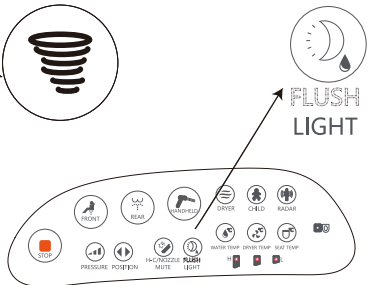

*Applicable to DC01 & DC01 Pro

After connecting the signal cable from the Drive Pneumatic to the side port of the toilet, the automatic flush can be controlled via the remote control or control panel.

ITEM	iCleaningo F2
Rated power supply	DC 12V
Rated power consumption	10W
Power cord length	47 Inch (1.2 m)
Water protection level	IPX4
Working ambient temperature	32 - 104 °F (0 - 40 °C)
Compatible flush valve types	Canister flush valves, Flapper valves, Top-mount flush valves
Dimensions(MAX D*W*H)	6.85 x 5.2 x 5.2 Inch (174x132x132mm)
Weight including free gifts	About 2 lb (0.9kg)

iCleaningo Company Limited
 Address : Changsha, Hunan CHINA
 Zip Code : 410000 Email: support@icleaningo.com
 Websites : www.icleaningo.com



Scan the WhatsApp QR code for 1-on-1 support

Installation of the Drive Pneumatic

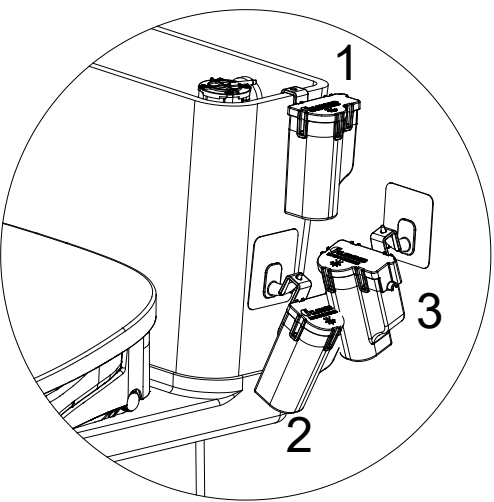

1. Choose the appropriate installation position based on the available space.

- Hang it on the toilet tank wall.
- Secure the hook to the toilet tank wall or the wall, then hang the unit.

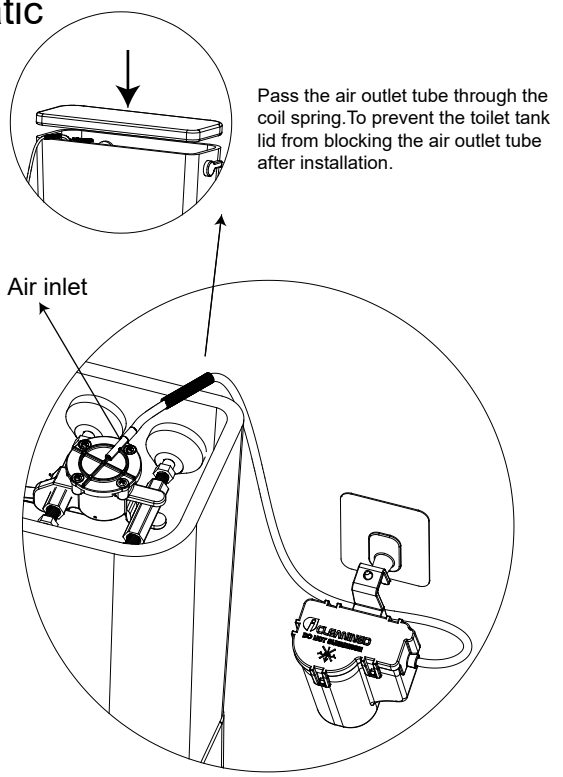

2. Connect the air outlet tube from the Drive Pneumatic to the air inlet on the Flush Actuator.



Owner's Manual

F2 Auto Toilet Flush Kit

