

# RVA1244

PLATFORM FOR MIXING BOWL

**RUVATI**<sup>®</sup>  
SPECIFICATION SHEET

**Material:** Hardwood - Solid Sapele (African Mahogany)

**Size:** 17-1/4" (length) x 15-3/4" (width) x 1" (thick)

## Compatible Ruvati Sinks:

RVH8003, RVH8023, RVH8030, RVH8035, RVH8222, RVH8300, RVH8301, RVH8309, RVH8310, RVH8333, RVH8345, RVH8350, RVH8351, RVH8555, RVH9050, RVH9100, RVH9200, RVH9201, RVH9300, RVH9301, RVH9333

## Care Instructions:

Like any natural wood product, this cutting board needs proper care and handling. Improper use can result in the board warping or cracking, and is not covered by any warranty. Please follow the instructions below:

### DOs



- Wipe off with Damp towel, or wash gently with dish soap after use and rinse well with water. Dry immediately. Do not leave wet or soaked in water. Let dry by standing vertically on one edge.



- Always store dry cutting board either vertically, or sitting on the ledges of the Ruvati workstation sink.



- Rub both sides with food-grade mineral oil or vegetable oil once a month.

### DON'Ts

- Don't use bleach or any other harsh cleaning agent.
- Don't leave it sitting on wet countertop.
- Don't put in dishwasher.
- Don't leave it soaked in water.
- Don't expose to hot surfaces or direct sunlight.

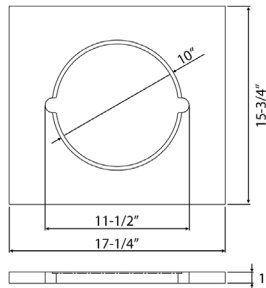

 California Prop 65 Warning:  
Cancer and Reproductive Harm



X003VXBAT9

**RUVATI USA**

WWW.RUVATI.COM

PHONE: 1.855.478.8284  
EMAIL: SUPPORT@RUVATI.COM

SCAN TO REGISTER  
YOUR WARRANTY



www.ruvati.com/register