

RESORT CORNER WALL-HUNG

Cat. No.
4-1091



Faucet Not Included



Mounting hardware

Width: 17-³/₄"
Depth: 15-³/₄"
Height: 6-¹/₄"

***Please do NOT drill hole without
template or actual product.**

Interior Dimensions:

Basin interior: 14-¹/₂" X 7-³/₄"
Basin depth: 5"
Back of basin to center of faucet: 4-¹/₄"
Back of basin to center of drain: 8-³/₄"
Mount holes cc: 6"
Faucet hole diameter: 1-³/₈"

Features:

- ▶ Vitreous China
- ▶ Available for 1 faucet hole
- ▶ Pre-drilled overflow hole
- ▶ Perfect for corners
- ▶ Mounting hardware included

Colors:

WH White

Compliance Certification

Meets or exceeds the following
specifications: ASME A112.19.2
2013 and CSA B45.1-13 for
plumbing fixtures.

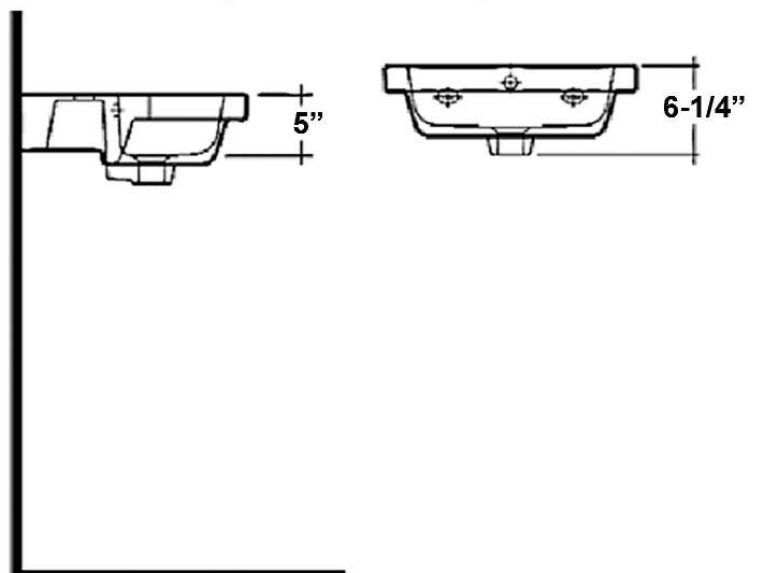
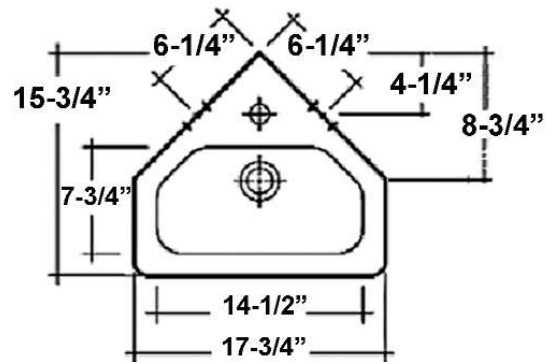

Dimensions of fixture are nominal and may vary within the range of tolerances established by ANSI Standard A112.19.2. Dimensions and specifications subject to change without notice.

04/27/2018

P 847•244•1234

www.barclayproducts.com