

Hand Push Sweeper

I. Main technical parameters

Specification and Model	
Drive Mode	Hand push type, double roll type
Maximum Working Efficiency	3680 m ² /h
Working Width	1100mm/43.3inch
Barrel Capacity	55L/14.53GAL
Color	
Weight	25kg/55.12lbs
Volume	1300 * 790 * 1035mm/51.2*31*41inch (use size) 890 * 790 * 385mm/35*31*15inch (folding size)

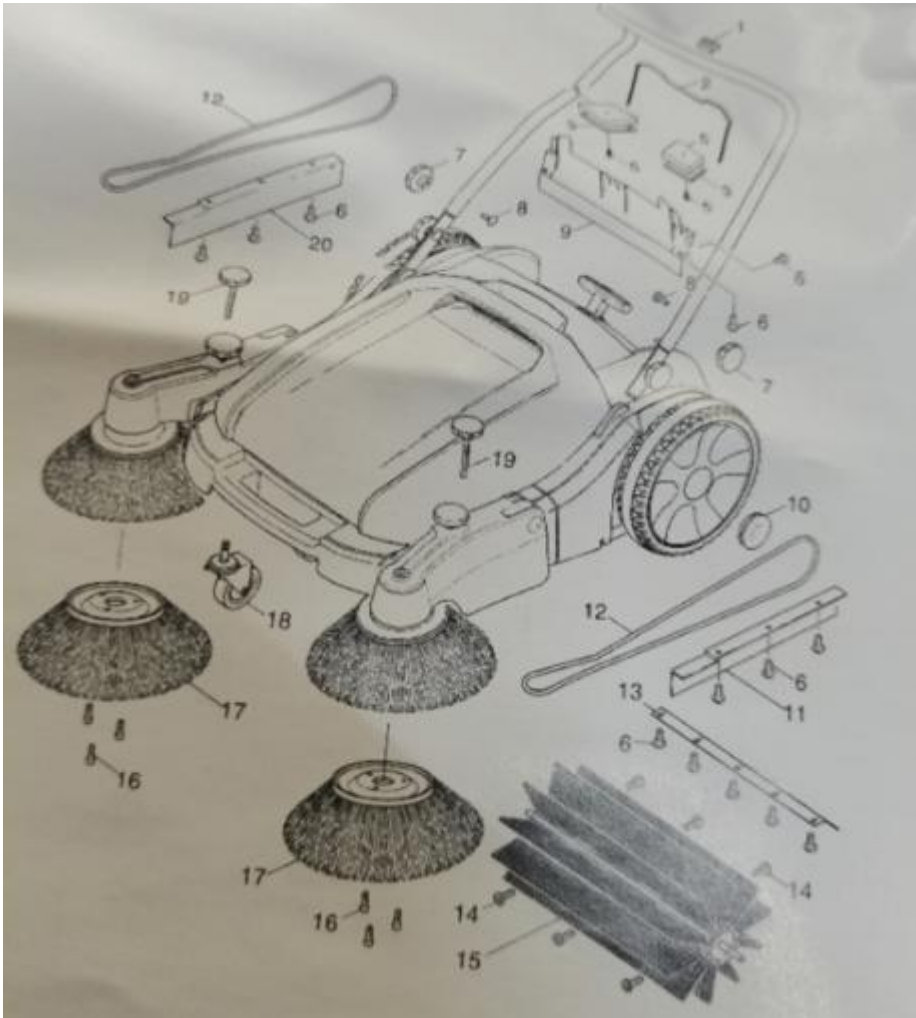

II. Manual Sweeper Instructions

Instructions

1. Before unpacking, if any damage is found during transportation, please inform the product seller.
2. Please read the operating instructions carefully before working and check whether the sweeper operates normally.
3. This machine is not suitable for cleaning substances harmful to health. It is strictly prohibited to clean combustibles or hot substances.
4. The machine is strictly prohibited to clean the ground with water or oil, and it is strictly prohibited to clean the wire rope or iron wire.
5. Please do not use the machine on rainy days, and do not wash it with water
6. It is strictly prohibited to run the machine with a single wheel touching the ground and tilting to avoid damaging the performance of the whole machine.
7. Please wear gloves when moving glass, metal or other parts in the dustbin.

Operation and Maintenance

1. The operator shall use the sweeper under normal operation. During operation, the operator shall consider the surrounding environment, be careful to touch people or objects, and pay special attention to the safety of children.
2. Adjust the best ground clearance of the front and rear brushes according to the garbage cleaning situation on the ground. If the brush is too high off the ground, the cleaning effect will not be achieved. If the brush is too low off the ground, the wear of the brush will be increased and the propulsion **resistance** will be increased. The adjusting handle of the armrest should be properly tightened. Please do not twist it too hard to prevent damage to the bolts.
3. After the use of the sweeper, the side brush must be lifted, and the main brush gear should be adjusted to the lowest position. When it is stored outdoors, pay attention to rain and moisture **resistance**.
4. The maintenance of the sweeper shall be completed by personnel with professional knowledge, using parts provided by the manufacturer to ensure **trouble-free** operation of the sweeper.

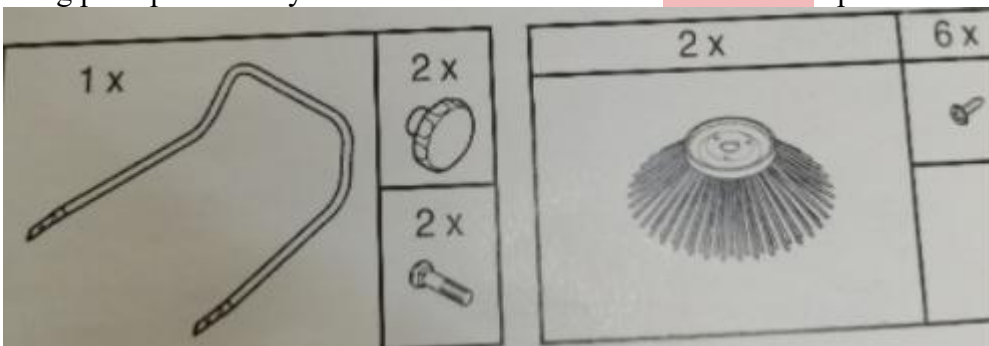

Handrail and adjusting bolt assembly

Front brush and fixing screw

1. Gloves
2. Sealing baffle
3. Sponge cover
4. Sponge
5. Locking pin
6. Self tapping screw ST4.8 * 16
7. Handle

- 8. Half round head square neck bolt M8 * 25
- 9. Dust proof rear cover
- 10. Wheel cover
- 11. Baffle 1
- 12. Driver belt
- 13. Dust retaining rubber
- 14. Self tapping screw ST4.8 * 32
- 16. Main brush
- 16. Self tapping screw ST4.8 * 22
- 17. Front brush
- 18. Guide wheel
- 19. Adjusting bolt assembly
- 20. Baffle plate 2

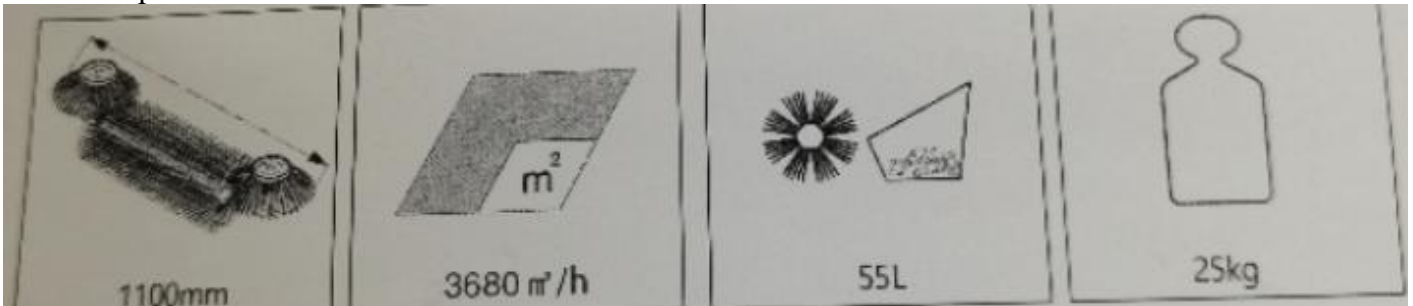

Effective width of front brush Hourly work efficiency Bin capacity Total Weight



Use dimensions Folding size Width of main brush

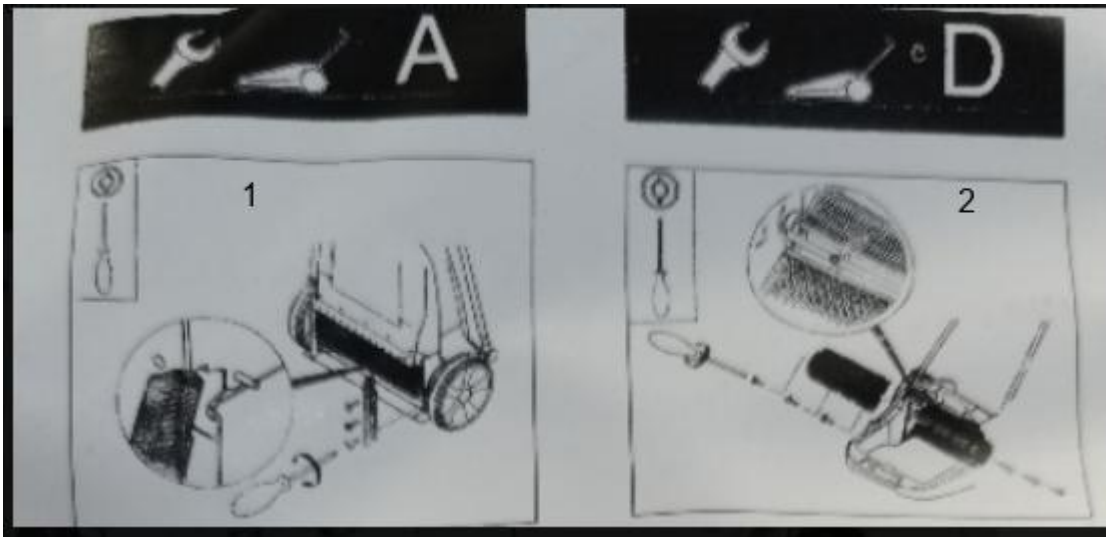

1. Installation of dust-proof plates at both sides of the bottom of the main brush
2. Removal and installation of main brush

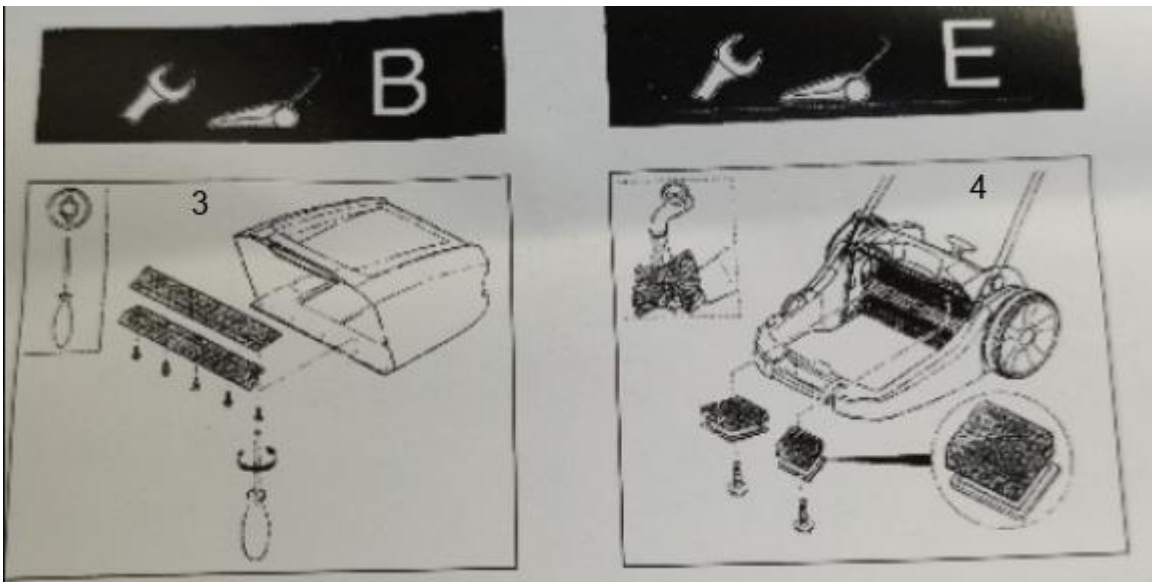

3. Installation of dustbin sealing baffle
4. Clean the sponge of exhaust hole regularly

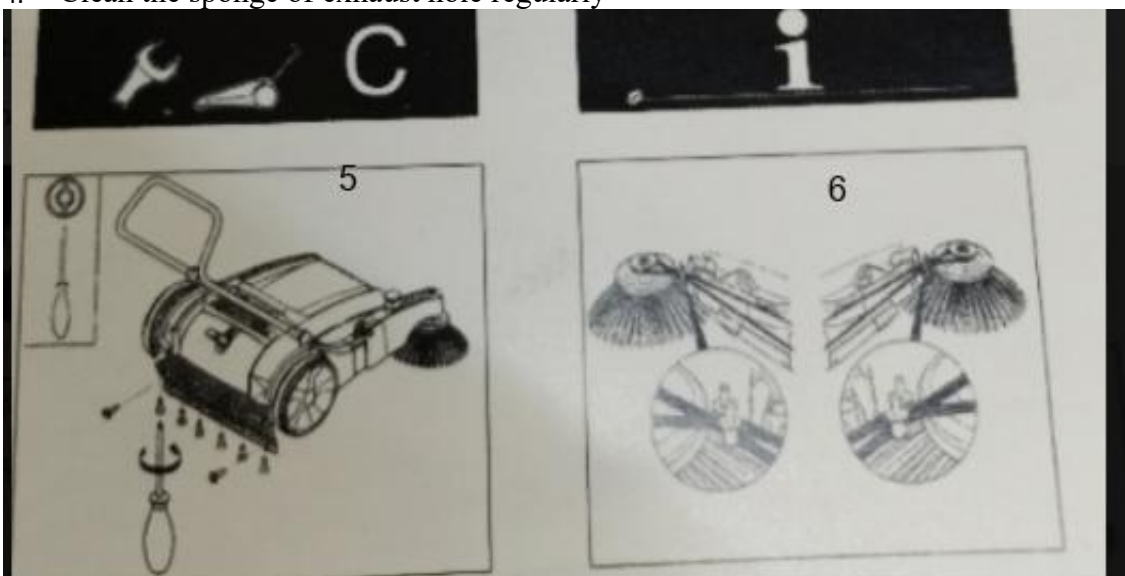

5. Installation of dust guard at the rear of main brush
6. Front brush drive

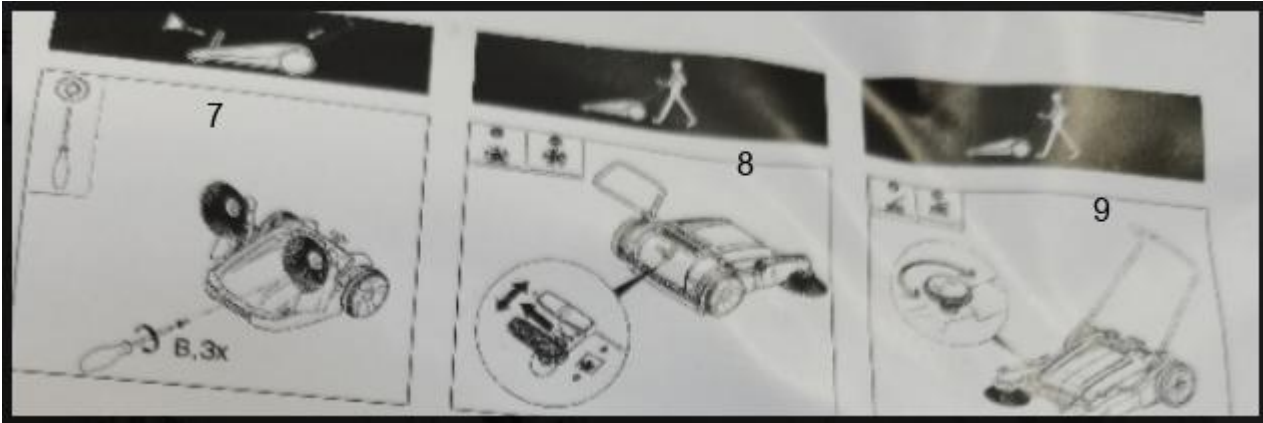

7. The front brush is fastened with three butterfly nails
8. Adjust the handle of the main brush, move the main brush pair in the "+" direction to lower, and move the main brush in the "-" direction to raise
9. Front brush adjusting handle, optional main brush lowering in "+" direction, main brush raising in "-" direction

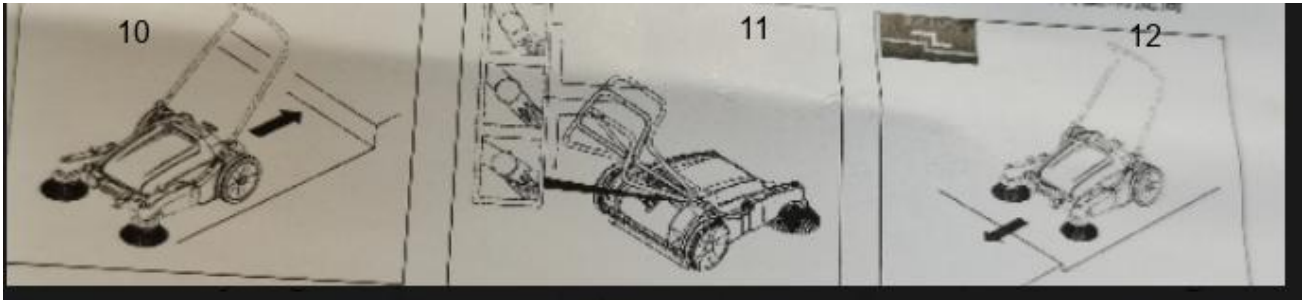

10. Crossing steps shall not exceed 19cm in reverse
11. The armrest has three angle adjustments
12. The height difference of the cleaned floor shall not exceed 2.5cm

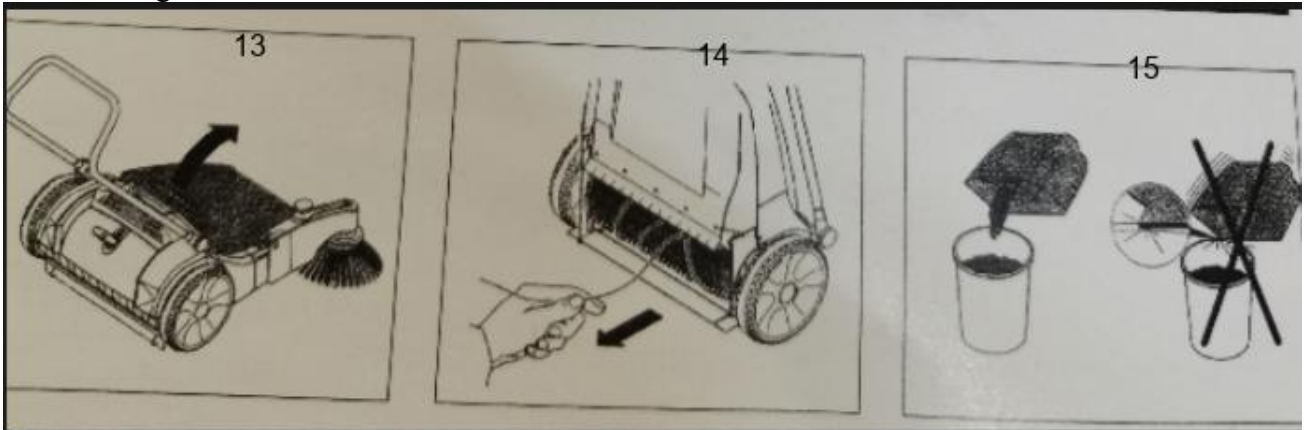

13. Remove the dustbin by lifting the handle upwards
14. When the main brush is entangled by garbage, it should be taken out in time
15. Once the garbage is dumped along the bin, it is strictly knocked against the bin