

design **TOSCANO**<sup>®</sup>

**INSTRUCTIONS  
FOR YOUR PRODUCT**

Thank you for your recent purchase of this Design Toscano hand-crafted piece of statuary. We have taken great care to create this piece especially for you. Please review these instructions and assemble this piece with care.

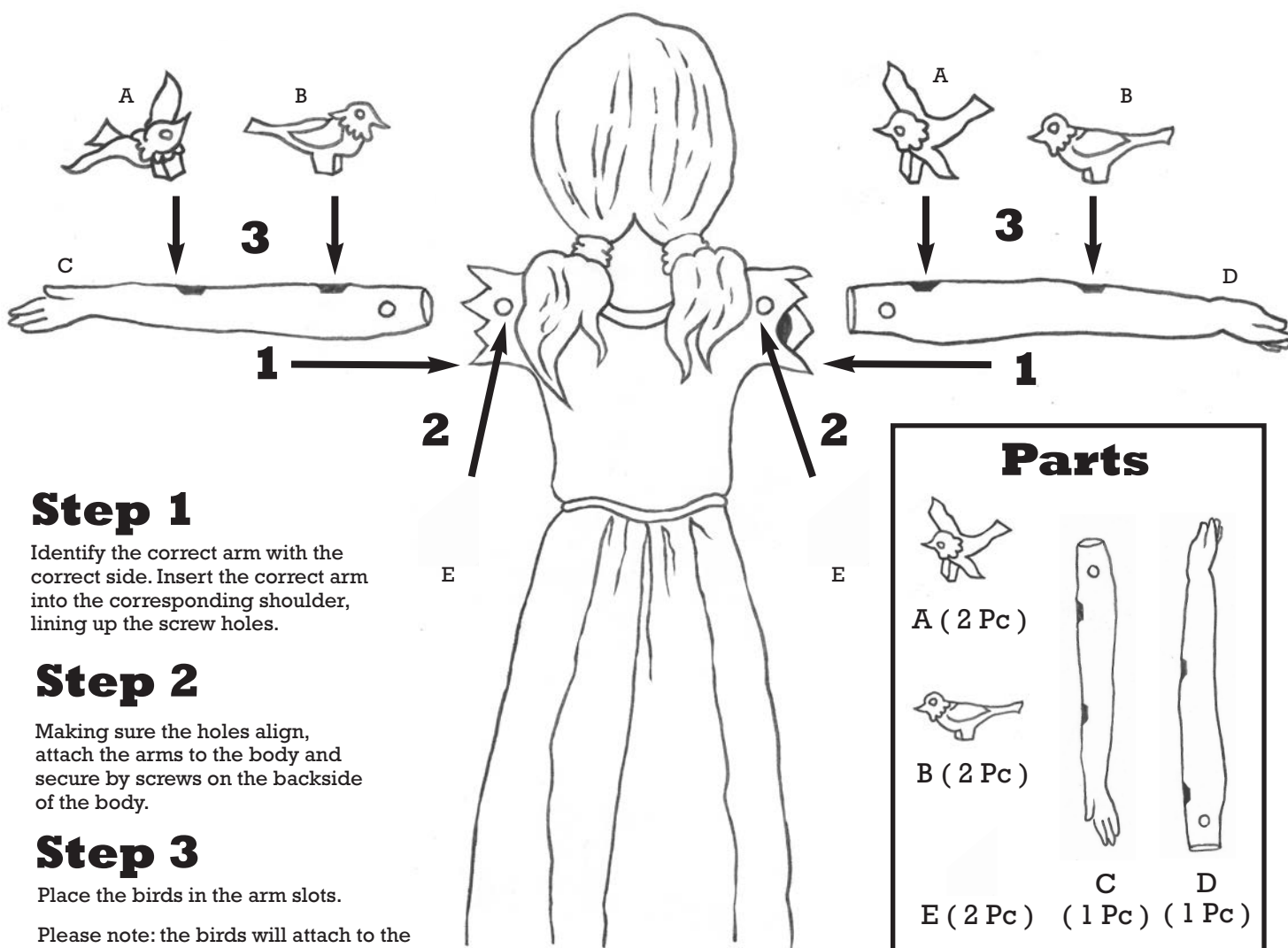

**Step 1**

Identify the correct arm with the correct side. Insert the correct arm into the corresponding shoulder, lining up the screw holes.

**Step 2**

Making sure the holes align, attach the arms to the body and secure by screws on the backside of the body.

**Step 3**

Place the birds in the arm slots.

Please note: the birds will attach to the armholes by a snug fit. You may want to add a waterproof glue for extra hold.

**Parts**

A ( 2 Pc )  
B ( 2 Pc )  
C ( 1 Pc )  
D ( 1 Pc )  
E ( 2 Pc )