

Features

- Slotted overflow for maximum bathing depth
- Integral lumbar support
- Molded armrests for extra comfort
- Two-piece design
- Textured Bottom Surface
- 67-3/4" (1721 mm) x 31-3/4" (806 mm) x 22" (559 mm)
- End Drain Placement

Material

- Exocrylic™

Installation

- Freestanding Bath
- Requires K-7271 or K-7272 Clearflo slotted overflow bath drain (sold separately).

Required Accessories

K-7271 Slotted Overflow Bath Drain

or

K-7272 Slotted Overflow Bath Drain

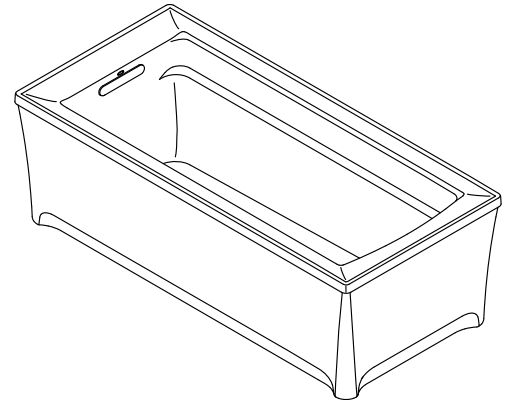

Codes/Standards





CSA B45.5/IAPMO Z124
CARB P2

See website for detailed warranty information.

Available Color/Finishes

Color tiles intended for reference only.

Color	Code	Description
-------	------	-------------

	0	White
	96	Biscuit
	47	Almond
	NY	Dune
	G9	Sandbar



ARCHER®
68" FREESTANDING BATH
K-2594

Recommended faucet area.

No change in measurements if connected with drain illustrated. (K-7272)

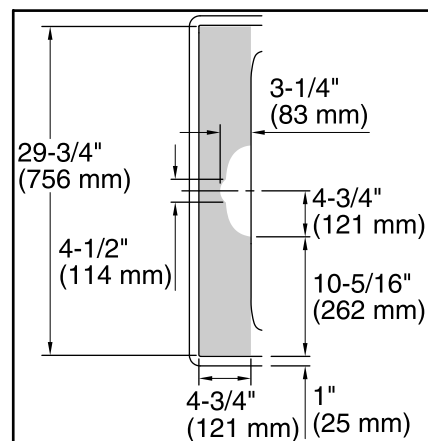
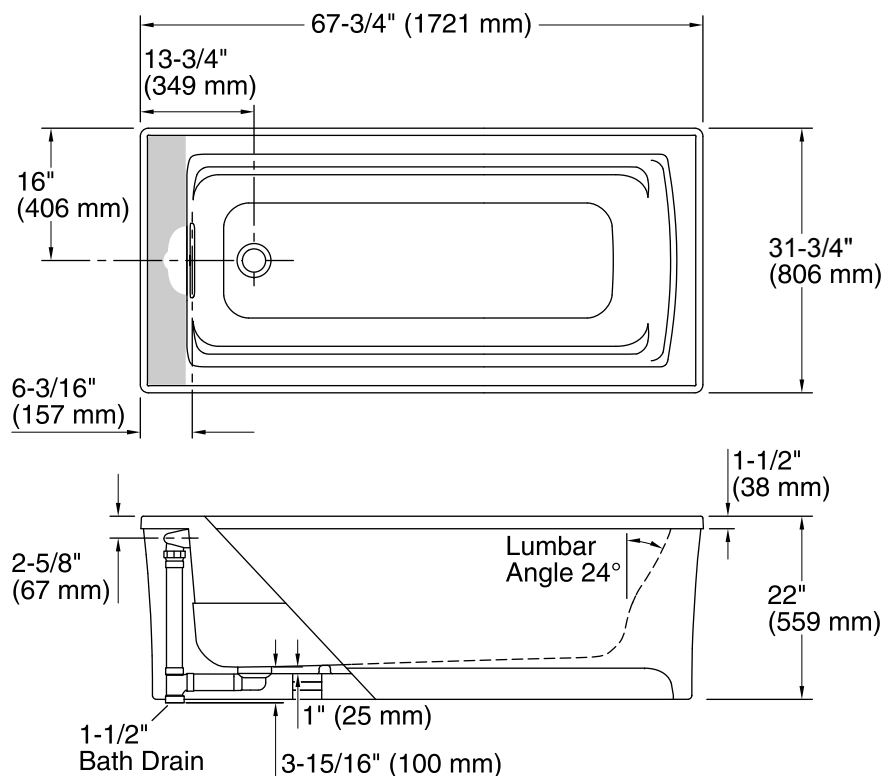

Recommended Faucet Area Detail

Technical Information

All product dimensions are nominal.

Installation: Freestanding

Drain location: Reversible

Basin area, bottom: 51-1/16" x 19-11/16" (1297 mm x 500 mm)

Basin area, top: 58-9/16" x 25-5/16" (1487 mm x 643 mm)

Weight: 95 lbs (43.1 kg)

Minimum floor load: 43.8 lbs/ft² (213.9 kg/m²)

Water depth: 15-1/16" (383 mm)

Water capacity: 65 gal (246.1 L)

Notes

Measure your actual product for roughing-in details.

Install this product in accordance with the installation instructions.

This bath is designed for freestanding installation only.

NOTICE: Do not support the load weight of the bath by the rim.

NOTICE: Confirm adequate support for rim-mount faucet. Using faucets as a means of support are not appropriate or safe for this installation.

The hot water supply should be 70% of the capacity of the bath or greater. Installations will vary.