

ME by Starck Two-piece toilet for SensoWash® # 217151..00 / 217151..00 / 217151..85 / 217151..85

| < 14 1/8" Inch > |

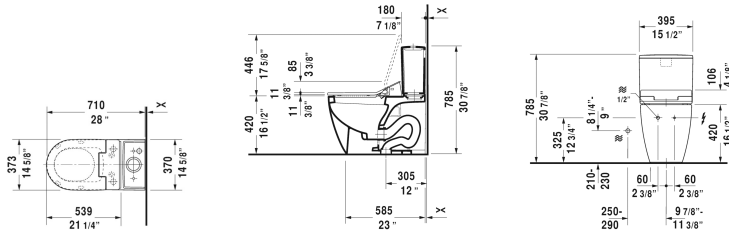

Two-piece toilet for SensoWash®	Dimension	Weight	Order number
(without tank), syphonic, 12" rough-in, vertical outlet, only in combination with SensoWash, connecting elements for SensoWash with concealed connections included, cUPC® listed*, WaterSense® listed			
Colors			
00 White 20 HygieneGlaze (an antibacterial ceramic glaze that provides almost indefinite effectiveness)			
Variant			
♣ 1.32/0.92 gpf, ADA height	14 1/8" x 28" Inch	101.4 lb	217151..00
♣ 1.32/0.92 gpf, ADA height	14 1/8" x 28" Inch	101.4 lb	217151..00
♣ 1.28 gpf, ADA height	14 1/8" x 28" Inch	101.4 lb	217151..85
♣ 1.28 gpf, ADA height	14 1/8" x 28" Inch	101.4 lb	217151..85
Sanitary ceramics with the special WonderGliss surface finish will remain clean and attractive-looking for a long time to come. When ordering WonderGliss please add a "1" as eleventh digit to the model number.			
Mounting set for One-Piece and Two-Piece toilets, outlet 3/8" - male thread, wall connection 1/2" - female thread, 1/2", North American version	17 3/4" Inch	1.1 lb	001417
Suitable products			
Tank for bottom left supply, WaterSense® listed, 15 3/8" x 7 1/8" Inch	15 3/8" x 7 1/8" Inch		093820
SensoWash® Slim shower-toilet seat for ME by Starck, Starck 2, Starck 3 and Darling New* Rear-, Lady- and Comfortwash, with slow close, night light, remote control included, locking function via remote control, self-cleaning wand, on / off-button, with concealed connections, automatic drainage in periods of prolonged disuse, 14 3/4" x 21 1/4" Inch	14 3/4" x 21 1/4" Inch		611000

All drawings contain the necessary measurements which are subject to standard tolerances. They are stated in inch & mm and are non-binding. Exact measurements, in particular for customized installation scenarios, can only be taken from the finished ceramic piece.