

ASSEMBLY INSTRUCTIONS

Parts:

(2) Side Piece

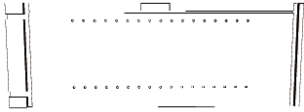

Top Piece



Bottom Piece

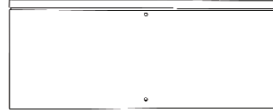

(16) Hex Screws



Back Piece

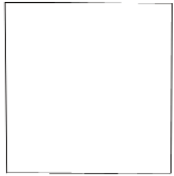

Back Brace (3¼" x 29½")



(2) Skirt (2" x 29½")



4) Shelf Piece



Allen Wrench



(16) Shelf Pins



**Notice - KEEP BACK GROOVES ALIGNED
Do Not Drill!**



Step 1: Align skirt with pre-drilled holes on **bottom piece**. Insert hex screws into pre-drilled holes in **bottom piece**. Tighten down. DO NOT DRILL. Repeat for remaining skirt piece.

Step 2: Insert edge of **bottom piece** into mortise of **side piece**. Make sure back grooves are aligned. Insert hex screws into each of pre-drilled holes in **side piece** and each of the **skirt**. Tighten down halfway. DO NOT DRILL.

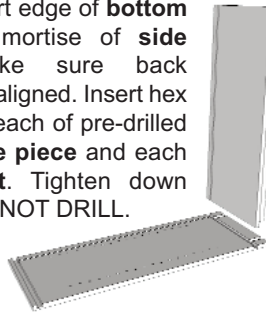

Step 3: Insert edge of **top piece** into mortise of **side piece**. Make sure back grooves are aligned. Insert hex screws into each of pre-drilled holes in **side piece** and tighten halfway. DO NOT DRILL.

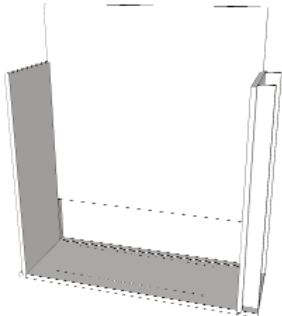
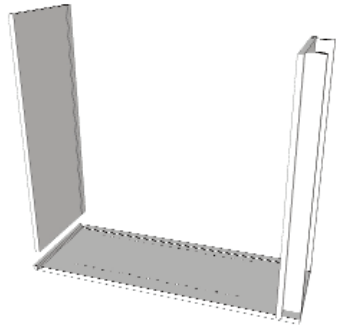

Step 4: Insert sides of **back piece** into back grooves of **top** and **bottom pieces**. Slide down until edge rests firmly in back groove of **side piece**.

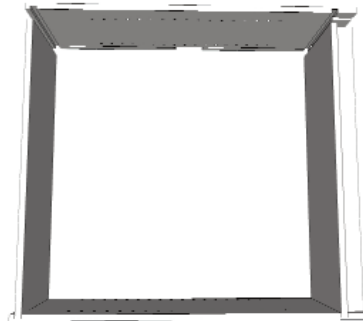

Step 5: Fit edges of assembled pieces into mortises and back grooves of remaining **side piece**. Insert hex screws into each of pre-drilled holes in **side piece** and tighten down halfway. DO NOT DRILL.

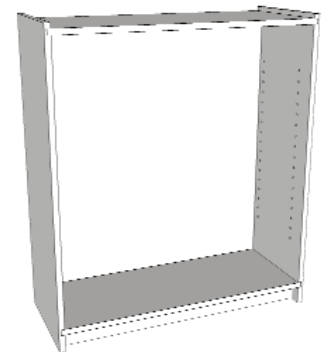

Step 6: Insert edge of **Back Brace** into mortises of **side pieces**. Make sure back grooves are aligned. Insert hex screws into each of pre-drilled holes in **side piece** and tighten down. DO NOT DRILL.

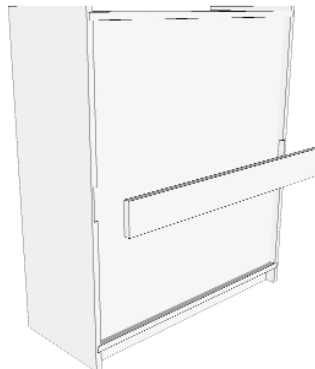

Step 7: Tighten all screws snugly. DO NOT OVERTIGHTEN. Rotate unit so that it rests on **bottom piece** and edges of **side pieces**. Insert shelf pins at desired height and place shelves on shelf pins. **Assembly is now complete.**