

# ASSEMBLY INSTRUCTION

## ITEM : CHAIR

Please read instructions carefully. Remove all wrapping material , staples and packing straps from the carton .  
Be sure you have all parts before ou start assembling . Place all wooden furniture parts on a clean and flat soft surface , such as carpet or rug to prevent from being scratched

CAUTION : 1)DO NOT FULLY TIGHTEN THE NUTS OR SCREWS INITIALLY UNTILL ALL THE NUTS AND  
2)SCREWS ARE ASSEMBLED . TO AVOID CAUSING DAMAGE TO THE TREAD , DO NOT OVER-TIGHTEN  
THE NUTS OR SCREWS .  
3)KEEP ALL HARDWARE PARTS OUT OF RECH OF CHILDREN .

### PARTS LIST

NO	DESCRIPTION	QTY
A	CHAIR BACK	1
B	FRONT LEG FRAME	1
C	SIDE RAIL	2
D	CUSHION	1

### HARDWARE LIST

NO	DESCRIPTION	QTY
1	JCBC BOLT M6 x 50mm	10
2	SPRING WASHER M6	10
3	CSK-CB SCREW M4 x 32mm	4
4	ALLEN KEY WITH BALL M4 x 110mm	1

### Step : 1

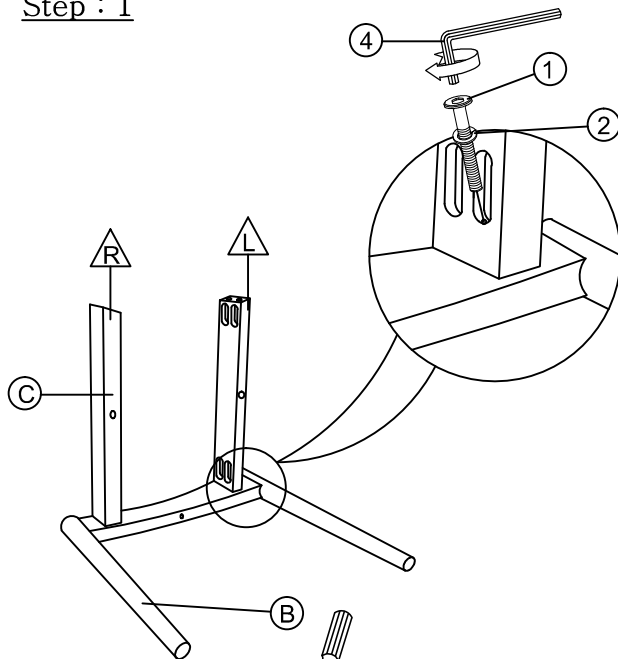

### Step : 2

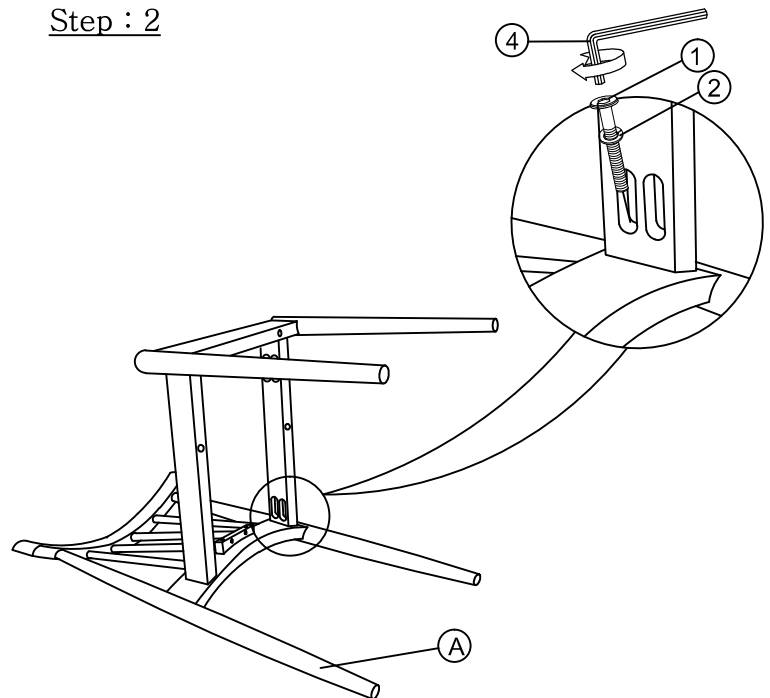

### Step : 3

