

Everly Home Inc

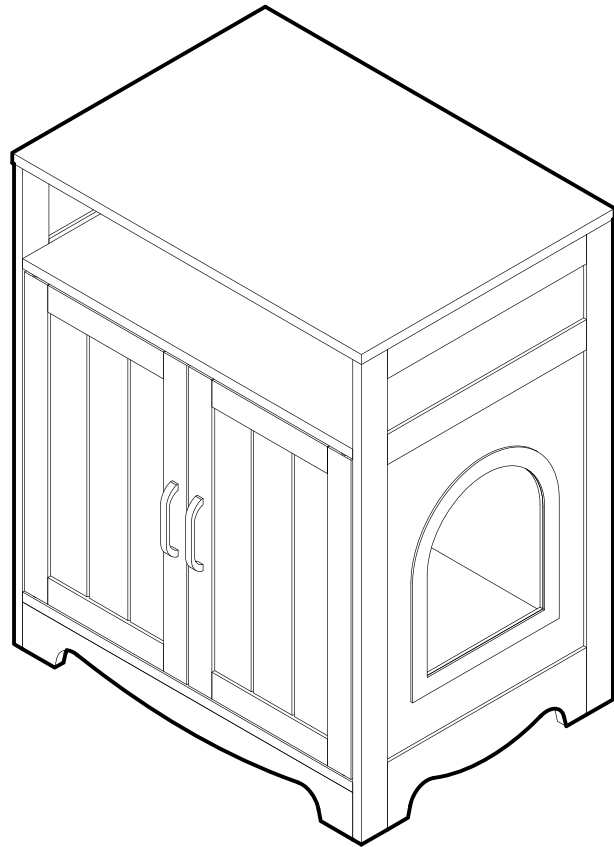

ASSEMBLY AND CARE INSTRUCTION

Cat Litter Box Enclosure Furniture

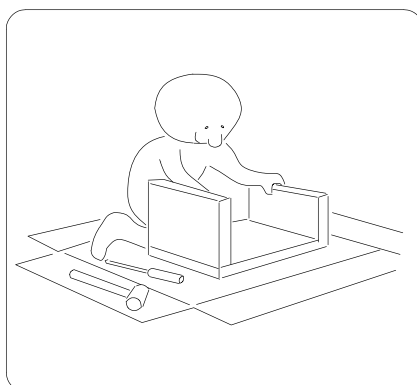
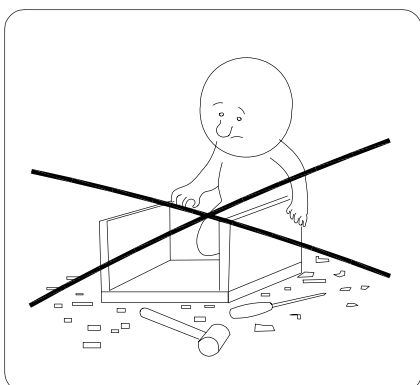
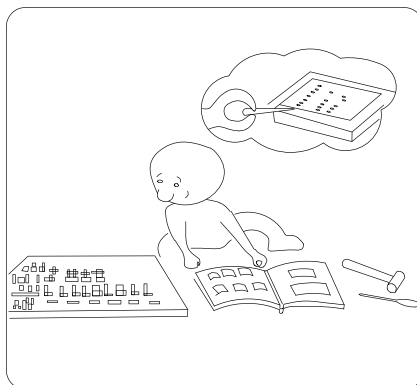
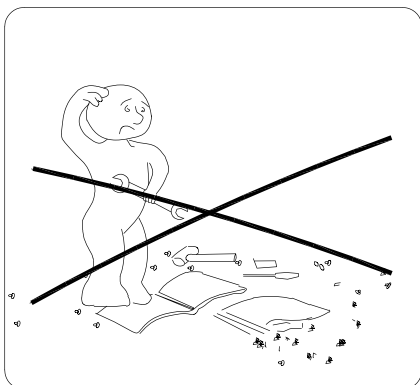
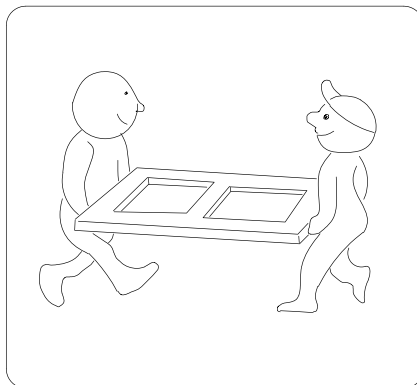
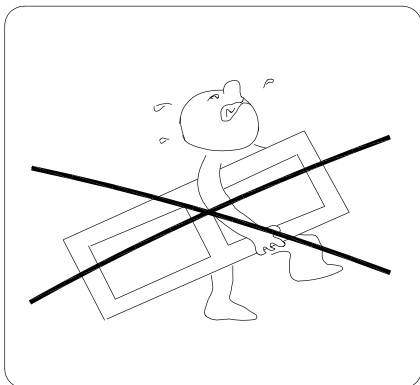
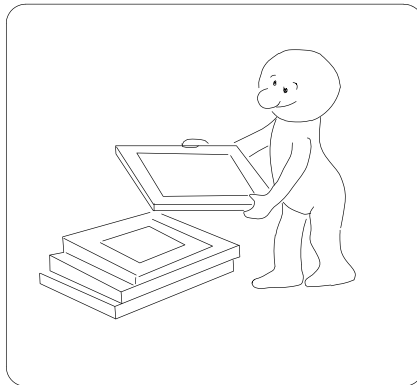
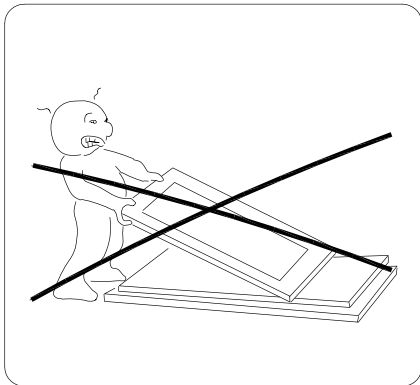
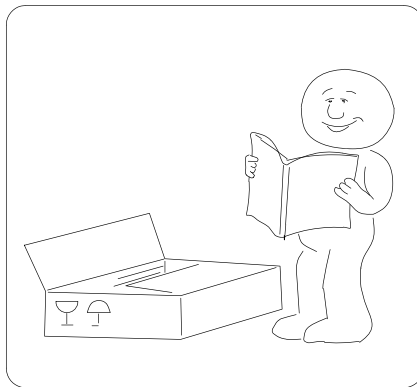
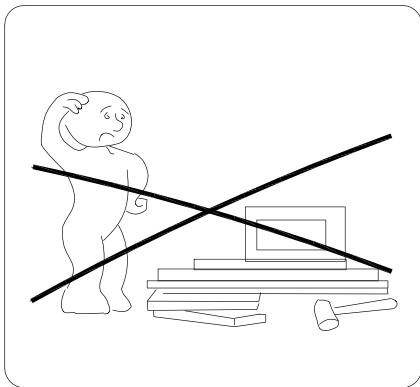

WARNING



1. PLEASE READ ALL INSTRUCTIONS CAREFULLY BEFORE STARTING ASSEMBLY.
2. DO NOT LET ANY SHARP OBJECTS TOUCH OR RUB THE SURFACE OF THE PRODUCT.
3. WHEN ASSEMBLING, DO NOT LET CHILDREN PLAY AROUND THE WORKING AREA.
4. PLEASE CONFIRM ALL PARTS ARE CORRECT BEFORE STARTING THE ASSEMBLY PROCESS.
5. DO NOT TIGHTEN ALL BOLTS AND SCREWS COMPLETELY UNTIL THE ENTIRE UNIT HAS BEEN ASSEMBLED AND SET UP.

ADVISE

1. DO NOT SIT OR STAND ON THIS PRODUCT. IT IS INTENDED FOR PETS ONLY.
2. THIS PRODUCT SHOULD BE ASSEMBLED BY AN ADULT.
3. PLEASE PUT THE PRODUCT ON A SMOOTH SURFACE AFTER YOU ASSEMBLED IT.
4. PLACE ALL PARTS ON A CLEAN AND SMOOTH SURFACE SUCH AS A RUG OR CARPET TO AVOID THE PARTS FROM BEING SCRATCHED.
5. THE SCREW OF HINGE ON THE DOOR ALSO CAN BE ADJUSTABLE, TO MAKE IT EVEN THEN TIGHTEN ALL SCREWS.

TOOL NEEDED

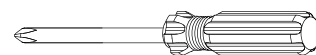

SCREWDRIVER REQUIRED
- NOT INCLUDED

PARTS

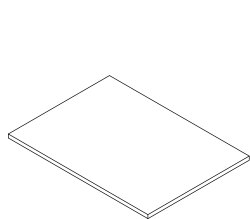
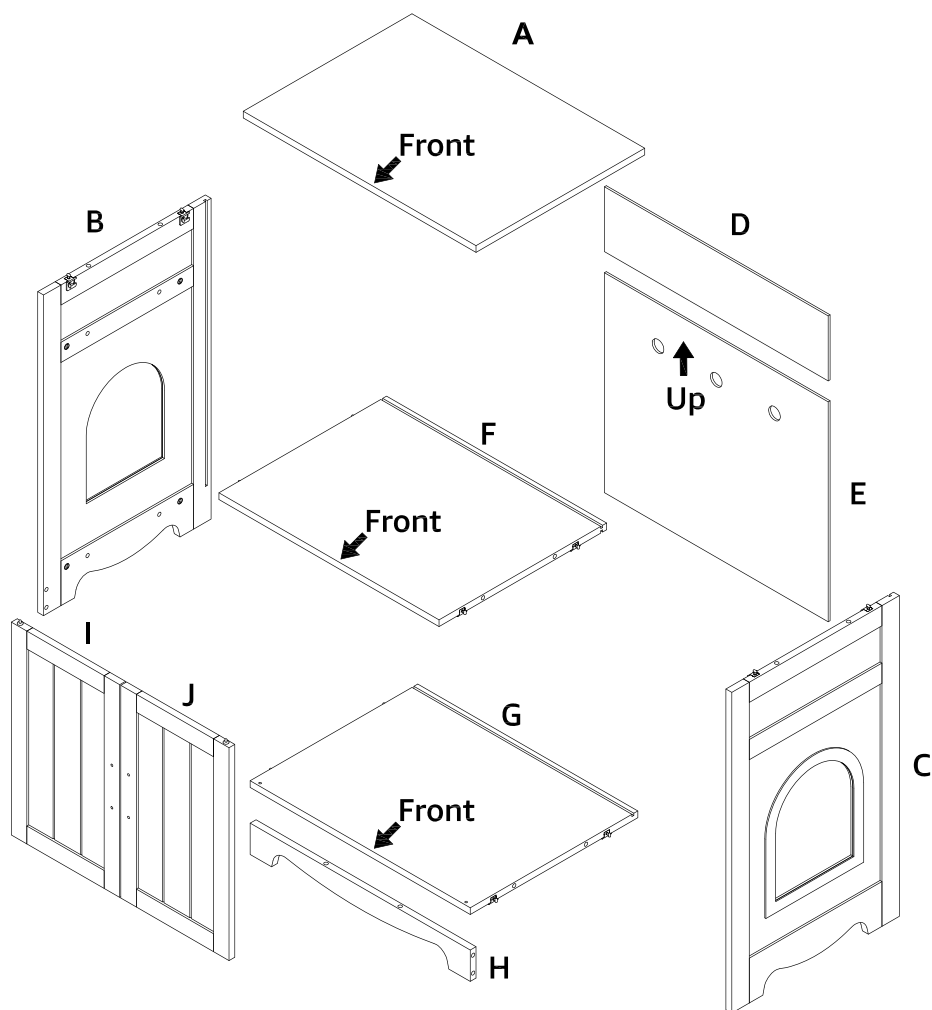

A
Top Panel
x1

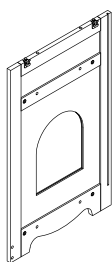

B
Left Side Panel
x1

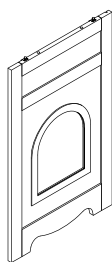

C
Right Side Panel
x1

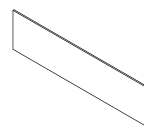

D
Back Panel
x1

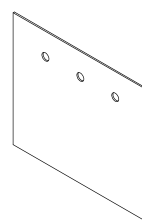

E
Back Panel
x1

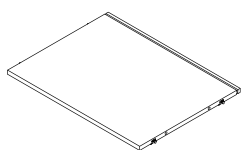

F
Shelf Panel
x1

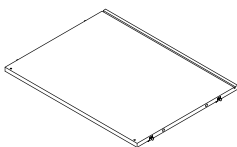

G
Bottom Panel
x1

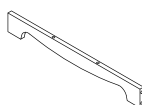

H
Bottom Apron
x1

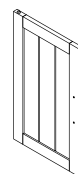

I
Left Door Panel
x1

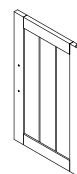

J
Right Door Panel
x1

HARDWARE



1

x 2 pcs



2

x 4 pcs



3

x 18 pcs

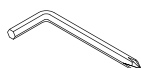

4

x 1 pc



5

x 4 pcs



6

x 4 pcs



7

x 1 pc

ASSEMBLY INSTRUCTIONS

1

Insert six wooden dowels 3 to left side panel B.

Insert two wooden dowels 3 to bottom panel G, connect bottom apron H to bottom panel G.



3

x 8 pcs

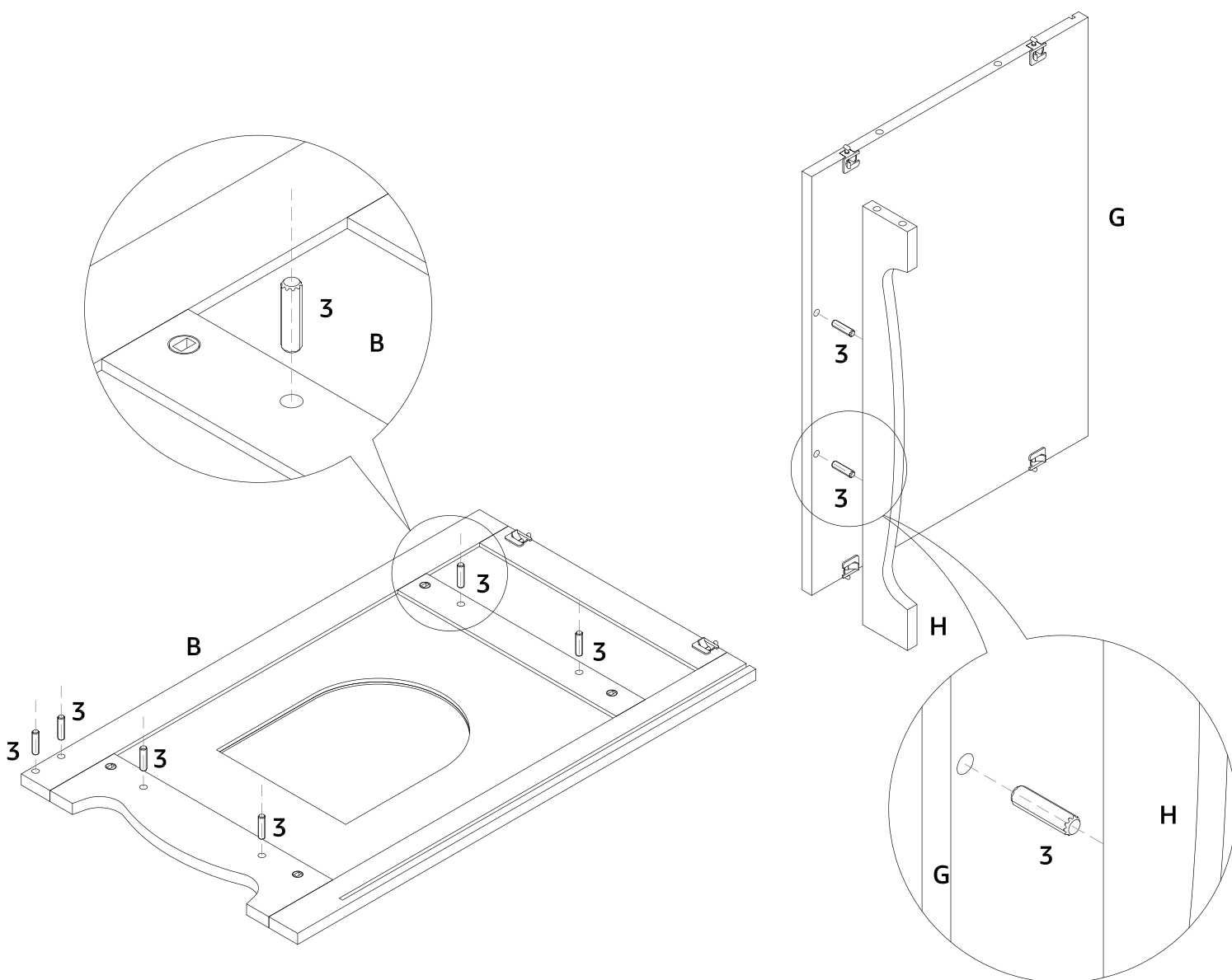

2

Connect bottom panel G and bottom apron H to left side panel B, lock down two hardware.

Connect shelf panel F to left side panel B, lock down two hardware.

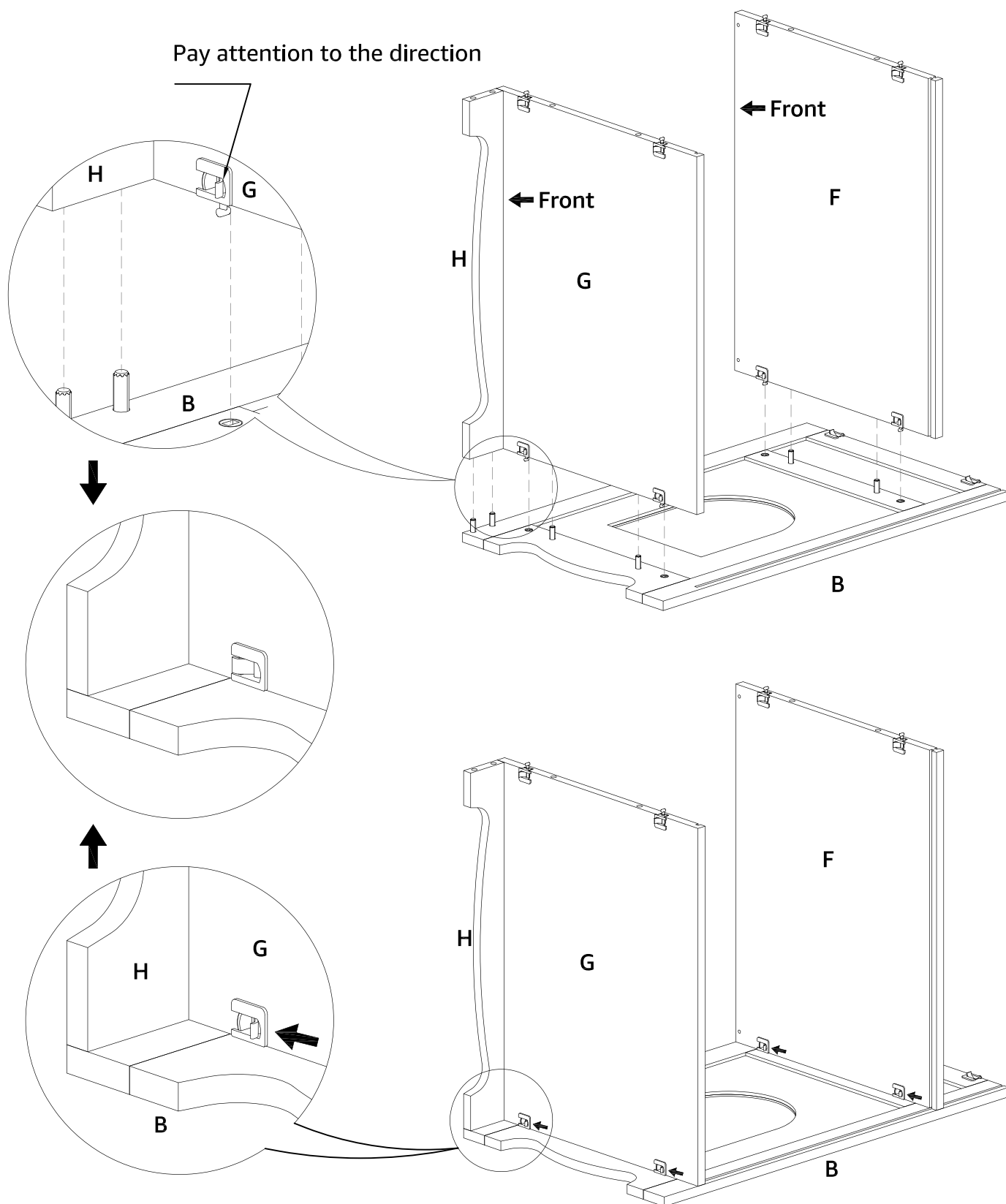

- 3** Insert back panel E to the bottom panel G and shelf panel F.
Insert six wooden dowels 3 to bottom panel G and bottom apron H and shelf panel F.

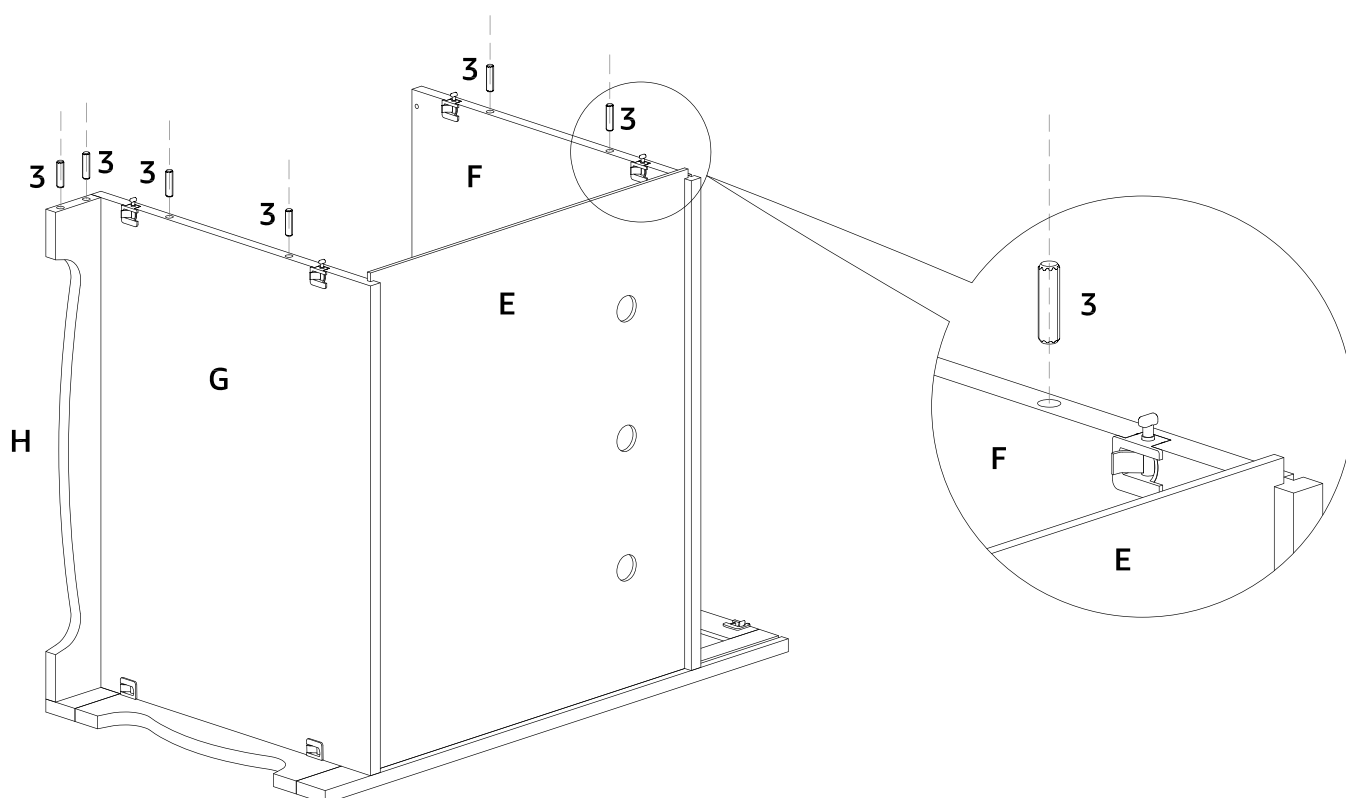
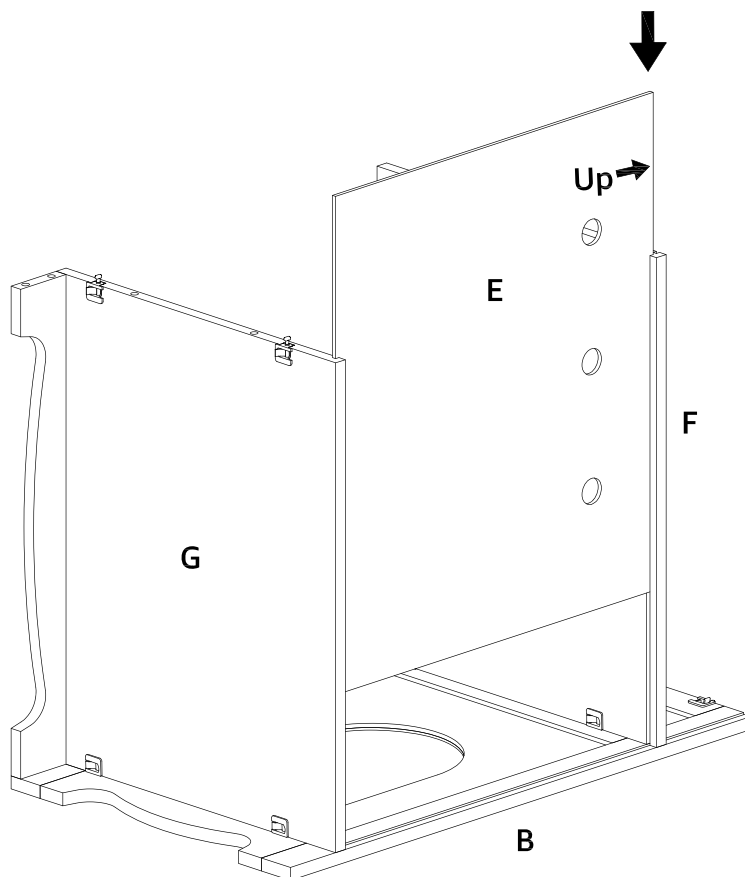
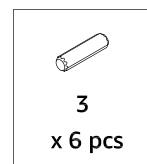

4

Connect right side panel C to shelf panel F, bottom panel G, bottom apron H and back panel E.
Lock down four hardware.

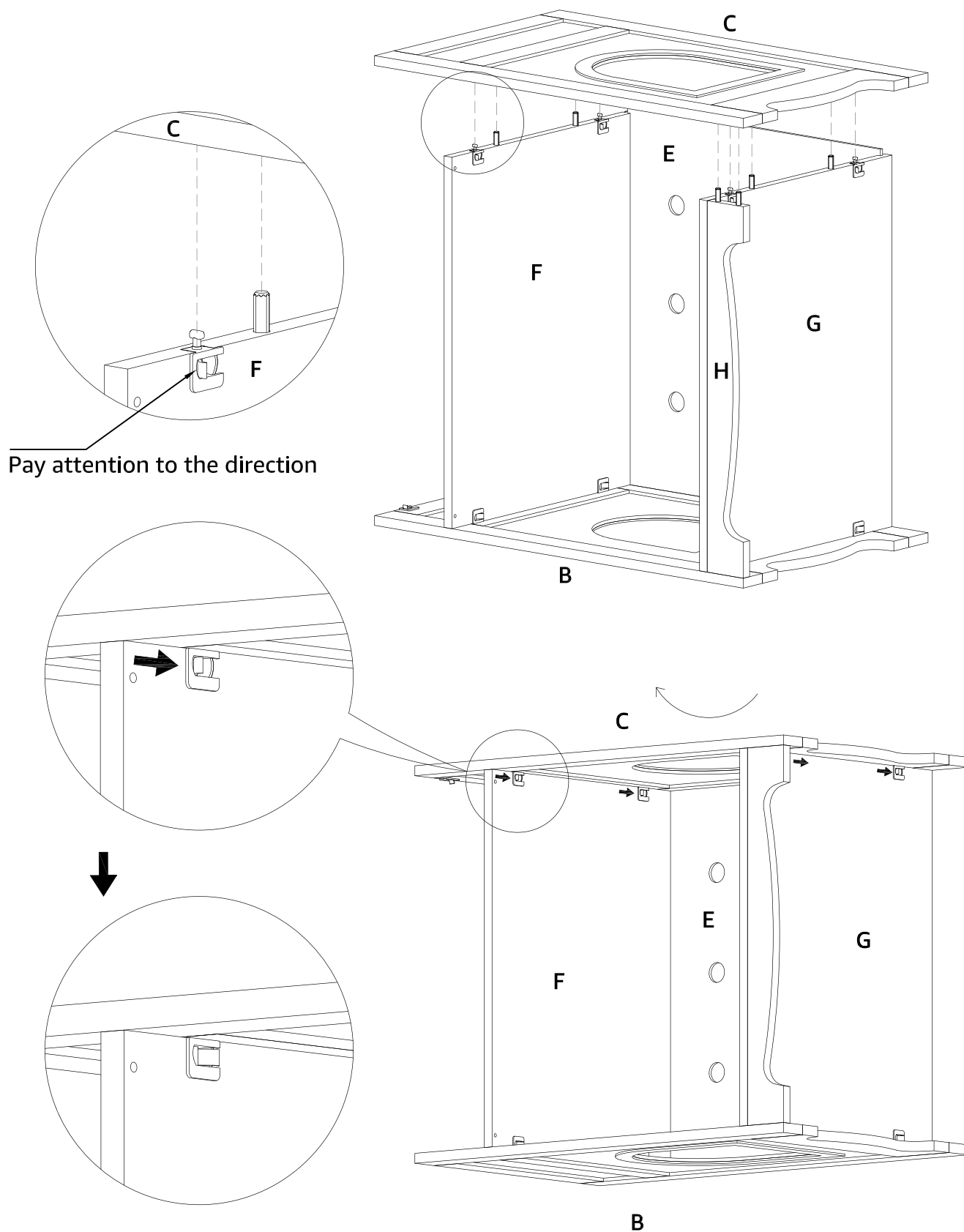

5

Insert back panel D to left and right side panel B and C.
Insert four wooden dowels 3 to left and right side panel B and C.

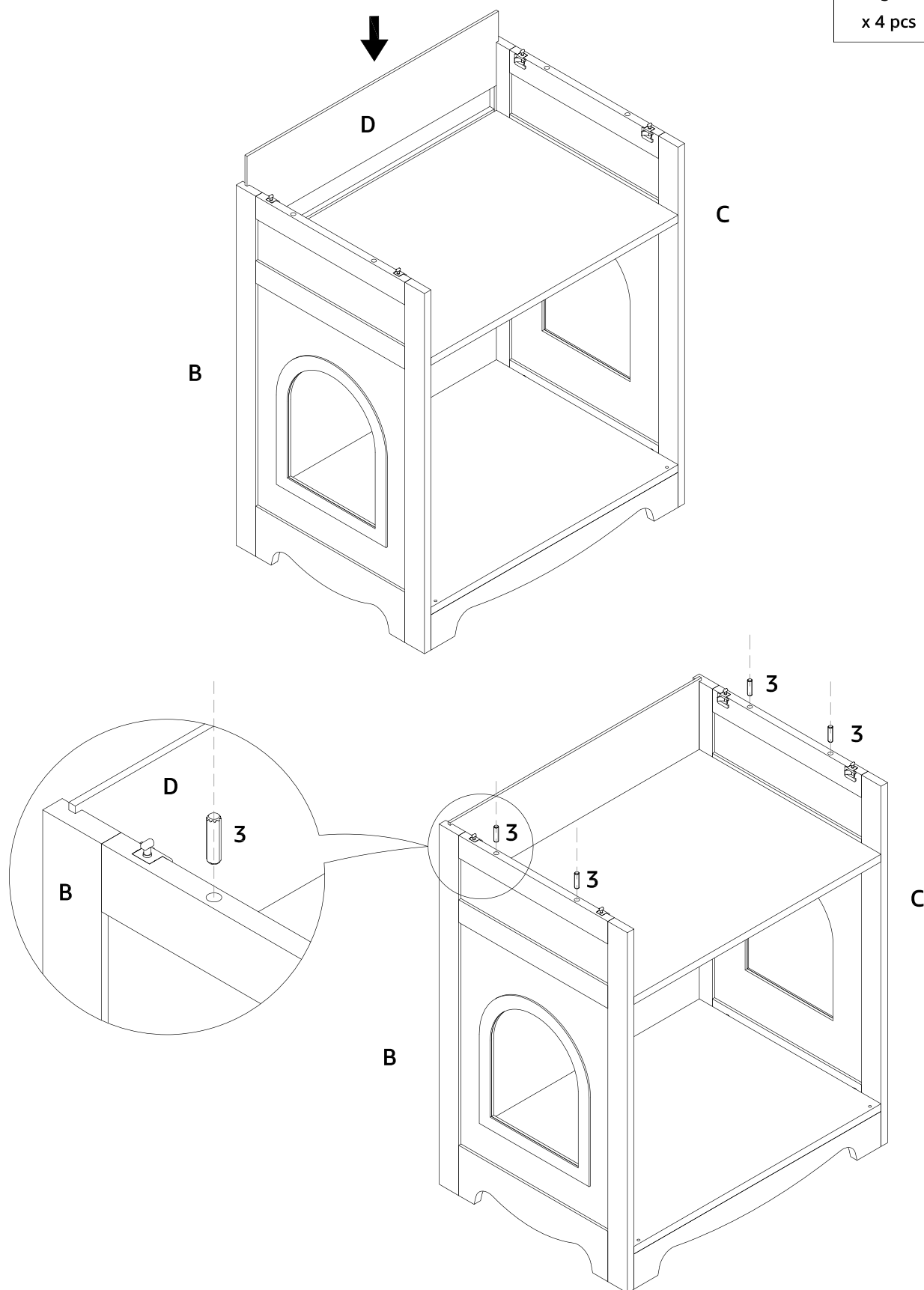
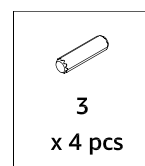

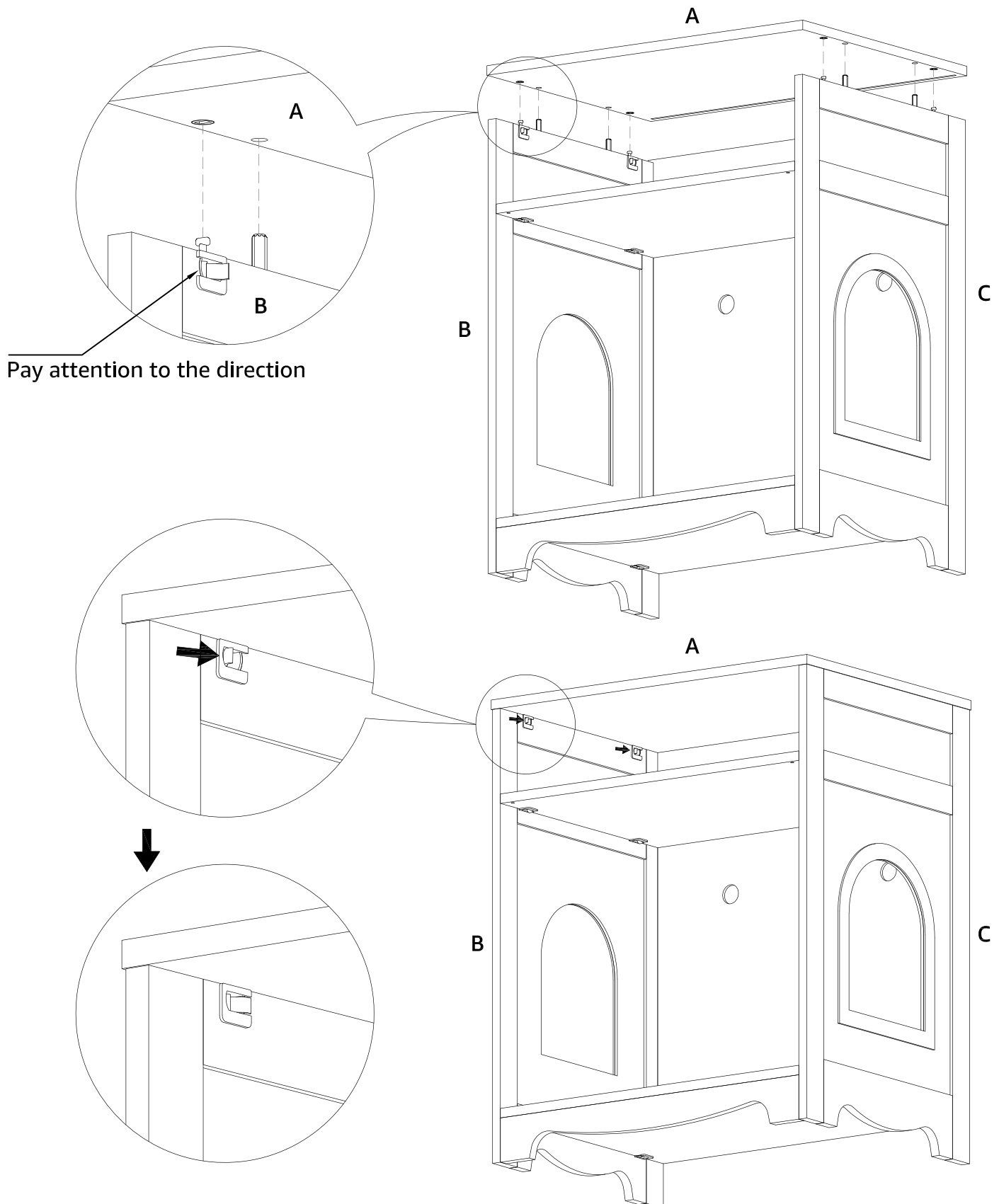

6

Connect top panel A to left and right side panel B and C.
Lock down two hardware on left side panel B.

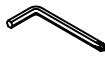

- 7** Then lock down other two hardware on right side panel C.
Attach two handles 1 to the door I and J with four screws 2.

		
1	2	4
x 2 pcs	x 4 pcs	x 1 pc

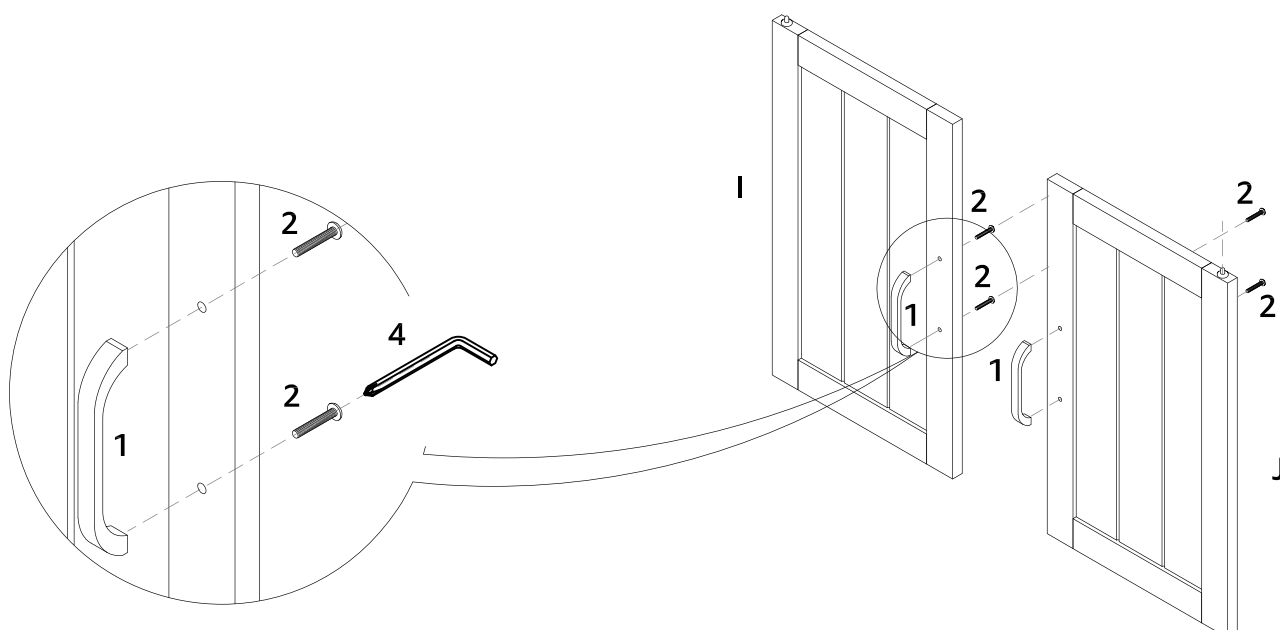
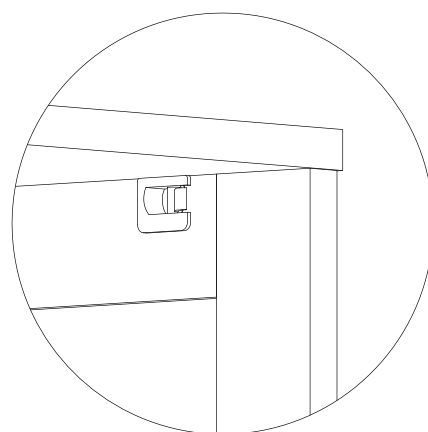
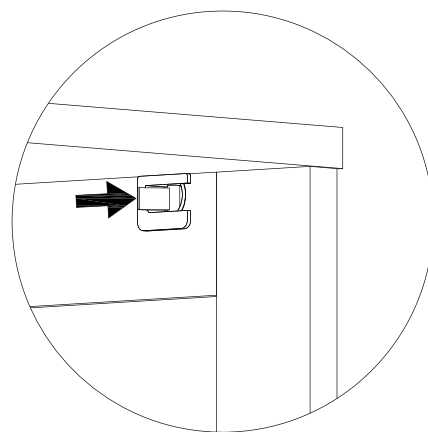
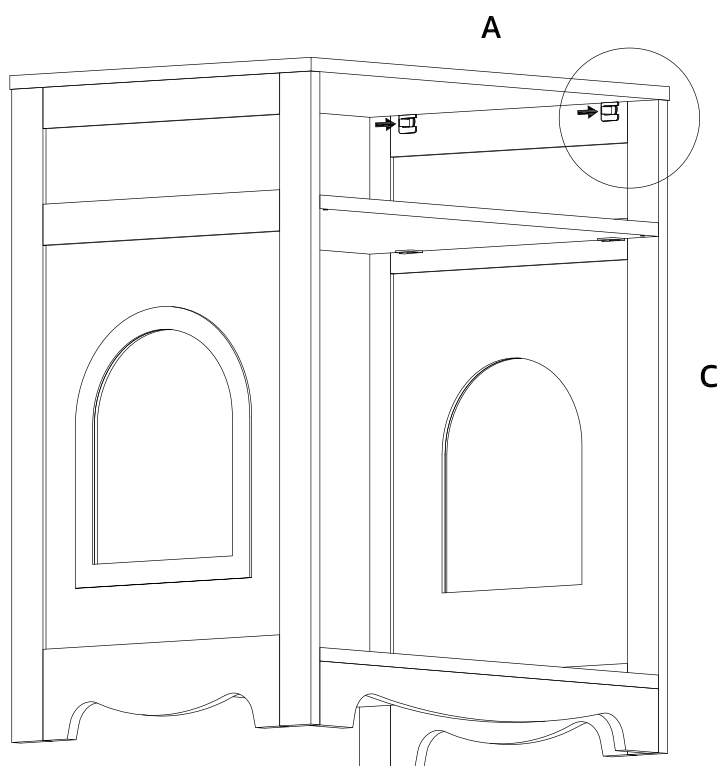

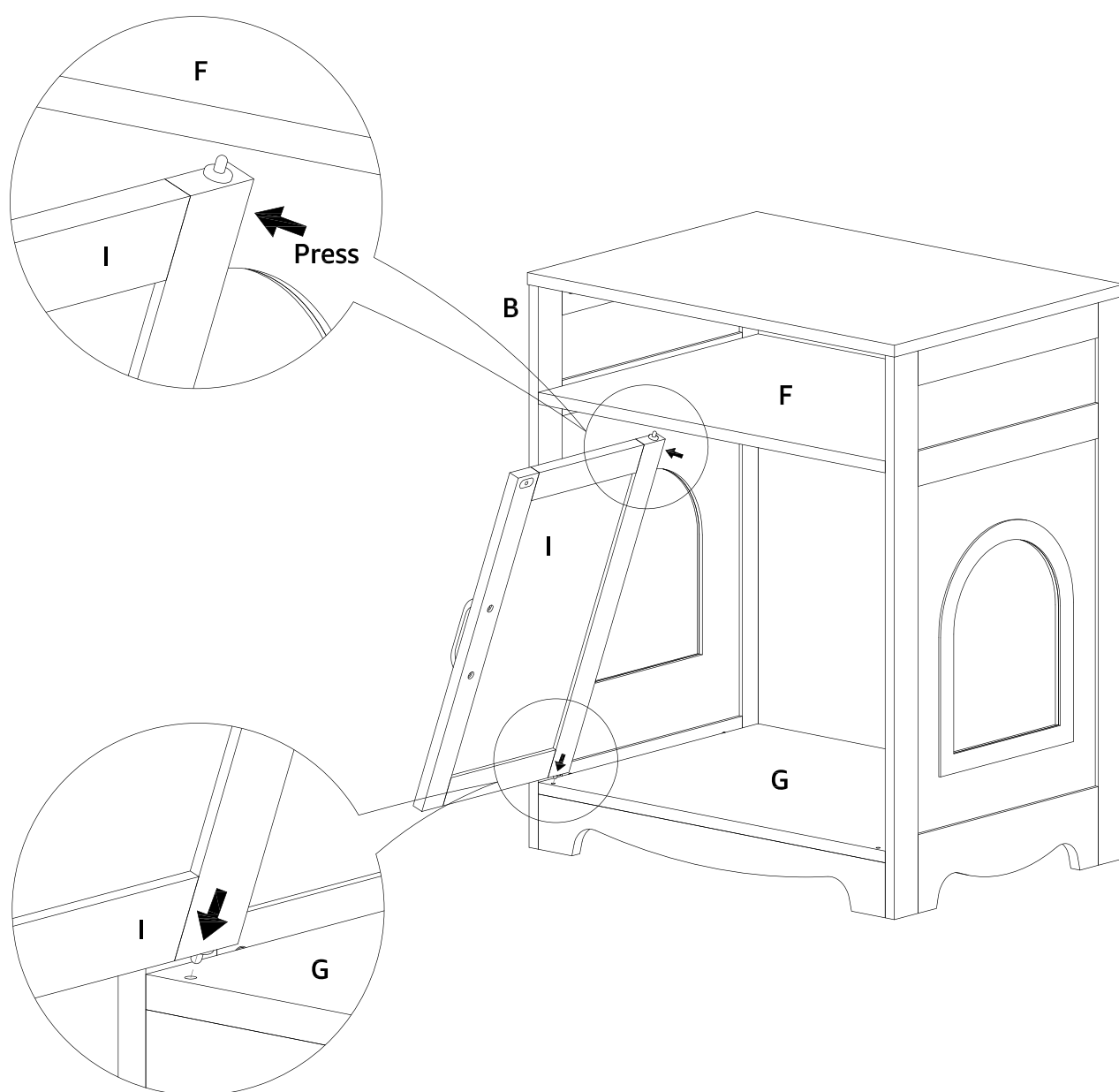

- 8 Insert the bottom part of door spindle to the hole on bottom panel G, press top part of door spindle and attach to shelf panel F.



9

Insert the bottom part of door spindle to the hole on bottom panel G, press top part of door spindle and attach to shelf panel F.
Insert part 6 to the four corner of back panel E, screw 5 to part 6.

	
5 x 4 pcs	6 x 4 pcs

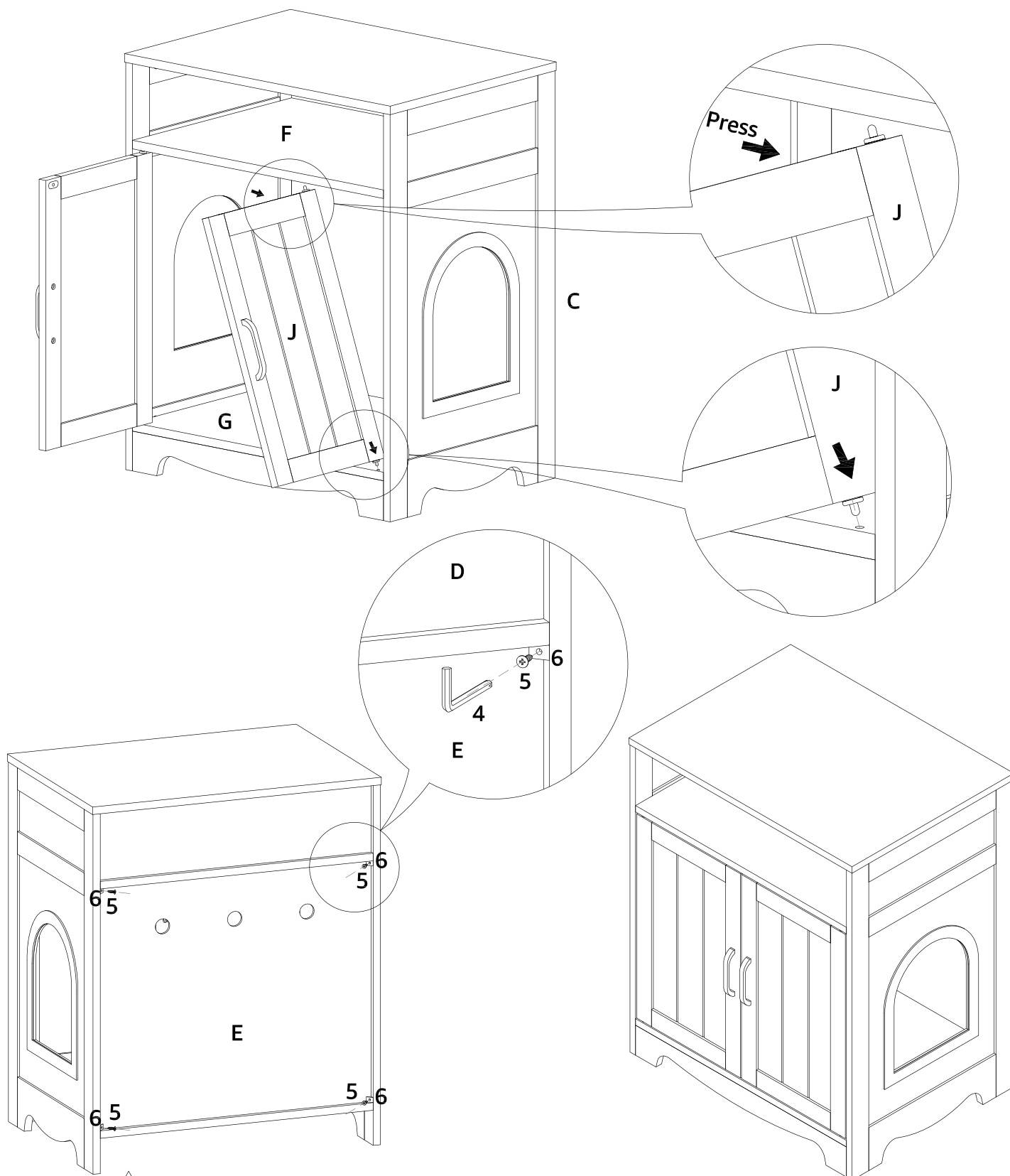

If any hardware has come loose, please stick it with white glue 7.