

ASSEMBLY INSTRUCTIONS

Parts:

Left Side



Right Side

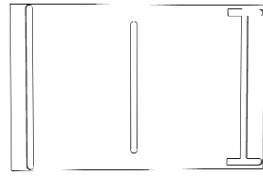

Top Piece



Center Shelf



(26) Hex Screws



Bottom Piece



Small Shelf



Allen Wrench



Right Divider

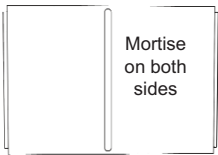

Mortise
on both
sides

Left Divider

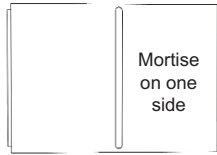

Mortise
on one
side

(2) Rails



Do Not Drill!

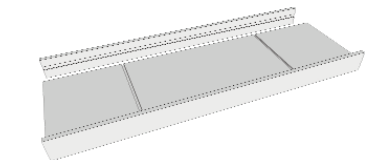

Step 1: Insert edges of **Top** into mortise on **Rail**. Insert hex screws into pre-drilled holes in **Rail**. Tighten down halfway. Repeat for remaining **Rail**.

Step 2: Insert edge of **Top Piece** into mortise of **Right Side**. Insert hex screws into each of the pre-drilled holes in **Right Side**. Tighten down halfway.

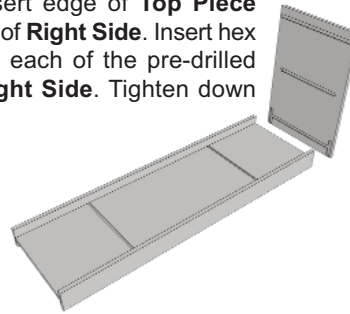

Step 3: Insert edge of **Center Shelf** into mortise of **Left Divider**. Insert hex screws into each of the pre-drilled holes in **Left Divider** and tighten halfway.

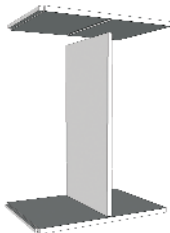
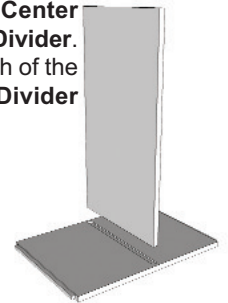

Step 4: Insert edge of **Center Shelf** into mortise of **Right Divider**. Insert hex screws into each of the pre-drilled holes in **Right Divider**. Tighten down halfway.

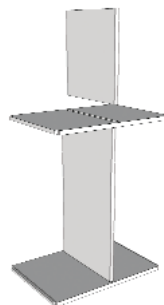

Step 5: Insert edge of **Small Shelf** into mortise of **Right Divider**. Insert hex screws into each of the pre-drilled holes in **Right Divider**. Tighten down halfway.



Step 6: Insert edges of **Right Divider** and **Left Divider** in dados of **Bottom Piece**. Insert hex screws into each of the pre-drilled holes in **Bottom Piece**. Tighten down halfway.

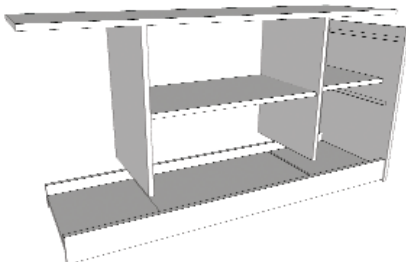

Step 7: Insert edge of **Bottom Piece** and **Small Shelf** into remaining mortises of the **Right Side**. Insert edge of each **Divider** and into the corresponding mortise on **Top Piece**. Insert hex screws into pre-drilled holes of **Right Side**. Tighten down halfway.

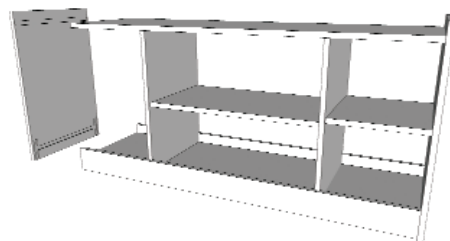

Step 8: Insert edge of **Top Piece**, **Rails**, and **Bottom Piece** into mortise of **Left Side**. Insert hex screws into each of the pre-drilled holes in **Left Side**. Tighten down halfway.

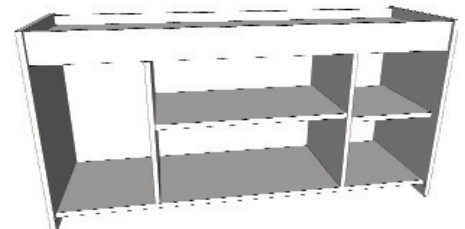

Step 7: Tighten all screws snugly. DO NOT OVERTIGHTEN. Rotate unit so that it rests on **Bottom Piece** and edges of **Side Pieces**. **Assembly is now complete.**