

# Aroma Diffuser

## User Manual

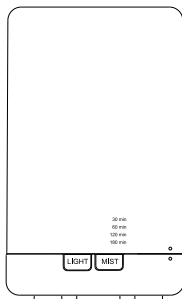

**This Aroma Diffuser uses Ultrasonic waves to instantly vaporize water and essential oil in the tank, to produce a cool, dry fragrant mist.**

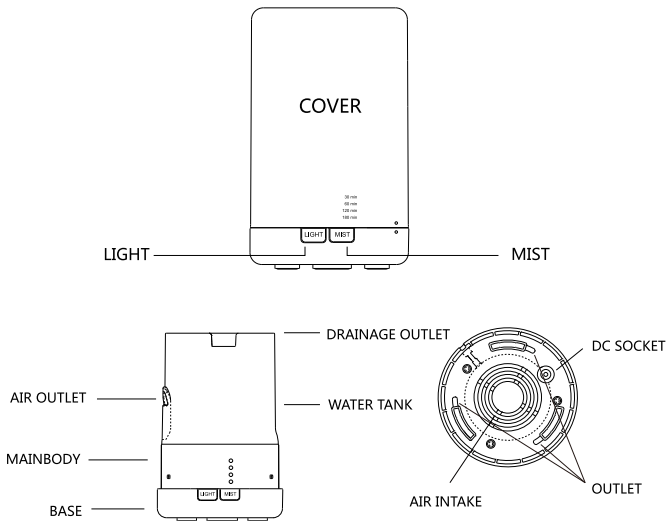

## OPERATION

1. Please put the product upside, and remove the upper cover. **FIG1**
2. Please connect the AC adaptor to the base of DC jack of the main body via cable guide. **FIG2**
3. Please use the measure cup to supply water from the water pipe. Please take care, do not pour water out of the cup and fill water into the water tank with measuring cup. **FIG3**

- Pay attention to the filled water level; do not exceed the max line on the water tank.
- Water with high temperature and the mist may fly out, please never fill in water during operating.

4. Drop essential oil into water tank vertically. **FIG 3**,  
The dosage is about 2-3 drops (about 0.1-0.15ML)

5. Install the cover of the main body with the original channel.

**BTW:** You must cover the upper cover when you want to use the product. **FIG 4**

6. Please connect the AC adaptor with family user power supply socket.

7. If you press the **MIST** switch on main body of the product, mist function is on. You can set up the timer, each time you press down this button; the timer will be changed between 30 minutes, 60 minutes, 120 minutes, 180 minutes and OFF. **FIG 6**

When the power supply is connected, the original state is OFF.

If there is few water in the water tank, the power supply will turn off immediately even with power connected.

- If the timing mode is off, LED light will be off at the same Time.
8. If you press the **LIGHT** on, you can chose ON/OFF state of the LED light. If you press this button for each time, the light color and lightness will be changed. **FIG5**
  9. If you do not use it for a long time, please drain out the water from tank water, dry and then keep it well. If you want to user it again, please use the neutral detergent to clean the water tank again, then you can use it.

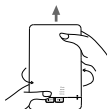

FIG3



FIG5

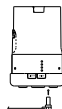

FIG2

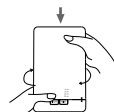

FIG4



FIG6

## ATTENTION

- The amount and intensity of mist produced will vary, but this is not unusual and should not be considered as a fault.
- Factors that affect this include water type, humidity, temperature, air currents.
- If there is no water in the Tank, pressing the **MIST** will cause the unit to “beep” 3 times to remind you to add water. The unit will not work without water.
- Only 100% natural essential oil can be used in this product. Those containing chemical fragrance, spice or impurities will cause malfunction. Use 3-5 drops per 100ML water a time. Too much oil will clog the system and cause malfunction. Please clean the unit as per the maintenance instructions, before changing to use a new type of essential oil.

## ACCIDENTAL LEAKAGE

In the event of the unit being knocked over or tipped during use, please follow the steps as below to avoid malfunction.

- Unplug the unit and remove cover.
- Pour out any remaining water out of the water tank from.
- Shake the unit gently to drain any water inside the mechanism, and then allow drying for at least 24 hours.

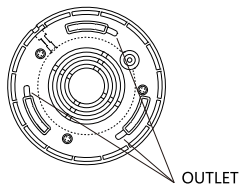
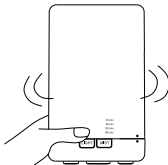
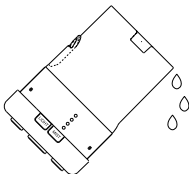

## MAINTENANCE

After using 5-6 times, or 2-3 days, please clean the product as follows.

- Unplug the unit from mains supply and remove cover.
- Pour out any remaining water from the "DRAIN SIDE" of the tank.
- Unplug power cord from base of unit.
- Put 1 tablespoon of citric acid in the water tank, add just under 70 ML of warm water (up to 70°C)
- Leave for 5 minutes, and then drain solution from the "DRAIN SIDE" of the tank.
- Wipe with a soft cloth. Avoid Ultrasonic Vibration plate area, which can be gently cleaned with a cotton bud.

**Never use other acids, enzymes or detergents, as this may risk poisonous gas to be created or cause malfunction.**

Cover has an inner cover that can also be removed for cleaning.

1. Pull grip as indicated in the diagram to release.
2. After cleaning inner cover, replace by holding grip, and pressing down inner and outer cover until "click" is heard.

AIR OUTLET

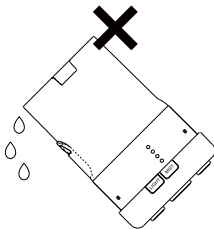
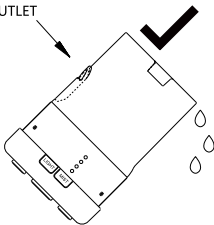

## PRECAUTIONS

Please check below to avoid malfunction of the unit.

- Do not fill over 70 ML “MAX” at any time.
- Do not switch on power when the tank is empty.
- Do not touch the Ultrasonic vibration plate.
- Clean regularly as per Maintenance instructions to avoid malfunction.
- Always unplug from power supply before maintenance.
- For hygiene reasons, after use, pour away remaining water from “**DRAIN SIDE**” of tank, and wipe with a clean dry cloth.
- Essential oils can stain. In the event of spillage of contact, please wipe away with a soft cloth.
- Only use the measuring cup provided to add water to the tank. Never fill directly from the tap.
- Do not let mist blow directly onto furniture, clothing, walls etc.
- Keep away from directing sunshine heat sources and air conditioners or fans.
- Always keep on stable flat surface do not place on carpet, duvet or unstable area.
- Keep away from electronic equipment, such as TV and Audio equipment.
- Do not tip the product this may cause water to enter the mechanism and cause malfunction.
- Do not use for more than 3 hours any time.

Wait 60 minutes before restart to avoid damage to Ultrasonic plate.

- Use tap water only, does not use mineral water, sparkling water etc.
- The amount and intensity of mist produced will vary, but this is not unusual and should not be considered as a fault.

Factors that affect this include water type, humidity, temperature, air currents.

- Never move product in use.
- Do not touch any part of the product with wet hands.
- Keep out of reach of children and pets. Also, children being supervised not to play with the product. Appliance is not to be used by children or persons with reduced physical, sensory or mental capabilities, or lack of experience and knowledge, unless they have been given supervision or instruction.
- Keep cord clear of pathways, and do not pull forcefully at any point.
- If smoke or burning smell is detected, unplug immediately.

## TROUBLESHOOTING

Please refer to the table below in the event of the product operating abnormally

Symptom	Possible Cause	Solution
Will not switch on-switch off early	<ul style="list-style-type: none"> <li>Is there enough water in the tank?</li> <li>Is the power cord connected properly?</li> </ul>	<ul style="list-style-type: none"> <li>Add water to the tank</li> <li>Disconnect, check cables and re-connect carefully.</li> </ul>
No mist or abnormal mist	<ul style="list-style-type: none"> <li>Not enough water?</li> <li>Too much water?</li> <li>Dirt on the Ultrasonic plate?</li> <li>Cover and inner cover are not installed properly?</li> <li>Dirt on the air suction port on the underside of the base?</li> </ul>	<ul style="list-style-type: none"> <li>Add suitable amount of water in the tank.</li> <li>Water must never be filled over 70 ML (MAX) line.</li> <li>Please refer to Maintenance instructions Remove and re-install correctly, so vapors can be released freely.</li> <li>Clean the air suction port of any dust.</li> <li>Restricted airflow will affect mist.</li> </ul>
Water leakage from product	<ul style="list-style-type: none"> <li>Cover and inner cover are not installed properly?</li> <li>Has the unit been tipped over?</li> <li>Low temperature or high humidity?</li> </ul>	<ul style="list-style-type: none"> <li>Remove and reinstall correctly, so vapors can be released freely.</li> <li>Follow accidental leakage instructions.</li> <li>Under these conditions, the mist may condense quickly into water droplets.</li> </ul>

## SPECIFICATIONS

Dimensions	Approx 75 x 130MM
Weight (excluding adaptor)	Approx 170g
Power: Input / Output	AC100-240V 50/60 Hz / DC 5V 1000mA
Length of cord	Approx 150CM
Electric consumption	Approx 4W
Time Mode	30min/60min/120min/180min
Tank Capacity	70ML
LED light	6 Bulbs
Materials	Upper parts PP
Accessories	USB Line
Method of mist production	Ultrasonic vibration at approx 3.0MHz