

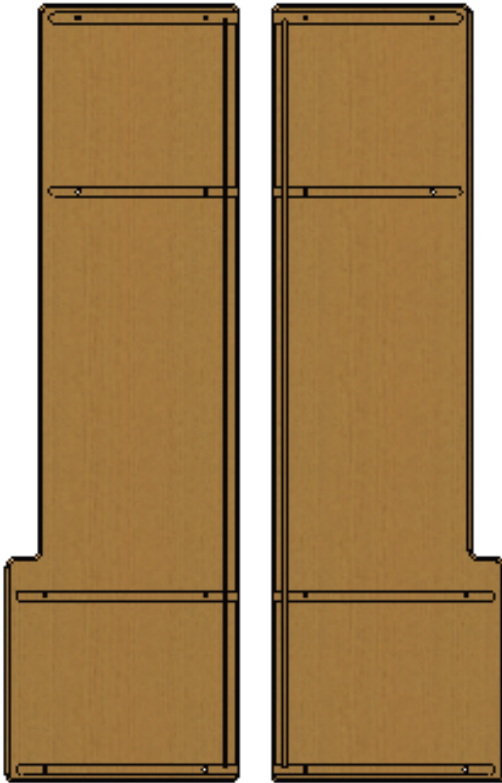

C51003 ASSEMBLY INSTRUCTIONS

Parts:

Set of Sides



Seat



Top



Bottom



Shelf



(3) Backs



(2) Divider



**For assistance, call: Customer Service
1-800-247-8465**

(6) Double
Hooks w/
hardware



Hardware:

(24) Hex
screws



(1) Allen wrench



Phillips Head Screwdriver
(Not included)



Step 1: Using predrilled holes in Dividers and Sides, attach **Hooks** to **Dividers** and **Sides** using supplied hardware and screwdriver not included. **(12) gold screws** used total.

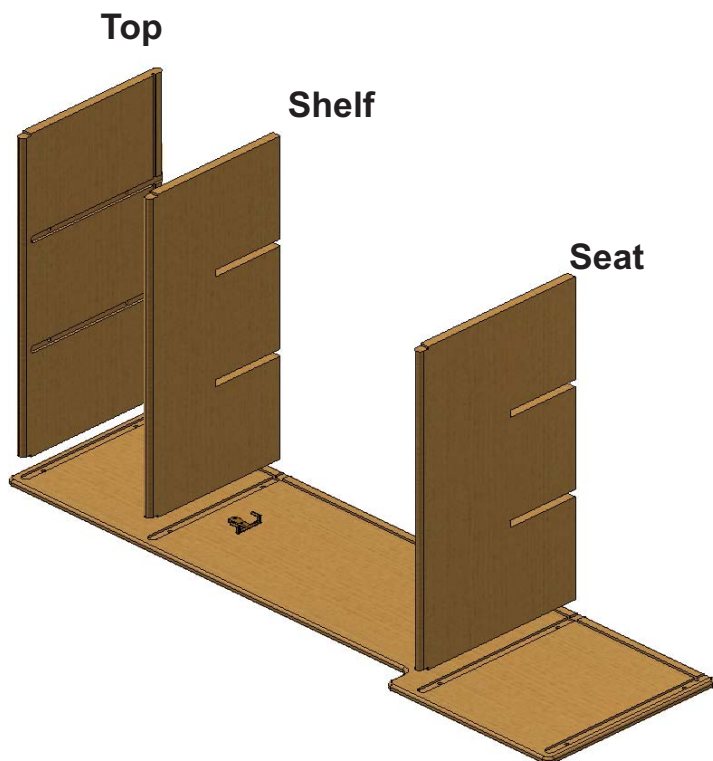
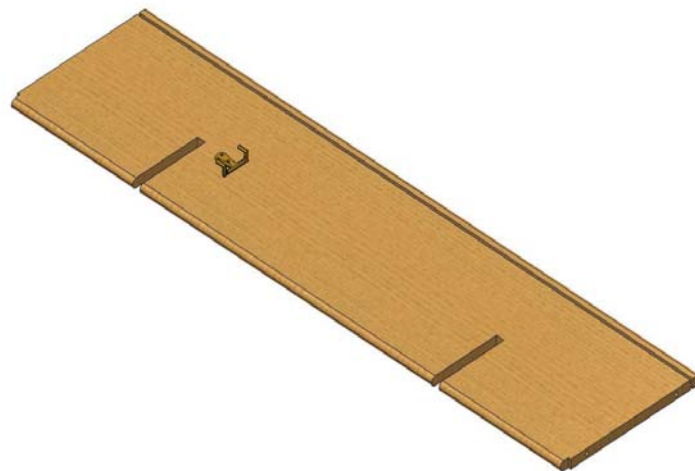

Step 2: Attach **Top**, **Seat**, and **Shelf** to **Left Side** piece. Align back groove in Top with back groove in Left Side. This will act as guiding system for Back in later step. Attach each component to Left Side using **(2) Hex screws** and Allen wrench. **(6) Hex screws** used in this step.

Step 3: Slide in **Dividers** from back side. **(4) Hex screws** and Allen wrench used in this step. Divider attaches to Top only. Back groove in Divider aligns with back groove in Top. Shelf and Seat sit flush with front edge of back groove. **(4) Hex screws** and Allen wrench used in this step.

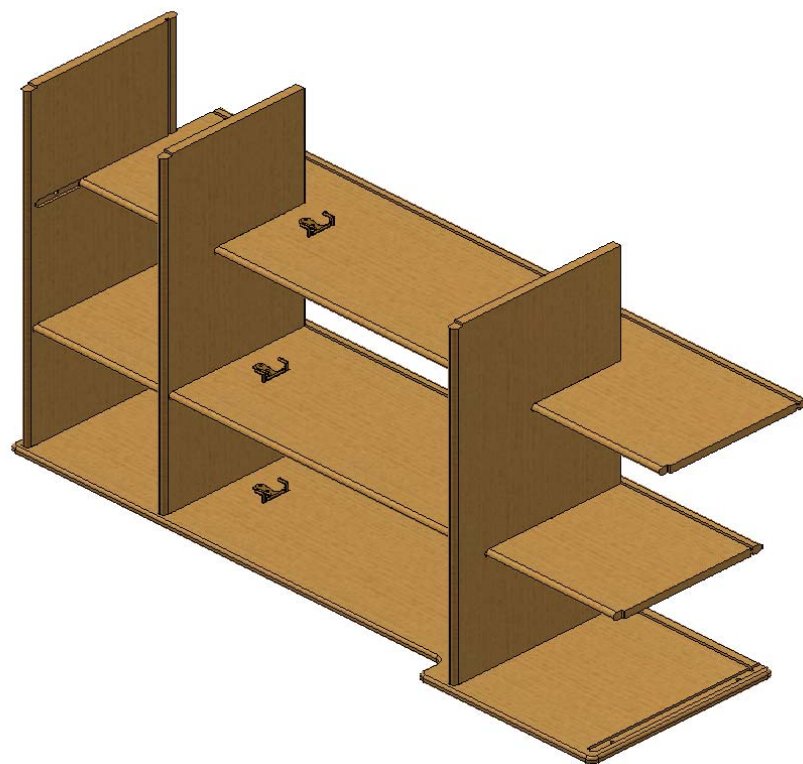

For assistance, call: Customer Service 1-800-247-8465

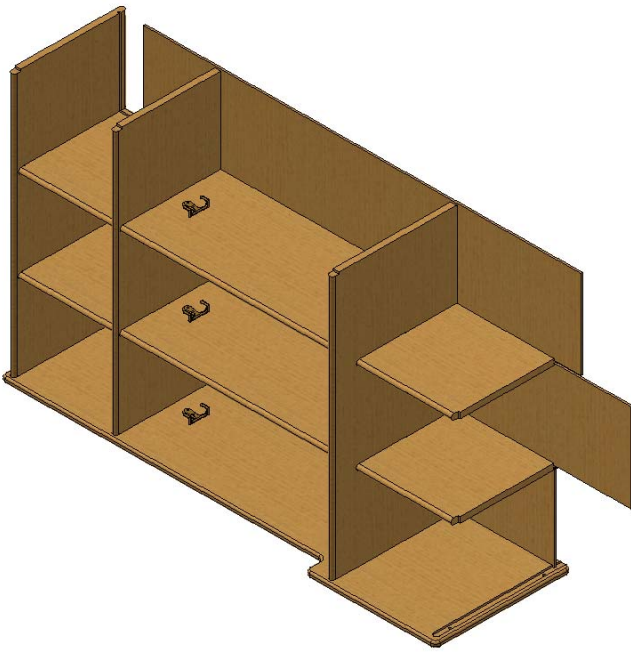

Step 4: Slide in **all Backs**. No hardware required in this step. Backs will sit in grooves of Dividers, Top, and Left Side. Loosening of Seat and Shelf may be needed to slide backs along grooving in Left Side and Divider.



Step 5: Attach **Bottom**. Grooves in Bottom fit over Backs and Divider. **(6) Hex screws** and Allen wrench used in this step.

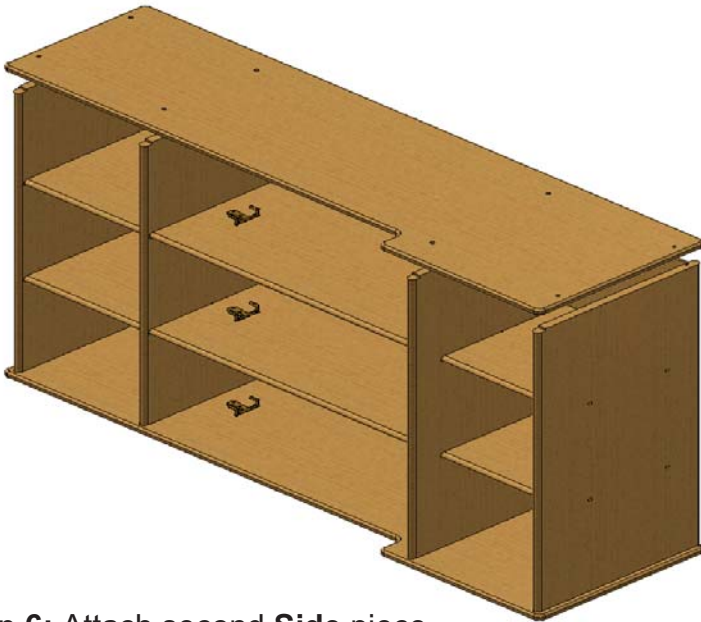

Step 6: Attach second **Side** piece using **(8)** supplied Hex screws and Allen wrench. Grooves in Right Side overlap previously assembled components.

Step 7: Set unit upright, resting edges of Sides on floor. Tighten all screws snugly. **DO NOT OVER-TIGHTEN. DO NOT DRILL.** Assembly is now complete.



For assistance, call: Customer Service 1-800-247-8465