

Office Chair Assembly Manual

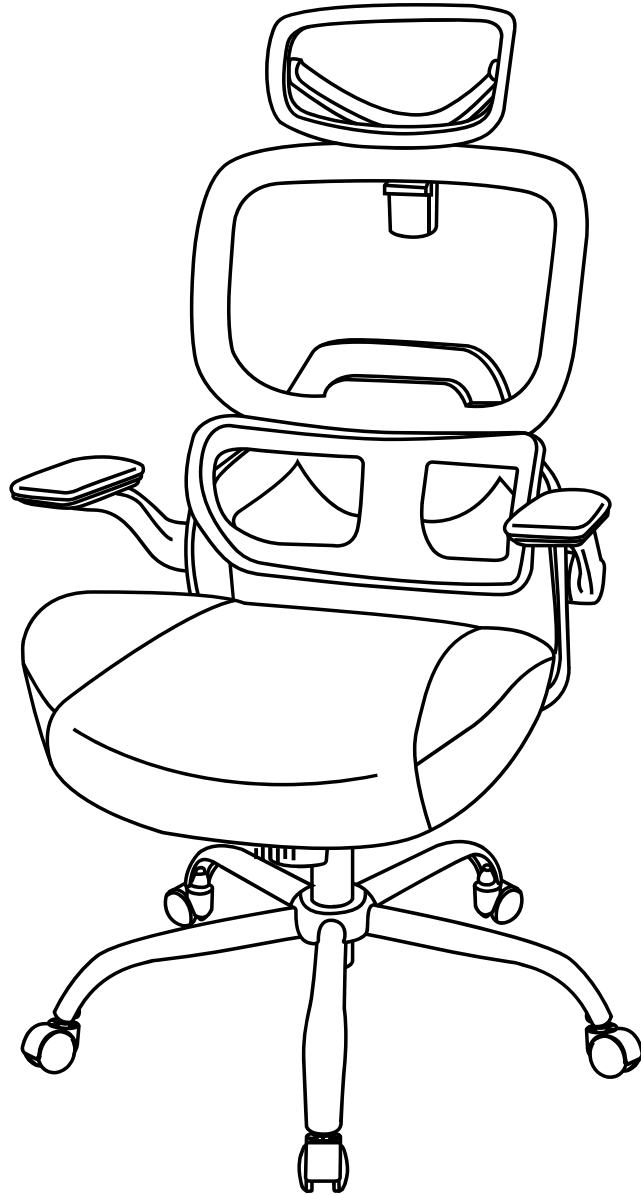

Instruction Manual

Contents

Make sure that the package contains the following parts:

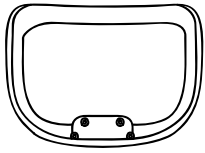

1 Upper Back(1)

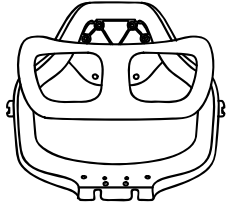

2 Lower Back (1)

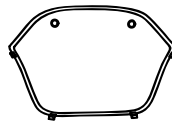

3 Rear Cover Plate(1)

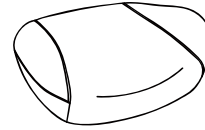

4 Seat Cushion(1)

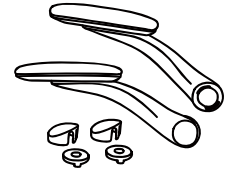

5 Arms(2)

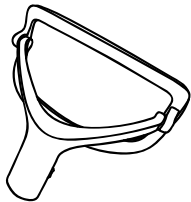

6 Headrest(1)

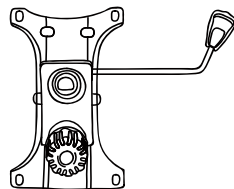

7 Seat Plate(1)

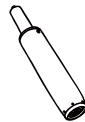

8 Gas Lift(1)

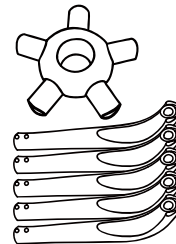

9 Star Base(1)

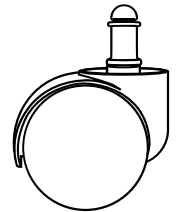

10 Casters(5)

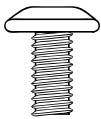

Bolts M6 × 14mm(10)

A

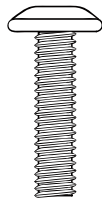

Bolts M6 × 25mm(6)

B

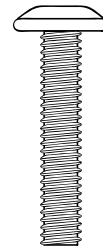

Bolts M6 × 30mm(4)

C

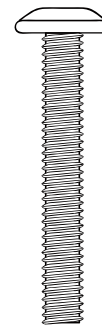

Bolts M6 × 50mm(4)

D

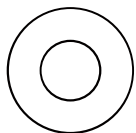

Washers M6 × 15mm(4)

E

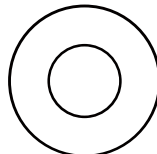

Washers M6 × 18mm(8)

F

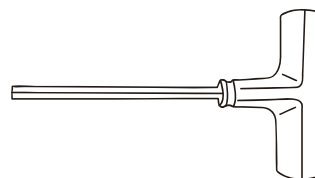

Wrench(1)

G

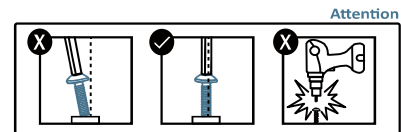

Attach The Bottom

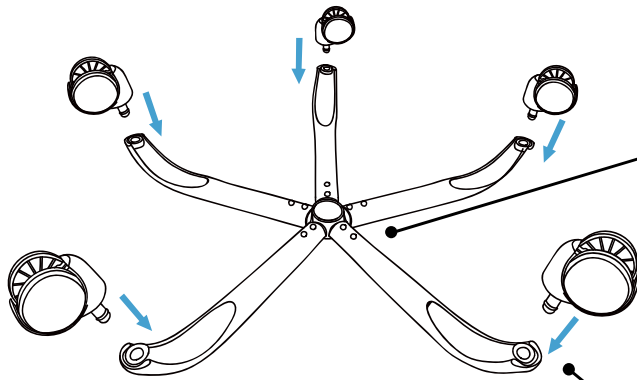
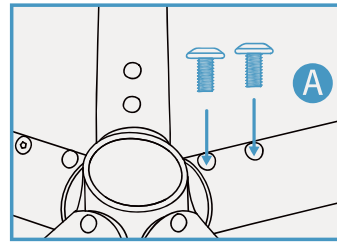

STEP 1

Turn the star base (9) upside down, Secure detachable feet with bolts(A) as shown.

STEP 2

Press the casters (10) into the holes at the end of each base leg.

STEP 3

Insert the Gas Lift (8) into the center hole of the star base.

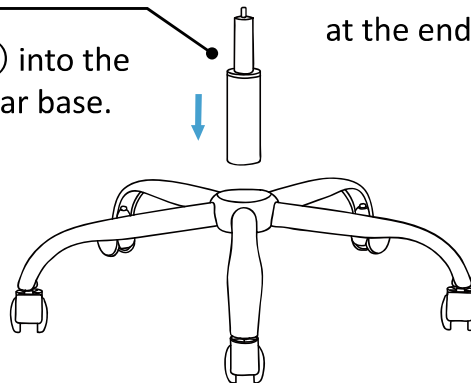

Attach the Back Cushion & Seat Plate

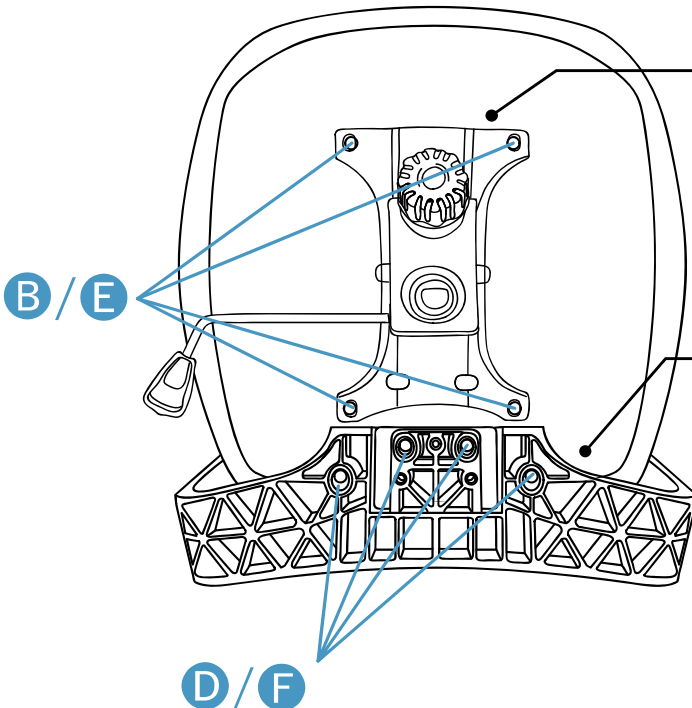

STEP 2

Attach the Seat Plate (7) to the Seat Cushion using Four Bolts(B) and Four Washers(E).

STEP 1

Attach the Lower Back (2) to the Seat Cushion (4) using Four Bolts(D) and Four Washers(F).

Order of bolts for better durability.

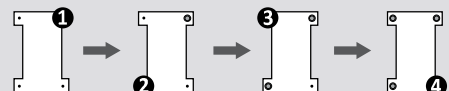

Push the Seat Cushion Down onto the Lift

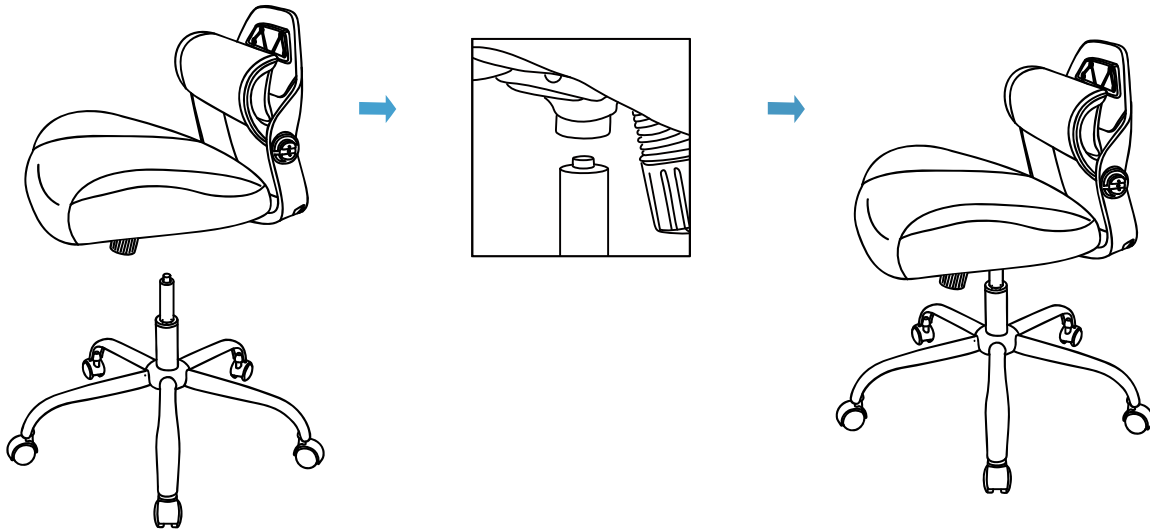

Attach the Backrest

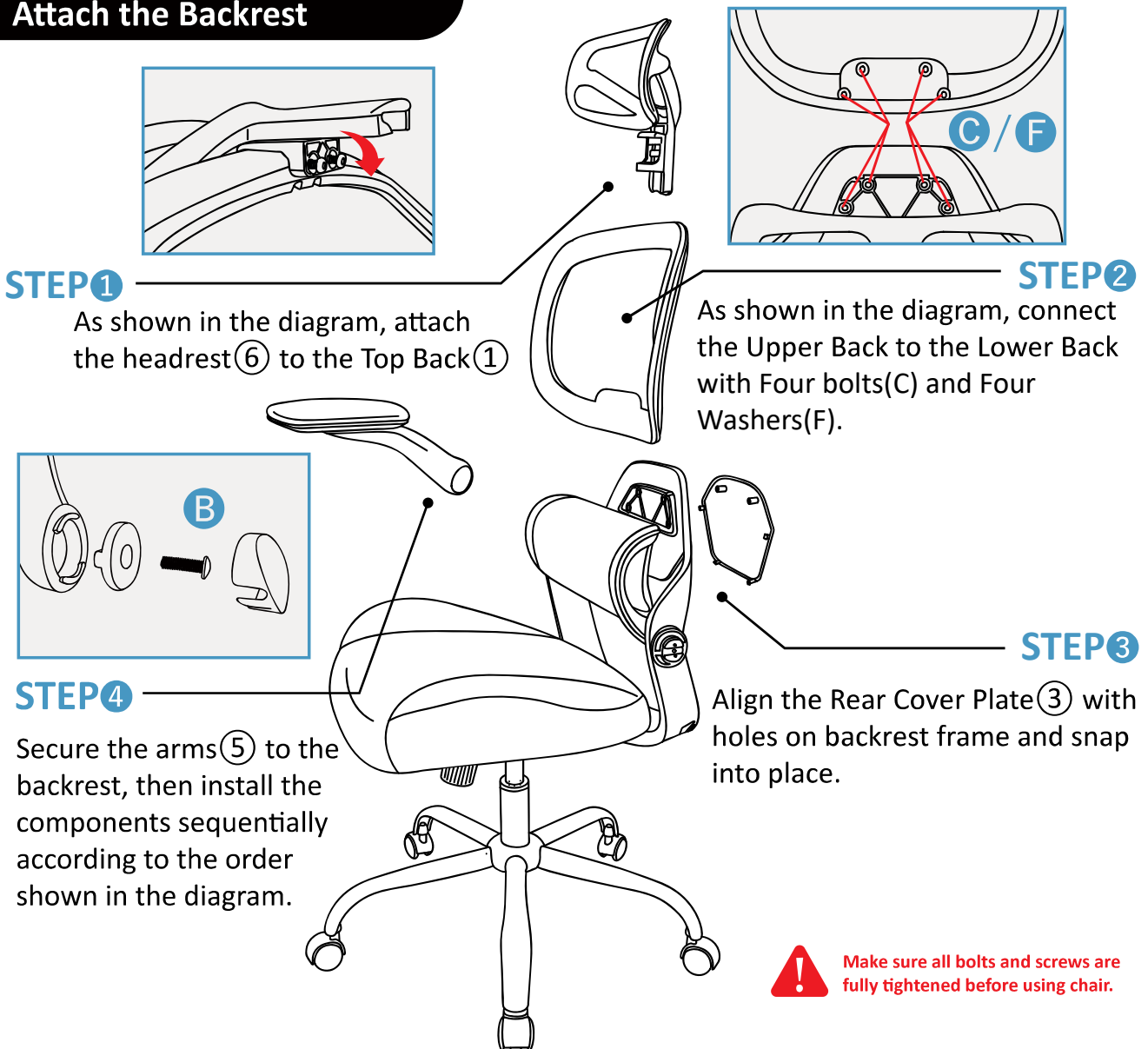

Instruction Manual

1. Seat Height Adjustable

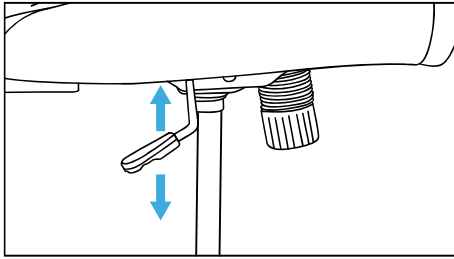

To raise:

While taking your weight off chair, lift lever up.



To lower:

While seated, lift lever up.

2. Rocking Pressure Adjustor

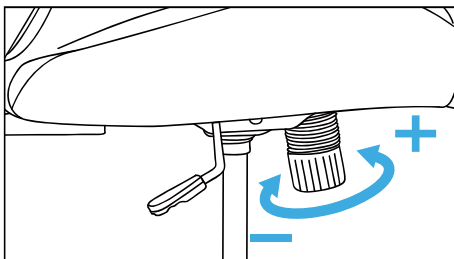

To increase tension:

Turn the tilt knob counter-clockwise.



To decrease tension:

Turn the tilt knob clock wise.

3. Rocking Function

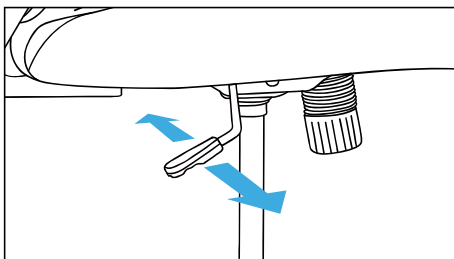

To let your chair rocking, pull the lever out.

4. Adjustable Armrests

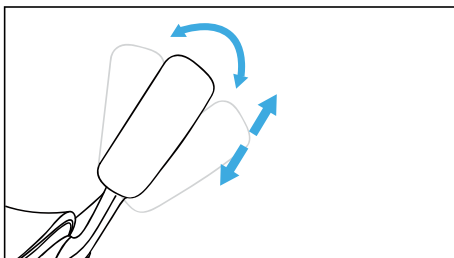

The position of the armrests can be adjusted according to your needs.

Child Safety: Keep children away during assembly; small parts pose choking hazards .

Emergency Contact: If installation issues arise (e.g., stuck gas lift), contact professionals. Do not use excessive force.